

Cylindrical revolving handles

Duroplast

MATERIAL

Phenolic based (PF) Duroplast, black colour, glossy finish.

STANDARD EXECUTION

- **I.281**: plain pass-through hole.
- **I.281+x**: matte chrome-plated steel shank, cylindrical-head with hexagon socket.
- **I.281+x-SST**: AISI 304 stainless steel shank, cylindrical-head with hexagon socket.
- **I.281+x+Gh**: matte chrome-plated steel shank and locking nut, cylindrical-head with hexagon socket.

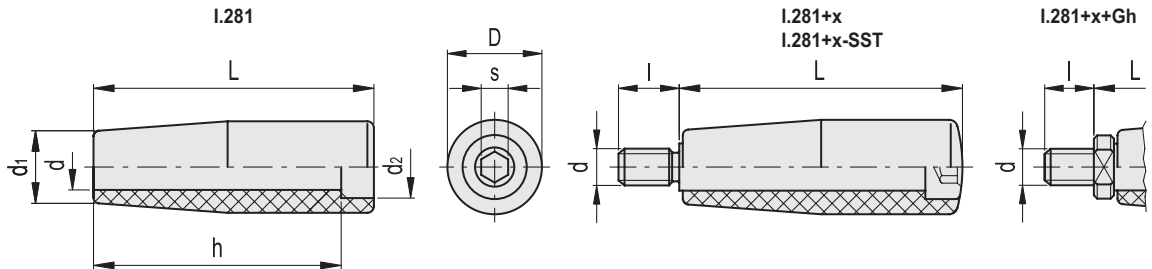

I.281

Code	Description	D	L	d	d1	d2	h	⚖
22301	I.281/40	18	39	8	15	12	35	10
22401	I.281/50	21	49	10	17	14	43	16
22501	I.281/65	23	64	12	19	16	56	22
22601	I.281/80	26	79	13	21	17	70	37
22701	I.281/90	28	89	14	22	19	79	49
22801	I.281/100	31	100	16	25	20	89	66

I.281+x

Code	Description	D	L	d6g	d1	l	s	⚖
22311	I.281/40+x-M6	18	40	M6	15	13	4	28
22411	I.281/50+x-M8	21	50	M8	17	15	5	52
22511	I.281/65+x-M8	23	65	M8	19	17	6	86
22512	I.281/65+x-M10	23	65	M10	19	17	6	90
22611	I.281/80+x-M10	26	80	M10	21	18	6	132
22711	I.281/90+x-M10	28	90	M10	22	18	8	170
22811	I.281/100+x-M12	31	102	M12	25	20	8	245
22812	I.281/100+x-M14	31	102	M14	25	20	8	248

I.281+x-SST

STAINLESS STEEL

Code	Description	D	L	d6g	d1	l	s	⚖
22312	I.281/40+x-M6-SST	18	40	M6	15	13	4	28
22412	I.281/50+x-M8-SST	21	50	M8	17	15	5	52
22513	I.281/65+x-M8-SST	23	65	M8	19	17	6	87
22514	I.281/65+x-M10-SST	23	65	M10	19	17	6	91
22612	I.281/80+x-M10-SST	26	80	M10	21	18	6	133
22712	I.281/90+x-M10-SST	28	90	M10	22	18	8	172
22813	I.281/100+x-M12-SST	31	102	M12	25	20	8	247
22814	I.281/100+x-M14-SST	31	102	M14	25	20	8	250

I.281+x+Gh

Code	Description	D	L	d6g	d1	l	s	⚖
22321	I.281/40+x-M6+Gh	18	45	M6	15	8	4	33
22421	I.281/50+x-M8+Gh	21	55	M8	17	10	5	56
22521	I.281/65+x-M8+Gh	23	70	M8	19	12	6	90
22522	I.281/65+x-M10+Gh	23	71	M10	19	12	6	98
22621	I.281/80+x-M10+Gh	26	86	M10	21	12	6	143
22721	I.281/90+x-M10+Gh	28	96	M10	22	12	8	180
22821	I.281/100+x-M12+Gh	31	109	M12	25	13	8	256
22822	I.281/100+x-M14+Gh	31	109	M14	25	13	8	262

X-ON Electronics

Largest Supplier of Electrical and Electronic Components

Click to view similar products for [Knobs & Dials](#) category:

Click to view products by [Elesa & Ganter](#) manufacturer:

Other Similar products are found below :

[790-1202](#) [790-2226](#) [8529](#) [8547](#) [85-559](#) [8573](#) [11K5015-EMNB](#) [11K5015-EMNG](#) [1770](#) [P400S-08-D6-N](#) [KNP700A1/4](#) [3045B](#) [AL811BA18](#)
[AR22PY-122B](#) [PKJ50B18](#) [277A](#) [348003](#) [42000B38](#) [5006](#) [56008-001](#) [411](#) [420037B14](#) [WA-102B](#) [WA-103](#) [WA-109B](#) [WA-1550](#) [WA-](#)
[1600-P](#) [WA-2300](#) [WA-4100](#) [WA-4108-P](#) [52-928.20](#) [52-928.9](#) [8517](#) [8529](#) [8545](#) [8572](#) [WA-4104](#) [WA-4103](#) [WA-1202](#) [WA-104B](#) [WA-103B](#)
[WA-102](#) [6126](#) [MS91528-0N1B](#) [7-1437622-0](#) [790-1208](#) [790-1370-MS](#) [8-1437622-6](#) [P209061-001](#) [P675S-06-D6-W](#)