

TECHNICAL SPECIFICATIONS

D-Sub Hood:

Material: Zinc, Nickel Plated
 Operating Temperature: -40°C to +120°C
 Cable Entry: Top Entry
 Thumbscrews: UNC 4-40 (Standard)
 Cable O.D.: Up to 11,5mm (Size 9-37)
 Up to 17mm (Size 50)

Male D-Sub Solder Cup:

Insulator: PBT, Black, UL94 V-0
 Shell: Steel, Tin Plated
 Contact pins: Copper Alloy
 Stamped & Formed Pins: Class 3, 100 inserts min.
 Machined Contact Pins: Class 1, 500 inserts min.
 Contact Plating: Selective Gold over Nickel
 Operating Temperature: -55°C to +105°C
 Withstanding voltage: 1000V for 1 minute
 Insulator resistance: 1000MΩ min.

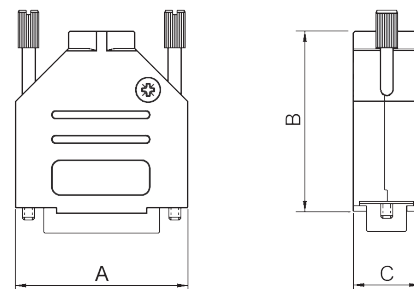

D-Sub-Hood

Features:

- Available in sizes 9-15-25-37-50
- Packed in Kit with MALE D-connector
- Class 3 or Class 1 connector as standard options
- Re-openable
- Full Metal Jackscrew as standard.

Size DTZK	Dim A	Dim B	Dim C
9-way	31,0	39,5	15,0
15-way	39,5	41,5	15,0
25-way	53,5	48,5	15,0
37-way	71,0	53,0	15,0
50-way	67,5	54,0	18,7

Ordering information:

Class 3 Sub-D Connector Kits (100 inserts min.)

Size:	P/N - Kitted:	Product Code - MALE Conn. Kit
9-way	6355-0002-01	DTZK09-DBP-K
15-way	6355-0002-02	DTZK15-DBP-K
25-way	6355-0002-03	DTZK25-DBP-K
37-way	6355-0002-04	DTZK37-DBP-K
50-way	6355-0002-05	DTZK50-DBP-K

Ordering information:

Class 1 Sub-D Connector Kits (500 inserts min.)

Size:	P/N - Kitted:	Product Code - MALE Conn. Kit
9-way	6355-0002-21	DTZK09-DMP-K
15-way	6355-0002-22	DTZK15-DMP-K
25-way	6355-0002-23	DTZK25-DMP-K
37-way	6355-0002-24	DTZK37-DMP-K
50-way	6355-0002-25	DTZK50-DMP-K

TECHNICAL SPECIFICATIONS

D-Sub Hood:

Material:	Zinc, Nickel Plated
Operating Temperature:	-40°C to +120°C
Cable Entry:	Top Entry
Thumbscrews:	UNC 4-40 (Standard)
Cable O.D.:	Up to 11,5mm (Size 9-37) Up to 17mm (Size 50)

Female D-Sub Solder Cup:

Insulator:	PBT, Black, UL94 V-0
Shell:	Steel, Tin Plated
Contact pins:	Copper Alloy
Stamped & Formed Pins	Class 3, 100 inserts min.
Machined Contact Pins:	Class 1, 500 inserts min.
Contact Plating:	Selective Gold over Nickel
Operating Temperature:	-55°C to +105°C
Withstanding voltage:	1000V for 1 minute
Insulator resistance:	1000MΩ min.

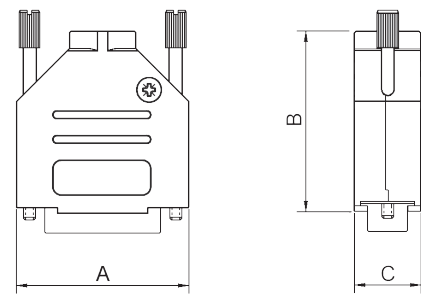

D-Sub-Hood

Features:

- Available in sizes 9-15-25-37-50
- Packed in Kit with FEMALE D-connector
- Class 3 or Class 1 connector as standard options
- Re-openable
- Full Metal Jackscrew as standard.

Size DTZK	Dim A	Dim B	Dim C
9-way	31,0	39,5	15,0
15-way	39,5	41,5	15,0
25-way	53,5	48,5	15,0
37-way	71,0	53,0	15,0
50-way	67,5	54,0	18,7

Ordering information:**Class 3 Sub-D Connector Kits (100 inserts min.)**

Size:	P/N - Kitted:	Product Code - MALE Conn. Kit
9-way	6355-0002-11	DTZK09-DBS-K
15-way	6355-0002-12	DTZK15-DBS-K
25-way	6355-0002-13	DTZK25-DBS-K
37-way	6355-0002-14	DTZK37-DBS-K
50-way	6355-0002-15	DTZK50-DBS-K

Ordering information:**Class 1 Sub-D Connector Kits (500 inserts min.)**

Size:	P/N - Kitted:	Product Code - FEMALE Conn. Kit
9-way	6355-0002-31	DTZK09-DMS-K
15-way	6355-0002-32	DTZK15-DMS-K
25-way	6355-0002-33	DTZK25-DMS-K
37-way	6355-0002-34	DTZK37-DMS-K
50-way	6355-0002-35	DTZK50-DMS-K

X-ON Electronics

Largest Supplier of Electrical and Electronic Components

Click to view similar products for [encitech](#) manufacturer:

Other Similar products are found below :

[6355-0007-12](#) [6355-0031-03](#) [D45ZK25-DMS-K](#) [DB25-SP](#) [1310-0004-01](#) [1310-1009-03](#) [1310-1013-03](#) [1310-0005-01](#) [1310-0007-03](#) [1310-0007-06](#) [1310-1012-01](#) [DPPK15-BK-HDP-K](#) [1130-0101-05](#) [1130-0103-04](#) [1130-0103-01](#) [6355-0005-03](#) [1310-1015-05](#) [1310-1019-04](#) [6355-0040-11](#) [6355-0050-02](#) [1310-1033-01](#) [6355-0066-11](#) [6355-0062-11](#) [6355-0071-02](#) [6355-0033-12](#) [6355-0033-13](#) [3101-8821](#) [3101-CAT6A](#) [DPAK-P-09-K](#) [6355-0030-03](#) [D45ZK15-DBS-K](#) [1310-1002-05](#) [1310-1010-01](#) [1310-1011-02](#) [DCRP09-DMS-CF65-CS80-K](#) [1310-1013-02](#) [DSSK09-M-DBS-K](#) [DCRP15-DBP-CF65-CS80-K](#) [DPPK09-M-HDS-K](#) [DSSK25-M-DMS-K](#) [1130-0221-03](#) [1130-0211-05](#) [1130-0221-04](#) [6355-0030-13](#) [1310-1018-03](#) [1310-1019-01](#) [1310-1020-01](#) [6355-0078-01](#) [DTSL09-SJSRG-S-HDP15-K](#) [DTSL09-SJSRG-S-HDS15-K](#)