

## KCS45 Tubular angle terminal

for multi-wire Cu cables

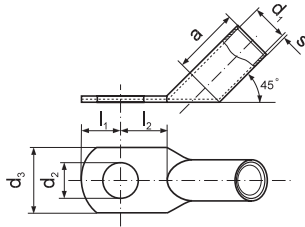

Material: galvanically tinned copper

Non tinned on request.

Cross section [mm <sup>2</sup> ]	For screw M	d <sub>2</sub> [mm]	Symbol	s [mm]	d <sub>1</sub> [mm]	d <sub>3</sub> [mm]	a [mm]	l <sub>1</sub> [mm]	l <sub>2</sub> [mm]	Weight [g/pc]	Unit [pcs]	Dies discriminant	Crimping tools
6	5	5,3	KCS45 5-6	1	4	9,5	9	8	8,5	3,90	10	6	EPZC300, EPZ300, GZ300, HRZ300, PRZ240, PR33, GO300, HR300, GU300, GU120, HR100-U, PR240, PR50, PP19, A11/6
	6	6,4	KCS45 6-6							3,73			
10	5	5,3	KCS45 5-10	1,2	4,5	12	10	8	8,5	5,93	10	7	EPZC300, EPZ300, GZ300, HRZ300, PRZ240, GO300,
	6	6,4	KCS45 6-10							6,14			
	8	8,4	KCS45 8-10							6,60			
16	6	6,4	KCS45 6-16	1,5	5,5	13	13	7,5	8,5	10,00	10	8	HR300, GU300, GU120, HR100-U, PR240, PR50, R50, PP19
	8	8,4	KCS45 8-16							10,50			
	10	10,5	KCS45 10-16							11,80			
25	6	6,4	KCS45 6-25	1,5	7	14	15	7,5	8,5	14,00	10	10	PP19 + as below
	8	8,4	KCS45 8-25							15,00			
	10	10,5	KCS45 10-25							14,90			
	12	13	KCS45 12-25							18,10			
35	6	6,4	KCS45 6-35	1,75	8,5	17	17	7,5	8,5	22,30	10	12	EPZC300, EPZ300, GZ300, HRZ300, PRZ240, GO300,
	8	8,4	KCS45 8-35							24,20			
	10	10,5	KCS45 10-35							25,20			
	12	13	KCS45 12-35							26,30			
	14	15	KCS45 14-35							27,70			
50	8	8,4	KCS45 8-50	2	10	20	19	10	11	33,20	10	14	HR300, GU300, GU120, HR100-U, PR240, PR120, PR150, PR50, PP19, A11/6
	10	10,5	KCS45 10-50							34,60			
	12	13	KCS45 12-50							33,30			
	14	15	KCS45 14-50							39,10			
	16	17	KCS45 16-50							43,20			
70	8	8,4	KCS45 8-70	2,25	12	23,5	21	10	11	51,20	10	16	EPZC300, EPZ300,
	10	10,5	KCS45 10-70							50,90			
	12	13	KCS45 12-70							55,10			
	14	15	KCS45 14-70							55,10			
	16	17	KCS45 16-70							61,40			
95	10	10,5	KCS45 10-95	2,25	13,5	26	25	12	13	58,612	10	18	GZ300, HRZ300, PRZ240, GO300, HR300, GU300, GU120, HR100-U, PR240, PR120, PR150
	12	13	KCS45 12-95							59,11			
	14	15	KCS45 14-95							67,90			
	16	17	KCS45 16-95							69,00			
	20	21	KCS45 20-95							74,00			
120	10	10,5	KCS45 10-120	2,25	15,5	29	26	12	13	75,17	10	19	PR240, PR120, PR150
	12	13	KCS45 12-120							76,40			
	14	15	KCS45 14-120							87,60			
	16	17	KCS45 16-120							88,90			
	20	21	KCS45 20-120							89,56			
150	10	10,5	KCS45 10-150	2,25	17	31	30	12	13	89,46	10	20	EPZC300, EPZ300, GZ300, HRZ300, PRZ240, GO300, HR300, GU300, PR240, PR150
	12	13	KCS45 12-150							90,23			
	14	15	KCS45 14-150							93,50			
	16	17	KCS45 16-150							95,60			
	20	21	KCS45 20-150							97,70			
185	10	10,5	KCS45 10-185	2,5	19	35	30	12	13	115,00	10	23	PR240, PRZ240, + as below
	12	13	KCS45 12-185							120,00			
	14	15	KCS45 14-185							120,30			
	16	17	KCS45 16-185							117,95			
	20	21	KCS45 20-185							123,23			
240	12	13	KCS45 12-240	2,5	21,5	39	35	13	14	140,00	10	25	EPZC300, EPZ300, GZ300, HRZ300, PRZ240, GO300, HR300, GU300
	14	15	KCS45 14-240							145,10			
	16	17	KCS45 16-240							146,30			
	20	21	KCS45 20-240							148,60			
300	12	13	KCS45 12-300	3	24,5	45	44	13	14	234,30	10	30	
	16	17	KCS45 16-300							238,90			
400	12	13	KCS45 12-400	3,5	27	49	44	24	24	338,70	10	34	GU625
	20	21	KCS45 20-400							334,10			

Production on request. Terminals of dimensions other than in chart.

## X-ON Electronics

Largest Supplier of Electrical and Electronic Components

*Click to view similar products for [Terminals](#) category:*

*Click to view products by [Erko](#) manufacturer:*

Other Similar products are found below :

[00-054007-01074-6](#) [00-054007-70206-1](#) [00-054007-70210-8](#) [00-054007-70217-7](#) [00-054007-70228-3](#) [00-054007-70256-6](#) [00-054007-70316-7](#) [00-054007-49560-4](#) [00-054007-70209-2](#) [00-054007-70231-3](#) [00-054007-70241-2](#) [00-054007-70242-9](#) [00-054007-70246-7](#) [00-054007-70263-4](#) [00-054007-70288-7](#) [00-054007-70290-0](#) [00-054007-70300-6](#) [00-054007-70304-4](#) [01-2900-1-04412](#) [00581P0075](#) [600TS-10](#) [605601-1](#) [60598-1-CUT-TAPE](#) [60617-1-C](#) [61314-6-C](#) [61810-3](#) [62149-1](#) [626-0194](#) [63-S](#) [M55155/059I03](#) [M55155/079C01](#) [M55155/099B03](#) [M55155/099H02](#) [M55155/109H01](#) [M55155/12XH05](#) [M55155/29XJ08](#) [M55155/30-6S](#) [M55155/30-9S](#) [M55155/30XI09](#) [M6-14RSX](#) [696683-1](#) [696861-1](#) [696999-1](#) [M86700006](#) [D18-110B-C](#) [D18-110B-M](#) [701-1936](#) [701-1955](#) [701-2003](#) [701-2007](#)