

EN-Zone für durchkontaktierte Löcher $\varnothing 0.6 \pm 0.05$
 compliant zone for through hole $\varnothing 0.6 \pm 0.05$

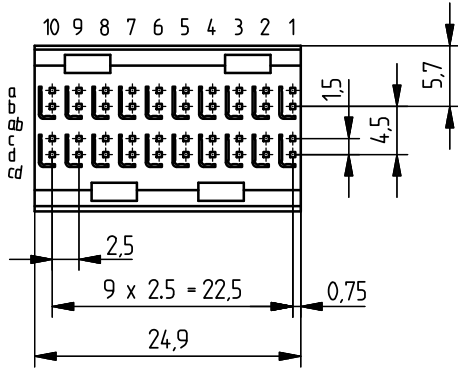

Kontaktversion, Messerkontakt
 Contact Option, Male Contact

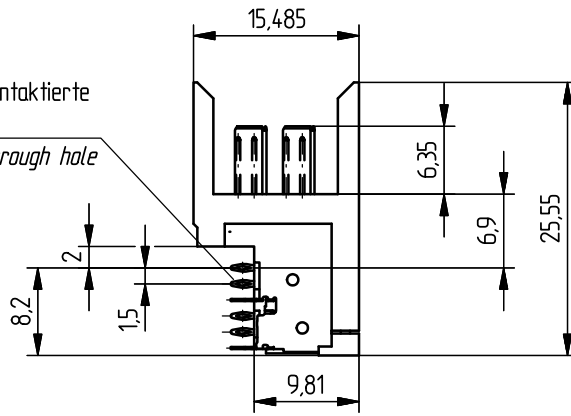
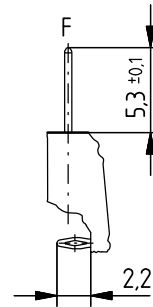

Kontaktversion, Schirmmesser
 Contact Option, Shielding Contact

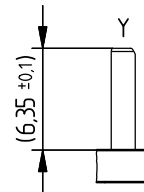

Bestückungsplan - contact layout

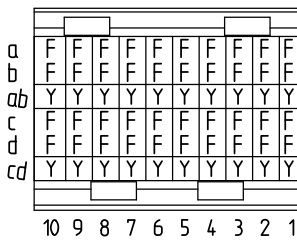

Lochbild für Leiterplatte Board hole pattern
 (Bestückungsseite) (Component mounting side)

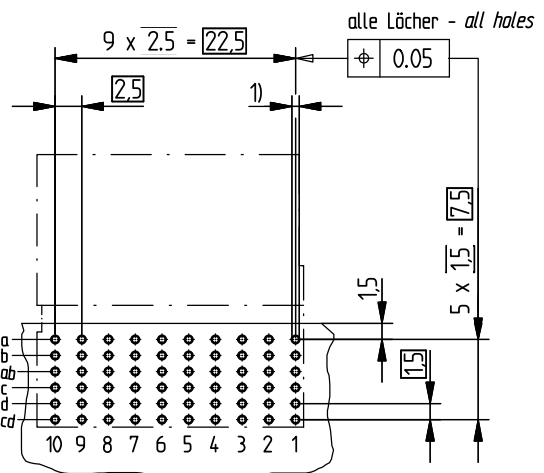

- 1) $\varnothing 0.6 \pm 0.05$ Durchmesser des metallisierten Loches
 $\varnothing 0.6 \pm 0.05$ Diameter of finished plated-through hole
- $\varnothing 0.7 \pm 0.02$ Bohrungsdurchmesser des Loches
 $\varnothing 0.7 \pm 0.02$ Diameter of drilled hole

Schichtaufbau im metallisierten Loch
 siehe Zeichnung 114406

Metal plating of plated-through hole
 see drawing 114406

Consider protection memo from DIN 34

Information: F + Y
 siehe Bestückungsplan /
 see contact layout
 Anforderungsstufe 2 / class 2

All rights reserved.
 Only for information.
 To insure that this is the latest
 version of this drawing, please
 contact one of the ERNI companies
 before using.

Tolerances



All Dimensions
 in mm

Scale 2:1

Subject to modification without
 prior notice.
 Drawing will not be updated.

Designation
 ERmetZD Messerleiste abg. 2-10
 ERmetZD Male Con. angle 2-10

ERNI www.ERNI.com

204780

1

b 30.01.2012
 Index Date

H:00057739.SZA

ERMZD

X-ON Electronics

Largest Supplier of Electrical and Electronic Components

Click to view similar products for [High Speed/Modular Connectors](#) category:

Click to view products by [ERNI](#) manufacturer:

Other Similar products are found below :

[650827-1](#) [74040-1346](#) [1410191-1](#) [1410368-3](#) [1410964-2](#) [1410326-3](#) [1410367-3](#) [1410971-4](#) [1467833-1](#) [2000877-1](#) [2000878-1](#) [2041314-1](#)
[2065387-1](#) [2187307-1](#) [163P](#) [1934290-1](#) [2000875-1](#) [2065917-1](#) [2102736-2](#) [FSR-40](#) [2169868-2](#) [22354-8](#) [437-5040-000](#) [5-1393565-0](#) [039-](#)
[0246-000](#) [0740618502](#) [0761601016](#) [0784461022](#) [10123159-12ELF](#) [030-2415-003/100 PK](#) [030-7380-004](#) [030-2494-001](#) [532939-1](#) [5532901-](#)
[3](#) [3-1469268-7](#) [74748-102LF](#) [10041743-101LF](#) [10066670-100002LF](#) [1-533915-1](#) [249-4515-000](#) [7-1469373-3](#) [DL2-2J/S](#) [2000713-8](#)
[2000713-7](#) [10124313-101LF](#) [3011-21](#) [757105208](#) [430305-001](#) [4395800100](#) [8140115](#)