

PART NO.	"A"±.020	"B"±.020	"C"	"D"	LED TYPE	MATERIAL	FIGURE NO.
LEDS1-3-26	3/16 [4.8]	.156 [4]	.047 [1.2]	.06 [1.5]	T-1	FLEXIBLE PVC (RMS-388), COLOR: BLACK	1
LEDS1-4-26	1/4 [6.4]						
LEDS1-6-26	3/8 [9.5]						
LEDS1-8-26	1/2 [12.7]						
LEDS1-10-26	5/8 [15.9]						
LEDS1-12-26	3/4 [19.1]						
LEDS1-14-26	7/8 [22.2]						
LEDS2-3-26	3/16 [4.8]	.188 [4.8]	.060 [1.5]	.10 [2.5]	T-1 3/4	FLEXIBLE PVC (RMS-388), COLOR: BLACK	1
LEDS2-4-26	1/4 [6.4]						
LEDS2-6-26	3/8 [9.5]						
LEDS2-8-26	1/2 [12.7]						
LEDS2-10-26	5/8 [15.9]						
LEDS2-12-26	3/4 [19.1]						
LEDS2-14-26	7/8 [22.2]						
LEDS3-3-26	3/16 [4.8]	.32 [8.1]	-	.10 [2.5]	T-1 & T-1 3/4	FLEXIBLE PVC (RMS-26), COLOR: BLACK	2
LEDS3-4-26	1/4 [6.4]						
LEDS3-6-26	3/8 [9.5]						
LEDS3-8-26	1/2 [12.7]						
LEDS3-10-26	5/8 [15.9]						
LEDS3-12-26	3/4 [19.1]						

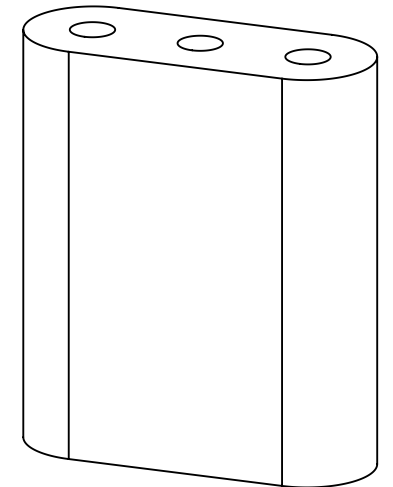
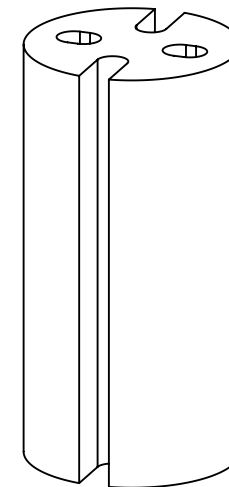

REV.	DESCRIPTION	ENGR.	DATE
H	MATERIAL CHANGE FROM -317 TO -388, ECN#1373	DZ	DEC14,2012
G	REDRAWN, SERIES EXPANSION, CO 200729	SK	OCT20,2011
-	SEE ENGINEERING FOR REV A TO F	---	-----

TITLE: LED SPACERS				UNITS= IN [mm]		FINAL	
CREATED USING SOLIDWORKS	FILE #: LEDS	DWN: SK	APP: -	FINAL			
TOLERANCES UNLESS NOTED .XX=±.02 .XXX=±.015 FRAC.=±1/32 ANG.=±1°	SHEET: 1 OF 1   SHEET SIZE: B	DT: 10/13/11	CHKD: -	PART #		PRINT TYPE	
RE: RICHCO, INC		RICHCO, INC. WWW.RICHCO-INC.COM		SEE TABLE		CA	

## X-ON Electronics

Largest Supplier of Electrical and Electronic Components

*Click to view similar products for [LED Mounting Hardware](#) category:*

*Click to view products by [ESSENTRA](#) manufacturer:*

Other Similar products are found below :

[00624250](#) [00624750](#) [M2200](#) [7047](#) [990-4901-010](#) [990-8115-001](#) [CMP22](#) [M16-T1](#) [C-101](#) [L2K-L4GD](#) [L2K-L5XL](#) [LDN51-125SL/BT](#)  
[00624500](#) [7046](#) [7056](#) [SN3486](#) [26-0053](#) [TC4-R-](#) [SLQ16](#) [LM6-2](#) [LM12-1](#) [LM10-1](#) [CM00624375](#) [CM00624900](#) [RNG132](#) [FIX-LEDH-10.5](#)  
[FIX-LEDH-11](#) [FIX-LEDH-11.5](#) [FIX-LEDH-12](#) [FIX-LEDH-14](#) [FIX-LEDH-17](#) [FIX-LEDH-18](#) [FIX-LEDH-4](#) [FIX-LEDH-4.5](#) [FIX-LEDH-7.5](#)  
[FIX-LEDH-9.5](#) [FIX-LEDS-1.5](#) [FIX-LEDS-2](#) [FIX-LEDS-3.5](#) [FIX-LEDT-11](#) [FIX-LEDT-20](#) [FIX-LEDT-26](#) [FIX-LEDT-5](#) [FIX-LEDT-9](#)  
[SQLEDS2-4-26](#) [7382](#) [CNXDX4624](#) [CNXDX4608](#) [CNXDF4608](#) [4740](#)