

REV.	MODIFICATION.	DATE	DRN
01	Sales Release	04/09/09	PH
02	CO2011179	29/07/11	SF
03	CO2011212	31/10/11	SF

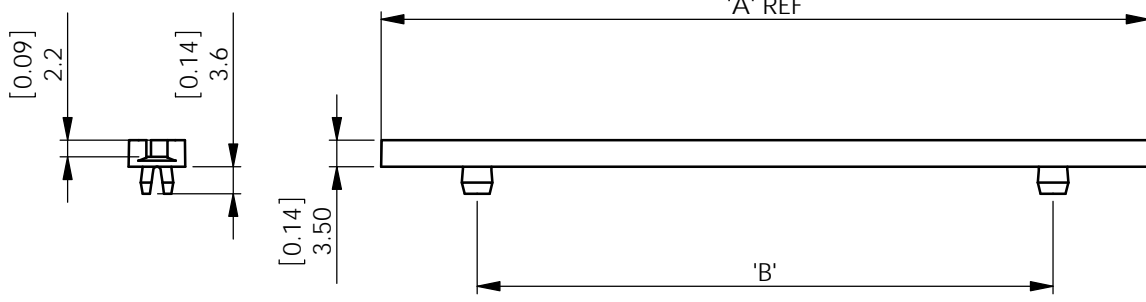

**PANEL DETAILS**

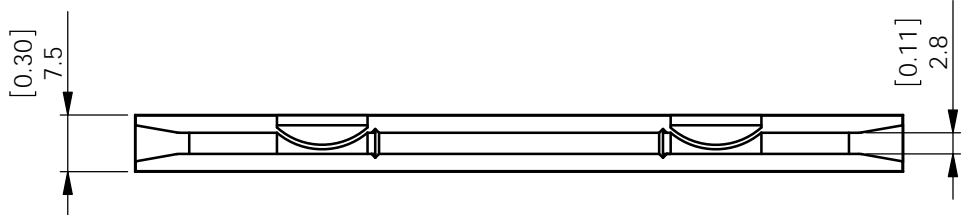
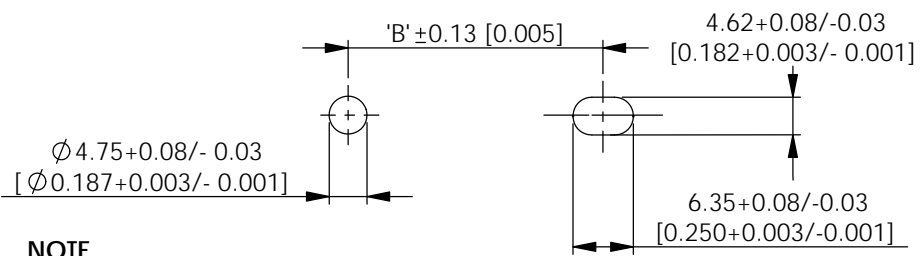

**NOTE**  
ACCEPTS PCB 0.8 TO 2.0 [0.032 TO 0.079]  
MOUNTS INTO PANEL 0.5 TO 2.0 [0.020 TO 0.079]

Part Number	Dimension 'A' REF	Dimension 'B' ± 0.25 [0.01]
MPCGCN-250	63.5 [2.50]	38.1 [1.50]
MPCGCN-300	76.2 [3.00]	50.8 [2.00]
MPCGCN-400	101.6 [4.00]	76.2 [3.00]
MPCGCN-550	139.7 [5.50]	114.4 [4.50]

ALTERNATE UNITS FOR REFERENCE ONLY

INFORMATION CONTAINED IN THIS DOCUMENT IS CONFIDENTIAL TO RICHCO INTERNATIONAL Co. Ltd. AND MAY NOT BE DISCLOSED OR REPRODUCED IN WHOLE OR PART WITHOUT THEIR WRITTEN CONSENT.

<b>RICHCO, INC.</b> <a href="http://WWW.RICHCO-INC.COM">WWW.RICHCO-INC.COM</a>	ALL DIMENSIONS IN mm GENERAL TOLERANCES ±0.25 UNLESS OTHERWISE STATED 1 DECIMAL PLACE ± 2 DECIMAL PLACES ± ANGULAR ±1°	THIRD ANGLE 
	MATERIAL: Nylon 6 Conductive Compound (RMS -392)	

COLOUR: **BLACK**

DESCRIPTION: **ESD MULTI PANEL CARD GUIDE**  
PART No: **SEE TABLE**

DRG No: 09-091      NPR No: EU09-0046      SHEET SIZE **A4**

DRN PH	DATE 21/08/09	CHKD TC	DATE 04/09/09	SCALE NTS	SHEET No. 1 OF 1
-----------	------------------	------------	------------------	--------------	---------------------

## X-ON Electronics

Largest Supplier of Electrical and Electronic Components

*Click to view similar products for [Racks & Rack Cabinet Accessories](#) category:*

*Click to view products by [Essentra](#) manufacturer:*

Other Similar products are found below :

[M00-PLN](#) [F2424](#) [8351-832-A-24](#) [9104](#) [9105](#) [PLFF2000](#) [H-9163-B](#) [1427C3](#) [HTS10](#) [PC-79](#) [SC10-3A](#) [SC4-28](#) [CG3-340S/12](#) [CP-001BK](#)  
[M6123-4007-SS](#) [TS170](#) [LP40](#) [5261304-07](#) [CG3-160G](#) [7112C-PLN](#) [ALUM](#) [CM10](#) [8610-3124-S-26](#) [TS81](#) [7142](#) [GP134](#) [M6125-4007-A-24](#)  
[M6127-4007-SS](#) [PBCOVER](#) [512](#) [AEG-4000G](#) [AEG-3000G](#) [HD99](#) [SR2-66A2](#) [FP10B4HP-1](#) [SR16-66A2](#) [FP52-2](#) [1406-1006-01](#) [29478](#)  
[TS2535](#) [TS169-6](#) [CAC2](#) [HA19-3U](#) [BR-19-10-1](#) [TS180](#) [CG3-ESD](#) [SC11-1](#) [CFS-1.00/2.20](#) [HEC0800PB](#) [ZC633R](#) [140PLN](#)