

NYLON 6/6 (RMS-01) COLOR: NATURAL PART NO.	FLAME RETARDANT NYLON (RMS-19) COLOR: NATURAL PART NO.	"A" REF.	"B" REF.	"C" REF.	"D" REF.	STYLE
OFNS-13-187-01	OFNS-13-187-19	1.06 (26.8)	.83 (21.2)	.75 (19.0)	1.11 (28.2)	1
OFNS-13-312-01	OFNS-13-312-19					2
OFNS-13-250-01	OFNS-13-250-19					4
OFNS-13-S9.5M-01	OFNS-13-S9.5M-19					5
OFNSB-13-01A-RT	OFNSB-13-19A-RT					6
OFNS-16-187-01	OFNS-16-187-19	1.35 (34.3)	1.13 (28.7)	.99 (25.1)	1.35 (34.4)	1
OFNS-16-312-01	OFNS-16-312-19					2
OFNS-16-S307-01	OFNS-16-S307-19					3
OFNS-16-S9.5M-01	OFNS-16-S9.5M-19					5
OFNSB-16-01A-RT	OFNSB-16-19A-RT					6
					1.53 (38.9)	

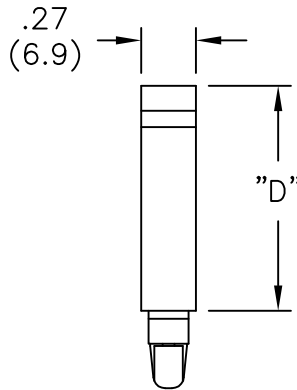

STYLE 1.
TO SNAP LOCK INTO A
.187±.003 (4.75±0.08) DIA.
HOLE IN A .031-.079
(0.8-2.0) THICK PANEL

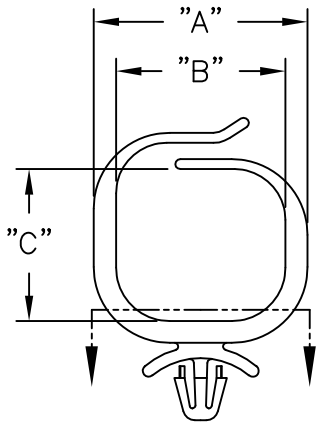

STYLE 2.
TO SNAP LOCK INTO A
.312±.003 (7.92±0.08) DIA.
HOLE IN A .031-.063
(0.8-1.6) THICK PANEL

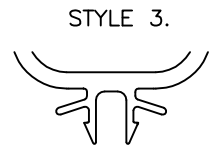

STYLE 3.
TO SNAP LOCK INTO A
.307±.003 (7.80±0.08) SQUARE
HOLE IN A .031-.079
(0.8-2.0) THICK PANEL.



STYLE 4.
TO SNAP LOCK INTO A
.250±.003 (6.35±0.08) DIA.
HOLE IN A .031-.079
(0.8-2.0) THICK PANEL

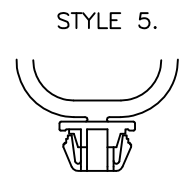

STYLE 5.
TO SNAP LOCK INTO A
.374±.003 (9.5±0.08) SQUARE
HOLE IN A .031-.079
(0.8-2.0) THICK PANEL

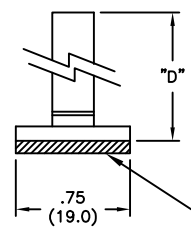
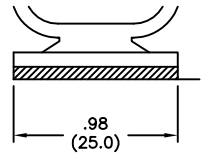

1/32 (0.8) THICK
DOUBLE SIDED ADHESIVE
TAPE W/RELEASE TAB

SEE STYLE

NOTES:
1. COLOR BLACK AVAILABLE BY
SPECIAL ORDER ONLY.

TO ORDER ADD SUFFIX "BK" TO THE END OF PART NO.
2. TAPE: ACRYLIC ADHESIVE TAPE (RMS-15)

TITLE: OPTICAL FIBER NETWORK SADDLE		DWG IN IN (MM)	FINAL	PRINT TYPE CA
TOLERANCES UNLESS NOTED .XX=±.010 .XXX=±.005 FRAC=±1/64 ANG=±1°	FILE # OFNS(B) MAT'L: SEE TABLE RE: RICHCO, INC.	DWN: J.B. DT: 04-08-97	APP: DT:	PART # SEE TABLE
		RICHCO INC. PO BOX 804238, CHICAGO, 60680 (773) 539-4060		

REV	DESCRIPTION	ENGR	DATE
F	SEE CO 200181 FOR CHANGES	SK	05.13.08
E	SEE ECN #1312 FOR CHANGES	SK	04.11.07
D	SEE ECN #1180 FOR CHANGES	SK	06.06.06.
C	UPDATED PRINT AND ADDED "...-S9.5M..." P/N	SM	05.10.02
B	CORRECTED METRIC CONVERSION; CHANGED FILE NO.	SM	12.18.01
A	ADDED OFNS-13-250-SERIES	AM	4-20-99

X-ON Electronics

Largest Supplier of Electrical and Electronic Components

Click to view similar products for [Cable Mounting & Accessories](#) category:

Click to view products by [ESSENTRA](#) manufacturer:

Other Similar products are found below :

[582603-1](#) [009333-000](#) [727844N003](#) [747](#) [809090N001](#) [843188-000](#) [8666](#) [967279N002](#) [DB-11](#) [1300840039](#) [1300900096](#) [1301800416](#)
[1302264450](#) [1300830184](#) [1300830729](#) [1300900039](#) [1301580036](#) [1301850553](#) [1301860939](#) [1302000074](#) [1302261315](#) [1302264431](#)
[1337706-2](#) [APA18-AK](#) [1724](#) [1-787307-1](#) [185491N001](#) [1868](#) [HP-6N](#) [C-202-C](#) [202C221-13-0](#) [CA7308-000](#) [8S23-75FR-CS8184](#) [2684](#) [9648](#)
[3089](#) [988382-000](#) [A72821-000](#) [AA401](#) [173506-000](#) [1823](#) [202C292-13-0](#) [202C302-13-0](#) [2109](#) [300625](#) [3330](#) [3412](#) [356247-1](#) [M9142](#)
[M9143](#)