

ROCKER SWITCHES

SERIES RA1066

RA 1066

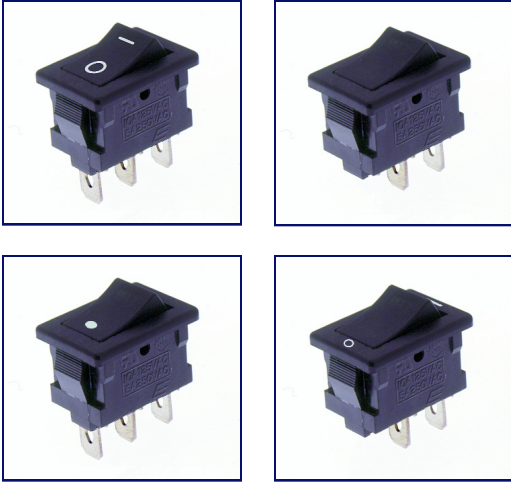

SPECIFICATIONS

CONTACT RESISTANCE: 100m max.

DIELECTRIC STRENGTH: AC2000V for 1 minute

LIFE EXPECTANCY: Electrical/10,000 cycle (R-L o a d)
Mechanical/25,000 cycle

RATING: 10A 125 VAC / 5A 250 VAC

OPERATING FORCE: 400±200gf

SAFETY STANDARD APPROVAL: UL (JRA), CSA, VDE, NEMKO,
SEMKO, FIMKO, DEMKO

MATERIALS

CONTACTS: Silver plated copper alloy



HOW TO ORDER

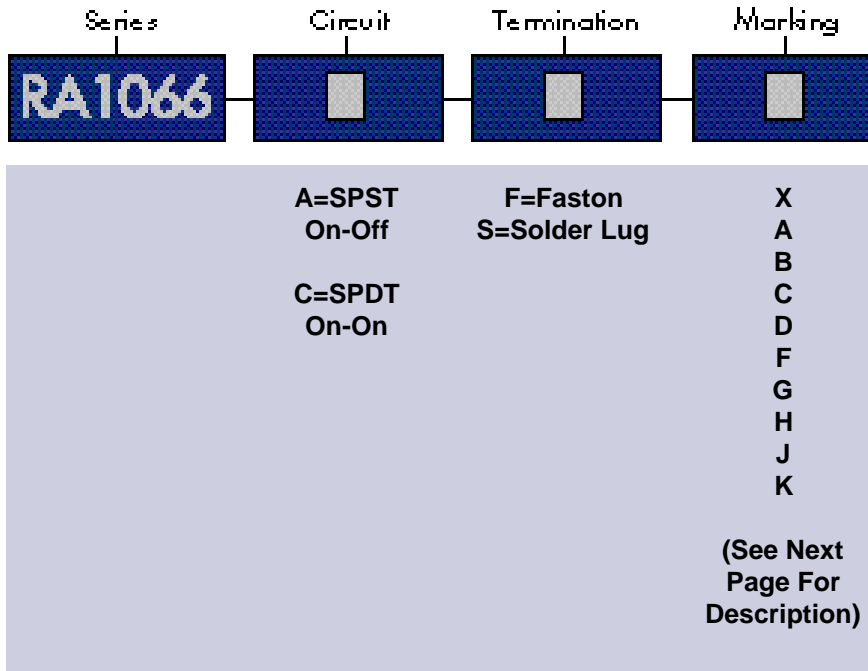

Example:

RA1066 → A → F → H

SPECIFICATIONS SUBJECT TO CHANGE WITHOUT NOTICE.

A SPST

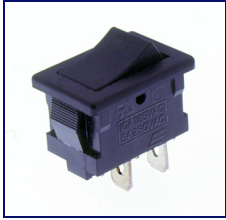

Circuit Code	POS 1	POS 2
A	ON	OFF
Term. Comm.	2-1	OPEN

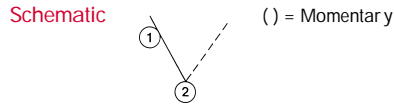

C SPDT

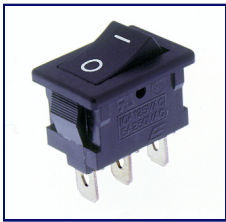

Circuit Code	POS 1	POS 2
C	ON	ON
Term. Comm.	2-1	2-3

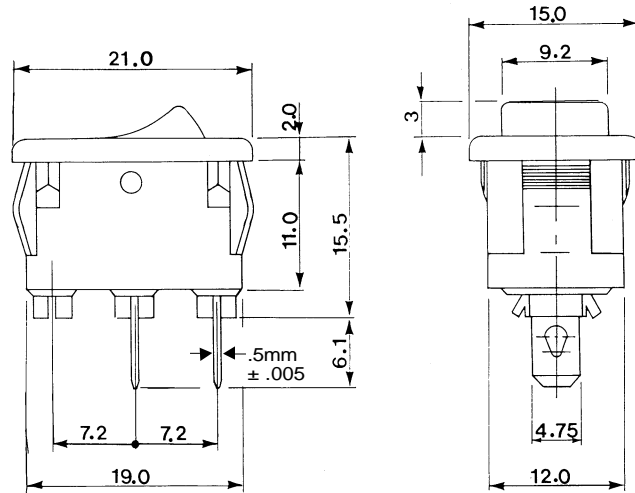
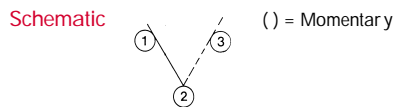

All dimensions in mm.

PANEL MOUNTING

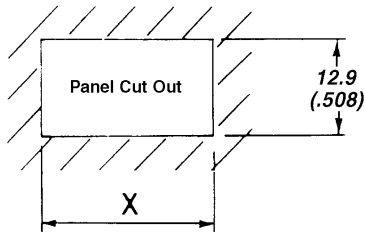

Panel Thickness	'X' Dim.
.75 - 1.25 (.030)-(.049)	19.2 (.756)
1.25 - 2.00 (.049)-(.079)	19.4 (.764)

TERMINATION OPTIONS

F Faston

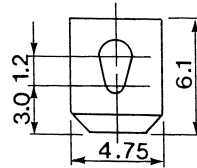

S Solder Lug

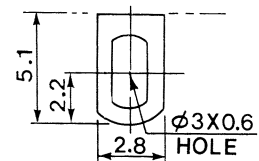

0.508 (.020) THK terminals designed for Quick Connect connectors available from AMP Industries, Harrisburg, PA 17105. (Or equivalent).

(F) Termination Rating:
10A, 125VAC

(S) Termination Rating:
5A, 250V AC

MARKING OPTIONS

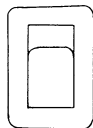

X

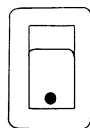

A

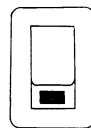

B

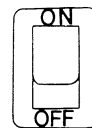

C

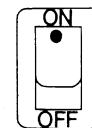

D

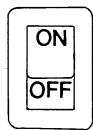

F

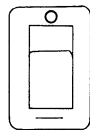

G

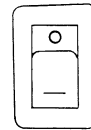

H

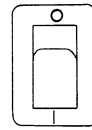

J

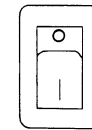

K

SPECIFICATIONS SUBJECT TO CHANGE WITHOUT NOTICE.

X-ON Electronics

Largest Supplier of Electrical and Electronic Components

Click to view similar products for [Rocker Switches](#) category:

Click to view products by [E-Switch](#) manufacturer:

Other Similar products are found below :

[LTI LA6E-1S-WH-RC-FN12VXCR1](#) [6-1571986-9](#) [8007K26N324V52](#) [8055K32Z7V](#) [8055K52Z7V](#) [8138K20E6M50](#) [84206L](#) [84312LX](#)
[PREDD5-07F-BB0GW](#) [999-16716-002](#) [999-16716-003](#) [999-16716-004](#) [A101J1V3Q004](#) [A101J2ZQ004](#) [A101J4ZQ004](#) [A101J51CB0004](#)
[A103J1ZQ004](#) [A201J1AQ004](#) [A201J3ZB004](#) [A201J50ZQ004](#) [A203J51ZQ0004](#) [A435S1YZQ](#) [H8500XBBBBL-A](#) [H8653VBBG2577W](#)
[HB130CHNWWNAAC](#) [R13112ABB-602W](#) [1251.0303](#) [AE205J60V3B004](#) [1352.0107](#) [1500G51E](#) [1571099-3](#) [1571987-4](#) [1571987-5](#)
[1571989-7](#) [1571988-5](#) [B123J77V7B2](#) [B226J50W4Q22P](#) [B433J37ZQ22M](#) [160212E](#) [1634200-7](#) [1801.1164](#) [1839.1502](#) [PANEL-PLUG-VHP-](#)
[BLACK](#) [PANEL-PLUG-VHP-WT](#) [K1ABBSCADN](#) [K2ABAAAAAA](#) [KG312A2DXD246X](#) [250011E714](#) [2600HM11E](#) [2600R21E](#)