

THIS DOCUMENT CONTAINS PROPRIETARY DATA OF POLARIS INDUSTRIAL ENTERPRISES, INC. NO DISCLOSURE, REPRODUCTION, OR USE OF ANY PART THERE OF MAY BE MADE EXCEPT BY WRITTEN PERMISSION.

REV.	BY	DATE	APPRVL.	P/N	HSM22
------	----	------	---------	-----	-------

GENERAL SPECIFICATION:

CURRENT CONSUMPTION SINGLE OUTPUT ----- BELOW 16mA  
 CURRENT CONSUMPTION DUAL OUTPUT----- BELOW 32mA  
 INDEPENDENT LINEARITY TOL. -----  $\pm 0.5\%FS$ (FS=360°)  
 MECHANICAL ROTATING ANGLE ----- 360°(ENDLESS)  
 EFFECTIVE ELECTRICAL ANGLE ----- 360°(ENDLESS)  
 APPLIED VOLTAGE ----- 5V $\pm 10\%$ D.C  
 LOAD RESISTANCE ----- 10KOHMS MIN  
 EFFECTIVE OUTPUT ----- 10%  $\pm 3\%$  ~ 90%  $\pm 3\%$  VIN  
 OUTPUT TEMPERATURE CHARACT. ----- WITHIN $\pm 0.3\%$ OUT/FS  
 OPERATING TEMPERATURE RANGE ----- -40°C ~ +120°C  
 STORAGE TEMPERATURE RANGE ----- -40°C ~ +120°C  
 MASS ----- APPROX 20g

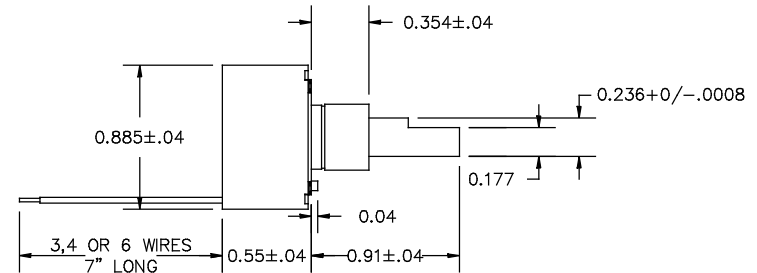

ENVIRONMENTAL SPECIFICATION:

ROTATING TORQUE ----- BELOW 5mN.m  
 THERMAL SHOCK ----- 5 CYCLES -40°C ~ +105°C  
 EXPOSURE TO LOW TEMPERATURE ----- 24 HOURS AT -40°C  
 EXPOSURE AT HIGH TEMPERATURES ----- 1,000 HOURS AT +105°C  
 VIBRATION ----- 10 ~ 2,000Hz 196m/s.s 12 HOURS  
 SHOCK ----- 980m/s.s 6ms (18 TIMES)  
 ROTATIONAL LIFE EXPECTANCY ----- APPROX. 50,000,000 REVOLUTIONS  
 EMS TOLERANCE ----- 100V/m (80MHz ~ 1GHz 1KHz SIN WAVE 80% AMPLITUDE MODULATION)  
 ESD TOLERANCE -----  $\pm 8KV$  CONTACT /  $\pm 15KV$  AERIAL DISCHARGE

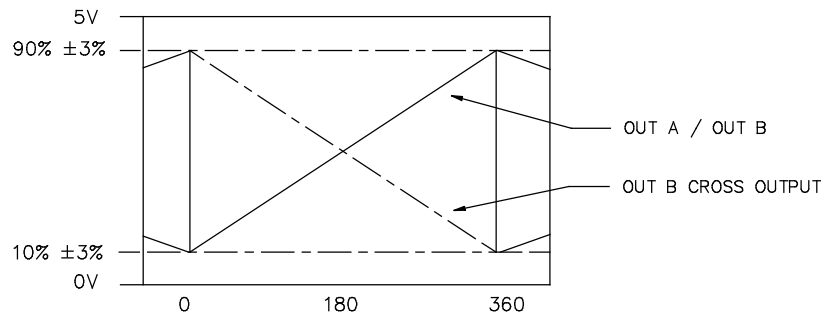
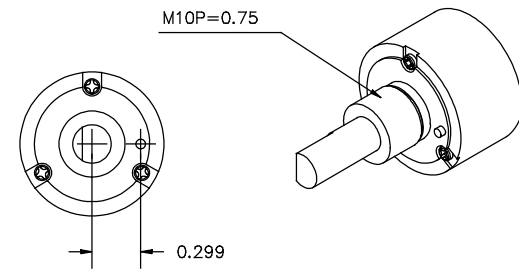

SINGLE OUTPUT      DUAL OUTPUT      DUAL INDEP. OUTPUT

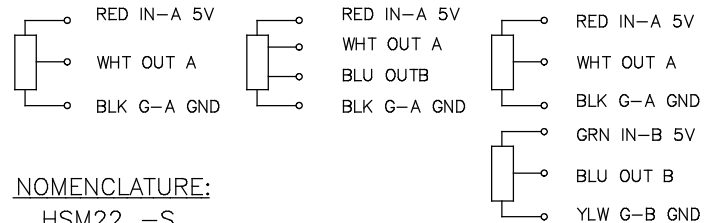

NOMENCLATURE:

HSM22 -S  
 OUTPUT TYPE (S, X, P, IX OR IP)  
 SERIES

TOLERANCES  
 XX = +/- .010" FRACT. = +/- 1/64"  
 XXX = +/- .005" ANGLES = +/- 1/2"  
 ALL SPECIFICATIONS SUBJECT TO CHANGE WITHOUT NOTICE.

SCALE	DATE: 5-3-13
NONE	BY AT
	APPRV'D
CODE IDENT:	19477



TITLE  
 CONTACTLESS  
 POTENTIOMETER

PART NO.  
 HSM22

## X-ON Electronics

Largest Supplier of Electrical and Electronic Components

*Click to view similar products for [Precision Potentiometers](#) category:*

*Click to view products by [ETI Systems](#) manufacturer:*

Other Similar products are found below :

[578002M9648](#) [70J1G032S202A](#) [176FL1-284](#) [F78SB102-M257](#) [3548H-1AA-103B](#) [485025M9267](#) [MH12B-10L-10K](#) [578005M9656](#)  
[72N4N048S203W](#) [6639S-481-103](#) [RO200SF1C103](#) [114BF2A102-L774](#) [200FL1-199](#) [78FL1-397](#) [78MKV-128](#) [501-0004](#) [501-0018](#)  
[SE15303-352-T4](#) [284TCBF103A26A1](#) [RO34SF1B502](#) [200FL1-260](#) [4205R10KL.5](#) [3548H-1AB-502A](#) [157-0237](#) [1521R10KL.3](#)  
[284TBBK103A26B1](#) [SP22G-500](#) [DC22-10-100](#) [JC22S 1K 0.5%](#) [RCL-200](#) [380C2750K](#) [380C2500K](#) [3590P-1-103L](#) [3547S-1AA-202A](#)  
[534B1250JC](#) [3543S-1-202L](#) [3545S-1-202L](#) [3543S-1-102L](#) [3543S-1-502L](#) [3545S-1-103L](#) [3549S-2AA-102/102A](#) [P3265](#) [P3270](#) [P3275](#) [P3280](#)  
[P3285](#) [P3290](#) [AR200KL.25](#) [6637S-1-102](#) [RV6NAYSD101AP](#)