

**Technical Data Sheet****Side View LEDs (Height 0.6mm)****99-116SUBP/S971/TR8****Features**

- Side view white LED.
- White SMT package.
- Lead frame package with individual 2 pins.
- Wide viewing angle.
- Soldering methods: IR reflow soldering.
- Pb-free.
- The product itself will remain within RoHS compliant version.

**Descriptions**

- Due to the package design, 99-116 has wide viewing angle, low power consumption and white LEDs are devices which are materialized by combining Blue LEDs and special phosphors. This feature makes the LED ideal for light guide application.

**Applications**

- LCD Back Light.
- Mobile phones .
- Indicators.
- Illuminations.
- Switch Lights.

**Device Selection Guide**

| Chip     | Emitted Color    | Resin Color |
|----------|------------------|-------------|
| Material |                  |             |
| InGaN    | Pastel mint blue | Water Clear |

Technical Data Sheet

Side View LEDs (Height 0.6mm)

**99-116SUBP/S971/TR8**

Package Outline Dimensions

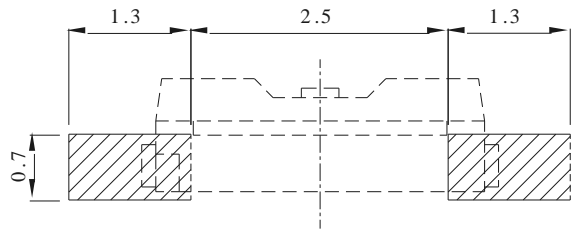
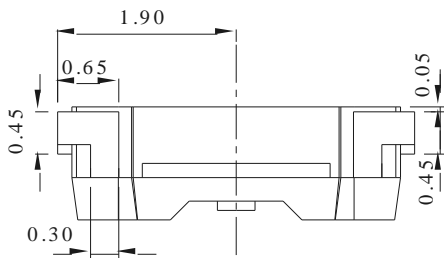
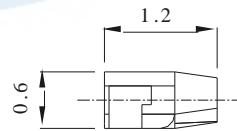
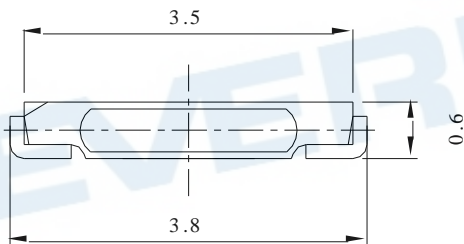
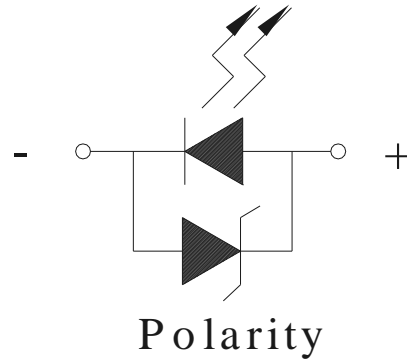
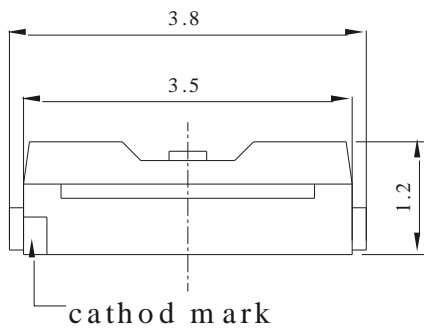

Recommended soldering pad design

**Note:**

Tolerances Unless Dimension  $\pm 0.1\text{mm}$ , Unit = mm



## Technical Data Sheet

## Side View LEDs (Height 0.6mm)

**99-116SUBP/S971/TR8****Absolute Maximum Ratings (Ta=25°C)**

| Parameter                                 | Symbol           | Rating  | Unit |
|---|------------------|---|------|
| Reverse Voltage                           | V <sub>R</sub>   | 5   | V    |
| Forward Current                           | I <sub>F</sub>   | 30  | mA   |
| Peak Forward Current<br>(Duty 1/10 @10ms) | I <sub>FP</sub>  | 100   | mA   |
| Power Dissipation                         | P <sub>d</sub>   | 110   | mW   |
| Electrostatic Discharge(HBM)              | ESD              | 2000  | V    |
| Operating Temperature                     | T <sub>opr</sub> | -40 ~ +85   | °C   |
| Storage Temperature                       | T <sub>stg</sub> | -40 ~ +90   | °C   |
| Soldering Temperature                     | T <sub>sol</sub> | Reflow Soldering : 260 °C for 10 sec.<br>Hand Soldering : 350 °C for 3 sec. |      |

**Electro-Optical Characteristics (Ta=25°C)**

| Parameter          | Symbol            | Min.  | Typ.  | Max.  | Unit | Condition           |
|--------------------|-------------------|-------|-------|-------|------|---------------------|
| Luminous Intensity | I <sub>v</sub>    | 225   | ----- | 360   | mcd  | I <sub>F</sub> =5mA |
| Viewing Angle      | 2θ <sub>1/2</sub> | ----- | 110   | ----- | deg  | I <sub>F</sub> =5mA |
| Forward Voltage    | V                 | 2.70  | ----- | 3.70  | V    | I <sub>F</sub> =5mA |

**Note:**

- 1.Tolerance of Luminous Intensity: ±11%
- 2.Tolerance of Forward Voltage: ±0.05V



## Technical Data Sheet

## Side View LEDs (Height 0.6mm)

**99-116SUBP/S971/TR8****Bin Range of Luminous Intensity**

| Bin Code | Min. | Max. | Unit | Conduction          |
|----------|------|------|------|---------------------|
| S2       | 225  | 285  | mcd  | I <sub>F</sub> =5mA |
| T1       | 285  | 360  |      |                     |

**Bin Range of Forward Voltage**

| Bin Code | Min. | Max. | Unit | Conduction          |
|----------|------|------|------|---------------------|
| 10       | 2.70 | 2.90 | V    | I <sub>F</sub> =5mA |
| 11       | 2.90 | 3.10 |      |                     |
| 12       | 3.10 | 3.30 |      |                     |
| 13       | 3.30 | 3.50 |      |                     |
| 14       | 3.50 | 3.70 |      |                     |

**Note:**

- 1.Tolerance of Luminous Intensity:  $\pm 11\%$
- 2.Tolerance of Forward Voltage:  $\pm 0.05V$



Technical Data Sheet

Side View LEDs (Height 0.6mm)

**99-116SUBP/S971/TR8**

**Bin Range of Chromaticity Coordinates**

| Bin Code | CIE_x | CIE_y | Bin Code | CIE_x | CIE_y |
|----------|-------|-------|----------|-------|-------|
| A        | 0.185 | 0.280 | B        | 0.211 | 0.380 |
|          | 0.194 | 0.280 |          | 0.202 | 0.369 |
|          | 0.206 | 0.330 |          | 0.189 | 0.330 |
|          | 0.189 | 0.330 |          | 0.206 | 0.330 |
|          | 0.185 | 0.318 |          | 0.218 | 0.380 |
|          | 0.185 | 0.280 |          | 0.211 | 0.380 |
| C        | 0.194 | 0.280 | D        | 0.218 | 0.380 |
|          | 0.202 | 0.280 |          | 0.206 | 0.330 |
|          | 0.220 | 0.315 |          | 0.220 | 0.330 |
|          | 0.220 | 0.330 |          | 0.220 | 0.380 |
|          | 0.206 | 0.330 |          | 0.218 | 0.380 |
|          | 0.194 | 0.280 |          | ----- | ----- |

**Note:**

Tolerance of Chromaticity Coordinates:  $\pm 0.01$

Technical Data Sheet

Side View LEDs (Height 0.6mm)

99-116SUBP/S971/TR8

The C.I.E. 1931 Chromaticity Diagram

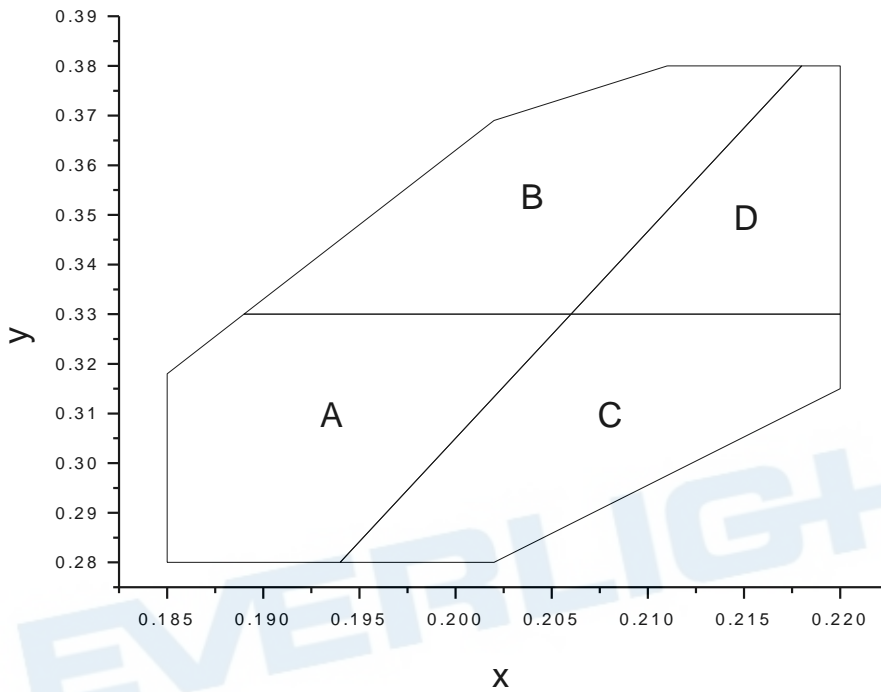

Technical Data Sheet

Side View LEDs (Height 0.6mm)

**99-116SUBP/S971/TR8**

Typical Electro-Optical Characteristics Curves

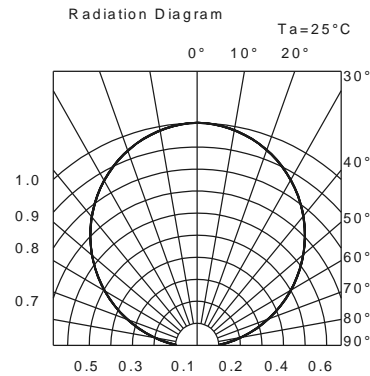
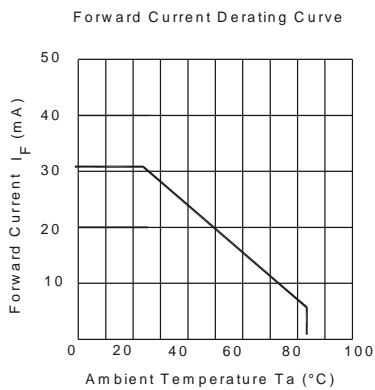
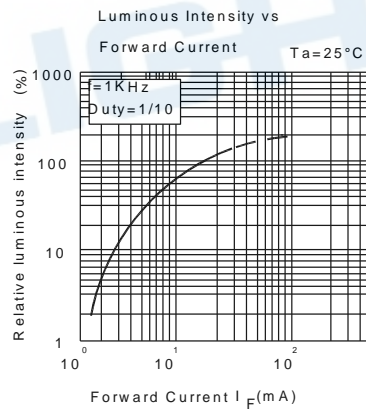
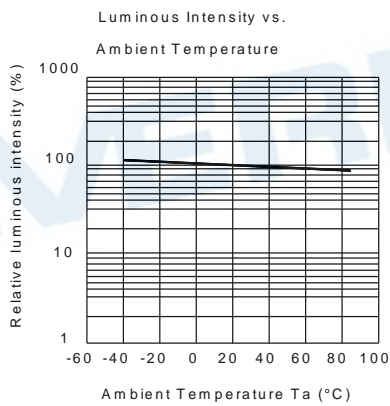
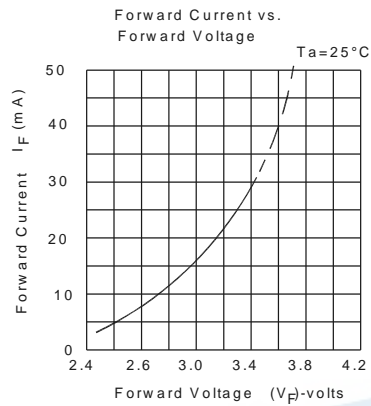
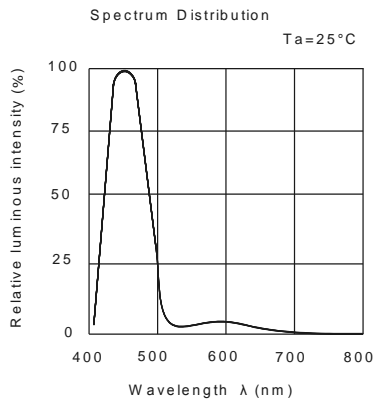



Technical Data Sheet

Side View LEDs (Height 0.6mm)

99-116SUBP/S971/TR8

Label Explanation

- CAT: Luminous Intensity Rank
- HUE: Chromaticity Coordinates
- REF: Forward Voltage Rank

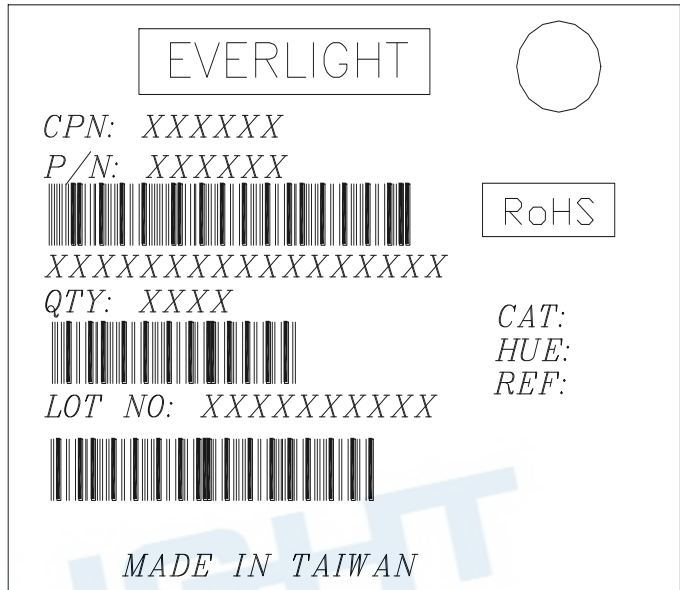

Reel Dimensions

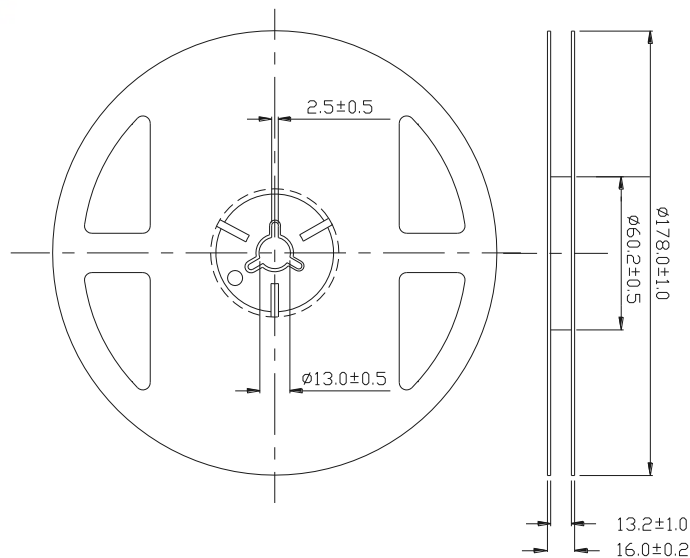

Note:

The tolerances unless mentioned is ±0.1mm, Unit = mm



Technical Data Sheet

Side View LEDs (Height 0.6mm)

**99-116SUBP/S971/TR8**

**Carrier Tape Dimensions: Loaded Quantity 2000 pcs per reel.**

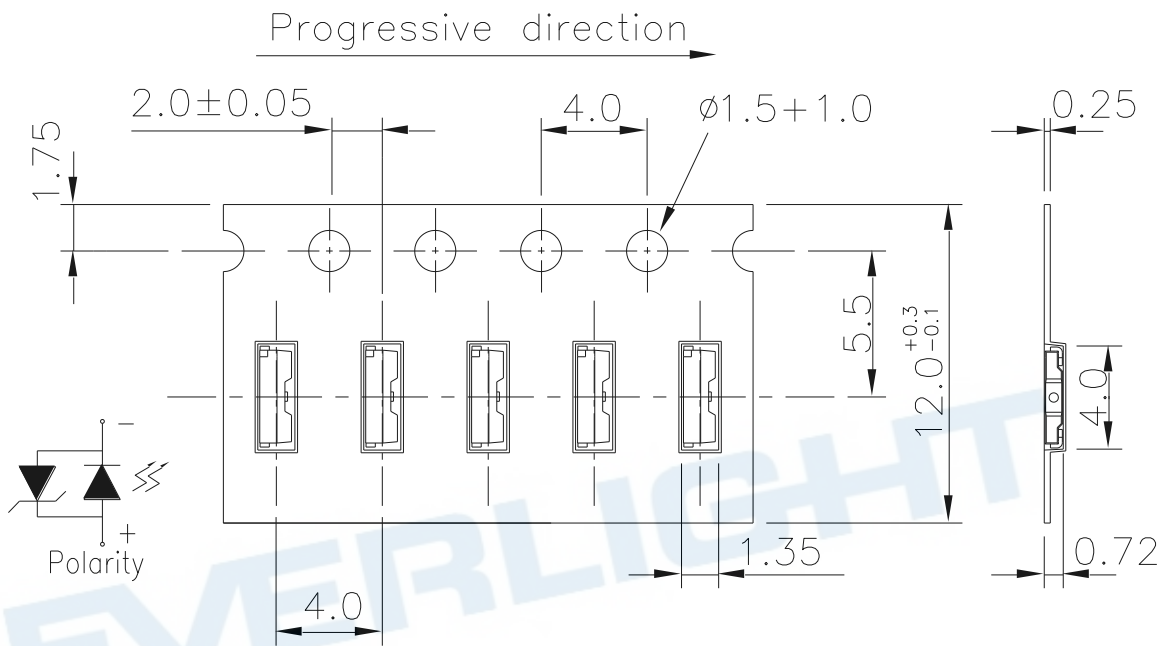

**Note:**

Tolerances Unless Dimension  $\pm 0.1\text{mm}$  Unit = mm

**Moisture Resistant Packaging**

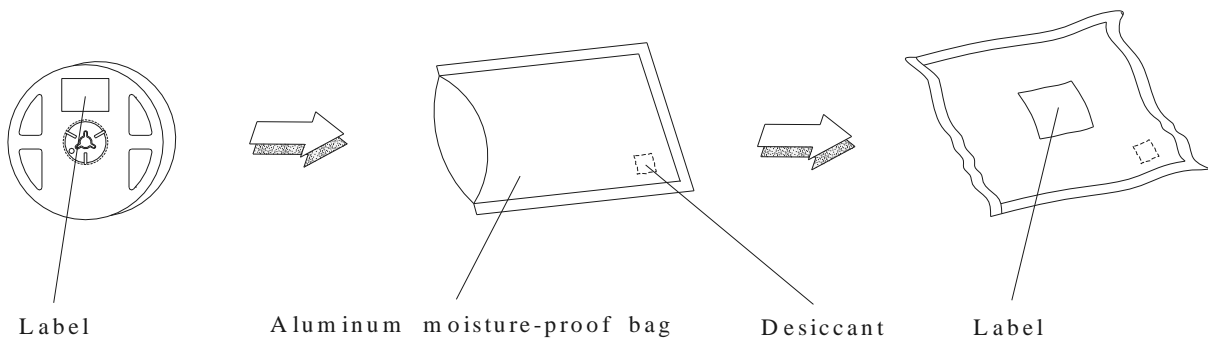

**Technical Data Sheet****Side View LEDs (Height 0.6mm)****99-116SUBP/S971/TR8****Reliability Test Items And Conditions**

The reliability of products shall be satisfied with items listed below.

Confidence level : 90%

LTPD : 10%

| No. | Items                            | Test Condition                                 | Test Hours/Cycles | Sample Size | Ac/Re |
|-----|----------------------------------|--|-------------------|-------------|-------|
| 1   | Reflow Soldering                 | Temp. : 260°C±5°C<br>Min. 5 sec.               | 6 Min.            | 22 PCS      | 0/1   |
| 2   | Temperature Cycle                | H : +100°C 15min<br>↓ 5 min<br>L : -40°C 15min | 300 Cycles        | 22 PCS.     | 0/1   |
| 3   | Thermal Shock                    | H : +100°C 5min<br>↓ 10 sec<br>L : -10°C 5min  | 300 Cycles        | 22 PCS.     | 0/1   |
| 4   | High Temperature Storage         | Temp. : 100°C                                  | 1000 Hrs.         | 22 PCS.     | 0/1   |
| 5   | Low Temperature Storage          | Temp. : -40°C                                  | 1000 Hrs.         | 22 PCS.     | 0/1   |
| 6   | DC Operating Life                | I <sub>F</sub> = 5 mA / 25°C                   | 1000 Hrs.         | 22 PCS.     | 0/1   |
| 7   | High Temperature / High Humidity | 85°C/85%RH                                     | 1000 Hrs.         | 22 PCS.     | 0/1   |

**Technical Data Sheet**

**Side View LEDs (Height 0.6mm)**

**99-116SUBP/S971/TR8**

**Precautions For Use**

1. Over-current-proof

Customer must apply resistors for protection, otherwise slight voltage shift will cause big current change ( Burn out will happen ).

2. Storage

2.1 Do not open moisture proof bag before the products are ready to use.

2.2 Before opening the package: The LEDs should be kept at 30°C or less and 90%RH or less.

2.3 After opening the package: The LED's floor life is 1 year under 30°C or less and 60% RH or less.

If unused LEDs remain, it should be stored in moisture proof packages.

2.4 If the moisture absorbent material (silica gel) has faded away or the LEDs have exceeded the storage time, baking treatment should be performed using the following conditions.

Baking treatment : 60±5°C for 24 hours.

3. Soldering Condition

3.1 Pb-free solder temperature profile

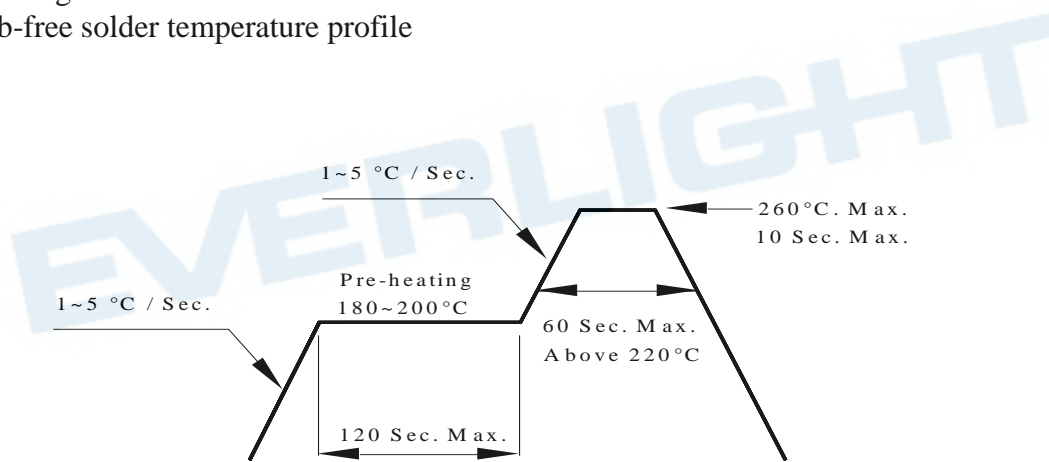

3.2 Reflow soldering should not be done more than two times.

3.3 When soldering, do not put stress on the LEDs during heating.

3.4 After soldering, do not warp the circuit board.

4.Soldering Iron

Each terminal is to go to the tip of soldering iron temperature less than 350°C for 3 seconds within once in less than the soldering iron capacity 25W. Leave two seconds and more intervals, and do soldering of each terminal. Be careful because the damage of the product is often started at the time of the hand solder.

**Technical Data Sheet****Side View LEDs (Height 0.6mm)****99-116SUBP/S971/TR8****5.Repairing**

Repair should not be done after the LEDs have been soldered. When repairing is unavoidable, a double-head soldering iron should be used (as below figure). It should be confirmed beforehand whether the characteristics of the LEDs will or will not be damaged by repairing.

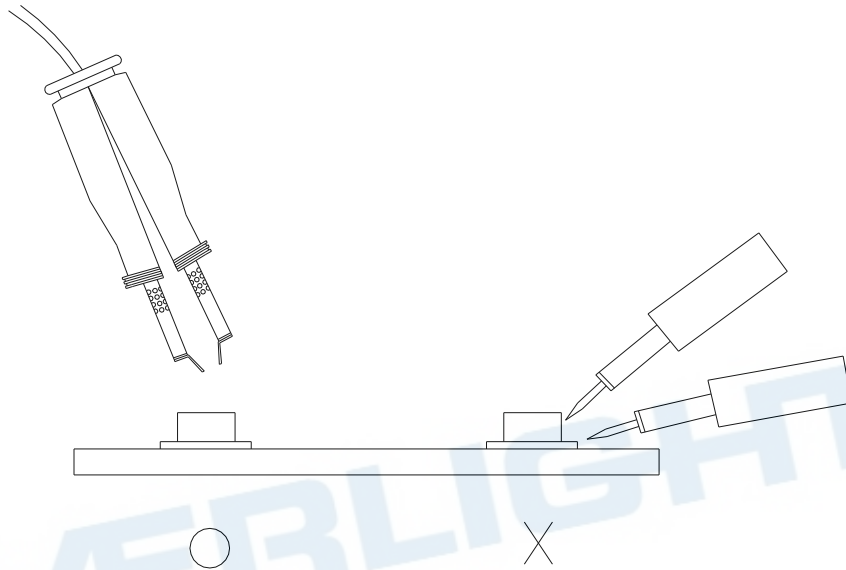
**6. Handling Indications**

During processing, mechanical stress on the surface should be minimized as much as possible. Sharp objects of all types should not be used to pierce the sealing compound

**EVERLIGHT ELECTRONICS CO., LTD.**

Office: No 25, Lane 76, Sec 3, Chung Yang Rd,  
Tucheng, Taipei 236, Taiwan, R.O.C

Tel: 886-2-2267-2000, 2267-9936

Fax: 886-2267-6244, 2267-6189, 2267-6306

<http://www.everlight.com>

## X-ON Electronics

Largest Supplier of Electrical and Electronic Components

*Click to view similar products for [Standard LEDs - SMD category](#):*

*Click to view products by [Everlight manufacturer](#):*

Other Similar products are found below :

[LTST-C190KYKT](#) [LTST-C19GD2WT](#) [LTST-N683GBEW](#) [LTW-170ZDC](#) [LTW-M140SZS40](#) [598-8110-100F](#) [598-8170-100F](#) [598-8610-202F](#) [AAAF5060QBFSEEZGS](#) [HLMA-QG00-S0021](#) [ALMD-LB36-SV002](#) [APT1608QGW](#) [EAST2012YA0](#) [EASV1803BA0](#) [LG M67K-H1J2-24-0-2-R18-Z](#) [SML-512VWT86A](#) [SML-LX0606SISUGC/A](#) [SML-LXL1307SRC-TR](#) [SML-LXR851SIUPGUBC](#) [LT1ED53A](#) [AM27ZGC03](#) [APB3025SGNC](#) [APFA3010SURKCGKQBDC](#) [APHK1608VGCA](#) [APT2012QGW](#) [CLX6D-FKB-CN1R1H1BB7D3D3](#) [LTST-008BGEW](#) [LTST-C250KGKT](#) [LTW-010DCG](#) [LTW-020ZDCG](#) [LTW-21TS5](#) [LTW-220DS5](#) [598-8330-117F](#) [SML-LX0402IC-TR](#) [CMDA20AYAA7D1S](#) [CMDA16AYDR7A1X](#) [91-21SYGD/S530-E2/TR7](#) [HSMQ-C177](#) [598-8040-100F](#) [598-8070-100F](#) [598-8140-100F](#) [598-8610-200F](#) [EAST2012GA0](#) [EAPL3527GA5](#) [SML-LXL1209SYC/ATR](#) [EAST2012RA0](#) [EAST1608RGBAO](#) [CMD91-21VRC/TR7](#) [SML-LXR851SGSIC-TR](#) [SML-512PWT86A](#)