



## MOS RELAY EPR SERIES

 E236930, 
  E155181(R)

### FEATURES

- No EMI/RFI generation
- High reliability
- No moving parts
- Low drive power requirement (TTL/CMOS compatible)
- Low On-state resistance
- High isolation voltage
- Arc-free with no snubbing circuits
- Machine insertable or wave solderable

### APPLICATIONS

- Telecommunications
- Instrumentation
- Medical equipment
- Security
- Industrial control

### PART NUMBER SYSTEM

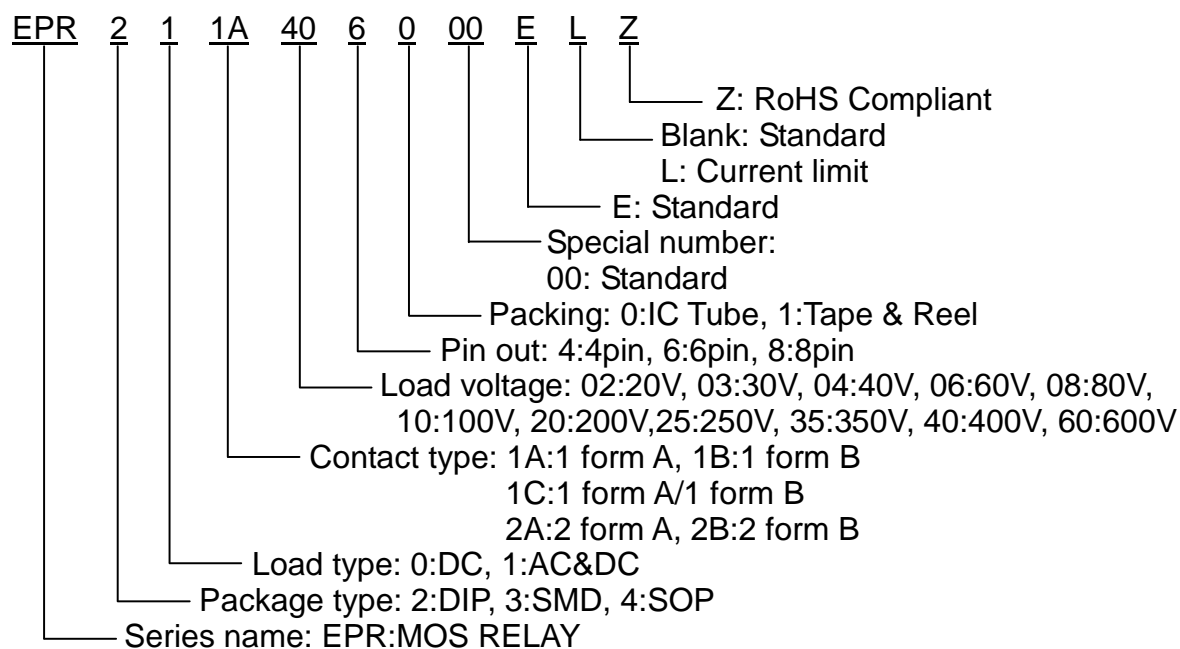

DIP TYPE



SMD TYPE



SOP TYPE





## MARKING SYSTEM

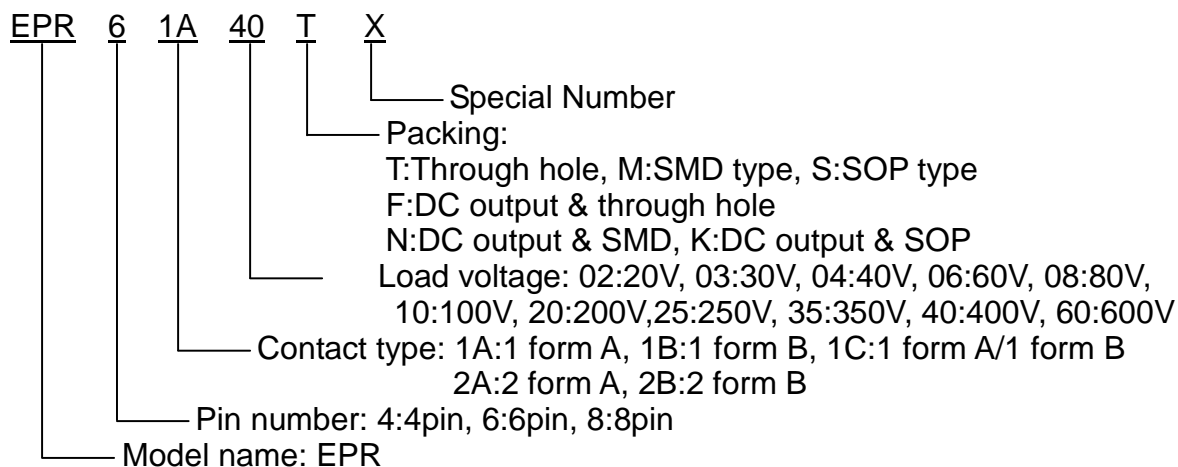

## CIRCUIT DIAGRAM

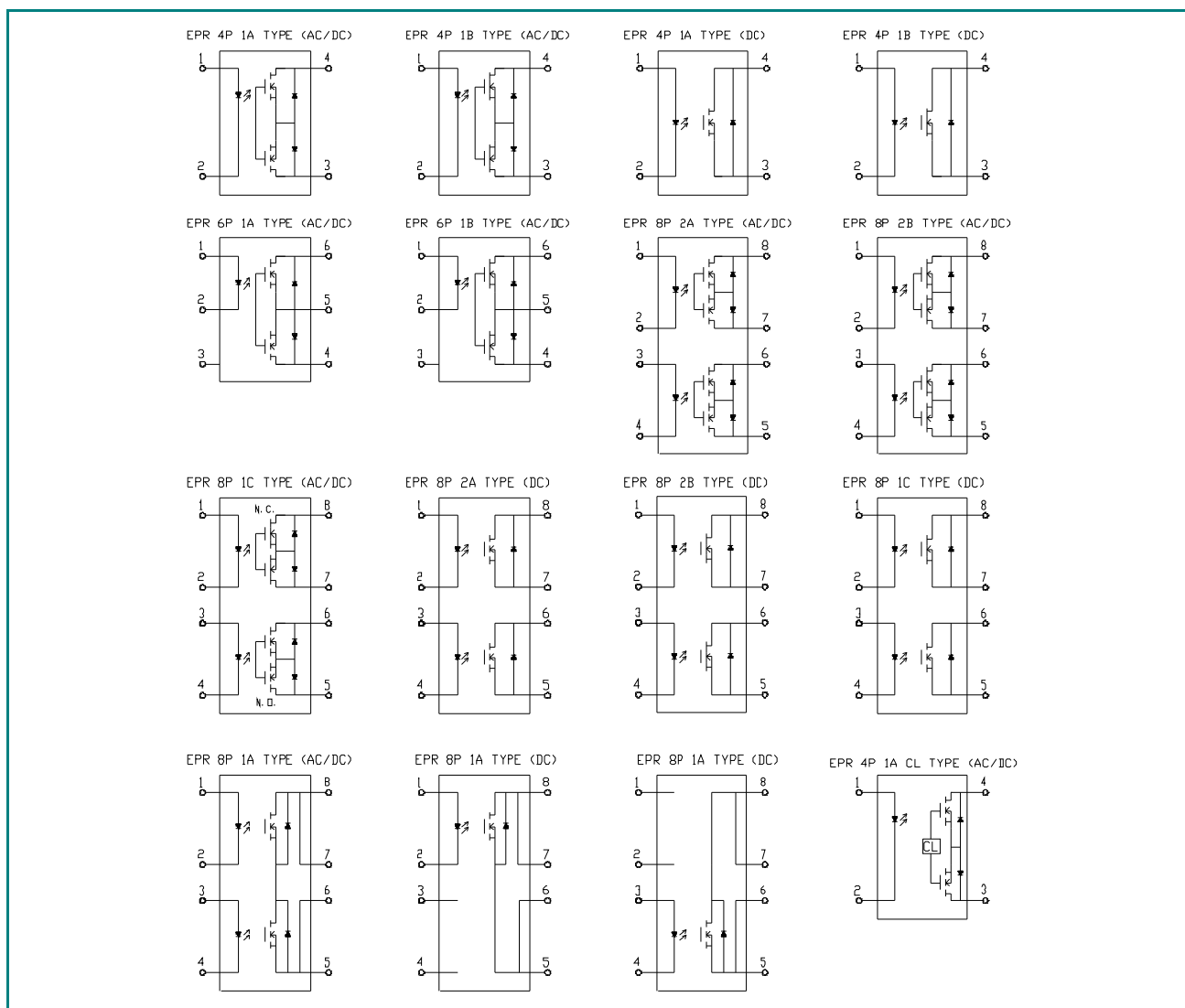



## OPTIONS

SMD Type  
TAPE & REEL Package

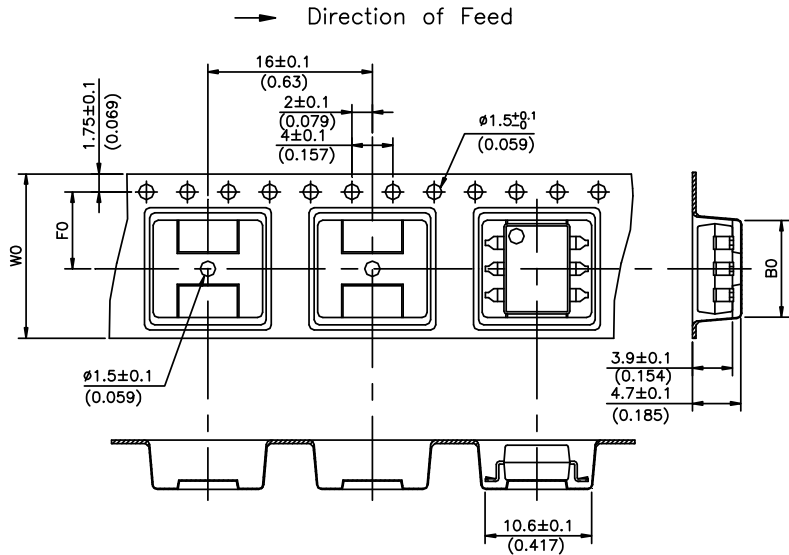
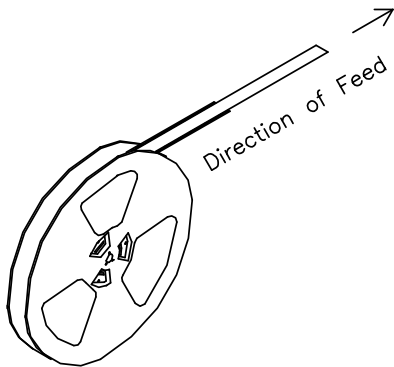

UNIT: mm(inch)

| TYPE | B0±0.1      | F0±0.1      | W0±0.3    | 15"REEL/PCS |
|------|-------------|-------------|-----------|-------------|
| 4P   | 5.3(0.209)  | 7.5(0.295)  | 16(0.630) | 1000        |
| 6P   | 9.4(0.370)  | 7.5(0.295)  | 16(0.630) | 1000        |
| 8P   | 10.3(0.406) | 11.5(0.453) | 24(0.945) | 1000        |

SOP Type  
TAPE & REEL Package

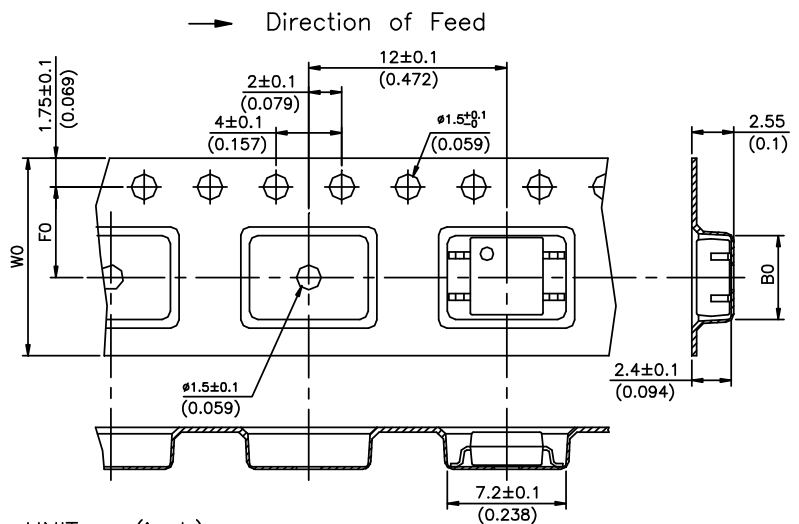
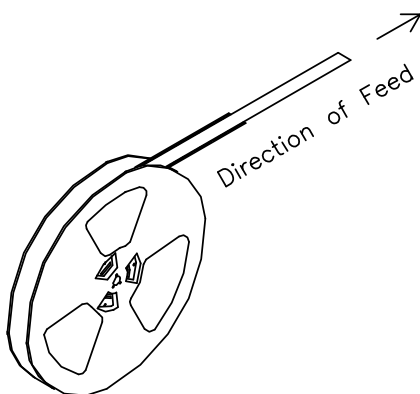

UNIT:mm(inch)

| TYPE | B0±0.1     | F0±0.1     | W0±0.3    | 13"REEL/PCS |
|------|------------|------------|-----------|-------------|
| 4P   | 5.1(0.200) | 5.5(0.217) | 12(0.472) | 2000        |
| 6P   | 6.7(0.264) | 7.5(0.295) | 16(0.630) | 2000        |
| 8P   | 9.6(0.378) | 7.5(0.295) | 16(0.630) | 2000        |



**■ DIMENSIONS UNIT:mm(inch)**

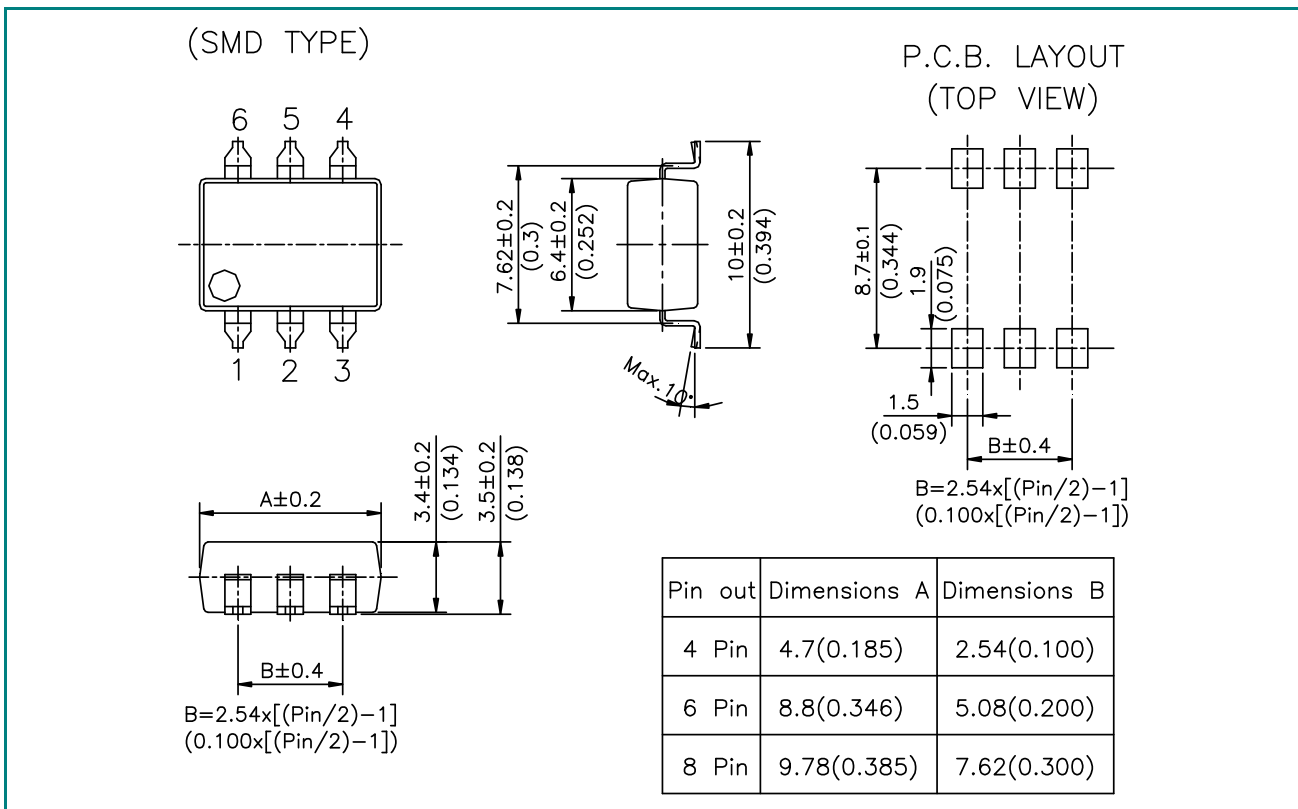
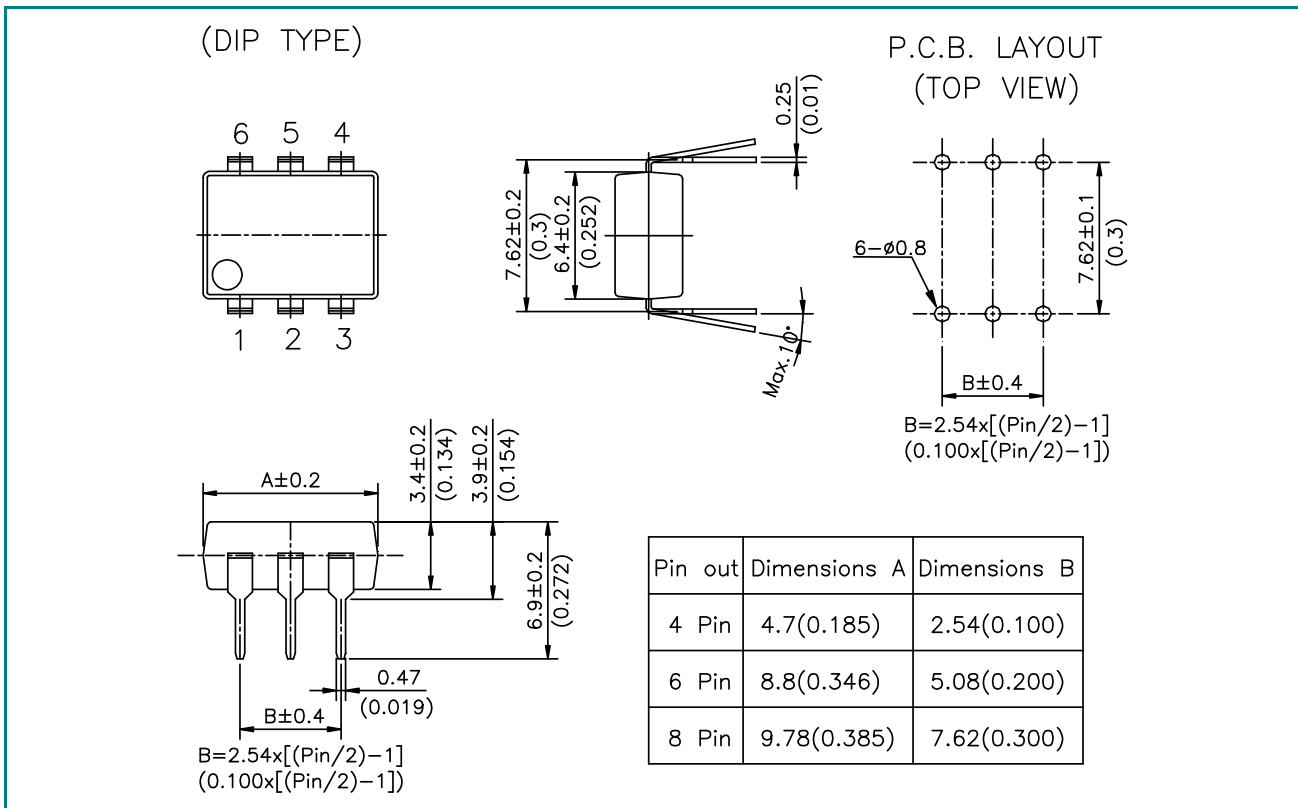



(SOP TYPE)

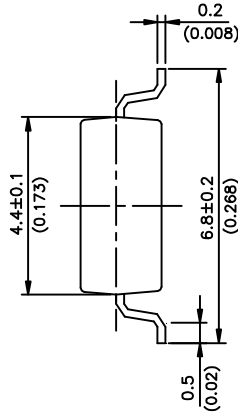
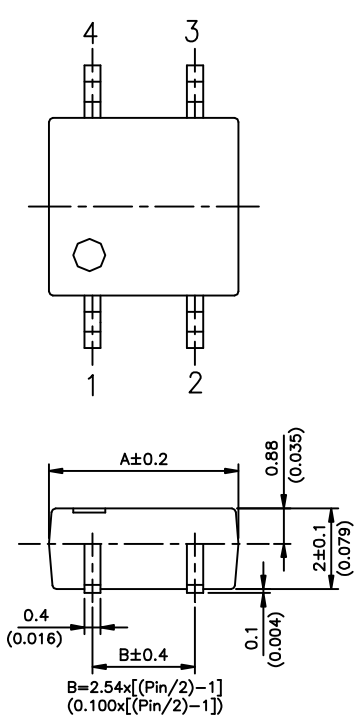

P.C.B. LAYOUT (TOP VIEW)

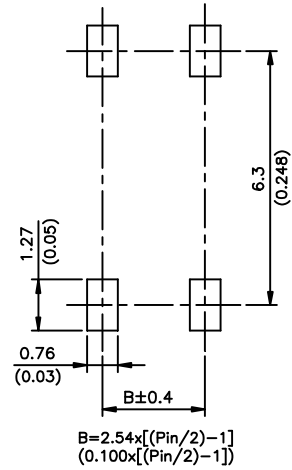

| Pin out | Dimensions A | Dimensions B |
|---------|--------------|--------------|
| 4 Pin   | 4.7(0.185)   | 2.54(0.100)  |
| 6 Pin   | 6.30(0.248)  | 5.08(0.200)  |
| 8 Pin   | 9.3(0.366)   | 7.62(0.300)  |



## ■ SPECIFICATIONS (@25°C / Initial):

| Part Number<br>(4 PIN)<br>(6 PIN)<br>(8 PIN)        | DIP                          | EPR                               | 211A024005 | 211A034005 | 211A064000 | 211A064001 | 211A064002 |
|---|------------------------------|-----------------------------------|------------|------------|------------|------------|------------|
|   | SMD                          |                                   | 211A026005 | 211A036005 | 211A066000 | 211A066001 | 211A066002 |
|   |                              |                                   | 212A028005 | 212A038005 | 212A068000 | 212A068001 | 212A068002 |
|   |                              |                                   | 311A024X05 | 311A034X05 | 311A064X00 | 311A064X01 | 311A064X02 |
|   |                              |                                   | 311A026X05 | 311A036X05 | 311A066X00 | 311A066X01 | 311A066X02 |
|   |                              |                                   | 312A028X05 | 312A038X05 | 312A068X00 | 312A068X01 | 312A068X02 |
|   |                              |                                   | 411A024X05 | 411A034X05 | 411A064X00 | 411A064X01 | 411A064X02 |
|   |                              |                                   | 411A026X05 | 411A036X05 | 411A066X00 | 411A066X01 | 411A066X02 |
|   |                              |                                   | 412A028X05 | 412A038X05 | 412A068X00 | 412A068X01 | 412A068X02 |
| Contact form  | 4PIN / 6PIN                  |                                   | 1A         | 1A         | 1A         | 1A         | 1A         |
|   | 8PIN                         |                                   | 2A         | 2A         | 2A         | 2A         | 2A         |
| Input Characteristics                               |                              |                                   |            |            |            |            |            |
| Forward voltage (V)(V <sub>F</sub> )                |                              |                                   | 0.9-1.5    | 0.9-1.5    | 0.9-1.5    | 0.9-1.5    | 0.9-1.5    |
| Reverse voltage at 10μA (V)(V <sub>R</sub> )        |                              |                                   | 5          | 5          | 5          | 5          | 5          |
| Control current (mA)(I <sub>F</sub> )               |                              |                                   | 10-50      | 10-50      | 5-50       | 5-50       | 5-50       |
| Output Characteristics                              |                              |                                   |            |            |            |            |            |
| Load voltage (V)(AC peak or DC)(V <sub>L</sub> )    |                              |                                   | 20         | 30         | 60         | 60         | 60         |
| Continuous rated load current (mA)(I <sub>L</sub> ) | SOP                          |                                   | 1500       | 1300       | 350        | 120        | 120        |
|   | SMD/DIP                      |                                   | 2000       | 1800       | 400        | 120        | 120        |
| Peak current (mA)(I <sub>L-Peak</sub> )             | SOP                          |                                   | 2500       | 2000       | 600        | 250        | 250        |
|   | SMD/DIP                      |                                   | 2500       | 2000       | 700        | 250        | 250        |
| On-state resistance Max. (Ω)(R <sub>ON</sub> )      |                              |                                   | 0.5        | 0.5        | 1.4        | 16         | 8          |
| Off-state leakage current (μA) (I <sub>LK</sub> )   |                              |                                   | 1          | 1          | 1          | 1          | 1          |
| Turn-on (msec)(T <sub>ON</sub> )                    |                              |                                   | 5          | 5          | 1          | 1.5        | 1.5        |
| Turn-off (msec)(T <sub>OFF</sub> )                  |                              |                                   | 2          | 2          | 1          | 1          | 1          |
| Capacitance (pF)(C <sub>OUT</sub> )                 |                              |                                   | 400        | 300        | 150        | 25         | 25         |
| Current limit typ. (mA)                             |                              |                                   | ---        | ---        | ---        | ---        | ---        |
| Input / Output Characteristics                      |                              |                                   |            |            |            |            |            |
| I/O Capacitance (pF)(C <sub>I/O</sub> )             |                              |                                   | 5          | 5          | 5          | 5          | 5          |
| I/O Isolation voltage (VAC)(V <sub>I/O</sub> )      | SOP                          |                                   | 1500       | 1500       | 1500       | 1500       | 1500       |
|   | SMD/DIP                      |                                   | 2500       | 2500       | 3750       | 3750       | 3750       |
| I/O Isolation resistance (GΩ)(R <sub>I/O</sub> )    |                              |                                   | 5          | 5          | 5          | 5          | 5          |
| Temperature limits                                  | Operating (T <sub>OP</sub> ) | -40°C to +85°C (-40°F to +185°F)  |            |            |            |            |            |
|   | Storage (T <sub>STG</sub> )  | -40°C to +100°C (-40°F to +212°F) |            |            |            |            |            |



|   |                              |     |                                   |            |            |            |            |
|---|------------------------------|-----|-----------------------------------|------------|------------|------------|------------|
| Part Number<br>(4 PIN)<br>(6 PIN)<br>(8 PIN)        | DIP                          | EPR | 211A064005                        | 211A064009 | 211A084000 | 211A084009 | 211A104000 |
|   |                              |     | 211A066005                        | 211A066009 | 211A086000 | 211A086009 | 211A106000 |
|   |                              |     | 212A068005                        | 212A068009 | 212A088000 | 212A088009 | 212A108000 |
|   | SMD                          |     | 311A064X05                        | 311A064X09 | 311A084X00 | 311A084X09 | 311A104X00 |
|   |                              |     | 311A066X05                        | 311A066X09 | 311A086X00 | 311A086X09 | 311A106X00 |
|   |                              |     | 312A068X05                        | 312A068X09 | 312A088X00 | 312A088X09 | 312A108X00 |
|   | SOP                          |     | 411A064X05                        | 411A064X09 | 411A084X00 | 411A084X09 | 411A104X00 |
|   |                              |     | 411A066X05                        | 411A066X09 | 411A086X00 | 411A086X09 | 411A106X00 |
|   |                              |     | 412A068X05                        | 412A068X09 | 412A088X00 | 412A088X09 | 412A108X00 |
| Contact form  | 4PIN / 6PIN                  |     | 1A                                | 1A         | 1A         | 1A         | 1A         |
|   | 8PIN                         |     | 2A                                | 2A         | 2A         | 2A         | 2A         |
| Input Characteristics                               |                              |     |                                   |            |            |            |            |
| Forward voltage (V)(V <sub>F</sub> )                |                              |     | 0.9-1.5                           | 0.9-1.5    | 0.9-1.5    | 0.9-1.5    | 0.9-1.5    |
| Reverse voltage at 10μA (V)(V <sub>R</sub> )        |                              |     | 5                                 | 5          | 5          | 5          | 5          |
| Control current (mA)(I <sub>F</sub> )               |                              |     | 10-50                             | 5-50       | 5-50       | 5-50       | 5-50       |
| Output Characteristics                              |                              |     |                                   |            |            |            |            |
| Load voltage (V)(AC peak or DC)(V <sub>L</sub> )    |                              |     | 60                                | 60         | 80         | 80         | 100        |
| Continuous rated load current (mA)(I <sub>L</sub> ) | SOP                          |     | 900                               | 350        | 120        | 120        | 120        |
|   | SMD/DIP                      |     | 1100                              | 400        | 120        | 120        | 120        |
| Peak current (mA)(I <sub>L-Peak</sub> )             | SOP                          |     | 1500                              | 600        | 250        | 250        | 250        |
|   | SMD/DIP                      |     | 1500                              | 700        | 250        | 250        | 250        |
| On-state resistance Max. (Ω)(R <sub>ON</sub> )      |                              |     | 0.7                               | 1.4        | 12         | 12         | 12         |
| Off-state leakage current (μA) (I <sub>LK</sub> )   |                              |     | 1                                 | 1          | 1          | 1          | 1          |
| Turn-on (msec)(T <sub>ON</sub> )                    |                              |     | 5                                 | 1          | 1          | 1          | 1          |
| Turn-off (msec)(T <sub>OFF</sub> )                  |                              |     | 2                                 | 1          | 1          | 1          | 1          |
| Capacitance (pF)(C <sub>OUT</sub> )                 |                              |     | 300                               | 150        | 25         | 25         | ---        |
| Current limit typ. (mA)                             |                              |     | ---                               | ---        | ---        | ---        | ---        |
| Input / Output Characteristics                      |                              |     |                                   |            |            |            |            |
| I/O Capacitance (pF)(C <sub>I/O</sub> )             |                              |     | 5                                 | 5          | 5          | 5          | 5          |
| I/O Isolation voltage (VAC)(V <sub>I/O</sub> )      | SOP                          |     | 1500                              | 2500       | 1500       | 2500       | 1500       |
|   | SMD/DIP                      |     | 2500                              | 5000       | 3750       | 5000       | 3750       |
| I/O Isolation resistance (GΩ)(R <sub>I/O</sub> )    |                              |     | 5                                 | 5          | 5          | 5          | 5          |
| Temperature limits                                  | Operating (T <sub>OP</sub> ) |     | -40°C to +85°C (-40°F to +185°F)  |            |            |            |            |
|   | Storage (T <sub>STG</sub> )  |     | -40°C to +100°C (-40°F to +212°F) |            |            |            |            |



|   |                              |     |                                   |            |            |            |            |
|---|------------------------------|-----|-----------------------------------|------------|------------|------------|------------|
| Part Number<br>(4 PIN)<br>(6 PIN)<br>(8 PIN)        | DIP                          | EPR | 211A204000                        | 211A204009 | 211A254000 | 211A254002 | 211A254009 |
|   |                              |     | 211A206000                        | 211A206009 | 211A256000 | 211A256002 | 211A256009 |
|   |                              |     | 212A208000                        | 212A208009 | 212A258000 | 212A258002 | 212A258009 |
|   | SMD                          |     | 311A204X00                        | 311A204X09 | 311A254X00 | 311A254X02 | 311A254X09 |
|   |                              |     | 311A206X00                        | 311A206X09 | 311A256X00 | 311A256X02 | 311A256X09 |
|   |                              |     | 312A208X00                        | 312A208X09 | 312A258X00 | 312A258X02 | 312A258X09 |
|   | SOP                          |     | 411A204X00                        | 411A204X09 | 411A254X00 | 411A254X02 | 411A254X09 |
|   |                              |     | 411A206X00                        | 411A206X09 | 411A256X00 | 411A256X02 | 411A256X09 |
|   |                              |     | 412A208X00                        | 412A208X09 | 412A258X00 | 412A258X02 | 412A258X09 |
| Contact form  | 4PIN / 6PIN                  |     | 1A                                | 1A         | 1A         | 1A         | 1A         |
|   | 8PIN                         |     | 2A                                | 2A         | 2A         | 2A         | 2A         |
| Input Characteristics                               |                              |     |                                   |            |            |            |            |
| Forward voltage (V)(V <sub>F</sub> )                |                              |     | 0.9-1.5                           | 0.9-1.5    | 0.9-1.5    | 0.9-1.5    | 0.9-1.5    |
| Reverse voltage at 10μA (V)(V <sub>R</sub> )        |                              |     | 5                                 | 5          | 5          | 5          | 5          |
| Control current (mA)(I <sub>F</sub> )               |                              |     | 5-50                              | 5-50       | 5-50       | 5-50       | 5-50       |
| Output Characteristics                              |                              |     |                                   |            |            |            |            |
| Load voltage (V)(AC peak or DC)(V <sub>L</sub> )    |                              |     | 200                               | 200        | 250        | 250        | 250        |
| Continuous rated load current (mA)(I <sub>L</sub> ) | SOP                          |     | 150                               | 150        | 140        | 140        | 140        |
|   | SMD/DIP                      |     | 200                               | 200        | 180        | 200        | 180        |
| Peak current (mA)(I <sub>L-Peak</sub> )             | SOP                          |     | 300                               | 300        | 300        | 300        | 300        |
|   | SMD/DIP                      |     | 400                               | 400        | 350        | 350        | 350        |
| On-state resistance Max. (Ω)(R <sub>ON</sub> )      |                              |     | 10                                | 10         | 10         | 8          | 10         |
| Off-state leakage current (μA) (I <sub>LK</sub> )   |                              |     | 1                                 | 1          | 1          | 1          | 1          |
| Turn-on (msec)(T <sub>ON</sub> )                    |                              |     | 1                                 | 1          | 1          | 1          | 1          |
| Turn-off (msec)(T <sub>OFF</sub> )                  |                              |     | 1                                 | 1          | 1          | 1          | 1          |
| Capacitance (pF)(C <sub>OUT</sub> )                 |                              |     | 100                               | 100        | 100        | ---        | 100        |
| Current limit typ. (mA)                             |                              |     | ---                               | ---        | ---        | ---        | ---        |
| Input / Output Characteristics                      |                              |     |                                   |            |            |            |            |
| I/O Capacitance (pF)(C <sub>I/O</sub> )             |                              |     | 5                                 | 5          | 5          | 5          | 5          |
| I/O Isolation voltage (VAC)(V <sub>I/O</sub> )      | SOP                          |     | 1500                              | 2500       | 1500       | 1500       | 2500       |
|   | SMD/DIP                      |     | 3750                              | 5000       | 3750       | 3750       | 5000       |
| I/O Isolation resistance (GΩ)(R <sub>I/O</sub> )    |                              |     | 5                                 | 5          | 5          | 5          | 5          |
| Temperature limits                                  | Operating (T <sub>OP</sub> ) |     | -40°C to +85°C (-40°F to +185°F)  |            |            |            |            |
|   | Storage (T <sub>STG</sub> )  |     | -40°C to +100°C (-40°F to +212°F) |            |            |            |            |





|   |                              |                                   |            |            |            |            |  |
|---|------------------------------|-----------------------------------|------------|------------|------------|------------|--|
| Part Number<br>(4 PIN)<br>(6 PIN)<br>(8 PIN)        | DIP                          | EPR                               | 211A354000 | 211A354001 | 211A354002 | 211A354009 |  |
|   | SMD                          |                                   | 211A356000 | 211A356001 | 211A356002 | 211A356009 |  |
|   |                              |                                   | 212A358000 | 212A358001 | 212A358002 | 212A358009 |  |
|   | SOP                          | 311A354X00                        | 311A354X01 | 311A354X02 | 311A354X09 |            |  |
|   |                              | 311A356X00                        | 311A356X01 | 311A356X02 | 311A356X09 |            |  |
|   |                              | 312A358X00                        | 312A358X01 | 312A358X02 | 312A358X09 |            |  |
| Contact form  | 4PIN / 6PIN                  |                                   | 1A         | 1A         | 1A         | 1A         |  |
|   | 8PIN                         |                                   | 2A         | 2A         | 2A         | 2A         |  |
| Input Characteristics                               |                              |                                   |            |            |            |            |  |
| Forward voltage (V)(V <sub>F</sub> )                |                              |                                   | 0.9-1.5    | 0.9-1.5    | 0.9-1.5    | 0.9-1.5    |  |
| Reverse voltage at 10μA (V)(V <sub>R</sub> )        |                              |                                   | 5          | 5          | 5          | 5          |  |
| Control current (mA)(I <sub>F</sub> )               |                              |                                   | 5-50       | 5-50       | 5-50       | 5-50       |  |
| Output Characteristics                              |                              |                                   |            |            |            |            |  |
| Load voltage (V)(AC peak or DC)(V <sub>L</sub> )    |                              |                                   | 350        | 350        | 350        | 350        |  |
| Continuous rated load current (mA)(I <sub>L</sub> ) | SOP                          |                                   | 100        | 80         | 130        | 100        |  |
|   | SMD/DIP                      |                                   | 130        | 100        | 170        | 130        |  |
| Peak current (mA)(I <sub>L-Peak</sub> )             | SOP                          |                                   | 300        | 200        | 300        | 300        |  |
|   | SMD/DIP                      |                                   | 300        | 250        | 300        | 300        |  |
| On-state resistance Max. (Ω)(R <sub>ON</sub> )      |                              |                                   | 30         | 50         | 16         | 30         |  |
| Off-state leakage current (μA) (I <sub>LK</sub> )   |                              |                                   | 1          | 1          | 1          | 1          |  |
| Turn-on (msec)(T <sub>ON</sub> )                    |                              |                                   | 1          | 1.5        | 1          | 1          |  |
| Turn-off (msec)(T <sub>OFF</sub> )                  |                              |                                   | 1          | 1          | 1          | 1          |  |
| Capacitance (pF)(C <sub>OUT</sub> )                 |                              |                                   | 100        | ---        | 200        | ---        |  |
| Current limit typ. (mA)                             |                              |                                   | ---        | ---        | ---        | ---        |  |
| Input / Output Characteristics                      |                              |                                   |            |            |            |            |  |
| I/O Capacitance (pF)(C <sub>I/O</sub> )             |                              |                                   | 5          | 5          | 5          | 5          |  |
| I/O Isolation voltage (VAC)(V <sub>I/O</sub> )      | SOP                          |                                   | 1500       | 1500       | 1500       | 2500       |  |
|   | SMD/DIP                      |                                   | 3750       | 3750       | 3750       | 5000       |  |
| I/O Isolation resistance (GΩ)(R <sub>I/O</sub> )    |                              |                                   | 5          | 5          | 5          | 5          |  |
| Temperature limits                                  | Operating (T <sub>OP</sub> ) | -40°C to +85°C (-40°F to +185°F)  |            |            |            |            |  |
|   | Storage (T <sub>STG</sub> )  | -40°C to +100°C (-40°F to +212°F) |            |            |            |            |  |



|   |                              |     |                                   |            |            |            |            |
|---|------------------------------|-----|-----------------------------------|------------|------------|------------|------------|
| Part Number<br>(4 PIN)<br>(6 PIN)<br>(8 PIN)        | DIP                          | EPR | 211A404000                        | 211A404002 | 211A404009 | 211A604000 | 211A604009 |
|   |                              |     | 211A406000                        | 211A406002 | 211A406009 | 211A606000 | 211A606009 |
|   |                              |     | 212A408000                        | 212A408002 | 212A408009 | 212A608000 | 212A608009 |
|   | SMD                          |     | 311A404X00                        | 311A404X02 | 311A404X09 | 311A604X00 | 311A604X09 |
|   |                              |     | 311A406X00                        | 311A406X02 | 311A406X09 | 311A606X00 | 311A606X09 |
|   |                              |     | 312A408X00                        | 312A408X02 | 312A408X09 | 312A608X00 | 312A608X09 |
|   | SOP                          |     | 411A404X00                        | 411A404X02 | 411A404X09 | 411A604X00 | 411A604X09 |
|   |                              |     | 411A406X00                        | 411A406X02 | 411A406X09 | 411A606X00 | 411A606X09 |
|   |                              |     | 412A408X00                        | 412A408X02 | 412A408X09 | 412A608X00 | 412A608X09 |
| Contact form  | 4PIN / 6PIN                  |     | 1A                                | 1A         | 1A         | 1A         | 1A         |
|   | 8PIN                         |     | 2A                                | 2A         | 2A         | 2A         | 2A         |
| Input Characteristics                               |                              |     |                                   |            |            |            |            |
| Forward voltage (V)(V <sub>F</sub> )                |                              |     | 0.9-1.5                           | 0.9-1.5    | 0.9-1.5    | 0.9-1.5    | 0.9-1.5    |
| Reverse voltage at 10μA (V)(V <sub>R</sub> )        |                              |     | 5                                 | 5          | 5          | 5          | 5          |
| Control current (mA)(I <sub>F</sub> )               |                              |     | 5-50                              | 5-50       | 5-50       | 5-50       | 5-50       |
| Output Characteristics                              |                              |     |                                   |            |            |            |            |
| Load voltage (V)(AC peak or DC)(V <sub>L</sub> )    |                              |     | 400                               | 400        | 400        | 600        | 600        |
| Continuous rated load current (mA)(I <sub>L</sub> ) | SOP                          |     | 100                               | 120        | 100        | 50         | 50         |
|   | SMD/DIP                      |     | 130                               | 150        | 130        | 70         | 70         |
| Peak current (mA)(I <sub>L-Peak</sub> )             | SOP                          |     | 250                               | 300        | 250        | 100        | 100        |
|   | SMD/DIP                      |     | 300                               | 300        | 300        | 120        | 120        |
| On-state resistance Max. (Ω)(R <sub>ON</sub> )      |                              |     | 30                                | 16         | 30         | 70         | 70         |
| Off-state leakage current (μA) (I <sub>LK</sub> )   |                              |     | 1                                 | 1          | 1          | 1          | 1          |
| Turn-on (msec)(T <sub>ON</sub> )                    |                              |     | 1                                 | 1          | 1          | 1          | 1          |
| Turn-off (msec)(T <sub>OFF</sub> )                  |                              |     | 1                                 | 1          | 1          | 1          | 1          |
| Capacitance (pF)(C <sub>OUT</sub> )                 |                              |     | 70                                | ---        | 70         | 100        | 100        |
| Current limit typ. (mA)                             |                              |     | ---                               | ---        | ---        | ---        | ---        |
| Input / Output Characteristics                      |                              |     |                                   |            |            |            |            |
| I/O Capacitance (pF)(C <sub>I/O</sub> )             |                              |     | 5                                 | 5          | 5          | 5          | 5          |
| I/O Isolation voltage (VAC)(V <sub>I/O</sub> )      | SOP                          |     | 1500                              | 1500       | 2500       | 1500       | 2500       |
|   | SMD/DIP                      |     | 3750                              | 3750       | 5000       | 3750       | 5000       |
| I/O Isolation resistance (GΩ)(R <sub>I/O</sub> )    |                              |     | 5                                 | 5          | 5          | 5          | 5          |
| Temperature limits                                  | Operating (T <sub>OP</sub> ) |     | -40°C to +85°C (-40°F to +185°F)  |            |            |            |            |
|   | Storage (T <sub>STG</sub> )  |     | -40°C to +100°C (-40°F to +212°F) |            |            |            |            |



|   |                              |     |   |            |            |            |
|---|------------------------------|-----|---|------------|------------|------------|
| Part Number<br>(4 PIN)<br>(6 PIN)<br>(8 PIN)              | DIP                          | EPR | 211B064000  | 211B064009 | 211B204000 | 211B204009 |
|   |                              |     | 211B066000  | 211B066009 | 211B206000 | 211B206009 |
|   |                              |     | 212B068000  | 212B068009 | 212B208000 | 212B208009 |
|   | SMD                          |     | 311B064X00  | 311B064X09 | 311B204X00 | 311B204X09 |
|   |                              |     | 311B066X00  | 311B066X09 | 311B206X00 | 311B206X09 |
|   |                              |     | 312B068X00  | 312B068X09 | 312B208X00 | 312B208X09 |
|   | SOP                          |     | 411B064X00  | 411B064X09 | 411B204X00 | 411B204X09 |
|   |                              |     | 411B066X00  | 411B066X09 | 411B206X00 | 411B206X09 |
|   |                              |     | 412B068X00  | 412B068X09 | 412B208X00 | 412B208X09 |
| Contact form  | 4PIN / 6PIN                  |     | 1B  | 1B         | 1B         | 1B         |
|   | 8PIN                         |     | 2B  | 2B         | 2B         | 2B         |
| Input Characteristics                                     |                              |     |   |            |            |            |
| Forward voltage (V)(V <sub>F</sub> )                      |                              |     | 0.9-1.5   | 0.9-1.5    | 0.9-1.5    | 0.9-1.5    |
| Reverse voltage at 10 $\mu$ A (V)(V <sub>R</sub> )        |                              |     | 5   | 5          | 5          | 5          |
| Control current (mA)(I <sub>F</sub> )                     |                              |     | 5-50  | 5-50       | 5-50       | 5-50       |
| Output Characteristics                                    |                              |     |   |            |            |            |
| Load voltage (V)(AC peak or DC)(V <sub>L</sub> )          |                              |     | 60  | 60         | 200        | 200        |
| Continuous rated load current (mA)(I <sub>L</sub> )       | SOP                          |     | 100   | 100        | 80         | 80         |
|   | SMD/DIP                      |     | 100   | 100        | 100        | 100        |
| Peak current (mA)(I <sub>L-Peak</sub> )                   | SOP                          |     | 250   | 250        | 200        | 200        |
|   | SMD/DIP                      |     | 300   | 300        | 250        | 250        |
| On-state resistance Max. ( $\Omega$ )(R <sub>ON</sub> )   |                              |     | 6   | 6          | 50         | 50         |
| Off-state leakage current ( $\mu$ A) (I <sub>LK</sub> )   |                              |     | 10  | 10         | 10         | 10         |
| Turn-on (msec)(T <sub>ON</sub> )                          |                              |     | 1   | 1          | 1          | 1          |
| Turn-off (msec)(T <sub>OFF</sub> )                        |                              |     | 1   | 1          | 1          | 1          |
| Capacitance (pF)(C <sub>OUT</sub> )                       |                              |     | ---   | ---        | 200        | 200        |
| Current limit typ. (mA)                                   |                              |     | ---   | ---        | ---        | ---        |
| Input / Output Characteristics                            |                              |     |   |            |            |            |
| I/O Capacitance (pF)(C <sub>I/O</sub> )                   |                              |     | 5   | 5          | 5          | 5          |
| I/O Isolation voltage (VAC)(V <sub>I/O</sub> )            | SOP                          |     | 1500  | 2500       | 1500       | 2500       |
|   | SMD/DIP                      |     | 3750  | 5000       | 3750       | 5000       |
| I/O Isolation resistance (G $\Omega$ )(R <sub>I/O</sub> ) |                              |     | 5   | 5          | 5          | 5          |
| Temperature limits  | Operating (T <sub>OP</sub> ) |     | -40 $^{\circ}$ C to +85 $^{\circ}$ C (-40 $^{\circ}$ F to +185 $^{\circ}$ F)  |            |            |            |
|   | Storage (T <sub>STG</sub> )  |     | -40 $^{\circ}$ C to +100 $^{\circ}$ C (-40 $^{\circ}$ F to +212 $^{\circ}$ F) |            |            |            |



|   |                              |     |  |  |  |  |
|---|------------------------------|-----|--|--|--|--|
| Part Number<br>(4 PIN)<br>(6 PIN)<br>(8 PIN)        | DIP                          | EPR | 211B354000<br>211B356X00<br>212B358X00 | 211B354009<br>211B356X09<br>212B358X09 | 211B404000<br>211B406X00<br>212B408X00 | 211B404009<br>211B406X09<br>212B408X09 |
|   | SMD                          |     | 311B354000<br>311B356X00<br>312B358X00 | 311B354009<br>311B356X09<br>312B358X09 | 311B404000<br>311B406X00<br>312B408X00 | 311B404009<br>311B406X09<br>312B408X09 |
|   | SOP                          |     | 411B354000<br>411B356X00<br>412B358X00 | 411B354009<br>411B356X09<br>412B358X09 | 411B404000<br>411B406X00<br>412B408X00 | 411B404009<br>411B406X09<br>412B408X09 |
| Contact form  | 4PIN / 6PIN                  |     | 1B                                     | 1B                                     | 1B                                     | 1B                                     |
|   | 8PIN                         |     | 2B                                     | 2B                                     | 2B                                     | 2B                                     |
| Input Characteristics                               |                              |     |  |  |  |  |
| Forward voltage (V)(V <sub>F</sub> )                |                              |     | 0.9-1.5                                | 0.9-1.5                                | 0.9-1.5                                | 0.9-1.5                                |
| Reverse voltage at 10μA (V)(V <sub>R</sub> )        |                              |     | 5                                      | 5                                      | 5                                      | 5                                      |
| Control current (mA)(I <sub>F</sub> )               |                              |     | 5-50                                   | 5-50                                   | 5-50                                   | 5-50                                   |
| Output Characteristics                              |                              |     |  |  |  |  |
| Load voltage (V)(AC peak or DC)(V <sub>L</sub> )    |                              |     | 350                                    | 350                                    | 400                                    | 400                                    |
| Continuous rated load current (mA)(I <sub>L</sub> ) | SOP                          |     | 80                                     | 80                                     | 80                                     | 80                                     |
|   | SMD/DIP                      |     | 100                                    | 100                                    | 100                                    | 100                                    |
| Peak current (mA)(I <sub>L-Peak</sub> )             | SOP                          |     | 200                                    | 200                                    | 200                                    | 200                                    |
|   | SMD/DIP                      |     | 250                                    | 250                                    | 250                                    | 250                                    |
| On-state resistance Max. (Ω)(R <sub>ON</sub> )      |                              |     | 50                                     | 50                                     | 50                                     | 50                                     |
| Off-state leakage current (μA) (I <sub>LK</sub> )   |                              |     | 10                                     | 10                                     | 10                                     | 10                                     |
| Turn-on (msec)(T <sub>ON</sub> )                    |                              |     | 1                                      | 1                                      | 1                                      | 1                                      |
| Turn-off (msec)(T <sub>OFF</sub> )                  |                              |     | 1                                      | 1                                      | 1                                      | 1                                      |
| Capacitance (pF)(C <sub>OUT</sub> )                 |                              |     | 200                                    | 200                                    | 200                                    | 200                                    |
| Current limit typ. (mA)                             |                              |     | ---                                    | ---                                    | ---                                    | ---                                    |
| Input / Output Characteristics                      |                              |     |  |  |  |  |
| I/O Capacitance (pF)(C <sub>I/O</sub> )             |                              |     | 5                                      | 5                                      | 5                                      | 5                                      |
| I/O Isolation voltage (VAC)(V <sub>I/O</sub> )      | SOP                          |     | 1500                                   | 2500                                   | 1500                                   | 2500                                   |
|   | SMD/DIP                      |     | 3750                                   | 5000                                   | 3750                                   | 5000                                   |
| I/O Isolation resistance (GΩ)(R <sub>I/O</sub> )    |                              |     | 5                                      | 5                                      | 5                                      | 5                                      |
| Temperature limits                                  | Operating (T <sub>OP</sub> ) |     | -40°C to +85°C (-40°F to +185°F)       |  |  |  |
|   | Storage (T <sub>STG</sub> )  |     | -40°C to +100°C (-40°F to +212°F)      |  |  |  |



| Part Number<br>(4 PIN)<br>(6 PIN)<br>(8 PIN)        | DIP                          | EPR                               | -----<br>211C068000 |         | -----<br>211C068009 |         | -----<br>211C208000 |         | -----<br>211C208009 |  |
|---|------------------------------|-----------------------------------|---------------------|---------|---------------------|---------|---------------------|---------|---------------------|--|
|   | SMD                          |                                   | -----<br>311C068X00 |         | -----<br>311C068X09 |         | -----<br>311C208X00 |         | -----<br>311C208X09 |  |
|   | SOP                          |                                   | -----<br>411C068X00 |         | -----<br>411C068X09 |         | -----<br>411C208X00 |         | -----<br>411C208X09 |  |
| Contact form  | 4PIN / 6PIN                  | ---                               |                     | ---     |                     | ---     |                     | ---     |                     |  |
|   | 8PIN                         | 1A                                | 1B                  | 1A      | 1B                  | 1A      | 1B                  | 1A      | 1B                  |  |
| Input Characteristics                               |                              |                                   |                     |         |                     |         |                     |         |                     |  |
| Forward voltage (V)(V <sub>F</sub> )                |                              | 0.9-1.5                           |                     | 0.9-1.5 |                     | 0.9-1.5 |                     | 0.9-1.5 |                     |  |
| Reverse voltage at 10μA (V)(V <sub>R</sub> )        |                              | 5                                 |                     | 5       |                     | 5       |                     | 5       |                     |  |
| Control current (mA)(I <sub>F</sub> )               |                              | 5-50                              |                     | 5-50    |                     | 5-50    |                     | 5-50    |                     |  |
| Output Characteristics                              |                              |                                   |                     |         |                     |         |                     |         |                     |  |
| Load voltage (V)(AC peak or DC)(V <sub>L</sub> )    |                              | 60                                | 60                  | 60      | 60                  | 200     | 200                 | 200     | 200                 |  |
| Continuous rated load current (mA)(I <sub>L</sub> ) | SOP                          | 350                               | 100                 | 350     | 100                 | 150     | 80                  | 150     | 80                  |  |
|   | SMD/DIP                      | 400                               | 100                 | 400     | 100                 | 200     | 100                 | 200     | 100                 |  |
| Peak current (mA)(I <sub>L-Peak</sub> )             | SOP                          | 600                               | 250                 | 600     | 250                 | 300     | 200                 | 300     | 200                 |  |
|   | SMD/DIP                      | 700                               | 300                 | 700     | 300                 | 400     | 250                 | 400     | 250                 |  |
| On-state resistance Max. (Ω)(R <sub>ON</sub> )      |                              | 1.4                               | 6                   | 1.4     | 6                   | 10      | 50                  | 10      | 50                  |  |
| Off-state leakage current (μA) (I <sub>LK</sub> )   |                              | 1                                 | 10                  | 1       | 10                  | 1       | 10                  | 1       | 10                  |  |
| Turn-on (msec)(T <sub>ON</sub> )                    |                              | 1                                 | 1                   | 1       | 1                   | 1       | 1                   | 1       | 1                   |  |
| Turn-off (msec)(T <sub>OFF</sub> )                  |                              | 1                                 | 1                   | 1       | 1                   | 1       | 1                   | 1       | 1                   |  |
| Capacitance (pF)(C <sub>OUT</sub> )                 |                              | 150                               | ---                 | 150     | ---                 | 100     | 200                 | 100     | 200                 |  |
| Current limit typ. (mA)                             |                              | ---                               | ---                 | ---     | ---                 | ---     | ---                 | ---     | ---                 |  |
| Input / Output Characteristics                      |                              |                                   |                     |         |                     |         |                     |         |                     |  |
| I/O Capacitance (pF)(C <sub>I/O</sub> )             |                              | 5                                 |                     | 5       |                     | 5       |                     | 5       |                     |  |
| I/O Isolation voltage (VAC)(V <sub>I/O</sub> )      | SOP                          | 1500                              |                     | 2500    |                     | 1500    |                     | 2500    |                     |  |
|   | SMD/DIP                      | 3750                              |                     | 5000    |                     | 3750    |                     | 5000    |                     |  |
| I/O Isolation resistance (GΩ)(R <sub>I/O</sub> )    |                              | 5                                 |                     | 5       |                     | 5       |                     | 5       |                     |  |
| Temperature limits                                  | Operating (T <sub>OP</sub> ) | -40°C to +85°C (-40°F to +185°F)  |                     |         |                     |         |                     |         |                     |  |
|   | Storage (T <sub>STG</sub> )  | -40°C to +100°C (-40°F to +212°F) |                     |         |                     |         |                     |         |                     |  |



|   |                              |     |                                   |     |                     |     |                     |     |                     |     |
|---|------------------------------|-----|-----------------------------------|-----|---------------------|-----|---------------------|-----|---------------------|-----|
| Part Number<br>(4 PIN)<br>(6 PIN)<br>(8 PIN)        | DIP                          | EPR | -----<br>211C358000               |     | -----<br>211C358009 |     | -----<br>211C408000 |     | -----<br>211C408009 |     |
|   | SMD                          |     | -----<br>311C358X00               |     | -----<br>311C358X09 |     | -----<br>311C408X00 |     | -----<br>311C408X09 |     |
|   | SOP                          |     | -----<br>411C358X00               |     | -----<br>411C358X09 |     | -----<br>411C408X00 |     | -----<br>411C408X09 |     |
| Contact form  | 4PIN / 6PIN                  |     | ---                               |     | ---                 |     | ---                 |     | ---                 |     |
|   | 8PIN                         |     | 1A                                | 1B  | 1A                  | 1B  | 1A                  | 1B  | 1A                  | 1B  |
| Input Characteristics                               |                              |     |                                   |     |                     |     |                     |     |                     |     |
| Forward voltage (V)(V <sub>F</sub> )                |                              |     | 0.9-1.5                           |     | 0.9-1.5             |     | 0.9-1.5             |     | 0.9-1.5             |     |
| Reverse voltage at 10μA (V)(V <sub>R</sub> )        |                              |     | 5                                 |     | 5                   |     | 5                   |     | 5                   |     |
| Control current (mA)(I <sub>F</sub> )               |                              |     | 5-50                              |     | 5-50                |     | 5-50                |     | 5-50                |     |
| Output Characteristics                              |                              |     |                                   |     |                     |     |                     |     |                     |     |
| Load voltage (V)(AC peak or DC)(V <sub>L</sub> )    |                              |     | 350                               | 350 | 350                 | 350 | 400                 | 400 | 400                 | 400 |
| Continuous rated load current (mA)(I <sub>L</sub> ) | SOP                          |     | 100                               | 80  | 100                 | 80  | 100                 | 80  | 100                 | 80  |
|   | SMD/DIP                      |     | 130                               | 100 | 130                 | 100 | 130                 | 100 | 130                 | 100 |
| Peak current (mA)(I <sub>L-Peak</sub> )             | SOP                          |     | 300                               | 200 | 300                 | 200 | 250                 | 250 | 250                 | 250 |
|   | SMD/DIP                      |     | 300                               | 250 | 300                 | 250 | 300                 | 250 | 300                 | 250 |
| On-state resistance Max. (Ω)(R <sub>ON</sub> )      |                              |     | 30                                | 50  | 30                  | 50  | 30                  | 50  | 30                  | 50  |
| Off-state leakage current (μA) (I <sub>LK</sub> )   |                              |     | 1                                 | 10  | 1                   | 10  | 1                   | 10  | 1                   | 10  |
| Turn-on (msec)(T <sub>ON</sub> )                    |                              |     | 1                                 | 1   | 1                   | 1   | 1                   | 1   | 1                   | 1   |
| Turn-off (msec)(T <sub>OFF</sub> )                  |                              |     | 1                                 | 1   | 1                   | 1   | 1                   | 1   | 1                   | 1   |
| Capacitance (pF)(C <sub>OUT</sub> )                 |                              |     | ---                               | 200 | ---                 | 200 | 70                  | 150 | 70                  | 150 |
| Current limit typ. (mA)                             |                              |     | ---                               | --- | ---                 | --- | ---                 | --- | ---                 | --- |
| Input / Output Characteristics                      |                              |     |                                   |     |                     |     |                     |     |                     |     |
| I/O Capacitance (pF)(C <sub>I/O</sub> )             |                              |     | 5                                 |     | 5                   |     | 5                   |     | 5                   |     |
| I/O Isolation voltage (VAC)(V <sub>I/O</sub> )      | SOP                          |     | 1500                              |     | 2500                |     | 1500                |     | 2500                |     |
|   | SMD/DIP                      |     | 3750                              |     | 5000                |     | 3750                |     | 5000                |     |
| I/O Isolation resistance (GΩ)(R <sub>I/O</sub> )    |                              |     | 5                                 |     | 5                   |     | 5                   |     | 5                   |     |
| Temperature limits                                  | Operating (T <sub>OP</sub> ) |     | -40°C to +85°C (-40°F to +185°F)  |     |                     |     |                     |     |                     |     |
|   | Storage (T <sub>STG</sub> )  |     | -40°C to +100°C (-40°F to +212°F) |     |                     |     |                     |     |                     |     |



|   |                              |     |                                   |             |             |             |             |
|---|------------------------------|-----|-----------------------------------|-------------|-------------|-------------|-------------|
| Part Number<br>(4 PIN)<br>(6 PIN)<br>(8 PIN)        | DIP                          | EPR | 211A354000L                       | 211A354001L | 211A354002L | 211A404000L | 211A404002L |
|   |                              |     | 211A356000L                       | 211A356001L | 211A356002L | 211A406000L | 211A406002L |
|   |                              |     | 212A358000L                       | 212A358001L | 212A358002L | 212A408000L | 212A408002L |
|   | SMD                          |     | 311A354X00L                       | 311A354X01L | 311A354X02L | 311A404X00L | 311A404X02L |
|   |                              |     | 311A356X00L                       | 311A356X01L | 311A356X02L | 311A406X00L | 311A406X02L |
|   |                              |     | 312A358X00L                       | 312A358X01L | 312A358X02L | 312A408X00L | 312A408X02L |
|   | SOP                          |     | 411A354X00L                       | 411A354X01L | 411A354X02L | 411A404X00L | 411A404X02L |
|   |                              |     | 411A356X00L                       | 411A356X01L | 411A356X02L | 411A406X00L | 411A406X02L |
|   |                              |     | 412A358X00L                       | 412A358X01L | 412A358X02L | 412A408X00L | 412A408X02L |
| Contact form  | 4PIN / 6PIN                  |     | 1A                                | 1A          | 1A          | 1A          | 1A          |
|   | 8PIN                         |     | 2A                                | 2A          | 2A          | 2A          | 2A          |
| Input Characteristics                               |                              |     |                                   |             |             |             |             |
| Forward voltage (V)(V <sub>F</sub> )                |                              |     | 0.9-1.5                           | 0.9-1.5     | 0.9-1.5     | 0.9-1.5     | 0.9-1.5     |
| Reverse voltage at 10μA (V)(V <sub>R</sub> )        |                              |     | 5                                 | 5           | 5           | 5           | 5           |
| Control current (mA)(I <sub>F</sub> )               |                              |     | 5-50                              | 5-50        | 5-50        | 5-50        | 5-50        |
| Output Characteristics                              |                              |     |                                   |             |             |             |             |
| Load voltage (V)(AC peak or DC)(V <sub>L</sub> )    |                              |     | 350                               | 350         | 350         | 400         | 400         |
| Continuous rated load current (mA)(I <sub>L</sub> ) | SOP                          |     | 100                               | 80          | 120         | 100         | 100         |
|   | SMD/DIP                      |     | 120                               | 100         | 120         | 120         | 120         |
| Peak current (mA)(I <sub>L-Peak</sub> )             | SOP                          |     | 120                               | 120         | 120         | 120         | 120         |
|   | SMD/DIP                      |     | 120                               | 120         | 120         | 120         | 120         |
| On-state resistance Max. (Ω)(R <sub>ON</sub> )      |                              |     | 35                                | 55          | 22          | 40          | 22          |
| Off-state leakage current (μA) (I <sub>LK</sub> )   |                              |     | 1                                 | 1           | 1           | 1           | 1           |
| Turn-on (msec)(T <sub>ON</sub> )                    |                              |     | 3                                 | 3           | 3           | 3           | 3           |
| Turn-off (msec)(T <sub>OFF</sub> )                  |                              |     | 1                                 | 1           | 1           | 1           | 1           |
| Capacitance (pF)(C <sub>OUT</sub> )                 |                              |     | ---                               | ---         | ---         | 70          | ---         |
| Current limit typ. (mA)                             |                              |     | 180                               | 180         | 180         | 180         | 180         |
| Input / Output Characteristics                      |                              |     |                                   |             |             |             |             |
| I/O Capacitance (pF)(C <sub>I/O</sub> )             |                              |     | 5                                 | 5           | 5           | 5           | 5           |
| I/O Isolation voltage (VAC)(V <sub>I/O</sub> )      | SOP                          |     | 1500                              | 1500        | 1500        | 1500        | 1500        |
|   | SMD/DIP                      |     | 3750                              | 3750        | 3750        | 3750        | 3750        |
| I/O Isolation resistance (GΩ)(R <sub>I/O</sub> )    |                              |     | 5                                 | 5           | 5           | 5           | 5           |
| Temperature limits                                  | Operating (T <sub>OP</sub> ) |     | -40°C to +85°C (-40°F to +185°F)  |             |             |             |             |
|   | Storage (T <sub>STG</sub> )  |     | -40°C to +100°C (-40°F to +212°F) |             |             |             |             |



|   |                              |   |  |  |                              |                                     |                                     |
|---|------------------------------|---|--|--|------------------------------|-------------------------------------|-------------------------------------|
| Part Number<br>(4 PIN)<br>(6 PIN)<br>(8 PIN)              | DIP                          | EPR   | 211A044005<br>211A046005<br>212A048005 | 211A034006<br>211A036006<br>212A038006 | -----<br>211A106005<br>----- | -----<br><b>211A038005</b><br>----- | -----<br><b>211A048005</b><br>----- |
|   | SMD                          |   | 311A044X05<br>311A046X05<br>312A048X05 | 311A034X06<br>311A036X06<br>312A038X06 | -----<br>311A106X05<br>----- | -----<br><b>311A038005</b><br>----- | -----<br><b>311A048005</b><br>----- |
|   | SOP                          |   | 411A044X05<br>411A046X05<br>412A048X05 | -----<br>411A036X06<br>-----           | -----<br>411A106X05<br>----- | -----<br>-----<br>-----             | -----<br>-----<br>-----             |
| Contact form  | 4PIN / 6PIN                  |   | 1A                                     | 1A                                     | 1A                           | ---                                 | ---                                 |
|   | 8PIN                         |   | 2A                                     | 2A                                     | 2A                           | 1A                                  | 1A                                  |
| Input Characteristics                                     |                              |   |  |  |                              |                                     |                                     |
| Forward voltage (V)(V <sub>F</sub> )                      |                              |   | 0.9-1.5                                | 0.9-1.5                                | 0.9-1.5                      | <b>2.0-3.0</b>                      | <b>2.0-3.0</b>                      |
| Reverse voltage at 10 $\mu$ A (V)(V <sub>R</sub> )        |                              |   | 5                                      | 5                                      | 5                            | <b>5</b>                            | <b>5</b>                            |
| Control current (mA)(I <sub>F</sub> )                     |                              |   | 10-50                                  | 10-50                                  | 10-50                        | <b>10-50</b>                        | <b>10-50</b>                        |
| Output Characteristics                                    |                              |   |  |  |                              |                                     |                                     |
| Load voltage (V)(AC peak or DC)(V <sub>L</sub> )          |                              |   | 40                                     | 30                                     | 100                          | <b>30</b>                           | <b>40</b>                           |
| Continuous rated load current (mA)(I <sub>L</sub> )       | SOP                          |   | 1300                                   | 2500                                   | 800                          | ---                                 | ---                                 |
|   | SMD/DIP                      |   | 1800                                   | 3000                                   | 1000                         | <b>6000</b>                         | <b>5500</b>                         |
| Peak current (mA)(I <sub>L-Peak</sub> )                   | SOP                          |   | 2500                                   | 5000                                   | 1500                         | ---                                 | ---                                 |
|   | SMD/DIP                      |   | 2500                                   | 5000                                   | 1500                         | <b>12000</b>                        | <b>12000</b>                        |
| On-state resistance Max. ( $\Omega$ )(R <sub>ON</sub> )   |                              |   | 0.5                                    | 0.2                                    | 0.5                          | <b>0.1</b>                          | <b>0.1</b>                          |
| Off-state leakage current ( $\mu$ A)(I <sub>LK</sub> )    |                              |   | 1                                      | 1                                      | 1                            | <b>10</b>                           | <b>10</b>                           |
| Turn-on (msec)(T <sub>ON</sub> )                          |                              |   | 5                                      | 5                                      | 5                            | <b>10</b>                           | <b>10</b>                           |
| Turn-off (msec)(T <sub>OFF</sub> )                        |                              |   | 2                                      | 2                                      | 2                            | <b>2</b>                            | <b>2</b>                            |
| Capacitance (pF)(C <sub>OUT</sub> )                       |                              |   | ---                                    | ---                                    | ---                          | ---                                 | ---                                 |
| Current limit typ. (mA)                                   |                              |   | ---                                    | ---                                    | ---                          | ---                                 | ---                                 |
| Input / Output Characteristics                            |                              |   |  |  |                              |                                     |                                     |
| I/O Capacitance (pF)(C <sub>I/O</sub> )                   |                              |   | 5                                      | 5                                      | 5                            | <b>5</b>                            | <b>5</b>                            |
| I/O Isolation voltage (VAC)(V <sub>I/O</sub> )            | SOP                          |   | 1500                                   | 1500                                   | 1500                         | ---                                 | ---                                 |
|   | SMD/DIP                      |   | 2500                                   | 2500                                   | 2500                         | <b>2500</b>                         | <b>2500</b>                         |
| I/O Isolation resistance (G $\Omega$ )(R <sub>I/O</sub> ) |                              |   | 5                                      | 5                                      | 5                            | <b>5</b>                            | <b>5</b>                            |
| Temperature limits  | Operating (T <sub>OP</sub> ) | -40 $^{\circ}$ C to +85 $^{\circ}$ C (-40 $^{\circ}$ F to +185 $^{\circ}$ F)  |  |  |                              |                                     |                                     |
|   | Storage (T <sub>STG</sub> )  | -40 $^{\circ}$ C to +100 $^{\circ}$ C (-40 $^{\circ}$ F to +212 $^{\circ}$ F) |  |  |                              |                                     |                                     |



## X-ON Electronics

Largest Supplier of Electrical and Electronic Components

*Click to view similar products for Solid State Relays - PCB Mount category:*

*Click to view products by Excel Cell Electronic(ECE) manufacturer:*

Other Similar products are found below :

[M86F-2W](#) [M90F-2W](#) [M90F-2Y](#) [901-SX](#) [G2-1A07-ST](#) [G2-1A07-TT](#) [G2-1B02-TT](#) [G2-DA06-ST](#) [PLA134S](#) [AQV212J](#) [AQY210ST](#)  
[EFR1200480A150](#) [901-7](#) [LCA220](#) [LCB110S](#) [1618400-5](#) [SR75-1ST](#) [AQV212AJ](#) [AQV212SXJ](#) [AQV238AD01](#) [AQW414TS](#) [AQY221R2VJ](#)  
[AQY275AXJ](#) [AQY414SXE01](#) [G2-1A02-ST](#) [G2-1A03-ST](#) [G2-1A03-TT](#) [G2-1A05-ST](#) [G2-1A06-TT](#) [G2-1A23-TT](#) [G2-1B01-ST](#) [G2-1B01-](#)  
[TT](#) [G2-1B02-ST](#) [G2-DA03-ST](#) [G2-DA03-TT](#) [G2-DA06-TT](#) [3-1617776-2](#) [CTA2425](#) [LBA110S](#) [LBB110S](#) [LCA110LSTR](#) [LCB126S](#)  
[WPPM-0626D](#) [WPPM-3526D](#) [WPPM-3588D](#) [X4IDC15D](#) [X4IDC5D](#) [X4ODC15](#) [X4ODC15A](#) [X4ODC24](#)