

MKP62
Code:C42

金属化聚丙烯膜抗干扰电容器(X2类, 305Vac/275Vac)

Metallized polypropylene film Interference Suppression capacitor(Class X2, 305Vac/275Vac)

外形图 Outline Drawing

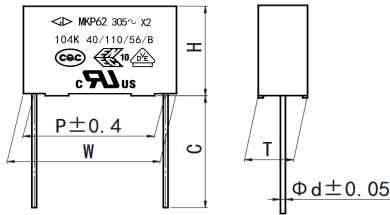

W±0.4, H±0.4, T±0.4

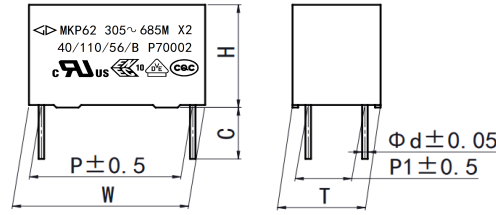

W±1.0, H±1.0, T±1.0 四引出线 4pins

方底(Square-bottom)

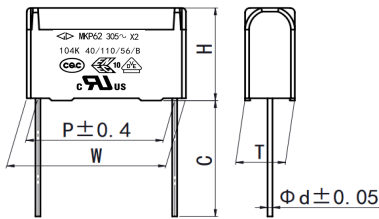

W±0.4, H±0.4, T±0.4

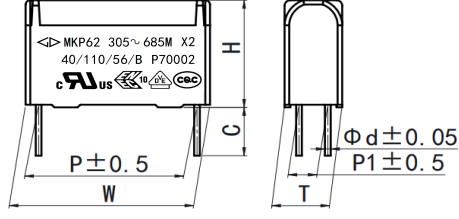

W±1.0, H±1.0, T±1.0 四引出线 4pins

圆弧底(Arc-bottom)

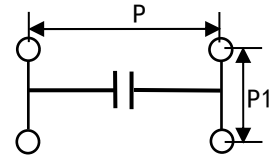

四引出线 4pins

特点

- 金属化聚丙烯
- 能承受过压冲击
- 优异的阻燃性能
- 用于电源跨线路等抗干扰场合

Features

- Metallized polypropylene structure
- Withstanding overvoltage stressing
- Excellent active and passive flame resistant abilities
- Used in across-the-line, interference suppression circuit

安全认证 Safety Approvals

| | | | |
|---|--|-----------------|---|
| ● | | CQC (中国) | IEC 60384-14:2013, X2, 305Vac/275Vac, 0.0010μF ~ 50.0μF, 40/110/56/B 证书号(Certificate No.): CQC03001002875 |
| ● | | ENEC-VDE (欧盟) | EN 60384-14:2013+A1:2016, X2, 305Vac/275Vac, 0.0010μF ~ 50.0μF, 40/110/56/B 证书号(Certificate No.): 40000358 |
| ● | | UL/CUL (美国/加拿大) | UL 60384-14:2009, CSA E60384-14:09, X2, 305Vac/275Vac, 0.0010μF ~ 50.0μF, 40/110/56/B 证书号(File No.): E186600, CCN: FOWX2/8 |
| ● | | KC (韩国) | K 60384-14(2006-12), X2, 305Vac/275Vac, 0.0010μF ~ 3.0μF, 40/110/56/B 证书号(Certificate No.): SU03060-12001A/12002/12003/12004 |

技术要求 Specifications

| | | | |
|---|---|--------------------------------------|---------------------------------------|
| 气候类别/阻燃等级 Climatic Category/Passive Flammability Category | 40/110/56/B | | |
| 工作温度范围 Operating Temperature Range | -40°C ~ +110°C | | |
| 额定电压 Rated Voltage(U _R) | 305Vac/275Vac, 50Hz/60Hz | | |
| 最大连续直流电压 Maximum continuous DC voltage | 630Vdc | | |
| 电容量范围 Capacitance Range | 0.0010μF ~ 25.0μF | | |
| 电容量偏差 Capacitance Tolerance | ±10%(K), ±20%(M) | | |
| 耐电压 Voltage Proof | 引线之间 Between Terminals: | 4.3U _R (Vdc), 2s | |
| | 极壳之间 Between Terminals To Case: | 2 120Vac, 1min | |
| 绝缘电阻 Insulation Resistance | R ≥ 15 000Ω, C _N ≤ 0.33μF | (20°C, 100V, 1min) | |
| | RC _N ≥ 5 000s, C _N > 0.33μF | | |
| 损耗角正切 Dissipation Factor(tanδ) | 0.0010μF ≤ C _N < 0.010μF | ≤ 20 × 10 ⁻⁴ (20°C, 1kHz) | ≤ 20 × 10 ⁻⁴ (20°C, 10kHz) |
| | 0.010μF ≤ C _N < 0.47μF | ≤ 10 × 10 ⁻⁴ (20°C, 1kHz) | ≤ 20 × 10 ⁻⁴ (20°C, 10kHz) |
| | 0.47μF ≤ C _N ≤ 1.0μF | ≤ 20 × 10 ⁻⁴ (20°C, 1kHz) | ≤ 40 × 10 ⁻⁴ (20°C, 10kHz) |
| | 1.0μF < C _N ≤ 10.0μF | ≤ 30 × 10 ⁻⁴ (20°C, 1kHz) | ----- |
| | 10.0μF < C _N ≤ 50.0μF | ≤ 40 × 10 ⁻⁴ (20°C, 1kHz) | ----- |
| 注: 1. 推荐用于电网额定电压不超过250VAC场合; 2. 如果需要用到承载一定纹波电流场合, 建议选用C6A等专用的滤波电容器; 如有疑问, 请与我司技术工程师联系; 3. 若用于户外或长期湿度较大场合, 建议选用防潮设计。 | Recommend for max rated supply mains voltage 250Vac application; If used in application which has ripple current applied, recommend to use AC filter series: C6A etc; If have any questions please contact our technical engineer for more detail; For outdoor or severe humidity condition application, recommend to use THB series. | | |

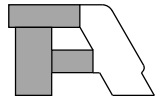

■ 产品编码说明 Part number system

■ 15 位产品代码如下:

The 15 digits part number is formed as follow:

| | | | | | | | | | | | | | | |
|---|---|---|---|---|---|---|---|---|----|----|----|----|----|----|
| 1 | 2 | 3 | 4 | 5 | 6 | 7 | 8 | 9 | 10 | 11 | 12 | 13 | 14 | 15 |
| C | 4 | 2 | | | | | | | | | | | | |

| | | | |
|-----------|---|----------------|--|
| 第 1~3 位 | 型号代码 C42= MKP62 | Digit 1 to 3 | Series code C42= MKP62 |
| 第 4~5 位 | 交流额定电压 Q2=305V P2=275V | Digit 4 to 5 | AC rated voltage Q2=305V P2=275V |
| 第 6~8 位 | 标称容量 举例: 103=10×10³pF=0.01μF | Digit 6 to 8 | Rated capacitance value for example: 103=10×10³pF=0.01μF |
| 第 9 位 | 容量偏差 K=±10%, M=±20% | Digit 9 | Capacitance tolerance K=±10%, M=±20% |
| 第 10 位 | 引线脚距 P 3=7.5mm 4=10.0mm 6=15.0mm 9=22.5mm B=27.5mm D=32.5mm F=37.5mm M=52.5mm | Digit 10 | Pitch 3=7.5mm 4=10.0mm 6=15.0mm 9=22.5mm B=27.5mm D=32.5mm F=37.5mm M=52.5mm |
| 第 11 位 | 内部特征码 | Digit 11 | Internal use |
| 第 12~15 位 | 引线加工和包装代码 | Digit 12 to 15 | Lead form and packaging code |

■ Table 1 引线加工和包装代码 lead form and packaging code

| 第 12 位 Digit 12 | | 第 13 位 Digit 13 | | 第 14 位 Digit 14 | | 第 15 位 Digit 15 | |
|-----------------|---|----------------------|--|-----------------|------------------|------------------|--|
| 代码 Code | 说明 explanation | 代码 Code | 说明 explanation | 代码 Code | 说明 explanation | 代码 Code | 说明 explanation |
| A | 弹带包装 ammo-pack | 3 4 6 | F=7.5mm F=10.0mm F=15.0mm | 0 | 表示直脚 straight | 1 5 | 产品在连续的两个载带孔之间 each cap.among two consecutive holes P3=12.7mm, H=18.5mm(For pitch=7.5mm) P3=25.4mm; H=18.5mm (For pitch=10.0/15.0mm) (Detail parameter refer to page 16) |
| C | 直脚 Straight lead "C" in the figure above | 代码 Code 00 45 | 说明 explanation 标准的引线长度(18mm~26 mm) standard lead length 引线长度 4.5mm lead length 4.5mm | | | 0 | 引线长度偏差±0.5mm 或标准长度 Length tolerance±0.5mm Or standard length |
| D E M | 软绝缘线(多股) Insulated stranded leads 硬绝缘线(单股) Insulated solid leads 软绝缘线(多股), 外壳带正底安装耳 Insulated stranded leads Box with mounting foot | C5 K0 K2 L0 | 35mm 100mm 120mm 200mm 注 1: 这里的长度包含剥线长度 Note 1: This length includes the stripping parts 注 2: 一般 P≥27.5mm 产品才可选用绝缘线方式 Note 2: Normally, for P≥27.5mm Caps can choice Insulated leads | | | 1 2 3 4 | 引线长度偏差 -5mm~0mm Length tolerance -5 mm~0 mm 引线长度偏差 0 mm~+5 mm Length tolerance 0 mm~+5 mm 引线长度偏差 0 mm~+10mm Length tolerance 0 mm~+10mm 引线长度偏差±5 mm Length tolerance±5 mm |
| T 3 | P1=20.3mm±0.5mm P1=20mm±0.5mm | 45 55 | 引线长度 4.5mm lead length 4.5mm 引线长度 5.5mm lead length 5.5mm | | | 0 | 引线长度偏差±0.5mm 或标准长度 Length tolerance±0.5mm Or standard length |

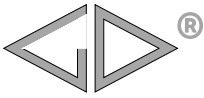

MKP62
Code:C42

■ 外形尺寸 Dimensions(mm)
标准型 Standard type

| 305Vac/275Vac [#] | | | | | | | 305Vac/275Vac [#] | | | | | | | 305Vac/275Vac [#] | | | | | | |
|----------------------------|------|------|-----|------|-----|-----------------|----------------------------|------|------|------|------|-----|-----------------|----------------------------|------|------|------|------|-----|------------------|
| C _N (μF) | W | H | T | P | d | Part number | C _N (μF) | W | H | T | P | d | Part number | C _N (μF) | W | H | T | P | d | Part number |
| 0.0010 | 10.5 | 9.0 | 4.0 | 7.5 | 0.6 | C42Q2102-30**** | 0.010 | 17.5 | 9.5 | 5.0 | 15.0 | 0.6 | C42Q2103-6A**** | 1.8 | 26.5 | 24.5 | 15.5 | 22.5 | 0.8 | C42Q2185-9S**** |
| 0.0012 | 10.5 | 9.0 | 4.0 | 7.5 | 0.6 | C42Q2122-30**** | 0.012 | 17.5 | 9.5 | 5.0 | 15.0 | 0.6 | C42Q2123-6A**** | 2.2 | 26.5 | 24.5 | 15.5 | 22.5 | 0.8 | C42Q2225-9S**** |
| 0.0015 | 10.5 | 9.0 | 4.0 | 7.5 | 0.6 | C42Q2152-30**** | 0.015 | 17.5 | 9.5 | 5.0 | 15.0 | 0.6 | C42Q2153-6A**** | 2.2 | 26.5 | 29.5 | 14.5 | 22.5 | 0.8 | C42Q2225-9A**** |
| 0.0018 | 10.5 | 9.0 | 4.0 | 7.5 | 0.6 | C42Q2182-30**** | 0.018 | 17.5 | 9.5 | 5.0 | 15.0 | 0.6 | C42Q2183-6A**** | 0.39 | 32.0 | 18.0 | 9.0 | 27.5 | 0.8 | C42Q2394-B0**** |
| 0.0022 | 10.5 | 9.0 | 4.0 | 7.5 | 0.6 | C42Q2222-30**** | 0.022 | 17.5 | 9.5 | 5.0 | 15.0 | 0.6 | C42Q2223-6A**** | 0.47 | 32.0 | 18.0 | 9.0 | 27.5 | 0.8 | C42Q2474-B0**** |
| 0.0027 | 10.5 | 9.0 | 4.0 | 7.5 | 0.6 | C42Q2272-30**** | 0.027 | 17.5 | 9.5 | 5.0 | 15.0 | 0.6 | C42Q2273-6A**** | 0.56 | 32.0 | 18.0 | 9.0 | 27.5 | 0.8 | C42Q2564-B0**** |
| 0.0033 | 10.5 | 9.0 | 4.0 | 7.5 | 0.6 | C42Q2332-30**** | 0.033 | 17.5 | 9.5 | 5.0 | 15.0 | 0.6 | C42Q2333-6A**** | 0.68 | 32.0 | 18.0 | 9.0 | 27.5 | 0.8 | C42Q2684-B0**** |
| 0.0039 | 10.5 | 9.0 | 4.0 | 7.5 | 0.6 | C42Q2392-30**** | 0.039 | 17.5 | 9.5 | 5.0 | 15.0 | 0.6 | C42Q2393-6A**** | 0.82 | 32.0 | 18.0 | 9.0 | 27.5 | 0.8 | C42Q2824-B0**** |
| 0.0047 | 10.5 | 9.0 | 4.0 | 7.5 | 0.6 | C42Q2472-30**** | 0.047 | 17.5 | 9.5 | 5.0 | 15.0 | 0.6 | C42Q2473-6A**** | 1.0 | 32.0 | 18.0 | 9.0 | 27.5 | 0.8 | C42Q2105-BS**** |
| 0.0056 | 10.5 | 9.0 | 4.0 | 7.5 | 0.6 | C42Q2562-30**** | 0.056 | 17.5 | 9.5 | 5.0 | 15.0 | 0.6 | C42Q2563-6A**** | 1.0 | 32.0 | 12.0 | 18.0 | 27.5 | 0.8 | C42Q2105-BC**** |
| 0.0068 | 10.5 | 9.0 | 4.0 | 7.5 | 0.6 | C42Q2682-30**** | 0.068 | 17.5 | 9.5 | 5.0 | 15.0 | 0.6 | C42Q2683-6A**** | 1.2 | 32.0 | 20.0 | 11.0 | 27.5 | 0.8 | C42Q2125-BS**** |
| 0.0082 | 10.5 | 9.0 | 4.0 | 7.5 | 0.6 | C42Q2822-30**** | 0.082 | 17.5 | 9.5 | 5.0 | 15.0 | 0.6 | C42Q2823-6A**** | 1.5 | 32.0 | 20.0 | 11.0 | 27.5 | 0.8 | C42Q2155-BS**** |
| 0.010 | 10.5 | 9.0 | 4.0 | 7.5 | 0.6 | C42Q2103-30**** | 0.10M | 17.5 | 9.5 | 5.0 | 15.0 | 0.6 | C42Q2104M6A**** | 1.8 | 32.0 | 22.0 | 13.0 | 27.5 | 0.8 | C42Q2185-BS**** |
| 0.012 | 10.5 | 9.0 | 4.0 | 7.5 | 0.6 | C42Q2123-30**** | 0.10 | 17.5 | 11.0 | 5.0 | 15.0 | 0.6 | C42Q2104-6S**** | 2.2M | 32.0 | 22.0 | 13.0 | 27.5 | 0.8 | C42Q2225MBS**** |
| 0.015 | 10.5 | 9.0 | 4.0 | 7.5 | 0.6 | C42Q2153-30**** | 0.12 | 17.5 | 11.0 | 5.0 | 15.0 | 0.6 | C42Q2124-6S**** | 2.2K | 32.0 | 25.0 | 13.0 | 27.5 | 0.8 | C42Q2225KBS**** |
| 0.018 | 10.5 | 9.0 | 4.0 | 7.5 | 0.6 | C42Q2183-30**** | 0.15M | 17.5 | 11.0 | 5.0 | 15.0 | 0.6 | C42Q2154M6S**** | ★2.2 | 32.0 | 16.0 | 22.0 | 27.5 | 0.8 | C42Q2225-BC**** |
| 0.022 | 10.5 | 9.0 | 4.0 | 7.5 | 0.6 | C42Q2223-3S**** | 0.15K | 17.5 | 12.0 | 6.0 | 15.0 | 0.6 | C42Q2154K6S**** | 2.7 | 32.0 | 28.0 | 14.0 | 27.5 | 0.8 | C42Q2275-BS**** |
| 0.027 | 10.5 | 9.0 | 4.0 | 7.5 | 0.6 | C42Q2273-3S**** | 0.18 | 17.5 | 12.0 | 6.0 | 15.0 | 0.6 | C42Q2184-6S**** | 3.3 | 32.0 | 30.0 | 16.0 | 27.5 | 0.8 | C42Q2395-BA**** |
| 0.033 | 10.5 | 11.0 | 5.0 | 7.5 | 0.6 | C42Q2333-3S**** | 0.22M | 17.5 | 12.0 | 6.0 | 15.0 | 0.6 | C42Q2224M6S**** | 3.3M | 32.0 | 24.5 | 15.0 | 27.5 | 0.8 | C42Q2335MBS**** |
| 0.039 | 10.5 | 11.0 | 5.0 | 7.5 | 0.6 | C42Q2393-3S**** | 0.22K | 17.5 | 13.5 | 6.0 | 15.0 | 0.6 | C42Q2224K6B**** | 3.3K | 32.0 | 28.0 | 17.0 | 27.5 | 0.8 | C42Q2335KBS**** |
| 0.047 | 10.5 | 11.0 | 5.0 | 7.5 | 0.6 | C42Q2473-3S**** | 0.22K | 17.5 | 12.0 | 7.0 | 15.0 | 0.6 | C42Q2224K6C**** | ★3.3M | 32.0 | 16.0 | 27.5 | 27.5 | 0.8 | C42Q2335MBC**** |
| 0.056 | 10.5 | 12.0 | 6.0 | 7.5 | 0.6 | C42Q2563-3S**** | 0.22K | 17.5 | 13.5 | 7.5 | 15.0 | 0.6 | C42Q2224K6S**** | ★3.3K | 32.0 | 18.5 | 31.0 | 27.5 | 0.8 | C42Q2335KBC**** |
| 0.068 | 10.5 | 12.0 | 6.0 | 7.5 | 0.6 | C42Q2683-3S**** | 0.27 | 17.5 | 13.5 | 7.5 | 15.0 | 0.6 | C42Q2274-6S**** | 3.9 | 32.0 | 29.0 | 19.0 | 27.5 | 0.8 | C42Q2395-BA**** |
| 0.0047 | 13.0 | 9.0 | 4.0 | 10.0 | 0.6 | C42Q2472-40**** | 0.33M | 17.5 | 13.5 | 7.5 | 15.0 | 0.6 | C42Q2334M6S**** | 3.9 | 32.0 | 33.0 | 18.0 | 27.5 | 0.8 | C42Q2395-BS**** |
| 0.0056 | 13.0 | 9.0 | 4.0 | 10.0 | 0.6 | C42Q2562-40**** | 0.33K | 17.5 | 14.0 | 8.0 | 15.0 | 0.6 | C42Q2334K6S**** | 4.7M | 32.0 | 33.0 | 18.0 | 27.5 | 0.8 | C42Q2475MBS**** |
| 0.0068 | 13.0 | 9.0 | 4.0 | 10.0 | 0.6 | C42Q2682-40**** | 0.33M | 17.5 | 12.5 | 9.0 | 15.0 | 0.6 | C42Q2334M6A**** | ★4.7M | 32.0 | 18.5 | 31.0 | 27.5 | 0.8 | C42Q2475MBC**** |
| 0.0082 | 13.0 | 9.0 | 4.0 | 10.0 | 0.6 | C42Q2822-40**** | 0.33M | 17.5 | 17.5 | 6.0 | 15.0 | 0.6 | C42Q2334M6B**** | 4.7K | 32.0 | 33.0 | 18.0 | 27.5 | 0.8 | C42Q2475KBA**** |
| 0.010 | 13.0 | 9.0 | 4.0 | 10.0 | 0.6 | C42Q2103-40**** | 0.33K | 17.5 | 18.5 | 7.5 | 15.0 | 0.8 | C42Q2334K6A**** | ★4.7 | 32.0 | 30.0 | 21.0 | 27.5 | 0.8 | C42Q2475-BS**** |
| 0.012 | 13.0 | 9.0 | 4.0 | 10.0 | 0.6 | C42Q2123-40**** | 0.33 | 17.5 | 12.0 | 13.0 | 15.0 | 0.8 | C42Q2334-6C**** | 5.6 | 32.0 | 37.0 | 22.0 | 27.5 | 0.8 | C42Q2565-BS**** |
| 0.015 | 13.0 | 9.0 | 4.0 | 10.0 | 0.6 | C42Q2153-40**** | 0.39 | 17.5 | 14.5 | 8.5 | 15.0 | 0.6 | C42Q2394-6S**** | 6.8M | 32.0 | 37.0 | 22.0 | 27.5 | 0.8 | C42Q2685MBS**** |
| 0.018 | 13.0 | 9.0 | 4.0 | 10.0 | 0.6 | C42Q2183-40**** | 0.47M | 17.5 | 14.5 | 8.5 | 15.0 | 0.6 | C42Q2474M6S**** | 1.5 | 41.0 | 22.0 | 11.0 | 37.5 | 1.0 | C42Q2155-FS**** |
| 0.022 | 13.0 | 9.0 | 4.0 | 10.0 | 0.6 | C42Q2223-40**** | 0.47M | 17.5 | 18.5 | 7.5 | 15.0 | 0.8 | C42Q2474M6A**** | 1.8 | 41.0 | 22.0 | 11.0 | 37.5 | 1.0 | C42Q2185-FS**** |
| 0.027 | 13.0 | 9.0 | 4.0 | 10.0 | 0.6 | C42Q2273-40**** | 0.47K | 17.5 | 16.0 | 10.0 | 15.0 | 0.8 | C42Q2474K6S**** | 2.2 | 41.0 | 24.0 | 13.0 | 37.5 | 1.0 | C42Q2225-FS**** |
| 0.033 | 13.0 | 9.0 | 4.0 | 10.0 | 0.6 | C42Q2333-4S**** | 0.56 | 17.5 | 16.0 | 10.0 | 15.0 | 0.8 | C42Q2564-6A**** | 2.2 | 42.0 | 15.0 | 24.0 | 37.5 | 1.0 | C42Q2225-FC**** |
| 0.039 | 13.0 | 9.0 | 4.0 | 10.0 | 0.6 | C42Q2393-4S**** | 0.60 | 17.5 | 19.0 | 11.0 | 15.0 | 0.8 | C42Q2604-6S**** | 2.7 | 41.0 | 24.0 | 13.0 | 37.5 | 1.0 | C42Q2275-FS**** |
| 0.047 | 13.0 | 9.0 | 4.0 | 10.0 | 0.6 | C42Q2473-4S**** | 0.68 | 17.5 | 19.0 | 11.0 | 15.0 | 0.8 | C42Q2684-6S**** | 3.3 | 41.0 | 26.0 | 15.0 | 37.5 | 1.0 | C42Q2335-FA**** |
| 0.056 | 13.0 | 11.0 | 5.0 | 10.0 | 0.6 | C42Q2563-4S**** | 0.82M | 17.5 | 19.0 | 11.0 | 15.0 | 0.8 | C42Q2824M6S**** | 3.3 | 42.0 | 28.0 | 14.0 | 37.5 | 1.0 | C42Q2335-FS**** |
| 0.068 | 13.0 | 11.0 | 5.0 | 10.0 | 0.6 | C42Q2683-4S**** | 0.15 | 26.5 | 15.0 | 6.0 | 22.5 | 0.8 | C42Q2154-90**** | 3.3 | 42.0 | 15.0 | 24.0 | 37.5 | 1.0 | C42Q2335-FC**** |
| 0.082 | 13.0 | 11.0 | 5.0 | 10.0 | 0.6 | C42Q2823-4S**** | 0.18 | 26.5 | 15.0 | 6.0 | 22.5 | 0.8 | C42Q2184-90**** | 3.9 | 41.0 | 30.0 | 16.0 | 37.5 | 1.0 | C42Q2395-FS**** |
| 0.10M | 13.0 | 11.0 | 5.0 | 10.0 | 0.6 | C42Q2104M4S**** | 0.22 | 26.5 | 15.0 | 6.0 | 22.5 | 0.8 | C42Q2224-9S**** | 4.7M | 42.0 | 19.0 | 24.0 | 37.5 | 1.0 | C42Q2475MFC**** |
| 0.10K | 13.0 | 12.0 | 6.0 | 10.0 | 0.6 | C42Q2104K4S**** | 0.27 | 26.5 | 15.0 | 6.0 | 22.5 | 0.8 | C42Q2274-9S**** | 4.7K | 41.0 | 20.0 | 26.0 | 37.5 | 1.0 | C42Q2475KFC**** |
| 0.12 | 13.0 | 13.0 | 7.0 | 10.0 | 0.6 | C42Q2124-4S**** | 0.33 | 26.5 | 15.0 | 6.0 | 22.5 | 0.8 | C42Q2334-9S**** | 4.7 | 41.0 | 30.0 | 16.0 | 37.5 | 1.0 | C42Q2475-FS**** |
| 0.15 | 13.0 | 13.0 | 7.0 | 10.0 | 0.6 | C42Q2154-4S**** | 0.39 | 26.5 | 15.0 | 6.0 | 22.5 | 0.8 | C42Q2394-9S**** | 5.6 | 41.0 | 33.5 | 18.5 | 37.5 | 1.0 | C42Q2565-FS**** |
| 0.18 | 13.0 | 14.0 | 8.0 | 10.0 | 0.6 | C42Q2184-4S**** | 0.47M | 26.5 | 15.0 | 6.0 | 22.5 | 0.8 | C42Q2474M9S**** | 6.8 | 41.0 | 33.5 | 18.5 | 37.5 | 1.0 | C42Q2685-FS**** |
| 0.22 | 13.0 | 14.0 | 8.0 | 10.0 | 0.6 | C42Q2224-4S**** | 0.47K | 26.5 | 16.0 | 7.0 | 22.5 | 0.8 | C42Q2474K9S**** | 6.8 | 42.0 | 24.0 | 32.0 | 37.5 | 1.0 | C42Q2685-FC**** |
| | | | | | | | 0.56 | 26.5 | 16.0 | 7.0 | 22.5 | 0.8 | C42Q2564-9S**** | 8.2 | 41.0 | 37.0 | 22.0 | 37.5 | 1.0 | C42Q2825-FS**** |
| | | | | | | | 0.60 | 26.5 | 17.0 | 8.5 | 22.5 | 0.8 | C42Q2604-9S**** | 10.0M | 41.0 | 37.0 | 22.0 | 37.5 | 1.0 | C42Q2106MFS**** |
| | | | | | | | 0.68 | 26.5 | 17.0 | 8.5 | 22.5 | 0.8 | C42Q2684-9S**** | 10.0K | 41.0 | 41.0 | 26.0 | 37.5 | 1.0 | C42Q2106KFS**** |
| | | | | | | | 0.82 | 26.5 | 18.5 | 10.0 | 22.5 | 0.8 | C42Q2824-9S**** | 10.0K | 41.5 | 37.5 | 27.5 | 37.5 | 1.0 | C42Q2106KFA**** |
| | | | | | | | 1.0 | 26.5 | 18.5 | 10.0 | 22.5 | 0.8 | C42Q2105-9S**** | 12.0 | 41.0 | 43.0 | 28.0 | 37.5 | 1.0 | C42Q2126-FS**** |
| | | | | | | | 1.2 | 26.5 | 20.0 | 11.0 | 22.5 | 0.8 | C42Q2125-9S**** | 15.0 | 42.0 | 45.0 | 30.0 | 37.5 | 1.0 | C42Q2156-FS**** |
| | | | | | | | 1.5M | 26.5 | 20.0 | 11.0 | 22.5 | 0.8 | C42Q2155M9S**** | 20.0 | 42.0 | 57.5 | 30.0 | 37.5 | 1.0 | C42Q2206-FS**** |
| | | | | | | | 1.5K | 26.5 | 22.0 | 12.0 | 22.5 | 0.8 | C42Q2155K9S**** | 20.0 | 57.0 | 45.0 | 30.0 | 52.5 | 1.2 | C42Q2206-MST**** |
| | | | | | | | | | | | | | | 20.0 | 57.0 | 30.0 | 44.0 | 52.5 | 1.2 | C42Q2206-MCT**** |
| | | | | | | | | | | | | | | 25.0 | 57.0 | 50.0 | 35.0 | 52.5 | 1.2 | C42Q2256-MST**** |

- 备注 Note: 1. “-”表示容量偏差。 “-”=capacitance tolerance code. M=±20%, K=±10%。
 2. “****”表示引线加工和包装代码(见表1)。“****”=lead form and packing code(refer to table 1).
 3. “#”当额定电压为 275Vac 时,第 4~5 位是 P2。“#”when the rated voltage is 275Vac, the digit 4~5 is P2.
 4. 不用于与电源串联的场合,与电源串联用请参见降压专用电容器 P153。
 Not for use in series with the mains, the capacitors for series with the mains, please refer Page153.
 5. “★”表示外壳为圆弧底。“★”=Arc bottom of the outer shell.

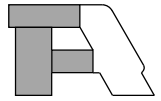

■ 外形尺寸 Dimensions(mm)
高性能型 High performance version

| 305Vac/275Vac [#] | | | | | | |
|----------------------------|------|------|------|------|-----|-----------------|
| C _N (μF) | W | H | T | P | d | Part number |
| 0.022 | 10.5 | 9.0 | 4.0 | 7.5 | 0.6 | C42Q2223-30**** |
| 0.027 | 10.5 | 11.0 | 5.0 | 7.5 | 0.6 | C42Q2273-30**** |
| 0.033 | 10.5 | 11.0 | 5.0 | 7.5 | 0.6 | C42Q2333-30**** |
| 0.039 | 10.5 | 12.0 | 6.0 | 7.5 | 0.6 | C42Q2393-30**** |
| 0.047 | 10.5 | 12.0 | 6.0 | 7.5 | 0.6 | C42Q2473-30**** |
| 0.033 | 13.0 | 11.0 | 5.0 | 10.0 | 0.6 | C42Q2333-40**** |
| 0.039 | 13.0 | 11.0 | 5.0 | 10.0 | 0.6 | C42Q2393-40**** |
| 0.047 | 13.0 | 11.0 | 5.0 | 10.0 | 0.6 | C42Q2473-40**** |
| 0.056 | 13.0 | 11.0 | 5.0 | 10.0 | 0.6 | C42Q2563-40**** |
| 0.068 | 13.0 | 12.0 | 6.0 | 10.0 | 0.6 | C42Q2683-40**** |
| 0.082 | 13.0 | 12.0 | 6.0 | 10.0 | 0.6 | C42Q2823-40**** |
| 0.12 | 13.0 | 14.0 | 8.0 | 10.0 | 0.6 | C42Q2124-40**** |
| 0.15 | 13.0 | 14.0 | 8.0 | 10.0 | 0.6 | C42Q2154-40**** |
| 0.010 | 17.5 | 11.0 | 5.0 | 15.0 | 0.8 | C42Q2103-60**** |
| 0.012 | 17.5 | 11.0 | 5.0 | 15.0 | 0.8 | C42Q2123-60**** |
| 0.015 | 17.5 | 11.0 | 5.0 | 15.0 | 0.8 | C42Q2153-60**** |
| 0.018 | 17.5 | 11.0 | 5.0 | 15.0 | 0.8 | C42Q2183-60**** |
| 0.022 | 17.5 | 11.0 | 5.0 | 15.0 | 0.8 | C42Q2223-60**** |
| 0.027 | 17.5 | 11.0 | 5.0 | 15.0 | 0.8 | C42Q2273-60**** |
| 0.033 | 17.5 | 11.0 | 5.0 | 15.0 | 0.8 | C42Q2333-60**** |
| 0.039 | 17.5 | 11.0 | 5.0 | 15.0 | 0.8 | C42Q2393-60**** |
| 0.047 | 17.5 | 11.0 | 5.0 | 15.0 | 0.8 | C42Q2473-60**** |
| 0.056 | 17.5 | 11.0 | 5.0 | 15.0 | 0.8 | C42Q2563-60**** |
| 0.068 | 17.5 | 11.0 | 5.0 | 15.0 | 0.8 | C42Q2683-60**** |
| 0.082 | 17.5 | 11.0 | 5.0 | 15.0 | 0.8 | C42Q2823-60**** |
| 0.10 | 17.5 | 11.0 | 5.0 | 15.0 | 0.8 | C42Q2104-60**** |
| 0.12 | 17.5 | 12.0 | 6.0 | 15.0 | 0.8 | C42Q2124-60**** |
| 0.15 | 17.5 | 12.0 | 6.0 | 15.0 | 0.8 | C42Q2154-60**** |
| 0.18 | 17.5 | 13.5 | 7.5 | 15.0 | 0.8 | C42Q2184-60**** |
| 0.22 | 17.5 | 13.5 | 7.5 | 15.0 | 0.8 | C42Q2224-60**** |
| 0.27 | 17.5 | 14.5 | 8.5 | 15.0 | 0.8 | C42Q2274-60**** |
| 0.33 | 17.5 | 16.0 | 10.0 | 15.0 | 0.8 | C42Q2334-60**** |
| 0.39 | 17.5 | 19.0 | 11.0 | 15.0 | 0.8 | C42Q2394-60**** |
| 0.47 | 17.5 | 19.0 | 11.0 | 15.0 | 0.8 | C42Q2474-60**** |

| 305Vac/275Vac [#] | | | | | | |
|----------------------------|------|------|------|------|-----|-----------------|
| C _N (μF) | W | H | T | P | d | Part number |
| 0.27 | 26.5 | 16.0 | 7.0 | 22.5 | 0.8 | C42Q2274-90**** |
| 0.33 | 26.5 | 16.0 | 7.0 | 22.5 | 0.8 | C42Q2334-90**** |
| 0.39 | 26.5 | 17.0 | 8.5 | 22.5 | 0.8 | C42Q2394-90**** |
| 0.47 | 26.5 | 17.0 | 8.5 | 22.5 | 0.8 | C42Q2474-90**** |
| 0.56 | 26.5 | 18.5 | 10.0 | 22.5 | 0.8 | C42Q2564-90**** |
| 0.68 | 26.5 | 18.5 | 10.0 | 22.5 | 0.8 | C42Q2684-90**** |
| 0.82 | 26.5 | 22.0 | 12.0 | 22.5 | 0.8 | C42Q2824-90**** |
| 1.0 | 26.5 | 22.0 | 12.0 | 22.5 | 0.8 | C42Q2105-90**** |
| 1.2 | 26.5 | 24.5 | 15.5 | 22.5 | 0.8 | C42Q2125-90**** |
| 1.5 | 26.5 | 24.5 | 15.5 | 22.5 | 0.8 | C42Q2155-90**** |
| 0.82 | 32.0 | 20.0 | 11.0 | 27.5 | 0.8 | C42Q2824-B0**** |
| 1.0 | 32.0 | 20.0 | 11.0 | 27.5 | 0.8 | C42Q2105-B0**** |
| 1.2 | 32.0 | 22.0 | 13.0 | 27.5 | 0.8 | C42Q2125-B0**** |
| 1.5 | 32.0 | 22.0 | 13.0 | 27.5 | 0.8 | C42Q2155-B0**** |
| 1.8 | 32.0 | 24.5 | 15.0 | 27.5 | 0.8 | C42Q2185-B0**** |
| 2.2 | 32.0 | 28.0 | 14.0 | 27.5 | 0.8 | C42Q2225-B0**** |
| 2.7 | 32.0 | 33.0 | 18.0 | 27.5 | 0.8 | C42Q2275-B0**** |
| 3.3 | 32.0 | 33.0 | 18.0 | 27.5 | 0.8 | C42Q2335-B0**** |
| 3.9 | 32.0 | 37.0 | 22.0 | 27.5 | 0.8 | C42Q2395-B0**** |
| 4.7 | 32.0 | 37.0 | 22.0 | 27.5 | 0.8 | C42Q2475-B0**** |
| 1.5 | 41.0 | 22.0 | 11.0 | 37.5 | 1.0 | C42Q2155-F0**** |
| ★1.8 | 41.0 | 26.0 | 12.0 | 37.5 | 1.0 | C42Q2185-F0**** |
| ★2.2M | 41.0 | 26.0 | 12.0 | 37.5 | 1.0 | C42Q2225MF0**** |
| 2.2K | 42.0 | 28.0 | 14.0 | 37.5 | 1.0 | C42Q2225KF0**** |
| 2.7 | 42.0 | 28.0 | 14.0 | 37.5 | 1.0 | C42Q2275-F0**** |
| 3.3 | 41.0 | 30.0 | 16.0 | 37.5 | 1.0 | C42Q2335-F0**** |
| 3.9 | 41.0 | 32.0 | 17.0 | 37.5 | 1.0 | C42Q2395-F0**** |
| 4.7 | 41.0 | 33.5 | 18.5 | 37.5 | 1.0 | C42Q2475-F0**** |
| 5.6 | 41.0 | 37.0 | 22.0 | 37.5 | 1.0 | C42Q2565-F0**** |
| 6.8 | 41.0 | 37.0 | 22.0 | 37.5 | 1.0 | C42Q2685-F0**** |
| 8.2 | 41.0 | 41.0 | 26.0 | 37.5 | 1.0 | C42Q2825-F0**** |
| 10.0 | 41.0 | 43.0 | 28.0 | 37.5 | 1.0 | C42Q2106-F0**** |

- 备注 Note: 1. “-”表示容量偏差。 “-”=capacitance tolerance code. M=±20%, K=±10%。
 2. “****”表示引线加工和包装代码(见表1)。“****”=lead form and packing code(refer to table 1).
 3. “#”当额定电压为 275Vac 时,第 4~5 位是 P2。“#” when the rated voltage is 275Vac, the digit 4~5 is P2.
 4. 不用于与电源串联的场合,与电源串联用请参见降压专用电容器 P153。
 Not for use in series with the mains, the capacitors for series with the mains, please refer Page 153.
 5. “★”表示外壳为圆弧底。“★”=Arc bottom of the outer shell.

X-ON Electronics

Largest Supplier of Electrical and Electronic Components

Click to view similar products for [Safety Capacitors](#) category:

Click to view products by [FARATRONIC](#) manufacturer:

Other Similar products are found below :

[B32022B3223K026](#) [B32912A3104K026](#) [46KI3470DQM1K](#) [B32913A3154K](#) [B81123C1102M003](#) [MKPY2-.02230020P15](#)
[46KN333000M1M](#) [46KN422000P0M](#) [DE1E3KX222MJ4BN01F](#) [46KR422000M1K](#) [HUB2200-S](#) [46KF268000M1M](#) [46KI3150NDM2M](#)
[PHE840MD6220MD13R30](#) [PHE840MY6470MD14R06](#) [PHE845VD5470MR06](#) [R463N4100ZAM1K](#) [MKPX2R-1/400/10P27](#)
[YP500101K040B20C2P](#) [YU0AH222M090DAMD0B](#) [LS1808N102K302NX080TM](#) [CY1471KE1IEB46X2A2](#) [CY1222ME5IEE48O2A2](#)
[MPX474K31DTEV158G0](#) [CY1471ME19EE45W2A2](#) [MPX104K31D2KN158HF](#) [MPX224K31D2KN158G0](#) [PX104K2W1502](#)
[YU1AH222M090DASD0H](#) [C47S1472K60C000](#) [MP2224K32C5J6LC](#) [H102M050FQ55250L750A](#) [MP2474K32D6R8LC](#)
[MP2224K32C3J6LC](#) [MP2104K32C3J6LC](#) [PX334K2C1006](#) [YU0AC222M080L20C7B](#) [MP2473K27B2X6LC](#) [MP2224K32D4J8LC](#)
[MP2684K32D6T8LC](#) [ST3Y1Y5U332M500VAC](#) [ST3Y1Y5V472M500VAC](#) [MP2474K32D4X8LC](#) [MP2474K32D4J8LC](#)
[YU0AH332M110L4EB0B](#) [CY1681ME1IEE45S2A2](#) [Y1220J-E1I-B4-AC400V](#) [Y1120K-E1I-B4-AC400V](#) [MP2154K32D2R8LC](#)
[ST1Y1Y5V222M500VAC](#)