

# PISMHV

For High Voltages up to 400V DC

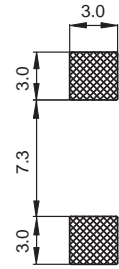

Recommended Layout for solder pads

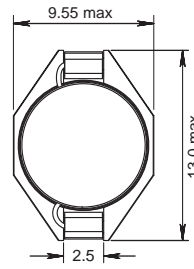
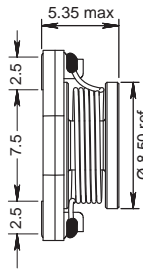
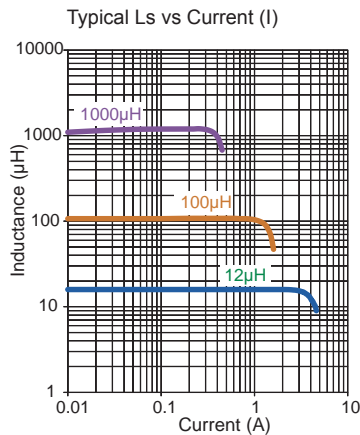
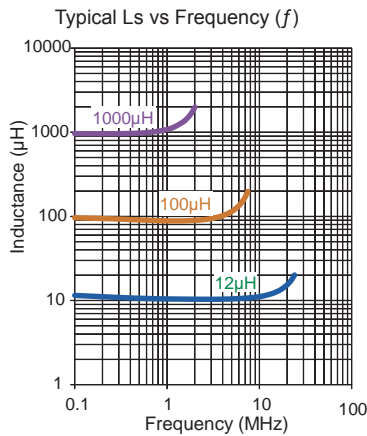

Part No	Inductance L (µH)	f <sub>L</sub> (MHz)	Tol ± (%)	SRF min (MHz)	DCR max (Ω)	Rated DC Current (A)	
						I <sub>sat</sub> typ	I <sub>ΔT</sub> = 40°C max
PISMHV-120M-04	12	0.1/1V	20	24	0.040	3.11	3.32
PISMHV-150M-04	15	0.1/1V	20	22	0.050	2.80	2.90
PISMHV-220M-04	22	0.1/1V	20	17	0.066	2.30	2.40
PISMHV-330M-04	33	0.1/1V	20	13	0.097	1.83	1.97
PISMHV-470M-04	47	0.1/1V	20	11	0.145	1.50	1.64
PISMHV-680M-04	68	0.1/1V	20	9.2	0.192	1.26	1.45
PISMHV-101M-04	100	0.1/1V	20	7.5	0.286	1.03	1.19
PISMHV-151M-04	150	0.1/1V	20	6.0	0.405	0.85	1.10
PISMHV-221M-04	220	0.1/1V	20	4.6	0.641	0.71	0.85
PISMHV-331M-04	330	0.1/1V	20	3.9	1.030	0.60	0.68
PISMHV-471M-04	470	0.1/1V	20	3.2	1.459	0.50	0.56
PISMHV-681M-04	680	0.1/1V	20	2.7	2.223	0.45	0.48
PISMHV-102M-04	1000	0.1/1V	20	2.0	3.483	0.35	0.40
PISMHV-222M-04	2200	0.1/1V	20	1.4	7.967	0.26	0.24

Core Material : Ferrite

Base Material : Plastic

Revision date : 06 Sep 2018

SPQ : Taped / Reel 750 [-04]

**Remarks :**

I<sub>sat</sub> & I<sub>ΔT</sub> - see description in Inductors Technical Data.

Terminal clip with lead-free tinned surface for SMT-Reflow soldering.

## X-ON Electronics

Largest Supplier of Electrical and Electronic Components

*Click to view similar products for [Fixed Inductors](#) category:*

*Click to view products by [Fastron](#) manufacturer:*

Other Similar products are found below :

[CR32NP-100KC](#) [70F224AI](#) [MHQ1005P10NJ](#) [MHQ1005P1N0S](#) [MHQ1005P2N4S](#) [MHQ1005P3N6S](#) [MHQ1005P5N1S](#) [MHQ1005P8N2J](#)  
[PE-53601NL](#) [PE-53602NL](#) [PG0936.113NLT](#) [9220-20](#) [9310-16](#) [PM06-2N7](#) [PM06-39NJ](#) [A01TK](#) [1206CS-471XJ](#) [HC2-R47-R](#) [HC8-1R2-R](#)  
[HCF1305-3R3-R](#) [1206CS-151XG](#) [RCH664NP-4R7M](#) [RCP1317NP-391L](#) [DH2280-4R7M](#) [DS1608C-106](#) [B10TJ](#) [B82498B3101J000](#) [ELJ-](#)  
[RE27NJF2](#) [1812CS-153XJ](#) [1812CS-183XJ](#) [1812CS-223XJ](#) [1812LS-104XJ](#) [1812LS-105XJ](#) [1812LS-124XJ](#) [1812LS-154XJ](#) [1812LS-223XJ](#)  
[1812LS-224XJ](#) [1812LS-563XJ](#) [1812LS-683XJ](#) [1812LS-824XJ](#) [NIN-FB101JTR110F](#) [NIN-FB471JTR62F](#) [NIN-FC1R5JTR220F](#) [NIN-](#)  
[HCR15JTRF](#) [NIN-HCR33JTRF](#) [NIN-HDR22JTRF](#) [NIN-HDR82JTRF](#) [NIN-HK2N7STRF](#) [NIN-PA150KTR370F](#) [NIN-PB100KTR550F](#)