

REVISIONS	
REV	ECN, ERN NO.
A	OCT16/12
PRODUCT DRAWING (EAR 14134)	
APPRD.	K.L.

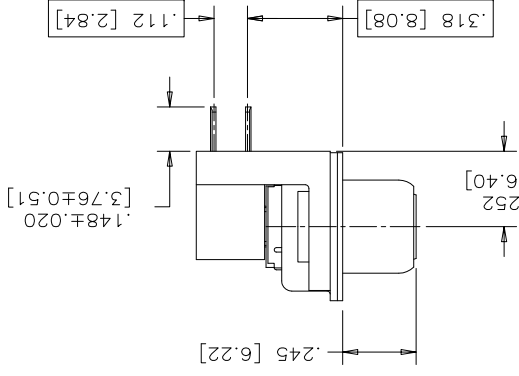
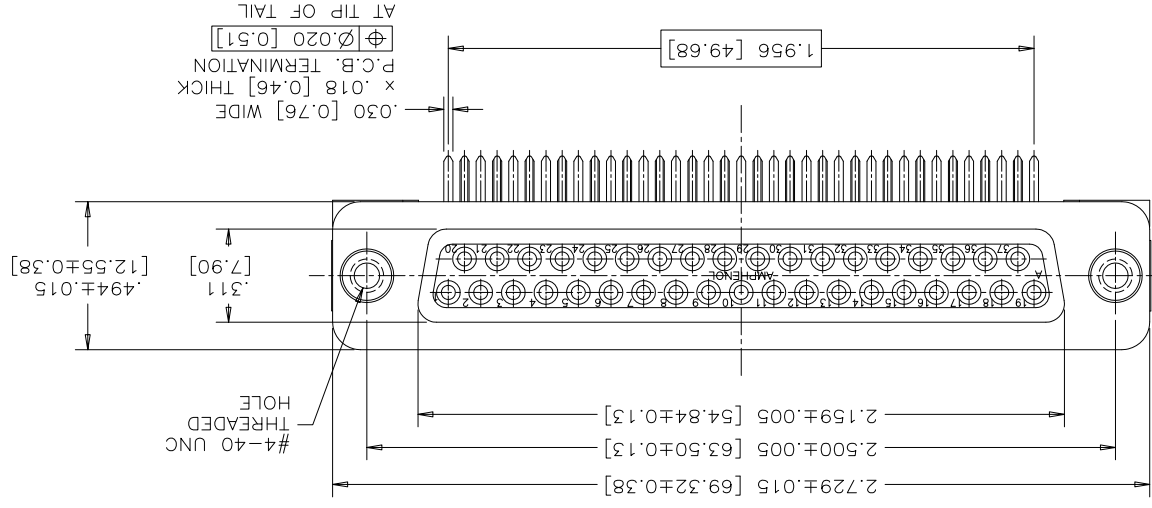
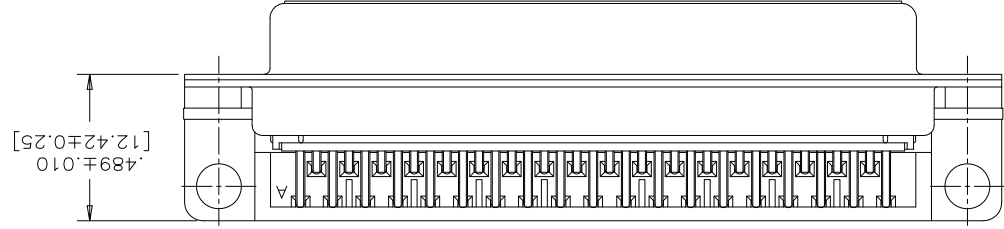

NOTES:

1. MATERIALS: - SHELLS - TIN PLATED STEEL  
- CONTACTS - PHOSPHOR BRONZE PLATED WITH 15µ" [0.38µm] GOLD OVER 50µ" [1.27µm] NICKEL ON THE MATING AREA AND TIN-LEAD ON THE TERMINALS  
- INSULATOR - ENGINEERING THERMOPLASTIC, FLAMMABILITY RATING UL94V-0, BLACK
2. CONTACT RESISTANCE: 15 MILLIOHMS MAXIMUM
3. INSULATION RESISTANCE: 3000 MEGOHMS MINIMUM
4. DIELECTRIC WITHSTANDING VOLTAGE: 600 VDC
5. CURRENT RATING: 5 AMPS MAXIMUM
6. OPERATING TEMPERATURE: -40°C TO 85°C
7. TOLERANCE, UNLESS INDICATED OTHERWISE, ±.005 [0.13]

THIS DOCUMENT CONTAINS PROPRIETARY INFORMATION AND SUCH INFORMATION MAY NOT BE DISCLOSED TO OTHERS FOR ANY PURPOSE OR USED FOR MANUFACTURING PURPOSES WITHOUT WRITTEN PERMISSION FROM AMPHENOL CANADA CORP.

ORDERING CODE: F C C 1 7 - C 3 7 S A - 3 9 1

SERIES: C37  
SIZE/NUMBER OF CONTACTS: 37  
CONNECTOR STYLE: S=SOCKET  
TERMINATION TYPE: A=.318" [8.08] FOOTPRINT  
MOUNTING: 3=#4-40 UNC THREAD

PERFORMANCE CHARACTERISTICS  
CATALOGUE FOR FILTER  
REFER TO AMPHENOL  
9=5600 pF ±15%  
1=BOARDLOCK OMITTED

MATERIAL	DATE	DRAWN	A.ESP/IE	OCT16/12
FINISH	CHECKED	DESIGNED		
	L. E. APPRD.			
	Q. A. APPRD.			
	DWG. APPRD.	K.LAMB/IE	OCT16/12	
ENG. REL. NO.	REF.	EAR	14134	
DIMENSIONS ARE IN INCHES [mm]	CODE ID. NO.	03554		
DWG. NO.	DWG.	C		
DRAWING NO.	P-FCC17-C37SA-391			
REV	A			

## X-ON Electronics

Largest Supplier of Electrical and Electronic Components

*Click to view similar products for [D-Sub Standard Connectors](#) category:*

*Click to view products by [Amphenol](#) manufacturer:*

Other Similar products are found below :

[DCM37S732N](#) [DAM15P500](#) [DEV09S364GTLF](#) [DEM09P032N](#) [DDM50P732N](#) [DAM15S332N](#) [173109-2218](#) [173109-2466](#) [173109-2436](#)  
[173109-2435](#) [56F706-005-LI](#) [56F711-015](#) [015-0341-000](#) [015-0372-008](#) [015-8544-011](#) [017041-0005](#) [020419-0104](#) [012-0515-000](#) [012-9507-](#)  
[034](#) [012-9507-114](#) [012-9534-001](#) [020745-0008](#) [609-25P](#) [M24308/2-23Z](#) [M243082310F](#) [M243082410F](#) [M243082411F](#) [M24308/4-21](#)  
[CT1A18-11PSA206](#) [CT1N36-5SC](#) [CT2-16S-17PS](#) [CT2-20-15PCAU](#) [CT2-24-12PS](#) [CT2-24-28PSF127A206](#) [CT2-32-9PC](#) [CT6F9767-14-4-](#)  
[14S-5PC](#) [CT6FA10SL-4PS](#) [CT7-18-10SC](#) [CT7-18-10SCAU](#) [CT7-18-12SCAU](#) [CT7-18-1PC](#) [CT7-18-1PCAU](#) [CT7-18-21SCAU](#) [M83513/01-](#)  
[FC](#) [M83723/76W24619 L/C](#) [M85049/48-3-2F](#) [69001-865](#) [6STD09PCM99B70X](#) [6STD09SCM99B30X](#) [6STD09SCT99S40X](#)