

	1	2	3	4
Technische Daten / Technical Data				
Empf. Mindeststrasterabstand / rec. center spacing:		2,60 mm		0,1024 inch
Federkraft / Spring Force		2,1 N ±15%		2,1 N ±15%
Vorspannung / Preload		1,0 N ±15%		1,0 N ±15%
A Maximaler Federweg / Max. Travel:		1,70 mm		0,0669 inch
	Empfohlener Kontakthub / Recomm. (rated) Travel:	1,00 mm		0,0394 inch
Temperaturbereich / Temperature Range		-55°C ... +250°C		-67°F ... +482°F
Typischer Widerstand / Typical Resistance		≤ 8 mΩ		≤ 8 mΩ
Typischer Nennstrom / Rated Current Load		15A		15A
E-Maß / Extension Height		5,90 mm		0,2323 inch
Typ. Federlebensdauer / Typ. Spring Life		1x10 ⁵ Lastwechsel		1x10 ⁵ load change
Werkstoffe / Materials				
Kolben / Plunger		Phosphorbronze, vergoldet		phosphor bronze, gold plated
Gehäusehülse / Barrel		Messing, vergoldet		brass, gold plated
B Feder / Spring		Edelstahl, unveredelt		stainless steel, not plated
	Kugel / Ball	Edelstahl, unveredelt		stainless steel, not plated

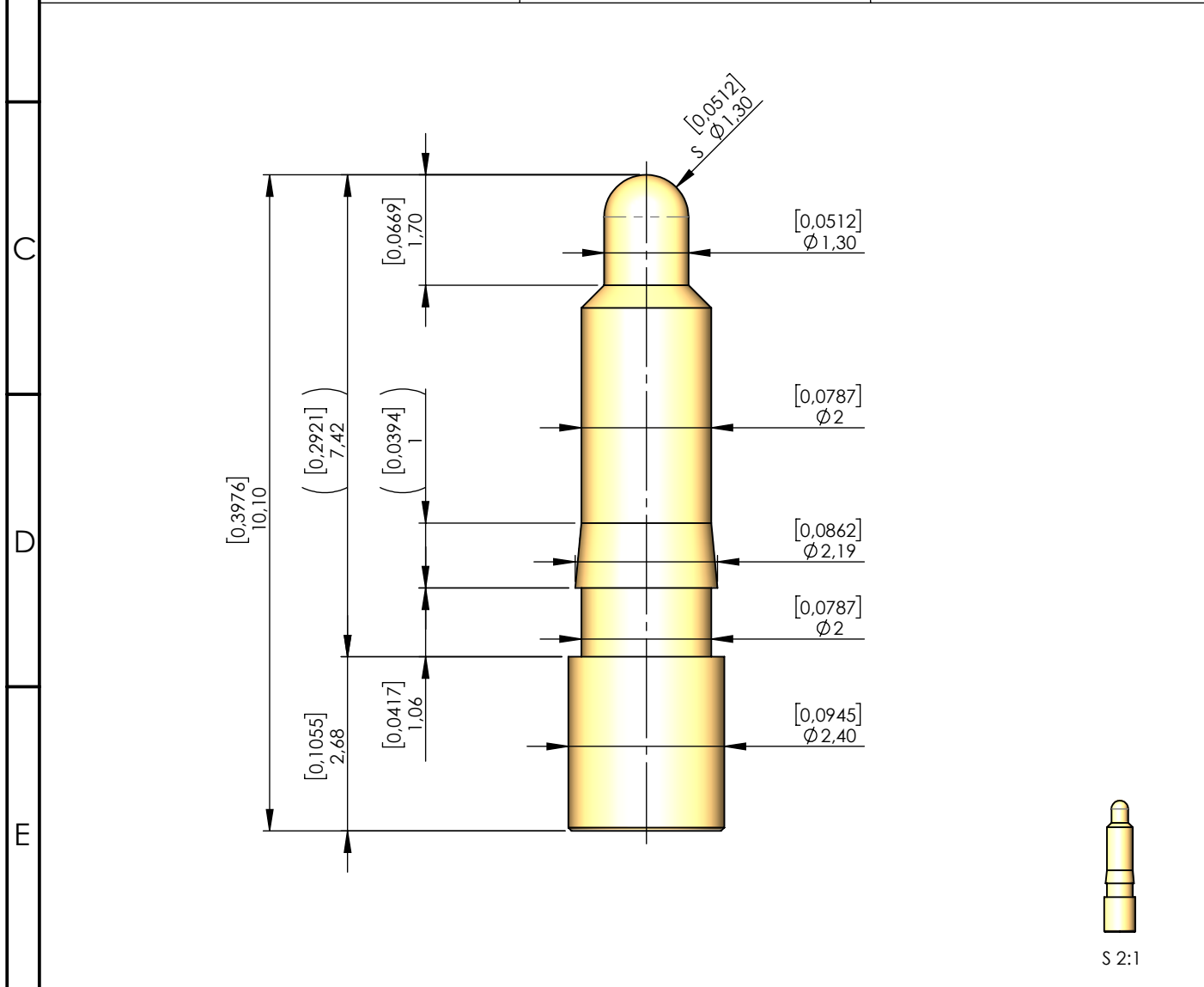

Unless otherwise defined Unit available in: mm / inch				Technical data sheet	
Name	Date	Note revision:	Title:		
created by PCh	07.03.2012	Änd.2.: Korrektur der Nennmaße	Batteriekontakt Battery probe		
checked by DBu	08.04.2020				
modified DBu	16.04.2020		Drawing number:		
Rev_A			FK-714		
Rev_B			Material:		
Rev_C			Scale: 10:1	Change 2	DIN A4 Page 2

X-ON Electronics

Largest Supplier of Electrical and Electronic Components

Click to view similar products for [Contact Probes](#) category:

Click to view products by [FIXTEST](#) manufacturer:

Other Similar products are found below :

[CT5253](#) [CT5082](#) [100039-033-958](#) [100077-003-0-0](#) [300122-031-1102](#) [R-2-RP-375](#) [S-4-C-5-G S/C](#) [300122-056-0203](#) [SS-75-B-2.4-G](#) [S-100-U-10-G-S](#) [SS-75-C-4.9-D D/C .620 OAL](#) [100165-033-952](#) [300106-000-1103](#) [100024-002-942](#) [SS-75-E-4.9-D D/C .620 OAL](#) [SX-0-U-2.2-G D/C](#) [101506-000](#) [101740-028-948](#) [ICT-100-V8-8-G S/C](#) [ICT-100-A-8-G S/C](#) [ICT-075-B-10-G-S S/C](#) [S-2-D-8.3-G D/C](#) [GSS-19-7-G S/C OAL](#) [ICT-100-T-8-G S/C](#) [GSS-4-7-G](#) [SS-40-J-2.4-G D/C](#) [S-0-A-2.2-D 660 S/C](#) [SS-50-J-3.3-D S/C](#) [S-0-V-3.7-G S/C](#) [SX-2-B-7-G D/C](#) [SX-1-U-6.6-G D/C](#) [SX-1-C-6.6-G D/C](#) [SS-75-D-4.9-D D/C .620 OAL](#) [SS-50-J-5.1-G S/C](#) [SS-50-E-2.9-G S/C](#) [SS-40-J-1.8-G-N/L D/C](#) [SS-3-7-G S/C W/HOLE .373 OAL](#) [SS-18-7-G S/C W/HOLE .405 OAL](#) [SS-10-7-G S/C W/HOLE .373 OAL](#) [SS-1-7-G S/C W/HOLE .385 OAL](#) [SHE-5-H-18.7-G](#) [SHE-5-B-18.7-G](#) [SHE-5-A-18.7-G](#) [SHE-3-A-7-G](#) [SH-4-A-10-G S/C](#) [101057-001-952](#) [S-50C-HS-4.3-DG-S](#) [S-5-F-8-G S/C SS](#) [SPGS](#) [S-5-F-16.4-G S/C](#) [S-4-K-5-G S/C](#)