

Manual Supplement

Manual Title: 28 II Ex Users
Print Date: November 2011
Revision/Date:

Supplement Issue: 1
Issue Date: 2/12
Page Count: 7

This supplement contains information necessary to ensure the accuracy of the above manual. This manual is distributed as an electronic manual on the following CD-ROM:

CD Title:	28 II Ex
CD Rev. & Date:	11/2011
CD PN:	3945765

Change #1, 60849 & 60854

On page 1, replace the second paragraph with:

The Product is designed for operation in potentially explosive areas of Zone 1, 2, 21, 22, and M1 as specified in Directive 1999/92/EC and 94/9/EC (ATEX). There can be dangerous consequences if you do not follow these instructions.

On page 2, replace the last bullet with:

Industrial use in potentially explosive areas of zone 1, 2, 21, 22, or M1, in accordance with ATEX requirements (see the EX safety instructions & regulations section)

On page 7, replace the entire page with:

Ex-Certification Data

- Ex-Type certificate no: PTB 11 ATEX 2028 X
IECEX PTB 11.0080X
- Ex-Designation: ATEX: II 2G Ex ia IIC T4 Gb
II 2D Ex ia IIIC T130 °C Db
I M1 Ex ia I Ma
IECEX: Ex ia IIC T4 Gb
Ex ia IIIC T130 °C Db
Ex ia I Ma
- CE: CE0102
- Operating Temperature: -15 °C to 50 °C
- Storage Temperature: -40 °C to +60 °C
- Batteries: 3 AAA Alkaline batteries, NEDA 24A IEC LR03. Table 7 shows the approved batteries for this Product.

For connections to intrinsically-safe circuits, observe these Product connections:

Voltage – measurement input $U_i = 65\text{ V}$:

- $U_0 = 9.54\text{ V}$
- $C_i = \text{negligible}$
- $I_0 = \text{negligible}$ $I_i = \text{negligible}$
- $L_i = \text{negligible}$

$P_0 = 3.4\text{ mW}$ $R_i = 2.47\text{K}$

Lo/Co						
Lo/mH	1000	100	2	0.5	0.1	0.01
Co/μF	0	0.61	1	1.4	2.1	3.6

Current – measurement input $I_i = 5\text{ A}$:

- $U_0 = 0\text{ V}$ $U_i = 65\text{ V}$
- $C_0 = 1000\text{ }\mu\text{F}$ $C_i = \text{negligible}$
- $I_0 = 0\text{ mA}$
- $L_0 = 1000\text{ mH}$ $L_i = \text{negligible}$
- $P_0 = 0\text{ mW}$
- mA/μA Jack
- $U_0 = 1.95\text{ V}$ $U_i = 65\text{ V}$
- $C_i = \text{negligible}$
- $I_0 = 9.7\text{ }\mu\text{A}$ $I_i = \text{Internally limited by a } 440\text{ mA fuse}$
- $L_i = \text{negligible}$
- $P_0 = \text{negligible}$

Lo/Co						
Lo/mH	1000	100	5	1	0.5	0.005
Co/ μ F	0	14	19	25	30	1000

For measurements on protected electric circuits:

- Approved for Zones 2 and 1, device group II, explosion group IIC (explosive gases, vapors and mist), temperature class T4.
- Approved for Zones 21 and 22, device group II, explosion group IIIC, conducting and non-conducting dust, fibers, and flyings.
- Approved for use in mines. Device group I, explosion group I, methane, and coal dust.

On page 43, replace Table 10 with:

Table 10. Replacement Parts

Description	Qty.	Fluke Part or Model Number
Fuse, 11 A, 1000 V, FAST	1	803293
28 II Ex Fuse Assembly	1	4016494
Alligator Clip, Black	1	AC172 or AC175
Alligator Clip, Red	1	
Test Lead Set	1	TL175
28 II Ex Manual Information Pack (Includes Users Manual, CD & Getting Started Manual)	1	4013990
Fluke Input Cap, Amp Jack Plugs for DMM's (10 packs)	1	4145825
<p> To ensure safety, use exact replacement only.</p>		

On page 44, replace Figure 12 with:

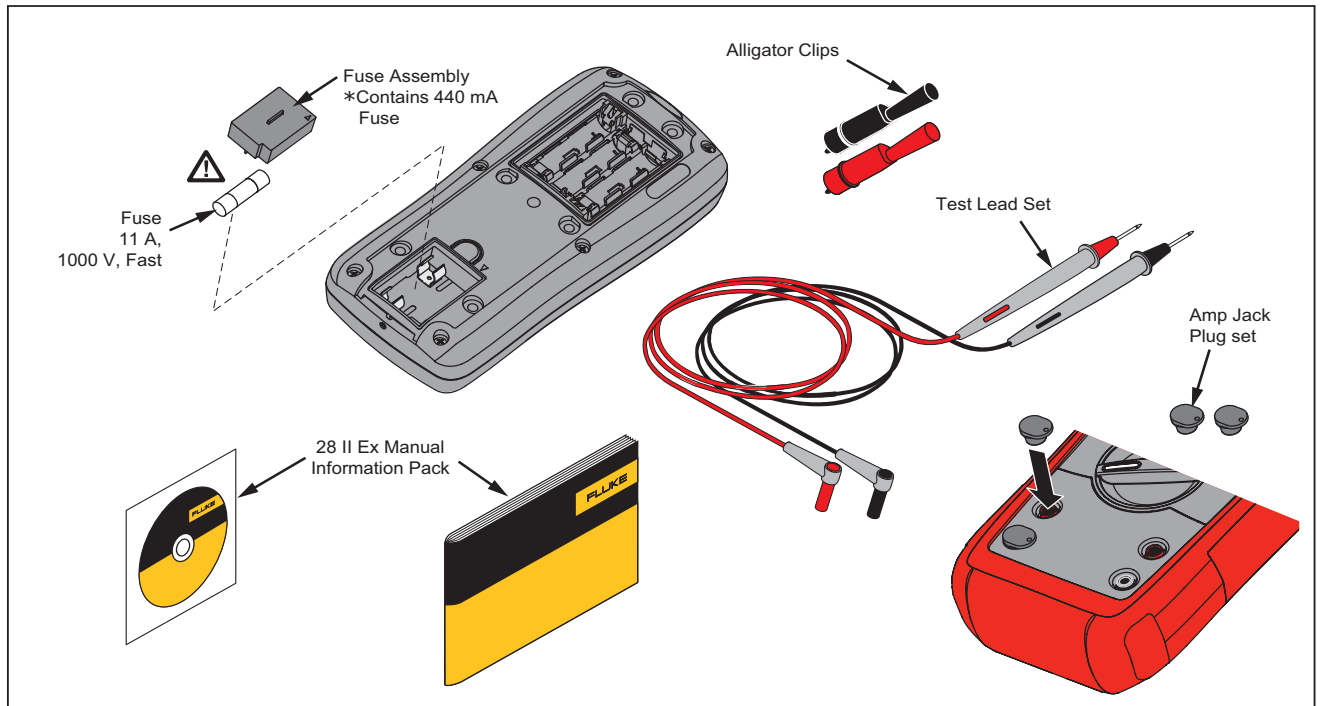

grt11.eps

Figure 12. Replacement Parts

On page 45, Replace Table 11 with:

Table 11. Accessories

Item	Description
AC172 or AC175	Alligator Clips
TL175	Silicone test lead set with probes
Amp Jack Plug Set	2 Pack for DMM's
I400	⚠ AC Current Clamp ^[1]
80PK-27	⚠ Temperature Probe ^[2]
<p>All accessories in this table are approved for use in explosive hazardous environments. Fluke accessories are available from an authorized Fluke distributor.</p> <p>[1] ⚠ Warning - To prevent personal injury or property damage, do not use this accessory in hazardous areas where dust is moved, transported, or conveyed.</p> <p>[2] ⚠ Warning - To prevent personal injury or property damage, do not use this accessory in dust hazardous areas.</p>	

On page 46, under **Temperature** replace Storage with:

Storage -40 °C to +85 °C (without battery)
 -40 °C to +60 °C (with battery)

On page 47, replace **Certifications** with:

CertificationsCSA, TÜV, CE,  ATEX, IECEx

X-ON Electronics

Largest Supplier of Electrical and Electronic Components

Click to view similar products for [Test Clips](#) category:

Click to view products by [Fluke](#) manufacturer:

Other Similar products are found below :

[010000](#) [923743-16](#) [BU-656-0](#) [4140A](#) [4324A](#) [TL820](#) [TL822](#) [5116](#) [5450](#) [5216](#) [5252](#) [5454](#) [5694](#) [923700](#) [923698](#) [CR0060](#) [3038](#) [927739-20](#)
[923743-14](#) [932146101](#) [930318100](#) [930126101](#) [Z-SB3FA3250AAAB04001](#) [Z-S11F0107G1000](#) [Z-S11F0207B1520](#) [Z-S11F0207B2030](#) [Z-](#)
[S11F0207B15000](#) [Z-SB3FA3226AAAB11001](#) [Z-S11F0207B1010](#) [923706](#) [930317800](#) [973889100](#) [972405100](#) [972405101](#) [R999720600](#) [949-](#)
[1](#) [458-3](#) [SK](#) [201200278](#) [020](#) [BU-65-B](#) [BU-21CPN-GZZZ](#) [PK-HVA-02](#) [BU-25C-DZZZ](#) [BU-142-2](#) [00425](#) [R8-1A RED](#) [R8-54 BLACK](#) [R8-](#)
[54 RED](#) [MA1SW](#) [MA260SH SW](#) [AX-CR-02-SET](#)