

PRELIMINARY

FUJITSU Component Relay FBR56-HW series Automotive relays

Fujitsu 1 Pole, 70 A relay

Features

- Smallest high power 70A relay (@23 °C, rating coil voltage)
- 1 pole 70A, 1 form C
- High temperature grade (-40°C to +125°C)
- This relay is able to replace the Mini ISO relay
- RoHS compliant



FBR56-HW

Part numbers

| Example | FBR56 (a) | N (b) | D12 (c) | -Y (d) | -HW (e) | -RW (f) |
|---------|-------------------------|----------|-------------------|-----------|---------------------------------------|------------|
| (a) | Series name | | FBR56-HW series | | | |
| (b) | Structure | | N Nil | | Plastic sealed type Flux free type | |
| (c) | Nominal voltage | | D09 D10 D12 | | 9 VDC 10 VDC 12VDC | |
| (d) | Contact material | | Y | | Silver-tin oxide | |
| (e) | Carrying current rating | | HW | | 70A | |
| (f) | Soldering | | Nil RW | | Standard Reflow version | |

Coil Data Chart

| Coil number | Nominal voltage (VDC) | Coil Resistance (ohms) (tolerance of 10%) | Operate Voltage (VDC) | Release Voltage (VDC) | Nominal Power [W] |
|-------------|-----------------------|--|-----------------------|-----------------------|-------------------|
| D09 | 9 | 170 | 5.4 | 0.7 | Approx. 0.45 |
| D10 | 10 | 220 | 6.3 | 0.8 | |
| D12 | 12 | 320 | 7.3 | 1.0 | |

All values in the table are measured at 20°C.

■ Specifications

| Item | Specifications | | |
|----------------------|------------------------|---|------------------|
| Contact | Arrangement | 1c (1 form C) | |
| | Material | Silver tin oxide | |
| | Rating | N.O.: 70A, 14VDC N.C.: 30A, 14VDC | |
| | Max. carrying current | N.O.: 70A (@ rating coil voltage) N.C.: 30A | |
| | Max. inrush current | 220A inrush (N.O.) | |
| | Min. switching load | 1A 6VDCX (reference) | |
| | Contact voltage drop | Max. 100mV (at 1A, 12VDC) | |
| Coil | Operating temperature | -40 to +125°C (no frost) | |
| Time value | Operate | Max. 10ms (at nominal voltage, without bounce) | |
| | Release | Max. 5ms (at nominal voltage, without diode, without bounce) | |
| Insulation | Resistance (at 500VDC) | Min. 100 MΩ | |
| | Dielectric Strength | Between contacts | 500VAC, 1 minute |
| | | Between coil and contacts | 500VAC, 1 minute |
| Life | Mechanical | Min. 1×10 ⁶ operations min. | |
| | Electrical Resistive | N.O. side 70A: 50 x 10 ³ operations min. N.O. side 60A: 100 x 10 ³ operations min. N.C. side 30A: 100 x 10 ³ operations min. | |
| Vibration resistance | Misoperation | 10 to 55 Hz at double amplitude of 1.5mm | |
| | Endurance | 10 to 55 Hz at double amplitude of 1.5mm | |
| Shock resistance | Misoperation | Min. 100m/s ² (11±1 ms) | |
| | Endurance | Min. 1,000m/s ² (6±1 ms) | |
| Weight | | 13g | |

Normal temperature and humidity

■ Dimensions

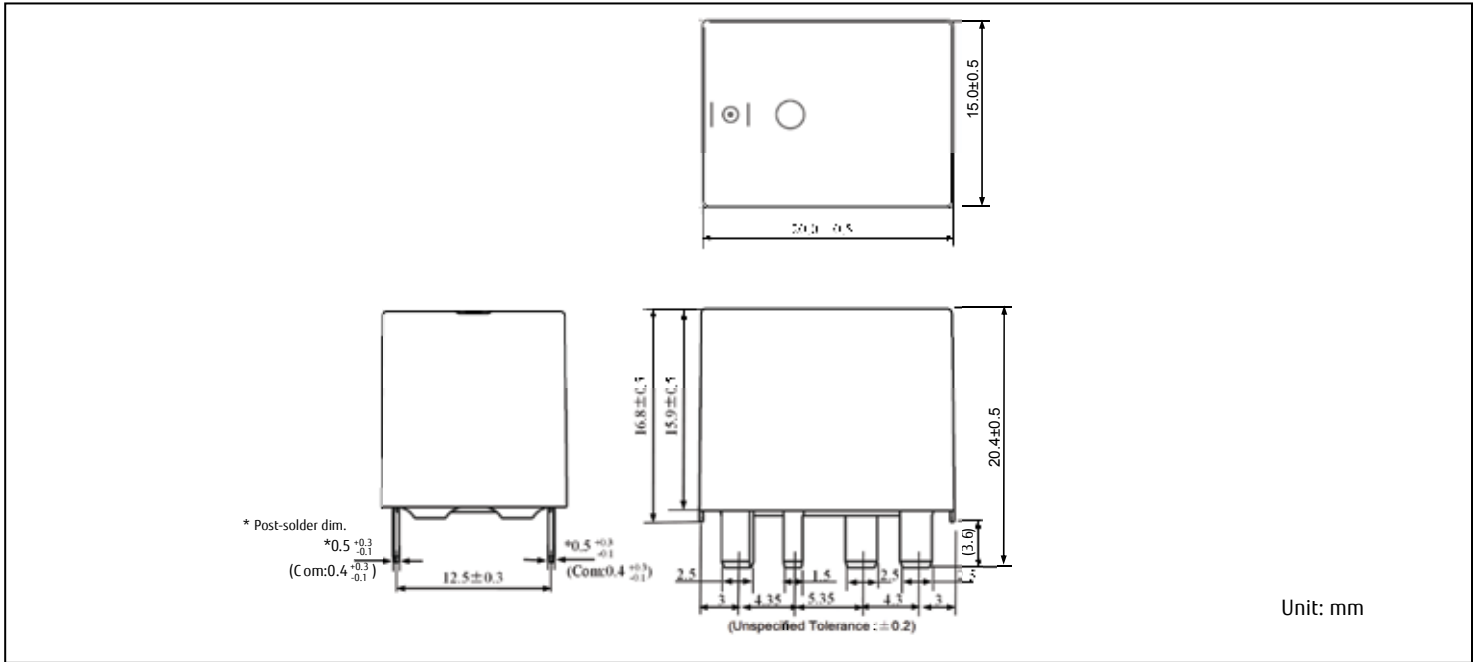

■ Schematics

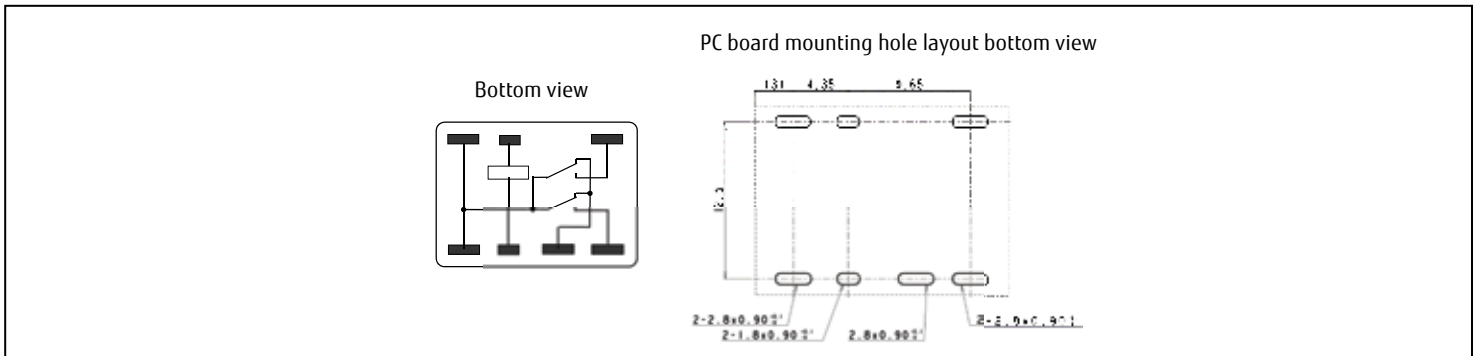

Contact

Japan
 FUJITSU COMPONENT LIMITED
 Shinagawa Seaside Park Tower
 12-4, Higashi-shinagawa 4-chome,
 Tokyo 140 0002, Japan
 Tel: (81-3) 3450-1681
 Fax: (81-3) 3474-2385
 Email: fcl-contact@cs.jp.fujitsu.com
 Web: www.fujitsu.com/jp/group/fcl/en/

Europe
 FUJITSU COMPONENTS EUROPE B.V.
 Diamantlaan 25
 2132 WV Hoofddorp
 Netherlands
 Tel: (31-23) 5560910
 Fax: (31-23) 5560950
 Email: info@fceu.fujitsu.com
 Web: www.fujitsu.com/uk/components/

China
 FUJITSU ELECTRONIC COMPONENTS
 (SHANGHAI) CO., LTD.
 Unit 4306, InterContinental Center
 100 Yu Tong Road, Shanghai 200070, China
 Tel: (86 21) 3253 0998 / Fax: (86 21) 3253 0997
 Email: fcsh@cn.fujitsu.com
 www.fujitsu.com/cn/products/devices/
 components/

Korea
 FUJITSU COMPONENTS KOREA, LTD.
 Alpha Tower #403,
 645 Sampyeong-dong,
 Bundang-gu, Seongnam-si,
 Gyeonggi-do, 13524 Korea
 Tel: (82 31) 708-7108
 Fax: (82 31) 709-7108
 Email: fcal@sg.fujitsu.com
 www.fujitsu.com/sg/products/
 devices/components/

North and South America
 FUJITSU COMPONENTS AMERICA, INC.
 2290 North First Street, Suite 212
 San Jose, CA 95131 U.S.A.
 Tel: (1-408) 745-4900
 Fax: (1-408) 745-4970
 Email: components@us.fujitsu.com
 Web: http://us.fujitsu.com/components/

Asia Pacific
 FUJITSU COMPONENTS ASIA, Ltd.
 102E Pasir Panjang Road
 #01-01 Citilink Warehouse Complex,
 Singapore 118529
 Tel: (65) 6375-8560 / Fax: (65) 6273-3021
 Email: fcal@sg.fujitsu.com
 www.fujitsu.com/sg/products/devices/
 components/

Hong Kong
 FUJITSU COMPONENTS HONG KONG Co., Ltd.
 Room 06, 28/F, Greenfield Tower, Concordia
 Plaza, No.1 Science Museum Road,
 Tsim Sha Tsui East, Kowloon, Hong Kong
 Tel: (852) 2881 8495 Fax: (852) 2894 9512
 Email: fcal@sg.fujitsu.com
 www.fujitsu.com/sg/products/devices/
 components/

Copyright

All trademarks or registered trademarks are the property of their respective owners. Fujitsu Components America or its affiliates do not warrant that the content of datasheet is error free. In a continuing effort to improve our products Fujitsu Components America, Inc. or its affiliates reserve the right to change specifications/datasheets without prior notice. Copyright ©2019 Fujitsu Components America, Inc. All rights reserved. Revised July 5, 2019.

X-ON Electronics

Largest Supplier of Electrical and Electronic Components

Click to view similar products for [Automotive Relays](#) category:

Click to view products by [Fujitsu](#) manufacturer:

Other Similar products are found below :

[7-1414968-8](#) [7-1617345-6](#) [9-1617516-5](#) [G5CE1ASIDC12](#) [1393204-2](#) [1393302-3](#) [13Z99A115-0074](#) [1432872-1](#) [1617057-2](#) [1617058-6](#)
[1617518-5](#) [2-1617057-2](#) [2-1617057-6](#) [2-1617058-3](#) [CB1F-M-12V-H15](#) [898H-1AH-D-001-12VDC](#) [24198-1](#) [4-1617057-0](#) [41FZ-200ACG-](#)
[BSL](#) [5-1616920-2](#) [5-1617052-9](#) [5407-0011-HS](#) [CB1AF-M-12V-H59](#) [5-1617346-8](#) [103-1AH-C-12VDC](#) [V23134A1052X299](#) [6-1393302-1](#)
[897H-1AH-D-R1-U01-12VDC](#) [FTR-P3CP024W1-06](#) [1-1617057-8](#) [3-1393305-1](#) [5436-0001-HS](#) [V23086-R1851-A502](#) [898H-1AH-D1SW-](#)
[R1-12VDC](#) [RH4C1P2607](#) [RE031005](#) [V23134M0052G242](#) [23234B0001X001-EV-144](#) [V23234-A1001-X036](#) [2138602-1](#) [3-1904020-8](#)
[FBR56ND12-W1](#) [S11-1A-C1-12VDC](#) [S11-1A-C1-24VDC](#) [FRC2U-DC12](#) [FRC7A-S-DC24V](#) [FTR-P6GN012WA](#) [LQ-12](#) [2-1414939-2](#)
[FRC7C-S-DC12V](#)