

Recommended PCB Layout

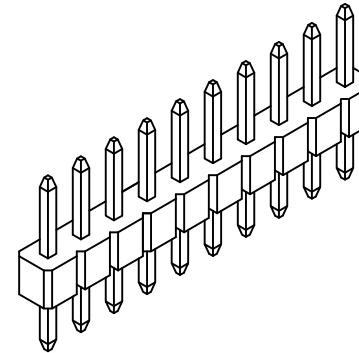
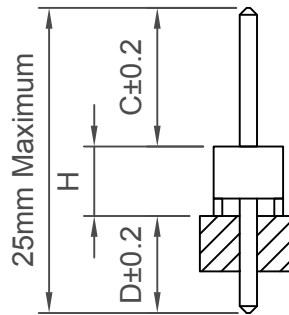
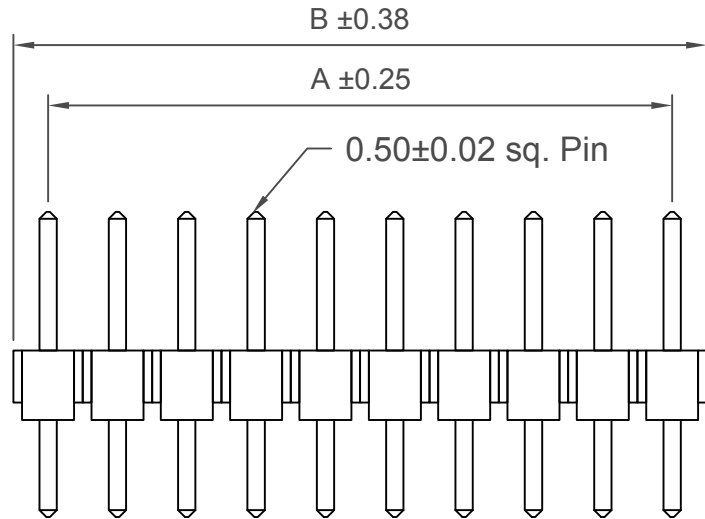

No. of Contacts	Dimensions	
	A	B
2	2.0	4.0
3	4.0	6.0
4	6.0	8.0
5	8.0	10.0
6	10.0	12.0
7	12.0	14.0
8	14.0	16.0
9	16.0	18.0
10	18.0	20.0
11	20.0	22.0
12	22.0	24.0
13	24.0	26.0
14	26.0	28.0
15	28.0	30.0
16	30.0	32.0
17	32.0	34.0
18	34.0	36.0
19	36.0	38.0
20	38.0	40.0

No. of Contacts	Dimensions	
	A	B
21	40.0	42.0
22	42.0	44.0
23	44.0	46.0
24	46.0	48.0
25	48.0	50.0
26	50.0	52.0
27	52.0	54.0
28	54.0	56.0
29	56.0	58.0
30	58.0	60.0
31	60.0	62.0
32	62.0	64.0
33	64.0	66.0
34	66.0	68.0
35	68.0	70.0
36	70.0	72.0
37	72.0	74.0
38	74.0	76.0
39	76.0	78.0
40	78.0	80.0

Specifications

Material

Insulator material:
 Standard
 Polyamide, Nylon 6T, UL 94V-0
 Options:
 Polymer, LCP, UL 94V-0
 Polyester, PBT, UL 94V-0
 Contact Terminal : Copper Alloy

Plating

See Ordering Grid

Electrical

Current Rating: 2 Amp per pin
 Contact Resistance: 20 mΩ max.
 Insulation Resistance: 1000 MΩ min.
 Dielectric Withstand Voltage: 500 V AC

Mechanical & Environmental

Operating Temperature: -40°C to +105°C

Soldering process:

Nylon 6T (Standard) -
 IR Reflow: 260°C for 10 sec.
 Wave: 230°C for 5-10 sec.
 Manual solder: 350°C for 3-5 sec

LCP (Option) -

IR Reflow: 260°C for 10 sec.
 Wave: 250°C for 5-10 sec.
 Manual solder: 350°C for 3-5 sec

PBT (Option) -

Manual Solder: 330°C for 3-5 sec
 (Not Suitable for High Temperature Process)

Mates with (subject to pin length):

BF070 BF085 BF086 BF087 BF088 BF090

BF085 Recommended mating length 3.00mm

Ordering Grid

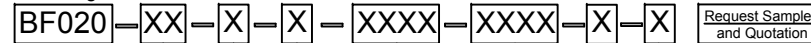

No. of Contacts
02 to 40

Contact Plating

A = Gold Flash All Over (Standard)
B = Selective Gold Flash Contact Area/Tin On Tail
C = Tin All Over
G = 10µ" Gold Contact Area/Tin On Tail
I = 30µ" Gold Contact Area/Tin On Tail

Insulator Height 'H'

B = 2.00mm (Standard)
A = 1.50mm

Request Samples and Quotation

Packing Options

G = Plastic Box (Standard)
D = Tube
E = Tube with Cap

Insulator Material

N = Nylon 6T (Standard)
P = PBT
L = LCP

Dimension D (1/100mm) (Tail Length)

0300 = 3.00mm (Standard)
 Or specify Custom Tail Length
 e.g. 2.50mm = 0250
 (Maximum 1500 = 15.00mm)
 (Minimum 0050 = 0.50mm)

Dimension C (1/100mm) (Post Height)

0300 = 3.00mm (Standard)
0400 = 4.00mm (Standard)
0600 = 6.00mm (Standard)
 Or specify Custom Post Height
 eg 0250 = 2.50mm
 (Maximum 1500 = 15.00mm)
 (Minimum 0050 = 0.50mm)

Part Number		Product Description	
BF020		2.00mm Pitch Pin Header	
Drawing Date		Single Row, Through Hole, Vertical	
25th October 2007			
By	CC	Tolerances (Except as Noted)	Units:
Detail	BF020 D PCN	Length X. ± 0.30 X.X ± 0.20 X.XX ± 0.15 X.XXX ± 0.10	Metric (mm)
Revision	D3	Angle X.X° ± 5° X.XX° ± 2° X.XXX° ± 1°	3rd Angle Projection
Date	11/09/17	X.XXX° ± 0.5°	



This drawing is confidential and copyright of Global Connector Technology, Ltd (GCT). This drawing must not be copied or disclosed without written consent. E & OE



www.gct.co

Not to Scale	Drawn By LYH	Sheet No. 1/1
--------------	--------------	---------------

X-ON Electronics

Largest Supplier of Electrical and Electronic Components

Click to view similar products for [Board to Board & Mezzanine Connectors](#) category:

Click to view products by [GCT](#) manufacturer:

Other Similar products are found below :

[589158040000018](#) [MDF7C-18P-2.54DSA\(55\)](#) [FCN-230C068-11](#) [FCN-268F012-G/BD](#) [FCN-268F036-G/BD](#) [FCN-268M012-G/0D](#) [FCN-268M024-G/1D](#) [FCN-723J004/1](#) [MIS-048-01-F-D-DP-K](#) [832-10-034-10-001000](#) [FX4C-80S-1.27DSA](#) [FCN-214Q030-G/0](#) [FCN-234P048-G/0](#) [FCN-235D050-G/C](#) [210-93-314-41-105000](#) [2-22603-0](#) [MDF7-40DP-2.54DSA\(55\)](#) [AXG720047](#) [5031084030](#) [MIT-114-03-F-D-K](#) [55323-1519](#) [DF33-2P-3.3DSA\(24\)](#) [YFT-20-05-H-03-SB-K](#) [503308-3040](#) [026-6203-PDB](#) [027-6203-PDB](#) [069159702701000](#) [10123981-102LF](#) [101A10019X](#) [55650-0588-C](#) [68684-306](#) [75140-7012](#) [589159005003045](#) [194261-1](#) [FCN-268F024-G0D](#) [10124054-515LF](#) [68685-603](#) [8-1616154-3](#) [MIS-019-01-F-D](#) [589159005002045](#) [541371078](#) [IL-WX-10PB-HF-B-E1000E](#) [FCN-268M024-G/3D](#) [20021832-06016C1LF](#) [KX15-20KLDL-E1000E](#) [MDF7-16DP-2.54DSA\(55\)](#) [AXE810124](#) [FCN-214J100-G/0](#) [FCN-230C068-E/S](#) [AXE812124](#)