

### R1 Type

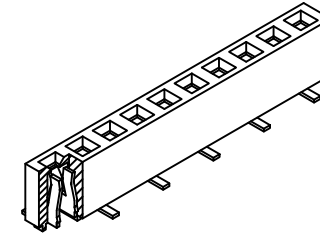

### R2 Type

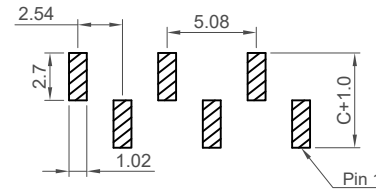
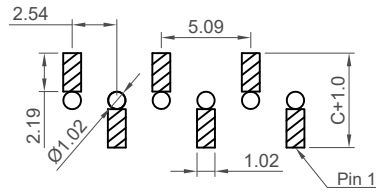
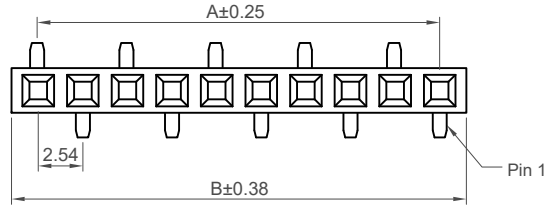
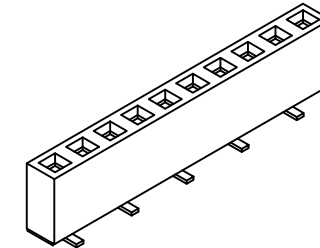
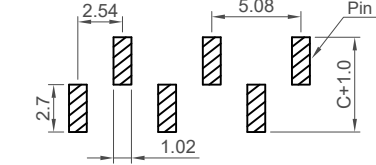
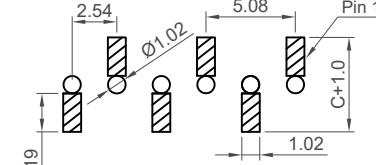
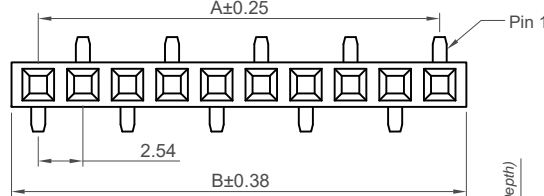

Insulator Height = 5.0mm: Pin Size = 0.75mm x 0.25mm  
 Insulator Height = 7.5mm: Pin Size = 0.60mm x 0.25mm

Insulator Height = 5.0mm: Min. Insertion Depth = 1.55mm  
 Insulator Height = 7.5mm: Min. Insertion Depth = 2.16mm

(Minimum Insertion Depth)

**Recommended PCB Layouts**  
 Bottom Entry General Tolerance ±0.05  
 Solder Area

**Recommended PCB Layouts**  
 Top Entry General Tolerance ±0.05  
 Solder Area

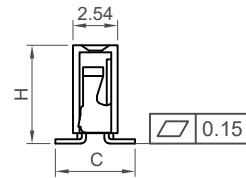

### Specifications

#### Material

Contact: Phosphor Bronze  
 Insulator Material:  
 Standard: Polyamide, Nylon 6T, UL 94V-0  
 Options: Polymer, LCP, UL 94V-0

#### Electrical

Current Rating: 3 Amp Per Pin  
 Insulator Resistance: 1000 MΩ min.  
 Contact Resistance: 20 mΩ max.  
 Dielectric Withstanding: AC 600 V

#### Environmental & Mechanical

Operating Temperature: -40° to +105°C  
 Soldering Process:

Nylon 6T (Standard) -  
 IR Reflow: 260°C for 10 sec.  
 Wave: 230°C for 5-10 sec.  
 Manual Solder: 350°C for 3-5 sec  
 LCP (Option) -  
 IR Reflow: 260°C for 10 sec.  
 Wave: 250°C for 5-10 sec.  
 Manual Solder: 350°C for 3-5 sec

#### Ordering Grid

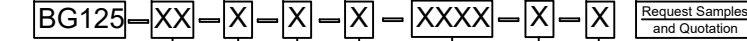

No. of Contacts  
02 to 40

#### Contact Plating

**A = Gold Flash All Over (Standard)**  
**B = Selective Gold Flash Contact Area/ Tin On Tail**  
**C = Tin All Over**  
**G = 10µ" Gold Contact Area/Tin On Tail**  
**I = 30µ" Gold Contact Area/Tin On Tail**

#### Height H

**1 = 5.00mm (Standard)**  
**2 = 7.50mm**

#### Packing Options

**C = Tape and Reel with Film (Standard)**  
**A = Tape and Reel**  
**B = Tape and Reel with Cap**  
**D = Tube**  
**E = Tube with Cap**  
**F = Tube with Film**

#### Insulator Material

**N = Nylon 6T (Standard)**  
**L = LCP**

#### Dimension C (Footprint Width) (1/100mm)

**0440 = 4.40mm (Standard when 'H' = 5.00mm)**  
**0420 = 4.20mm (Standard when 'H' = 7.50mm)**

#### Type

**1 = R1 Type**  
**2 = R2 Type**

Mates with (subject to pin length)

BG020 BG030 BG031 BG035  
 BG055 BG060 BG075 BG080

For bottom entry applications, stringent soldering control & pin alignment are required as lead to pad misalignment could cause incorrect mating.

Number of Contacts	Dimensions		
	A	B (H=5.0)	B (H=7.5)
2	2.54	5.58	5.08
3	5.08	8.12	7.62
4	7.62	10.66	10.16
5	10.16	13.20	12.70
6	12.70	15.74	15.24
7	15.24	18.28	17.78
8	17.78	20.82	20.32
9	20.32	23.36	22.86
10	22.86	25.90	25.40
11	25.40	28.44	27.94
12	27.94	30.98	30.48
13	30.48	33.52	33.02
14	33.02	36.06	35.56
15	35.56	38.60	38.10
16	38.10	41.14	40.64
17	40.64	43.68	43.18
18	43.18	46.22	45.72
19	45.72	48.76	48.26
20	48.26	51.30	50.80
21	50.80	53.84	53.34
22	53.34	56.38	55.88
23	55.88	58.92	58.42
24	58.42	61.46	60.96
25	60.96	64.00	63.50
26	63.50	66.54	66.04
27	66.04	69.08	68.58
28	68.58	71.62	71.12
29	71.12	74.16	73.66
30	73.66	76.70	76.20
31	76.20	79.24	78.74
32	78.74	81.78	81.28
33	81.28	84.32	83.82
34	83.82	86.86	86.36
35	86.36	89.40	88.90
36	88.90	91.94	91.44
37	91.44	94.48	93.98
38	93.98	97.02	96.52
39	96.52	99.56	99.06
40	99.06	102.10	101.60

Part Number		Product Description	
BG125		2.54mm Pitch Socket	
Drawing Date		Single Row, Surface Mount, Vertical, Dual Entry	
30th October 2006			
By	CC	Tolerances (Except as Noted)	Units:
Detail	BG125 H PCN	Length X. ± 0.30 XX ± 0.20 XXX ± 0.15 X.XXX ± 0.10	Metric (mm)
Revision	H3	Angle X.° ± 5° XX° ± 3° XXX° ± 2° X.XXX° ± 1°	RoHS COMPLIANT 2011/65/EU Deca-SIDE
Date	13/10/19	3rd Angle Projection	This drawing is confidential and copyright of Global Connector Technology, Ltd (GCT). This drawing must not be copied or disclosed without written consent. E & OE



Not to Scale	Drawn By AJO	Sheet No. 1/1
--------------	--------------	---------------

H  
G  
F  
E  
D  
C  
B  
A

## X-ON Electronics

Largest Supplier of Electrical and Electronic Components

*Click to view similar products for [Board to Board & Mezzanine Connectors](#) category:*

*Click to view products by [GCT](#) manufacturer:*

Other Similar products are found below :

[589158040000018](#) [MDF7C-18P-2.54DSA\(55\)](#) [FCN-230C068-11](#) [FCN-268F012-G/BD](#) [FCN-268F036-G/BD](#) [FCN-268M012-G/0D](#) [FCN-268M024-G/1D](#) [FCN-723J004/1](#) [MIS-048-01-F-D-DP-K](#) [832-10-034-10-001000](#) [FX4C-80S-1.27DSA](#) [FCN-214Q030-G/0](#) [FCN-234P048-G/0](#) [FCN-235D050-G/C](#) [210-93-314-41-105000](#) [2-22603-0](#) [MDF7-40DP-2.54DSA\(55\)](#) [AXG720047](#) [5031084030](#) [MIT-114-03-F-D-K](#) [55323-1519](#) [DF33-2P-3.3DSA\(24\)](#) [YFT-20-05-H-03-SB-K](#) [503308-3040](#) [026-6203-PDB](#) [027-6203-PDB](#) [069159702701000](#) [10123981-102LF](#) [101A10019X](#) [55650-0588-C](#) [68684-306](#) [75140-7012](#) [589159005003045](#) [063209](#) [194261-1](#) [FCN-268F024-G0D](#) [10124054-515LF](#) [68685-603](#) [8-1616154-3](#) [MIS-019-01-F-D](#) [589159005002045](#) [541371078](#) [IL-WX-10PB-HF-B-E1000E](#) [FCN-268M024-G/3D](#) [20021832-06016C1LF](#) [KX15-20KLDL-E1000E](#) [MDF7-16DP-2.54DSA\(55\)](#) [AXE810124](#) [FCN-214J100-G/0](#) [FCN-230C068-E/S](#)