

**RECOMMENDED PCB LAYOUT**  
General Tolerance: ±0.05

1.60 REF.  
Minimum  
Insertion  
Depth

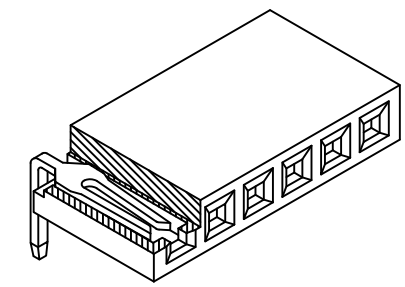
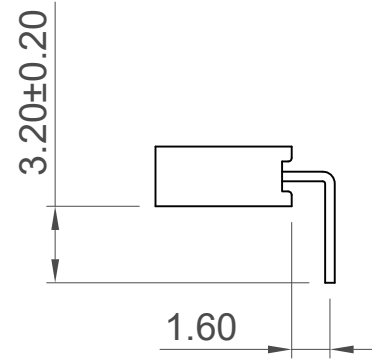
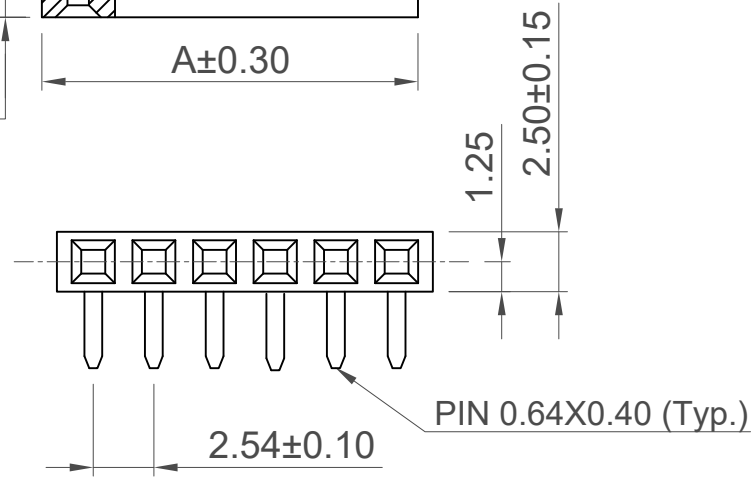

**Specifications 规格**

**Material 物料**  
Insulator 绝缘体: Polymer 聚合物, LCP, Natural, UL94V-0  
Contact 接触: Copper Alloy

**Plating 电镀**  
Underplating 底层电镀: 50µ"-100µ" Nickel all over  
Contact Area 接触部分: See ordering grid

**Electrical 电气**  
Current Rating 电流额定值: 3A per pin  
Contact Resistance 接触电阻值: 20 mΩ max.  
Insulating Resistance 绝缘电阻值: 1000 MΩ min.  
Dielectric Withstand Voltage 耐电压: 1000V AC

**Mechanical & Environmental 机械 & 环境**  
Operating Temperature 工作温度: -40°C to +105°C

**Soldering Process 可焊性:**  
Wave 波峰焊: 250°C for 5-10 secs  
Manual Solder 人工焊接: 350°C for 3-5 secs

**Mates with 配套之公头:**  
Use BG303 for perfect horizontal mating.  
(Standard mating pin length 3.00mm)  
配套卧式公头为BG303 (标准插入针长3.00mm)

**NOTES 备注:**  
Maximum mating pin length 4.25mm 最大容许插入针长4.25mm  
Standard black version of BG302 is BG145  
BG302的标准黑色塑胶版本为料号为BG145

**Ordering Grid**

BG302 - XX - X - L - X Request Samples and Quotation

No. of Contacts: 02 to 06  
Contact Plating: A = Gold Flash All Over  
(Other plating options available on request)

Packing Options: G = Plastic Box (Standard) MOQ 1000pcs  
D = Tube  
Insulator Material: L = LCP (Natural)

CONTACTS	DIMENSIONS	
	A	B
2	5.58	2.54
3	8.12	5.08
4	10.66	7.62
5	13.20	10.16
6	15.74	12.70

Part Number		Product Description		<b>GCT</b> www.gct.co	
BG302		2.54mm Pitch Socket, Single Row, Through-hole, Horizontal, Natural LCP			
Drawing Date		7th December 2011			
By	CC	Tolerances (Except as Noted)	Units:	 This drawing is confidential and copyright of Global Connector Technology, Ltd (GCT). This drawing must not be copied or disclosed without written consent. E & OE	
Detail	Drawing Release	Length	Metric (mm)		
Revision	A1	X.X ± 0.30			
Date	30/11/16	X.XX ± 0.20			
		3rd Angle Projection			
Not to Scale	Drawn By	Sheet No.			
	CM	1/1			

## X-ON Electronics

Largest Supplier of Electrical and Electronic Components

*Click to view similar products for [Board to Board & Mezzanine Connectors](#) category:*

*Click to view products by [GCT](#) manufacturer:*

Other Similar products are found below :

[589158040000018](#) [MDF7C-18P-2.54DSA\(55\)](#) [FCN-230C068-11](#) [FCN-268F012-G/BD](#) [FCN-268F036-G/BD](#) [FCN-268M012-G/0D](#) [FCN-268M024-G/1D](#) [FCN-723J004/1](#) [MIS-048-01-F-D-DP-K](#) [832-10-034-10-001000](#) [FX4C-80S-1.27DSA](#) [FCN-214Q030-G/0](#) [FCN-234P048-G/0](#) [FCN-235D050-G/C](#) [210-93-314-41-105000](#) [2-22603-0](#) [MDF7-40DP-2.54DSA\(55\)](#) [AXG720047](#) [5031084030](#) [MIT-114-03-F-D-K](#) [55323-1519](#) [DF33-2P-3.3DSA\(24\)](#) [YFT-20-05-H-03-SB-K](#) [503308-3040](#) [026-6203-PDB](#) [027-6203-PDB](#) [069159702701000](#) [10123981-102LF](#) [101A10019X](#) [55650-0588-C](#) [68684-306](#) [75140-7012](#) [589159005003045](#) [194261-1](#) [FCN-268F024-G0D](#) [10124054-515LF](#) [68685-603](#) [8-1616154-3](#) [MIS-019-01-F-D](#) [589159005002045](#) [541371078](#) [IL-WX-10PB-HF-B-E1000E](#) [FCN-268M024-G/3D](#) [20021832-06016C1LF](#) [KX15-20KLDL-E1000E](#) [MDF7-16DP-2.54DSA\(55\)](#) [AXE810124](#) [FCN-214J100-G/0](#) [FCN-230C068-E/S](#) [AXE812124](#)