

RECOMMENDED PCB LAYOUT
General Tolerance: ±0.05

1.60 REF.
Minimum
Insertion
Depth

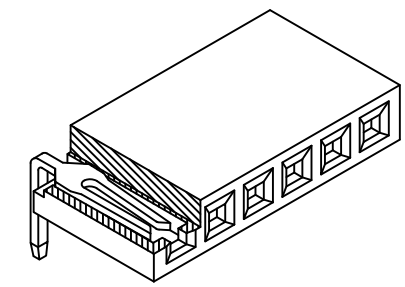
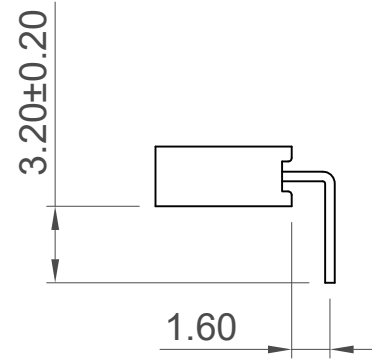
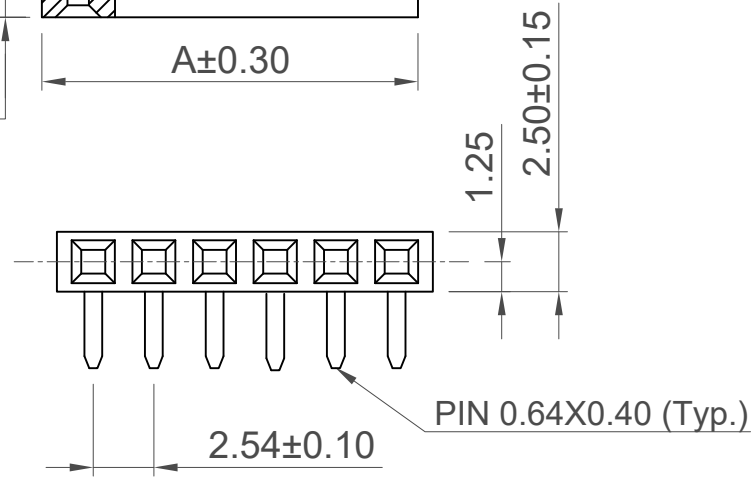

Specifications 规格

Material 物料
Insulator 绝缘体: Polymer 聚合物, LCP, Natural, UL94V-0
Contact 接触: Copper Alloy

Plating 电镀
Underplating 底层电镀: 50µ"-100µ" Nickel all over
Contact Area 接触部分: See ordering grid

Electrical 电气
Current Rating 电流额定值: 3A per pin
Contact Resistance 接触电阻值: 20 mΩ max.
Insulating Resistance 绝缘电阻值: 1000 MΩ min.
Dielectric Withstand Voltage 耐电压: 1000V AC

Mechanical & Environmental 机械 & 环境
Operating Temperature 工作温度: -40°C to +105°C

Soldering Process 可焊性:
Wave 波峰焊: 250°C for 5-10 secs
Manual Solder 人工焊接: 350°C for 3-5 secs

Mates with 配套之公头:
Use BG303 for perfect horizontal mating.
(Standard mating pin length 3.00mm)
配套卧式公头为BG303 (标准插入针长3.00mm)

NOTES 备注:
Maximum mating pin length 4.25mm 最大容许插入针长4.25mm
Standard black version of BG302 is BG145
BG302的标准黑色塑胶版本为料号为BG145

Ordering Grid

BG302 - XX - X - L - X Request Samples and Quotation

No. of Contacts: 02 to 06
Contact Plating: A = Gold Flash All Over
(Other plating options available on request)

Packing Options: G = Plastic Box (Standard) MOQ 1000pcs
D = Tube
Insulator Material: L = LCP (Natural)

CONTACTS	DIMENSIONS	
	A	B
2	5.58	2.54
3	8.12	5.08
4	10.66	7.62
5	13.20	10.16
6	15.74	12.70

Part Number BG302		Product Description 2.54mm Pitch Socket, Single Row, Through-hole, Horizontal, Natural LCP		GCT www.gct.co
Drawing Date 7th December 2011				
By CC	Detail Drawing Release	Tolerances (Except as Noted) Length X.X ± 0.30 X.XX ± 0.20	Units: Metric (mm)	 This drawing is confidential and copyright of Global Connector Technology, Ltd (GCT). This drawing must not be copied or disclosed without written consent. E & OE
Revision Date	A1 30/11/16			
Not to Scale		Drawn By CM	Sheet No. 1/1	

X-ON Electronics

Largest Supplier of Electrical and Electronic Components

Click to view similar products for [FFC & FPC Connectors](#) category:

Click to view products by [GCT manufacturer](#):

Other Similar products are found below :

[HFW11R-1STE1H1LF](#) [FH29B-100S-0.2SHW\(99\)](#) [FA5S008HP1](#) [FH29B-120S-0.2SHW\(99\)](#) [FH29B-80S-0.2SHW\(99\)](#) [FHS-16](#) [FPH-2022G](#)
[52610-1075](#) [52610-1275](#) [52610-1934](#) [XF3M\(1\)-1415-1B-R100](#) [501864-3091-TR225](#) [0525594033](#) [086210010340800](#) [086222026001800](#)
[52271-2869-CUT-TAPE](#) [62674-201121DLF](#) [62684-36210E9ALF](#) [52610-1675](#) [52746-1671-TR250](#) [10051922-2810EHLF](#) [6-520415-9](#)
[BD021-09A-A1-0350-0200-0550-LD](#) [SFV6R-1STE9HLF](#) [XF3M-2915-1B-R100](#) [1658549-1](#) [62674-221121ALF](#) [46214008010800](#)
[046298003000883](#) [151660622](#) [842-816-2630-035](#) [AYF530665TA](#) [AYF351525](#) [046296011930846+](#) [AYF352325A](#) [046254020000800+](#)
[FH19C-13S-0.5SH\(99\)](#) [FH39J-51S-0.3SHW\(99\)](#) [AYF355125A](#) [AYF530365TA](#) [FH29B-44S-0.2SHW\(99\)](#) [SFW5R-2STAE9LF](#) [AYF351125A](#)
[AYF350725A](#) [62684-502100AHLF](#) [FH39-61S-0.3SHW\(99\)](#) [AYF414035A](#) [10064555-172520HLF](#) [AYF212335A](#) [504754-2500](#)