

**CONDUCTIVE DUST CAPS**

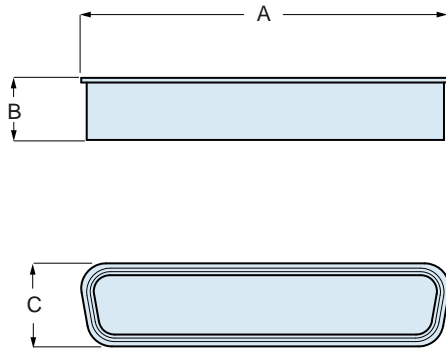

Black plastic conductive dust caps fit HiPer-D and M24308-type D-subminiature connectors. Molded in conductive polyethylene copolymer (EVA), these caps provide electrostatic discharge protection to sensitive equipment. 140°F maximum service temperature. These caps meet the static decay requirement of MIL-PRF-81705. Surface resistivity is less than  $1 \times 10^5$  ohms/square. Integral lip allows easy removal.

Conductive Dust Caps								
Shell Size	Type	Part Number	A Max.		B Max.		C Max.	
			In.	mm.	In.	mm.	In.	mm.
1	Pin	<a href="#">289-052-1-P</a>	.826	20.98	.300	7.62	.489	12.42
	Socket	<a href="#">289-052-1-S</a>	.743	18.87	.283	6.93	.411	10.44
2	Pin	<a href="#">289-052-2-P</a>	1.154	29.31	.300	7.62	.489	12.42
	Socket	<a href="#">289-052-2-S</a>	1.071	27.20	.283	6.93	.411	10.44
3	Pin	<a href="#">289-052-3-P</a>	1.694	43.03	.300	7.62	.489	12.42
	Socket	<a href="#">289-052-3-S</a>	1.611	40.92	.283	6.93	.411	10.44
4	Pin	<a href="#">289-052-4-P</a>	2.342	59.49	.300	7.62	.489	12.42
	Socket	<a href="#">289-052-4-S</a>	2.259	57.38	.283	6.93	.411	10.44
5	Pin	<a href="#">289-052-5-P</a>	2.239	56.87	.300	7.62	.601	15.27
	Socket	<a href="#">289-052-5-S</a>	2.164	54.97	.283	6.93	.523	13.28
6	Pin	<a href="#">289-052-6-P</a>	2.372	60.25	.300	7.62	.663	16.84
	Socket	<a href="#">289-052-6-S</a>	2.289	58.14	.283	6.93	.586	14.88

## X-ON Electronics

Largest Supplier of Electrical and Electronic Components

*Click to view similar products for* [Circular MIL Spec Tools, Hardware & Accessories](#) *category:*

*Click to view products by* [Glenair](#) *manufacturer:*

Other Similar products are found below :

[809-199-3](#) [001104](#) [300 04](#) [600-006-16](#) [600-079-06](#) [M10-101982-143](#) [M10-101982-163](#) [M10-101983-183](#) [M10-150912-083](#) [M10-454396-008](#) [602GB18808](#) [M225201-06](#) [M24758-20E21](#) [M2887610-BC](#) [M2887615-CD](#) [M38999/9-19B](#) [62GB-812-10](#) [630A007NF083A](#) [630B007M051A](#) [630BJ003NF032H](#) [637-149NF04B](#) [M39029/29-215](#) [650FS002NF16](#) [M81969-14-02](#) [660-008NF14S7-01](#) [660-009M22H8-03](#) [660-013NF19U6-210](#) [660-015M10S6-17](#) [660-015NF10S5-01](#) [660-015NF14R3.5-01](#) [660-023NF19H6-19](#) [660-024N09S5-104](#) [660-024NF11S12-01](#) [660-024NF11S3-01](#) [660-050XM17F4-01](#) [660-068NF25R6-30G](#) [660-070M23S8-04](#) [660-073MTCH9-20](#) [M83723/60-116RC](#) [M83723/61-18W](#) [M83723/61-218R](#) [M83723/61-224W](#) [667-224NF16](#) [M85049/118S22A](#) [M85049/126S11N](#) [M85049130-07M](#) [M85049140-09BC](#) [M85049/41-16A W/B](#) [687-697NF-1](#) [M85049/75-14-1](#) [M8504980-8](#)