

Series 80 Mighty Mouse Contacts and Tools

Size #23 Non-Removable Crimp Contacts



Size #23 crimp contacts for AWG #20 wire (Non-Removable)

Standard size #23 contacts accept #22 to #28 AWG wire. Choose "large bore" versions for #20 to #22 AWG wire. Contacts are bulk packaged. Terminate with standard M22520 crimper with special positioner. **Note contacts are installed with standard size #23 insertion tools.**

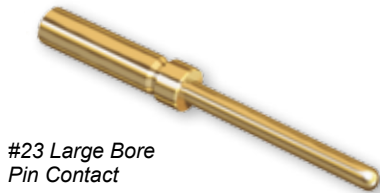

#23 Large Bore
Pin Contact



#23 Small Bore
Socket Contact

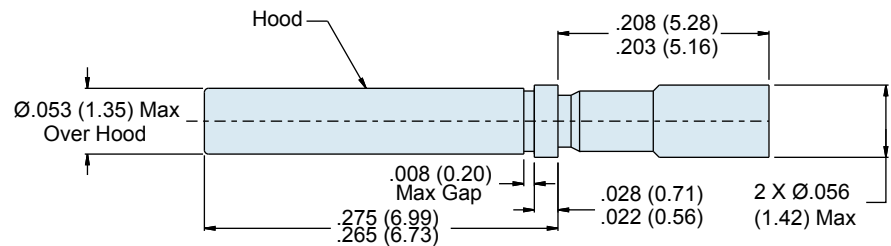
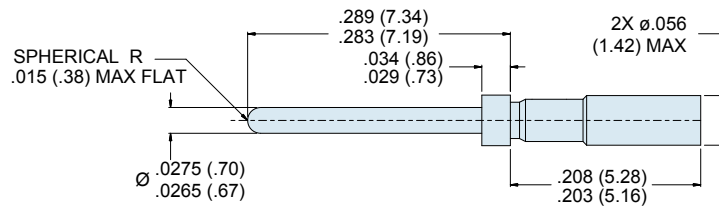

NOTES

Material and Finish

- Contact: beryllium copper alloy per ASTM B 196 or ASTM B 197, 50 microinches gold plated per ASTM B488 Type II Code C Class 1.25 over nickel underplate
- Socket contact hood: stainless steel, passivated per AMS-QQ-P-35.

Specifications

- Current Rating: 5 Amps maximum
- Voltage Drop (at 5 Amps and 25° C): 70 millivolts maximum
- Temperature Range: -65° to + 175° C
- Socket Contact Minimum Separation Force: 0.5 ounces

Crimp Tools and Insertion/Removal Tools

- Crimper: M22520/2-01 Pin/Socket
- Positioner: 809-301 (large bore).

Size #23 Non-Removable Crimp Contacts

Contact Type	Wire Size	Material	Part Number	Color Band	Tool Code
Pin	#23 - #20	BeCu	809-299	None	A, S
Socket	#23 - #20	BeCu	809-300	None	A, S

Crimp Tensile Strength

(Values are in pounds and are minimums.)

Wire Gage	Axial Load
#20	20
#22	12

Dimensions in Inches (millimeters) are subject to change without notice.

X-ON Electronics

Largest Supplier of Electrical and Electronic Components

Click to view similar products for [Circular MIL Spec Contacts](#) category:

Click to view products by [Glenair](#) manufacturer:

Other Similar products are found below :

[006-1189-20](#) [71-VEAM](#) [809-023](#) [809-111](#) [811393-000](#) [850-014](#) [97-45-1418P-5\(920\)](#) [97-45-1418S-4](#) [D-602-0106CS076](#) [AIC12-14P](#)
[AIC16-16PG](#) [AIC8-12P](#) [AIC8-8SG](#) [AIC8-8SRAD](#) [1495044-1](#) [BACC47CP2T](#) [BACC47CP3S](#) [BACC47DP4](#) [BACC47GC1A](#) [BACC47GN1](#)
[16968/2C](#) [173-900245-91](#) [241611N001](#) [2560-220-2031](#) [27915-38T9](#) [27964-38T112](#) [2M809-118](#) [97-67-36-20](#) [AIC12-16P](#) [AIC16-14SG](#)
[AIC16-18PG](#) [AIC16-18S](#) [AIC16-20PG](#) [AIC4-4PG](#) [CE102S-18](#) [M39029/30-221](#) [M39029/77-430](#) [416-2020-088I](#) [MDM-21SH003B-F222](#) [48-](#)
[100-5014P-02](#) [BA-4020-50LD](#) [BA-4120-50LD](#) [BACC47CN2](#) [BACC47GC3A](#) [BACC47GD3A](#) [BACC47GM1](#) [52G137 REV A](#) [CB2-18-21PS](#)
[D-602-1116CS2727](#) [D-602-1117CS2727](#)