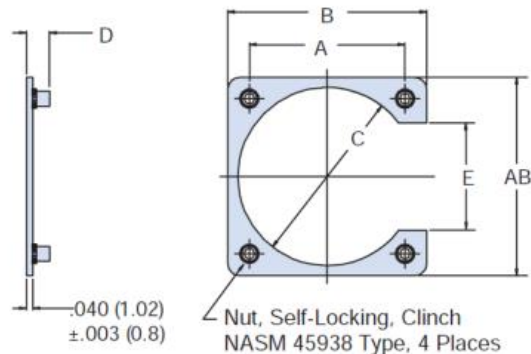

Basic
Part NumberA = Primer Coat
Required
M85049/95 - 10A - A
Shell Size
and Class
B
APPLICATION NOTES

1. Assembly identified with manufacturer's name and part number, space permitting.
2. For complete dimensions, see the applicable Military Specification.
3. Metric dimensions (mm) are in parentheses.

TABLE I: Reference for Connector Shell Size

Shell Size & Class	Thread UNJC-3B	A ±.003 (0.1)		B ±.015 (0.4)		C ±.015 (0.4)		D Max	E ±.030 (0.8)
3A	4-40	.625	(15.9)	.925	(23.5)	.641	(16.3)	.166 (4.2)	.325 (8.3)
7A	4-40	.719	(18.3)	1.019	(25.9)	.688	(17.5)	.166 (4.2)	.433 (11.0)
8A	4-40	.594	(15.1)	.880	(22.4)	.570	(14.5)	.166 (4.2)	.308 (7.8)
10A	4-40	.719	(18.3)	1.019	(25.9)	.720	(18.3)	.166 (4.2)	.433 (11.0)
10B	6-32	.812	(20.6)	1.312	(33.3)	.749	(19.0)	.183 (4.6)	.433 (11.0)
12A	4-40	.812	(20.6)	1.104	(28.0)	.855	(21.7)	.166 (4.2)	.530 (13.5)
12B	6-32	.938	(23.8)	1.312	(33.3)	.938	(23.8)	.183 (4.6)	.530 (13.5)
14A	4-40	.906	(23.0)	1.198	(30.4)	.984	(25.0)	.166 (4.2)	.624 (15.8)
14B	6-32	1.031	(26.2)	1.406	(35.7)	1.031	(26.2)	.183 (4.6)	.624 (15.8)
16A	4-40	.969	(24.6)	1.280	(32.5)	1.094	(27.8)	.166 (4.2)	.687 (17.4)
16B	6-32	1.125	(28.6)	1.500	(38.1)	1.125	(28.6)	.183 (4.6)	.687 (17.4)
18A	4-40	1.062	(27.0)	1.406	(35.7)	1.220	(31.0)	.166 (4.2)	.780 (19.8)
18B	6-32	1.203	(30.6)	1.578	(40.1)	1.234	(31.3)	.183 (4.6)	.780 (19.8)
19A	4-40	.906	(23.0)	1.192	(30.3)	.953	(24.2)	.166 (4.2)	.620 (15.7)
20A	4-40	1.156	(29.4)	1.535	(39.0)	1.345	(34.2)	.166 (4.2)	.874 (22.2)
20B	6-32	1.297	(32.9)	1.688	(42.9)	1.359	(34.5)	.183 (4.6)	.865 (22.0)
22A	4-40	1.250	(31.8)	1.665	(42.3)	1.478	(37.5)	.166 (4.2)	.968 (24.6)
22B	6-32	1.375	(34.9)	1.738	(44.1)	1.483	(37.7)	.183 (4.6)	.907 (23.0)
24A	6-32	1.500	(38.1)	1.891	(48.0)	1.560	(39.6)	.183 (4.6)	1.000 (25.4)
24B	6-32	1.375	(34.9)	1.785	(45.3)	1.595	(40.5)	.183 (4.6)	1.031 (26.2)
25A	6-32	1.500	(38.1)	1.891	(48.0)	1.658	(42.1)	.183 (4.6)	1.125 (28.6)
27A	4-40	.969	(24.6)	1.255	(31.9)	1.094	(27.8)	.166 (4.2)	.683 (17.3)
28A	6-32	1.562	(39.7)	2.000	(50.8)	1.820	(46.2)	.183 (4.6)	1.125 (28.6)
32A	6-32	1.750	(44.5)	2.312	(58.7)	2.062	(52.4)	.183 (4.6)	1.188 (30.2)
36A	6-32	1.938	(49.2)	2.500	(63.5)	2.312	(58.7)	.183 (4.6)	1.375 (34.9)
37A	4-40	1.187	(30.1)	1.500	(38.1)	1.281	(32.5)	.166 (4.2)	.874 (22.2)
61A	4-40	1.437	(36.5)	1.812	(46.0)	1.594	(40.5)	.166 (4.2)	1.602 (40.7)

Dimensions in inches (millimeters) and are subject to change without notice.

X-ON Electronics

Largest Supplier of Electrical and Electronic Components

Click to view similar products for [Circular MIL Spec Tools, Hardware & Accessories](#) *category:*

Click to view products by [Glenair](#) *manufacturer:*

Other Similar products are found below :

[0113-201-2025](#) [600-079-06](#) [600-146-06](#) [M10-101983-183](#) [M10-454396-008](#) [602GB18808](#) [CS3102A-22-14PW](#) [M2887615-CD](#) [627-009](#)
[M38999/9-19B](#) [630A007NF083A](#) [630B007M051A](#) [630BJ003NF032H](#) [637-149NF04B](#) [M39029/29-215](#) [6408-203V-09273](#) [6426-201-11343](#)
[650FS002NF16](#) [660-008NF14S7-01](#) [660-009M22H8-03](#) [660-013NF19U6-210](#) [660-015M10S6-17](#) [660-015NF10S5-01](#) [660-015NF14R3.5-01](#)
[660-023NF19H6-19](#) [660-024NF11S12-01](#) [660-024NF11S3-01](#) [660-024NF17S4-109](#) [660-050XM17F4-01](#) [660-068NF25R6-30G](#) [660-](#)
[070M23S8-04](#) [660-073MTCH9-20](#) [M83723/61-18W](#) [M83723/61-218R](#) [M83723/61-224W](#) [667-084-23C](#) [667-084-35C](#) [667-224NF16](#) [687-](#)
[697NF-1](#) [M85049/94-10-A](#) [M85049/96-7-A](#) [M855282-10A01A](#) [M85528/2-10B](#) [M855282-18A01A](#) [M85528/2-22A01A](#) [M85528/2-22AA](#)
[710HS460NF2508](#) [780-001-22G12-SK](#) [780-002-19G12-SK](#) [780-002-20G12SK](#)