

# M85528/1 Mounting Flange, Full Perimeter

**M85528/1-10 A**

Basic Part No. \_\_\_\_\_ A = Primer Coat  
Shell Size \_\_\_\_\_ Required

Note: part superceded by M85049/94

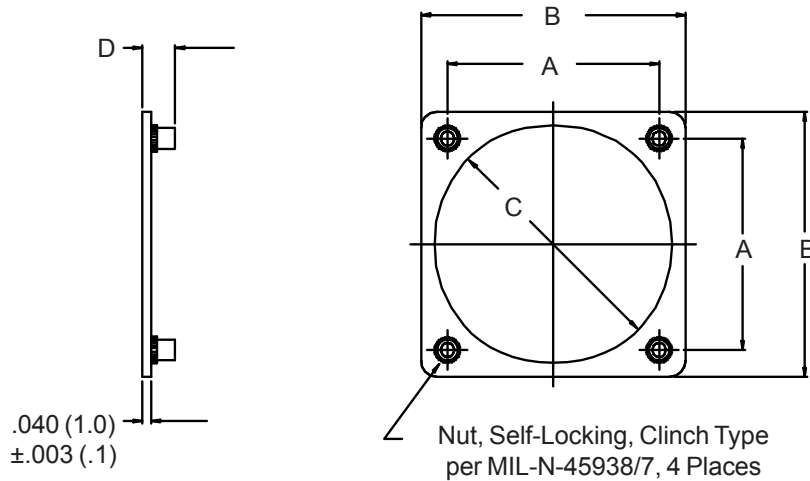

TABLE I

Shell Size	Thread UNJC-3B	A		B		C		D	
		±.003 (.1)	(.1)	±.015 (.4)	(.4)	-.010 (.3)	(.3)	±.030 (.8)	(.8)
8	4-40	.594	(15.1)	.880	(22.4)	.570	(14.5)	.136	(3.5)
10	4-40	.719	(18.3)	1.005	(25.5)	.700	(17.8)	.136	(3.5)
12	4-40	.812	(20.6)	1.098	(27.9)	.820	(20.8)	.136	(3.5)
14	4-40	.906	(23.0)	1.192	(30.3)	.945	(24.0)	.136	(3.5)
16	4-40	.969	(24.6)	1.255	(31.9)	1.070	(27.2)	.136	(3.5)
18	4-40	1.062	(27.0)	1.348	(34.2)	1.196	(30.4)	.136	(3.5)
20	4-40	1.156	(29.4)	1.500	(38.1)	1.320	(33.5)	.136	(3.5)
22	4-40	1.250	(31.8)	1.625	(41.3)	1.440	(36.6)	.136	(3.5)
24	6-32	1.375	(34.9)	1.750	(44.5)	1.570	(39.9)	.153	(3.9)
25	6-32	1.500	(38.1)	1.891	(48.0)	1.658	(42.1)	.153	(3.9)

1. For complete dimensions see applicable Military Specification.
2. Metric dimensions (mm) are indicated in parentheses.

## X-ON Electronics

Largest Supplier of Electrical and Electronic Components

*Click to view similar products for* [Circular MIL Spec Tools, Hardware & Accessories](#) *category:*

*Click to view products by* [Glenair](#) *manufacturer:*

Other Similar products are found below :

[0113-201-2025](#) [600-079-06](#) [600-146-06](#) [M10-101982-143](#) [M10-101982-163](#) [M10-101983-183](#) [M10-150912-083](#) [M10-454396-008](#)  
[602GB18808](#) [CS3102A-22-14PW](#) [M2887615-CD](#) [627-009](#) [M38999/9-19B](#) [630A007NF083A](#) [630B007M051A](#) [630BJ003NF032H](#) [637-](#)  
[149NF04B](#) [M39029/29-215](#) [6408-203V-09273](#) [6426-201-11343](#) [650FS002NF16](#) [660-008NF14S7-01](#) [660-009M22H8-03](#) [660-013NF19U6-](#)  
[210](#) [660-015M10S6-17](#) [660-015NF10S5-01](#) [660-015NF14R3.5-01](#) [660-023NF19H6-19](#) [660-024NF11S12-01](#) [660-024NF11S3-01](#) [660-](#)  
[024NF17S4-109](#) [660-050XM17F4-01](#) [660-068NF25R6-30G](#) [660-070M23S8-04](#) [660-073MTCH9-20](#) [M83723/61-18W](#) [M83723/61-218R](#)  
[M83723/61-224W](#) [667-084-23C](#) [667-084-35C](#) [667-224NF16](#) [687-697NF-1](#) [M85049/94-10-A](#) [M85049/96-7-A](#) [M855282-10A01A](#)  
[M85528/2-10B](#) [M855282-18A01A](#) [M85528/2-22A01A](#) [M85528/2-22AA](#) [710HS460NF2508](#)