

Querschnitt
Cross section

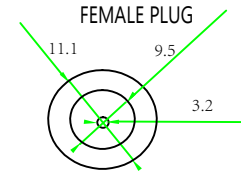
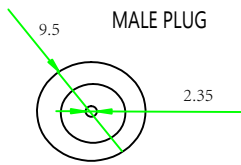
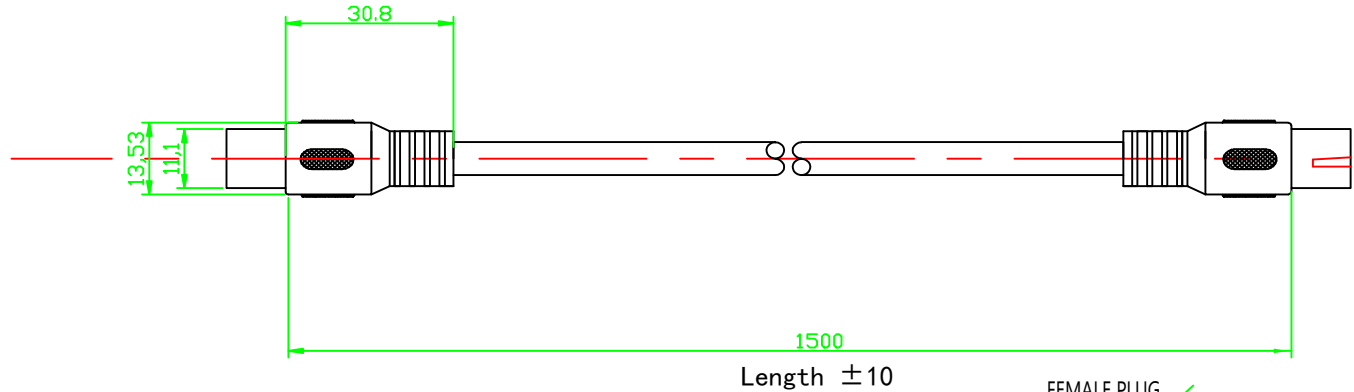
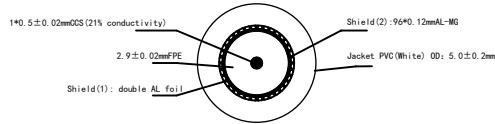

Elektrische Leistung:
Electrical Performance:
30-1000 MHz S.A >85 dB±5

SAT-Antennenkabel

- hochdichte doppelte Abschirmung zur störungsfreien Signalübertragung
- voll abgeschirmter, beidseitig vergossene Verbinder zum Schutz vor Staub, Schmutz und mechanischen Belastungen
- vernickelte, passgenaue Kontakte
- Anschlüsse: IEC-Stecker/-Kupplung (3C2V)
- FPE Dielektrikum
- CCS Innenleiter
- PVC Ummantelung
- 2-fach Schirmung: (AlMg Geflecht und Al Folie)
- >85 dB Schirmungsmaß; Class A
- Konformität: RoHS/REACH

SAT Antenna cable

- double shielded with high density for interference-free signal transmission
- fully shielded, encapsulated connectors on both sides, protection against dust, dirt and mechanical loads
- nickel plated contacts
- Connections: IEC male/female (3C2V)
- FPE dielectric
- CCS inner conductor
- PVC sheath
- 2-fold shielding: (AlMg mesh and Al foil)
- >85 dB shielding measure; Class A
- Conformity: RoHS / REACH

Nr. / No.	Beschreibung / Description
66612	Class A Antenna cable IEC male/female 0100 1.0 m
66613	Class A Antenna cable IEC male/female 0150 1.5 m
66614	Class A Antenna cable IEC male/female 0200 2.0 m
66615	Class A Antenna cable IEC male/female 0300 3.0 m
66616	Class A Antenna cable IEC male/female 0500 5.0 m
66617	Class A Antenna cable IEC male/female 1000 10.0 m

Änderungen

Datum	Name	gez.:	Datum	Name
		gef.:	24.09.2018	tf
		gepr.:	24.09.2018	tf
		Norm:		
Änderungen vorbehalten / Subject to change				

Bezeichnung
Class A Antenna cable
IEC male/female



Zeichnungs-Nr.:
Blatt
von

X-ON Electronics

Largest Supplier of Electrical and Electronic Components

Click to view similar products for [Specialised Cables category](#):

Click to view products by [Goobay manufacturer](#):

Other Similar products are found below :

[GP-IE515546DS-002](#) [7810SB-010-1000](#) [96CB-L2020PIB2](#) [1200740161](#) [R88ACAKA0015SRE](#) [R88ACAWL005SDE](#) [R88ACRGD0R3C](#)
[1300660042](#) [1300660201](#) [1971465-2](#) [22733-8](#) [2R7004A20F060](#) [SSL009PC2DC012N](#) [FC2A-KC6C](#) [CCSFCBF2](#) [R7ACAB005S](#)
[XS2WM12PUR4SA10M](#) [XS2WM12PVC4SA10M](#) [05AU05](#) [UCABLE](#) [10114734-2010LF](#) [XW2Z010H3](#) [XW2Z010H1](#) [5-1589827-8](#) [5-](#)
[1589827-4](#) [861084-1](#) [XW2Z200JB24](#) [5-1589956-8](#) [CR4000A76M020](#) [1201140211](#) [1300140039](#) [CR4000A76M005](#) [CR4006A76M005](#)
[10077488-N0550FDLF](#) [XW2ZRY150C](#) [I4JPBJLUXX100](#) [I4JPBJLUXX50](#) [CM06](#) [CM06W](#) [POE004](#) [0243 009 05](#) [0243 009 20](#) [0243 009 36](#)
[0243 009 26](#) [0243 009 33](#) [0243 009 23](#) [0243 009 01](#) [0243 009 30](#) [0243 008 05](#) [0243 008 20](#)