

Model No.: **GP1604A**

NO MERCURY ADDED	
Description	: Alkaline Manganese 9V Battery
Chemical System	: Alkaline Manganese Dioxide
Nominal Voltage	: 9.0 Volts
Nominal Dimensions	: 25.5 (L)mm x 16.5 (W)mm x 47.5 (H)mm
Operating Temp.	: -20 - 60 °C , 65 % RH Max
Storage Temp.	: 15 - 25 °C , 45 - 75 % RH
Terminal	: Nickel plated miniature snap fasteners
Jacket	: Printed metal jacket
Internal Connection	: Welding
Application	: All electronics devices
Nominal Weight	: 47g
Date Code	: Unless otherwise specified, every battery will carry a 6 digits (MM-YYYY) expiry code.
Special Feature	: World class explosion proof
Shelf Life	: 5 years as below conditions

Cross References:

GP	JIS	IEC	Eveready	Duracell
1604A	6LF22	6LF22	522	MN1604

Electrical Characteristics

Test Items	Test Conditions 25 ± 2°C 60 ± 15%RH	Specification (Volt), min			
		3 months	1 year	3 years	5 years
OCV		9.30V	9.20V	9.00V	8.80V
CCV	47Ω, 0.3 s	8.00V	7.80V	7.50V	7.20V

Discharge Capacity

Test Items	Test Conditions 25 ± 2°C 60 ± 15%RH (EV=End Voltage)	Specification (Hours), mean			
		3 months	1 year	3 years	5 years
Duration	270 Ω Intermittent 1 h/d EV=5.40V	20.0	19.7	18.2	16.2
	620 Ω Intermittent 2 h/d EV=5.40V	48.2	47.2	44.7	40.7
	10 kΩ background 24 h/d, 620 Ω 1 s/h pulse EV=7.50V	Specification (Days), mean			
		19.0	18.5	17.5	16.5*

* Storage performance is estimated.

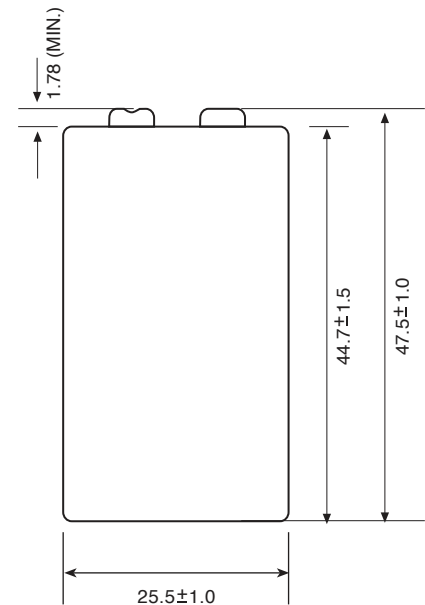
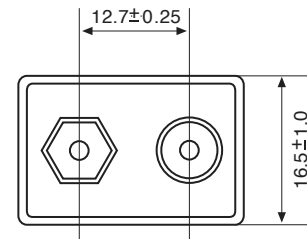

Unit : mm

The information (subject to change without prior notice) contained in this document is for reference only and should not be used as a basis for product guarantee or warranty. For applications other than those described here, please consult your nearest GP Sales and Marketing Office or Distributors.

X-ON Electronics

Largest Supplier of Electrical and Electronic Components

Click to view similar products for [Cylindrical Battery Contacts, Clips, Holders & Springs](#) category:

Click to view products by [GP Batteries](#) manufacturer:

Other Similar products are found below :

[12BH36A-GR](#) [200](#) [161](#) [183](#) [270](#) [QX3506](#) [5220](#) [5230](#) [1055](#) [1088](#) [5250](#) [KT0008](#) [1119](#) [5207](#) [246](#) [BWCD-L4.5W2.0H2.3](#) [BWCD-L6.0W2.0H2.0](#) [BW0041BG-L2.5W1.0H1.5](#) [BW0031AG-L3.5W1.0H3.0](#) [BWCD-L5.0W2.0H2.5](#) [BW0019CG-L3.5W1.5H4.3](#) [BW0036AG-L3.5W1.0H1.4](#) [BW0034AG-L3.5W0.9H1.5](#) [BW0033BG-L3.4W0.9H2.0](#) [BW0041CG-L2.5W1.0H1.8](#) [BW0028AG-L3.5W1.5H2.05](#) [BW0098DG-L4.0W1.5H2.0](#) [BW0019BG-L3.5W1.5H3.8](#) [BWCD-L6.5W2.0H2.0](#) [BWCD-L4.0W2.0H1.0](#) [BWCD-L5.5W2.0H3.0](#) [BW0019AG-L3.5W1.5H3.5](#) [BWCD-L3W2.0H1.0](#) [ECT818002831](#) [ECT81800A081](#) [ECT818003141](#) [ECT81800B009](#) [ECT818002399](#) [F9-7-6-0.4Z](#) [F8-10-0.4-1.3](#) [F10-10-6-0.4-1.3](#) [F8-8-5-0.4Z](#) [F10-12-0.4-1.3](#) [F10-10-6.5-0.4P](#) [F10-10-6.5-0.4 Z](#) [GP SUPER 14A \(LR14\) SHRINK 2 LR20 INDUSTRIAL INTENSE](#) [CW332](#) [HC4](#) [PCL5A](#)