

SGBJ3616

Features

- Glass passivated chip, high reliability
- Low forward voltage drop
- Insulation voltage: 2500V~

Application

- DC power supply
- Input rectifying of PWM converter
- Power supply of DC equipments

Characteristics

- Simple installation
- Smart size, Light weight
- Small heating resistance, high heat radiation, low temperature

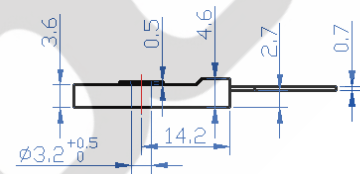
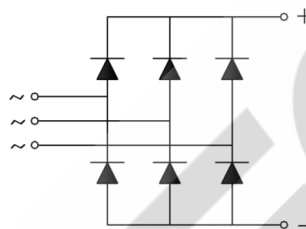
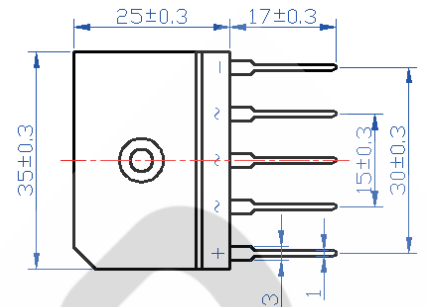

■ Max. value

| Symbol | Rated | | | | Unit |
|-----------|----------|----------|----------|----------|------|
| | SGBJ3510 | SGBJ3512 | SGBJ3514 | SGBJ3516 | |
| V_{RRM} | 1000 | 1200 | 1400 | 1600 | V |
| V_{RSM} | 1100 | 1300 | 1500 | 1700 | V |

| Symbol | Testing condition | Rated | Unit |
|-------------|--|-------------|-------------------------|
| $I_{F(AV)}$ | 180° sine anf half wave 50Hz, $T_c=100^\circ\text{C}$ | 35 | A |
| I_{FSM} | $t=10\text{ms}, 50\text{Hz}, \text{sin}, T_j=25^\circ\text{C}$ | 400 | A |
| I^2t | | 660 | A^2S |
| V_{ISO} | 50Hz, R.M.S, $t=1\text{min}, I_{iso}: 1\text{mA}(\text{Max})$ | 2500 | V |
| T_j | | -40 to +150 | $^\circ\text{C}$ |
| T_{jm} | | 150 | $^\circ\text{C}$ |
| T_{stg} | | -40 to +125 | $^\circ\text{C}$ |
| M_d | | 0.8 | $\text{N}\cdot\text{m}$ |
| W_t | | 10 | g |

| Symbol | Testing condition | Rated | Unit |
|---------------|--|-------|---------------------------|
| I_{RRM} | $V_R=V_{RRM}, \text{ sine anf half wave}, T_j=25^\circ\text{C}$ | 5 | μA |
| | $V_R=V_{RRM}, \text{ sine anf half wave}, T_j=150^\circ\text{C}$ | 3 | mA |
| V_{FM} | $I_{FM}=17.5\text{A}, T_j=25^\circ\text{C}$ | 1.2 | V |
| $R_{th(j-c)}$ | single side cooling, sine anf half wave | 0.96 | $^\circ\text{C}/\text{W}$ |

SGBJ3616

正向特性曲线

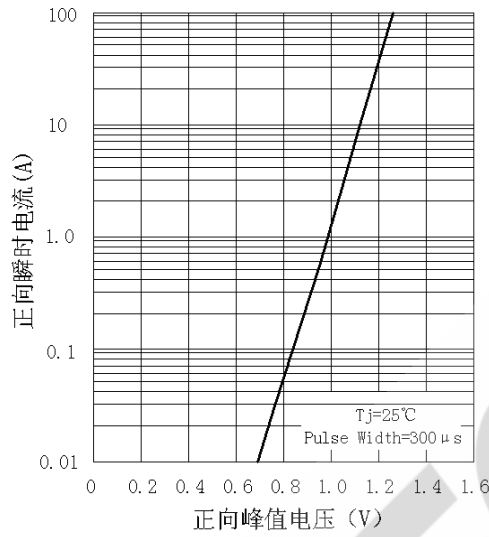

管壳温度与正向平均电流特性曲线

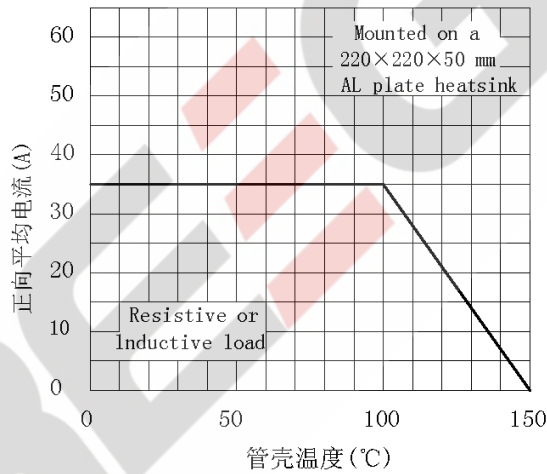

正向浪涌电流与周波数特性曲线

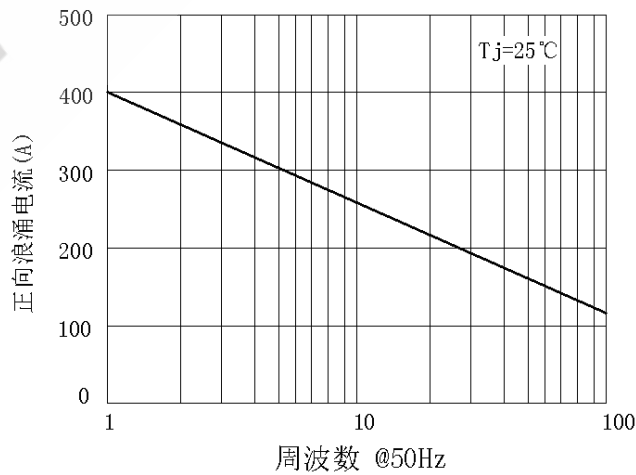

X-ON Electronics

Largest Supplier of Electrical and Electronic Components

Click to view similar products for [Bridge Rectifiers](#) category:

Click to view products by [GREGOO](#) manufacturer:

Other Similar products are found below :

[MB2510](#) [MB252](#) [MB356G](#) [MB358G](#) [GBJ1504-BP](#) [GBU15J-BP](#) [GBU15K-BP](#) [GBU4A-BP](#) [GBU4D-BP](#) [GBU6B-E3/45](#) [GSIB680-E3/45](#)
[DB101-BP](#) [DF01](#) [DF10SA-E345](#) [BU1508-E3/45](#) [KBPC50-10S](#) [RS405GL-BP](#) [G5SBA60-E3/51](#) [GBJ1502-BP](#) [GBU10J-BP](#) [GBU4J-BP](#)
[GBU6M](#) [GBU8D-BP](#) [GBU8J-BP](#) [GSIB1520-E3/45](#) [2KBB10](#) [36MB140A](#) [TB102M](#) [MB1510](#) [MB258](#) [MB6M-G](#) [MB86](#) [TL401G](#)
[MDA920A2](#) [TU602](#) [TU810](#) [BR1005-BP](#) [BR101-BP](#) [BR84DTP204](#) [BU2008-E3/51](#) [36MB100A](#) [36MT160](#) [KBPC25-02](#) [VS-2KBB60](#)
[DBB08G-TM-E](#) [DBD250G](#) [DBF20G](#) [DF06SA-E345](#) [DF1510S](#) [VS-40MT160PAPBF](#)