

1

2

3

4

5

6

7

8

9

REV.	LOCAS.	DESCRIPTION	DATE	DRAWN
04	△	變更料號	2009.02.25	趙章池
05	△	依上級要求變更圖號	2012.05.21	李芳忠

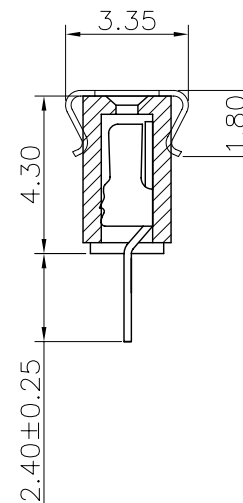
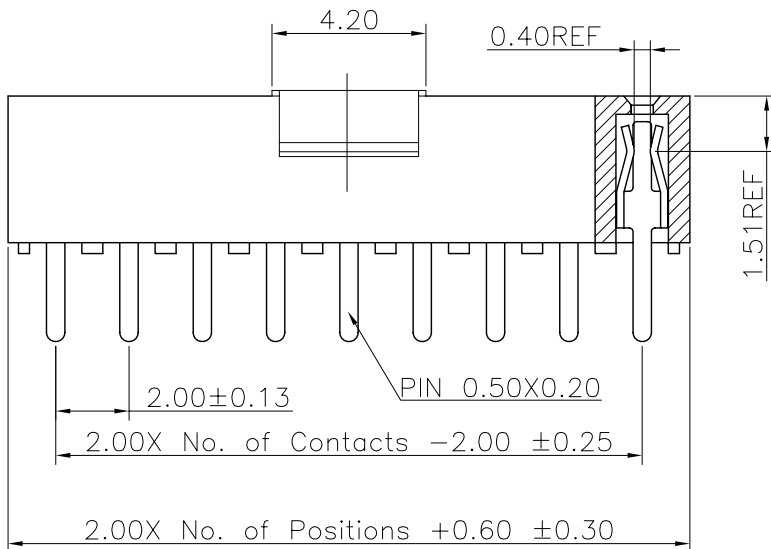
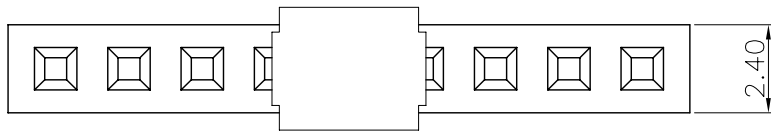

Specifications

Current Rating: 2Amp

Insulation Resistance: 1000MΩ Min.

Dielectric Withstanding Voltage: 500VAC

Contact Resistance: 20mΩ Max.

Operating Temperature: -40°C to +105°C

Materials

Contact Material: Phosphor Bronze

Insulator Material: High Temperature

Thermoplastic, UL 94V-0 Nylon 6T or the equivalent material

All materials must meet Greenconn requirement for environment protection.

Ordering Information

C SFA101 - XX XX A 001 B 1 A X

No. of Pins per Row
02~40

Standard Plating
02=Gold Flash
Selective Plating
01=Tin
05=Gold Flash/Tin

Color
1=Black

Standard Packing
A=Box
Selective Packing
C=Tube
E=Cap+Tube
F=Cap+Tape&Reel

Recommended P.C.Board Layout

(Tolerance: ±0.05)

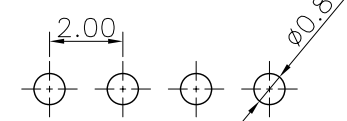

格稜股份有限公司
Greenconn Corporation

GENERAL TOLERANCE	
X.*±5.0°	X.±0.30
.X*±3.0°	.X±0.25
.XX*±2.0°	.XX±0.15
.XXX*±1.0°	.XXX±0.10

DESIGN: 李芳忠	DATE: 2012.05.21
CHECKED: 劉北平	DATE: 2012.05.21
AUDITED: 李輝	DATE: 2012.05.21
APPROVED: cc_li	DATE: 2012.05.21

DWG. NO.	△△
CHECKED:	CSFA101-CA1BA
PART NO.	△
APPROVED:	CSFA101-XXXX A001B1AX

TITLE:	2.00 FEMALE HEADER SINGLE ROW DIP TYPE CONNECTOR
--------	--

REV.	UNIT.	SCALE.	PAGE.
05	mm	5:1	1/1

1

2

3

4

5

6

7

8

9

X-ON Electronics

Largest Supplier of Electrical and Electronic Components

Click to view similar products for [Headers & Wire Housings](#) category:

Click to view products by [GREENCONN](#) manufacturer:

Other Similar products are found below :

[57102-F02-18ULF](#) [58102-G61-06LF](#) [582553-1](#) [009176003701906](#) [01.001.5753.1](#) [0050291907](#) [02.125.8002.8](#) [609-3404](#) [61062-3](#)
[CSU011177004](#) [622-0430](#) [622-3653LF](#) [63453-116](#) [636-1030](#) [636-1427](#) [636-3427](#) [636-4007](#) [641938-9](#) [65495-038](#) [65692-001LF](#) [65781-018](#)
[65781-047](#) [65817-010LF](#) [65817-015LF](#) [66207-023LF](#) [67095-007LF](#) [67601157](#) [68631-112](#) [68645-018](#) [699319-000](#) [M90C108951C](#)
[70.362.1628.0](#) [70-4210](#) [70-4226B](#) [70-4853B](#) [707-5028](#) [71.350.2428.0](#) [71961-016LF](#) [733-134](#) [733-162](#) [754199-000](#) [760-3052](#) [80.063.4001.1](#)
[800-90-001-10-001000](#) [800-90-010-10-002000](#) [801-43-002-10-013000](#) [801-43-006-10-002000](#) [803-41-018-10-001000](#) [803-43-024-10-](#)
[001000](#) [803-93-012-10-001000](#)