

REV.	LOCAS.	DESCRIPTION	DATE	DRAWN
03	△	變更料號	2009.03.03	李彬彬
04	△	依上級要求變更圖號	2011.08.11	李芳忠

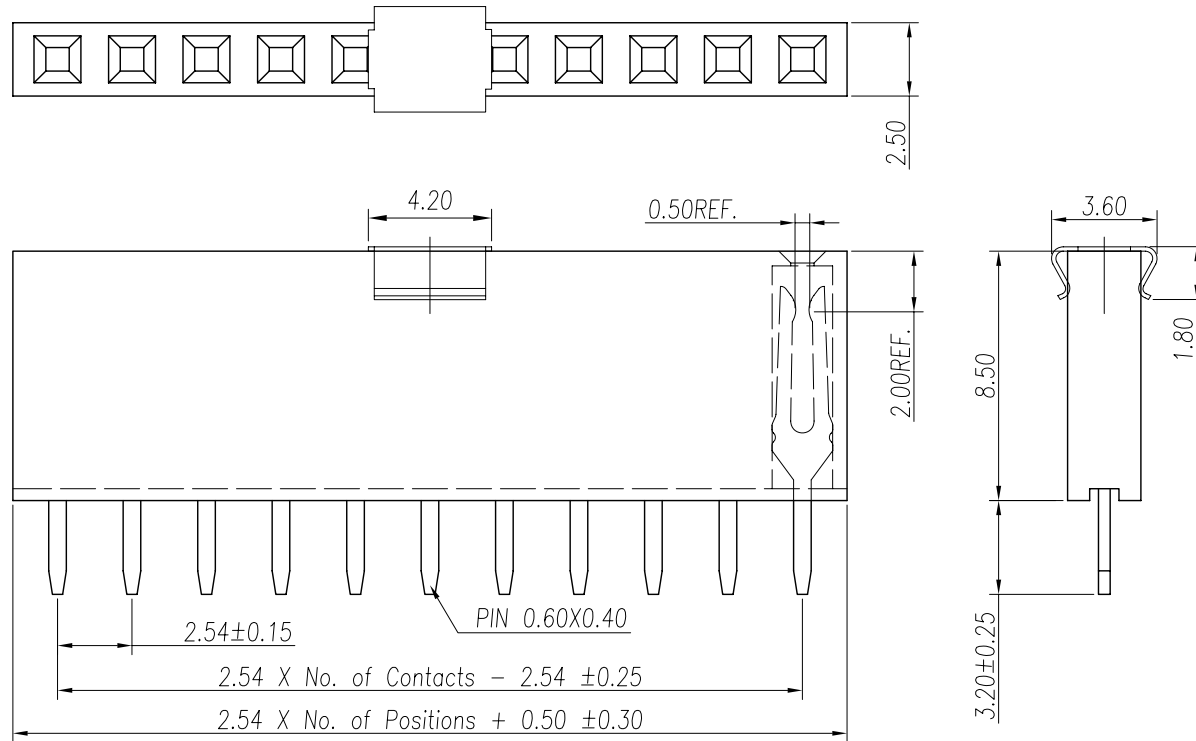

Specifications  
 Current Rating: 3Amp  
 Insulation Resistance: 1000MΩMin.  
 Dielectric Withstanding Voltage: 600VAC  
 Contact Resistance: 20mΩMax.  
 Operating Temperature: -40°C to +105°C  
 Materials  
 Contact Material: Phosphor Bronze  
 Insulator Material: Thermoplastic, UL 94V-0  
 PBT or the equivalent material  
 All materials must meet Greenconn  
 requirement for environment protection.

### △ Ordering Information △

C SHA101 - XX XX A 001 A X A X

No. Of Pins Per Row  
02~40

Standard Plating  
02=Gold Flash  
Selective Plating  
01=Tin  
05=Gold Flash/Tin

Color  
1=Black  
6=Gray  
K=Pink

Standard Packing  
A=Box  
Selective Packing  
C=Tube  
E=Cap+Tube  
F=Cap+Tape&Reel

Recommended P.C.Board  
 Layout  
 (Tolerance: ±0.05)

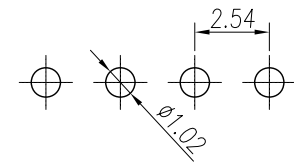

格菱股份有限公司  
**Greenconn Corporation**

GENERAL TOLERANCE		DESIGN:	李芳忠	DATE:	2011.08.11
X'±5.0'	X.±0.30	CHECKED:	劉北平	DATE:	2011.08.11
.X'±3.0'	.X±0.25	AUDITED:	李輝	DATE:	2011.08.11
.XX'±2.0'	.XX±0.15	APPROVED:	cc_li	DATE:	2011.08.11
.XXX'±1.0'	.XXX±0.10				

DWG. NO.	△△ CSHA101-CA1AA
PART NO.	△ CSHA101-XXXX A001AXAX

TITLE.  
 2.54 FEMALE HEADER  
 SINGLE ROW DIP TYPE  
 CONNECTOR

REV.	UNIT.	SCALE.	PAGE.	Symbol
04	mm	4:1	1/1	Symbol

## X-ON Electronics

Largest Supplier of Electrical and Electronic Components

*Click to view similar products for [Headers & Wire Housings](#) category:*

*Click to view products by [GREENCONN](#) manufacturer:*

Other Similar products are found below :

[0015917161](#) [0022155065](#) [57102-F02-18ULF](#) [58102-G61-06LF](#) [582553-1](#) [01.001.5753.1](#) [0050291907](#) [02.125.8002.8](#) [609-3404](#) [61062-3](#)  
[CSU011177004](#) [622-0430](#) [622-3653LF](#) [63453-116](#) [636-1030](#) [636-1427](#) [636-3427](#) [636-4007](#) [641938-9](#) [65495-038](#) [65692-001LF](#) [65781-018](#)  
[65781-047](#) [65817-010LF](#) [65817-015LF](#) [67095-007LF](#) [67601157](#) [68631-112](#) [68645-018](#) [699319-000](#) [70.362.1628.0](#) [70-4210](#) [70-4226B](#) [70-](#)  
[4853B](#) [71.350.2428.0](#) [733-134](#) [733-162](#) [760-3052](#) [MHR-64-VUAL](#) [80.063.4001.1](#) [800-90-001-10-001000](#) [801-43-002-10-013000](#)  
[801-43-006-10-002000](#) [803-43-024-10-001000](#) [803-93-012-10-001000](#) [8-1437020-4](#) [819-22-004-30-001101](#) [820-22-006-30-001101](#)  
[820-22-008-30-001101](#) [821-22-002-10-001101](#)