

REV.	LOCAS.	DESCRIPTION	DATE	DRAWN
01	NEW	INITIAL RELEASE.	2013.11.20	郭丙建

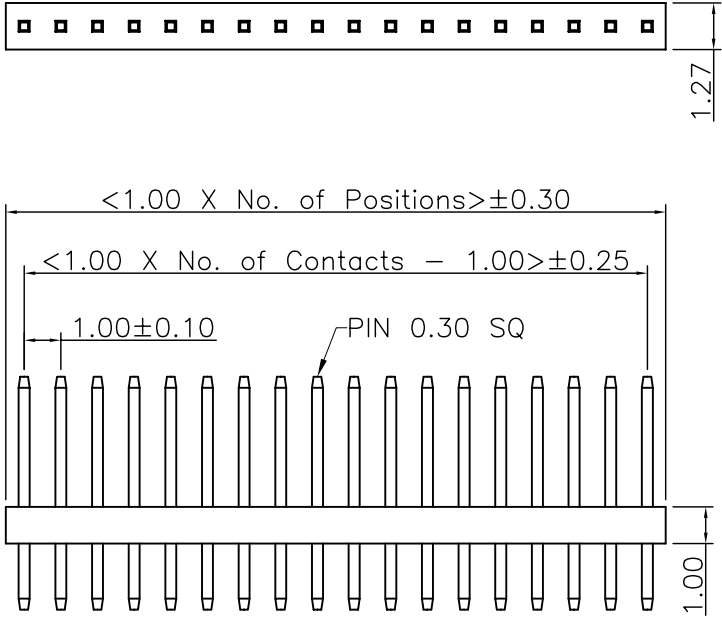

Recommended P.C.Board  
Layout  
(Tolerance:  $\pm 0.05$ )

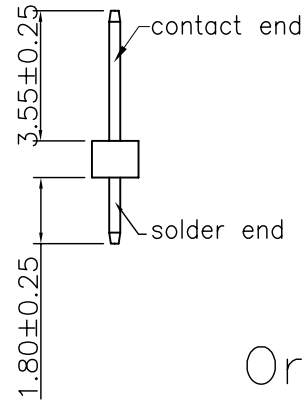
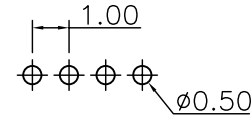

### Specifications

Current Rating: 1.0Amp  
Insulation Resistance: 1000M $\Omega$  Min.  
Dielectric Withstanding: 300V AC  
Contact Resistance: 20m $\Omega$  Max.  
Operating Temperature: -40°C to +105°C

### Materials

Contact Material: Phosphor Bronze  
Insulator Material: Polyester UL94V-0  
LCP Or Equivalent material

All materials must meet Greenconn requirement for environment protection.

### Ordering Information

G PCA101-XX XX A 001 C 1 A X

No. of Pins per Row 02~40	Standard Plating	Color 1=Black	Standard Packing A=Box C=Tube
	02=Gold Flash Selective Plating 01=Tin 05=Gold Flash /Tin		

格稜股份有限公司  
**Greenconn Corporation**

GENERAL TOLERANCE		DESIGN: 郭丙建	DATE: 2013.11.20
X.* $\pm 5.0^\circ$	X. $\pm 0.30$	CHECKED: 劉蟬	DATE: 2013.11.20
.X.* $\pm 3.0^\circ$	.X. $\pm 0.25$	AUDITED: 吳柏昌	DATE: 2013.11.20
.XX.* $\pm 2.0^\circ$	.XX. $\pm 0.15$	APPROVED: 陳義昌	DATE: 2013.11.20
.XXX.* $\pm 1.0^\circ$	.XXX. $\pm 0.10$		

DWG. NO. GPCA101-CA1CA
PART NO. GPCA101-XX XX A001C1AX

TITLE.  
PITCH 1.00  
HEADER SIGLE ROW  
DIP TYPE

REV.	UNIT.	SCALE.	PAGE.
01	mm	5:1	1/1

## X-ON Electronics

Largest Supplier of Electrical and Electronic Components

*Click to view similar products for [Headers & Wire Housings](#) category:*

*Click to view products by [GREENCONN](#) manufacturer:*

Other Similar products are found below :

[0015917161](#) [0022155065](#) [57102-F02-18ULF](#) [58102-G61-06LF](#) [582553-1](#) [01.001.5753.1](#) [0050291907](#) [02.125.8002.8](#) [609-3404](#) [61062-3](#)  
[CSU011177004](#) [622-0430](#) [622-3653LF](#) [63453-116](#) [636-1030](#) [636-1427](#) [636-3427](#) [636-4007](#) [641938-9](#) [65495-038](#) [65692-001LF](#) [65781-018](#)  
[65781-047](#) [65817-010LF](#) [65817-015LF](#) [67095-007LF](#) [67601157](#) [68631-112](#) [68645-018](#) [699319-000](#) [70.362.1628.0](#) [70-4210](#) [70-4226B](#) [70-](#)  
[4853B](#) [71.350.2428.0](#) [733-134](#) [733-162](#) [760-3052](#) [MHR-64-VUAL](#) [80.063.4001.1](#) [800-90-001-10-001000](#) [801-43-002-10-013000](#)  
[801-43-006-10-002000](#) [803-43-024-10-001000](#) [803-93-012-10-001000](#) [8-1437020-4](#) [819-22-004-30-001101](#) [820-22-006-30-001101](#)  
[820-22-008-30-001101](#) [821-22-002-10-001101](#)