

REV.	LOCAS	DESCRIPTION	DATE	DRAWN
01	NEW	INITIAL RELEASE.	08-06-04'	XIAO PING
02	△	變更塑膠材質	07.11.20	周禮軍
03	△	變更料號	2008.08.05	彭思城
04	△	變更圖號	2011.01.10	黃明霞
05	△	新增電碼	2022.11.01	謝青平

Recommended P.C.Board Hole Layout

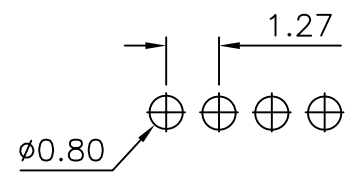

Specifications
 Current Rating:1Amp
 Insulation Resistance:1000MΩMin.
 Dielectric Withstanding: 300VAC
 Contact Resistance:20mΩMax.
 Operating Temperature:-40°C to +105°C
 Materials
 Contact Material: Phosphor Bronze
 Insulator Material: Polyester, UL 94V-0
 △₀₁ LCP
 All materials must meet Greenconn requirement for environment protection.

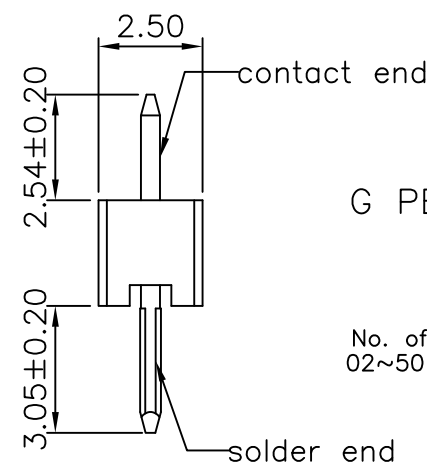
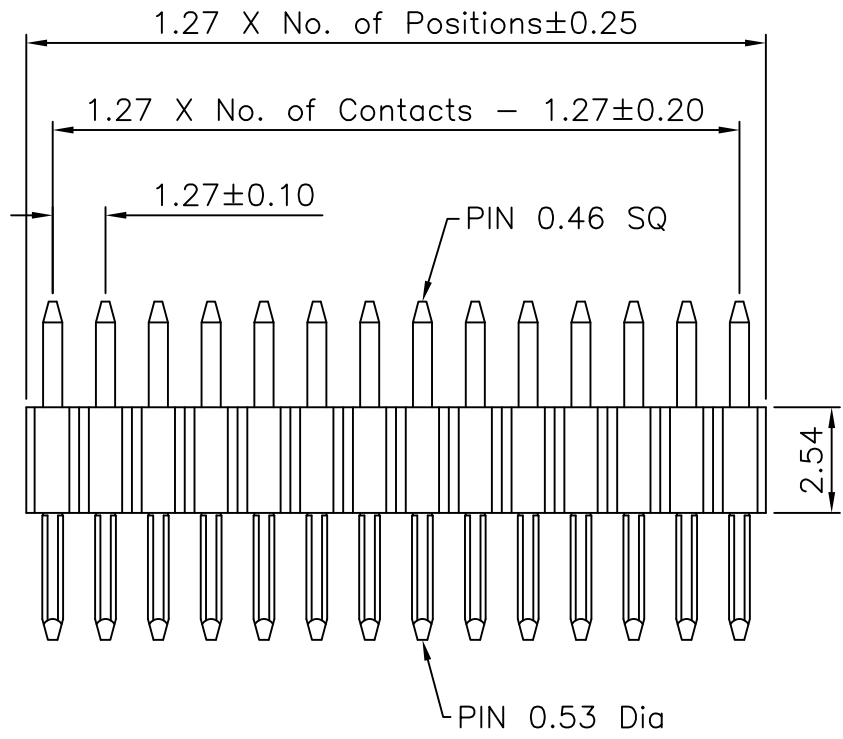
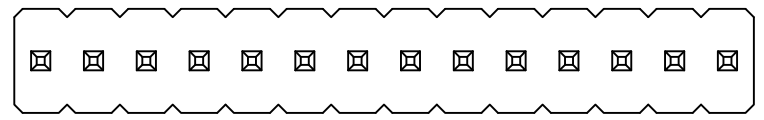

Ordering Information △

G PEA101 - XX XX A036 C 1 A X

No. of Pins per Row 02~50 Contact Plating 01=Tin, 02=Gold Flash, Duplex plating, 05=Gold Flash /Tin, △10=Gold 10u" /Gold Flash Options D=tape reel, F=cap+tape reel, ...

F
E
D
C
B
A

F
E
D
C
B
A

格菱股份有限公司 Greenconn Corporation			GENERAL TOLERANCE X: ±5.0° X: ±0.30 .X: ±3.0° .X: ±0.25 .XX: ±2.0° .XX: ±0.15 .XXX: ±1.0° .XXX: ±0.10		DESIGN: 謝青平 CHECKED: LINK AUDITED: LINK	DATE: 2022.11.01 DATE: 2022.11.01 DATE: 2022.11.01	DWG. NO. △△ GPEA101-CA36CA PART NO. △ GPEA101-XXXA036C1AX	TITLE. 1.27PIN HEADER SINGLE ROW DIP TYPE BASE 2.54 H
REV. 05	UNIT. mm	SCALE. 1:1	PAGE. 1/1					

X-ON Electronics

Largest Supplier of Electrical and Electronic Components

Click to view similar products for [Headers & Wire Housings](#) category:

Click to view products by [GREENCONN](#) manufacturer:

Other Similar products are found below :

[57102-F02-18ULF](#) [58102-G61-06LF](#) [582553-1](#) [009176003701906](#) [01.001.5753.1](#) [0050291907](#) [02.125.8002.8](#) [609-3404](#) [61062-3](#)
[CSU011177004](#) [622-0430](#) [622-3653LF](#) [63453-116](#) [636-1030](#) [636-1427](#) [636-3427](#) [636-4007](#) [641938-9](#) [65495-038](#) [65692-001LF](#) [65781-018](#)
[65781-047](#) [65817-010LF](#) [65817-015LF](#) [66207-023LF](#) [67095-007LF](#) [67601157](#) [68631-112](#) [68645-018](#) [699319-000](#) [M90C108951C](#)
[70.362.1628.0](#) [70-4210](#) [70-4226B](#) [70-4853B](#) [707-5028](#) [71.350.2428.0](#) [71961-016LF](#) [733-134](#) [733-162](#) [754199-000](#) [760-3052](#) [80.063.4001.1](#)
[800-90-001-10-001000](#) [800-90-010-10-002000](#) [801-43-002-10-013000](#) [801-43-006-10-002000](#) [803-41-018-10-001000](#) [803-43-024-10-](#)
[001000](#) [803-93-012-10-001000](#)