

REV.	LOCAS	DESCRIPTION	DATE	DRAWN
07	△	依業務要求變更操作溫度	2016.07.30	馮國東
08	△	依業務要求把客戶名字換成客戶代碼	2020.05.18	何東華
09	△	依業務要求加標子	2020.12.16	何東華

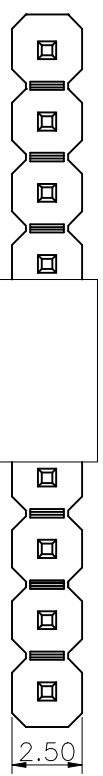

Specifications
 Current Rating: 3Amp
 Insulation Resistance: 1000MΩ/min.
 Dielectric Withstanding Voltage: 600VAC
 Contact Resistance: 20mΩMax.
 Operating Temperature: -40°C to +125°C

Materials
 Contact Material: Brass
 Insulator Material: Thermoplastic, UL 94V-0
 PBT or the equivalent material

All materials must meet Greenconn requirement for environment protection.

★: Critical Characteristics.

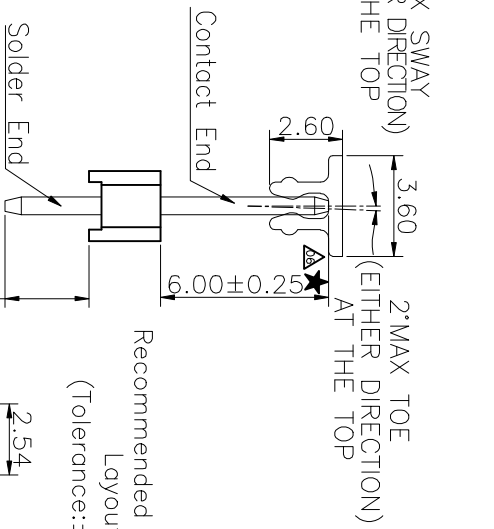
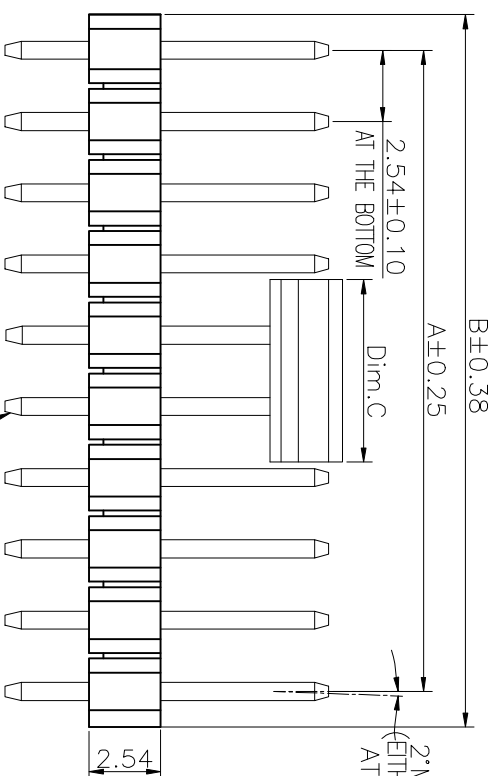

Recommended P.C.Board Layout
 (Tolerance: ±0.05)

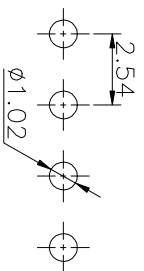

DIM.C	NOTE
5.00	02PIN
6.50	03~40PIN

PART NO.	A	B	Insulator Material	Standard Finishing
Greenconn P/N	Customer	Remarks		
GPHA101-0102A001A1BA	--	2.54	PBT	Box
GPHA101-0202A001A1BA	2.54	5.08	PBT	Box
GPHA101-0302A001A1BA	5.08	7.62	PBT	Box
GPHA101-0402A001A1BA	7.62	10.16	PBT	Box
GPHA101-0502A001A1BA	10.16	12.70	PBT	Box
GPHA101-0602A001A1BA	12.70	15.24	PBT	Box
GPHA101-0702A001A1BA	15.24	17.78	PBT	Box
GPHA101-0802A001A1BA	17.78	20.32	PBT	Box
GPHA101-0902A001A1BA	20.32	22.86	PBT	Box
GPHA101-1002A001A1BA	22.86	25.40	PBT	Box
GPHA101-1102A001A1BA	25.40	27.94	PBT	Box
GPHA101-1202A001A1BA	27.94	30.48	PBT	Box
GPHA101-1302A001A1BA	30.48	33.02	PBT	Box
GPHA101-1402A001A1BA	33.02	35.56	PBT	Box
GPHA101-1502A001A1BA	35.56	38.10	PBT	Box
GPHA101-1602A001A1BA	38.10	40.64	PBT	Box
GPHA101-1702A001A1BA	40.64	43.18	PBT	Box
GPHA101-1802A001A1BA	43.18	45.72	PBT	Box
GPHA101-1902A001A1BA	45.72	48.26	PBT	Box
GPHA101-2002A001A1BA	48.26	50.80	PBT	Box
GPHA101-2102A001A1BA	50.80	53.34	PBT	Box
GPHA101-2202A001A1BA	53.34	55.88	PBT	Box
GPHA101-2302A001A1BA	55.88	58.42	PBT	Box
GPHA101-2402A001A1BA	58.42	60.96	PBT	Box
GPHA101-2502A001A1BA	60.96	63.50	PBT	Box
GPHA101-2602A001A1BA	63.50	66.04	PBT	Box
GPHA101-2702A001A1BA	66.04	68.58	PBT	Box
GPHA101-2802A001A1BA	68.58	71.12	PBT	Box
GPHA101-2902A001A1BA	71.12	73.66	PBT	Box
GPHA101-3002A001A1BA	73.66	76.20	PBT	Box
GPHA101-3102A001A1BA	76.20	78.74	PBT	Box
GPHA101-3202A001A1BA	78.74	81.28	PBT	Box
GPHA101-3302A001A1BA	81.28	83.82	PBT	Box
GPHA101-3402A001A1BA	83.82	86.36	PBT	Box
GPHA101-3502A001A1BA	86.36	88.90	PBT	Box
GPHA101-3602A001A1BA	88.90	91.44	PBT	Box
GPHA101-3702A001A1BA	91.44	93.98	PBT	Box
GPHA101-3802A001A1BA	93.98	96.52	PBT	Box
GPHA101-3902A001A1BA	96.52	99.06	PBT	Box
GPHA101-4002A001A1BA	99.06	101.60	PBT	Box
GPHA101-1001A001A1BA	A050	Automotive Connector		
GPHA101-1002A001A1BA	A050	Automotive Connector		

Ordering Information

Ordering Information: PHA101 - XX XX A 001 A 1 X

No. of Pins per Row: 01~40

Standard Pating:
 02=Gold Flash
 Selective Pating
 01=Tin
 05=Gold Flash/Tin

Color: 1=Black

Standard Packing:
 A=Box
 B=Tube
 C=Tube
 E=Cap+Tube
 F=Cap+Tape&Reel

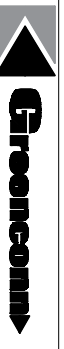

REV.	UNIT.	SCALE.	PAGE.	GENERAL TOLERANCE	DESIGNED:	DATE:	DWG. NO.	TITLE:
09	mm	4:1	1/1	X: ±5.0° .X: ±3.0° .XX: ±2.0° .XXX: ±1.0°	何東華	2020.12.16	GPHA101-CA1AB	2.54 PIN HEADER
					CHECKED:	DATE:	PART NO.	SINGLE ROW DIP TYPE
					APPROVED:	DATE:	GPHA101-XXXX A001A1BX	CONNECTOR

1 2 3 4 5 6 7 8 9

X-ON Electronics

Largest Supplier of Electrical and Electronic Components

Click to view similar products for [Headers & Wire Housings](#) category:

Click to view products by [GREENCONN](#) manufacturer:

Other Similar products are found below :

[0015917161](#) [0022155065](#) [57102-F02-18ULF](#) [58102-G61-06LF](#) [582553-1](#) [01.001.5753.1](#) [0050291907](#) [02.125.8002.8](#) [609-3404](#) [61062-3](#)
[CSU011177004](#) [622-0430](#) [622-3653LF](#) [63453-116](#) [636-1030](#) [636-1427](#) [636-3427](#) [636-4007](#) [641938-9](#) [65495-038](#) [65692-001LF](#) [65781-018](#)
[65781-047](#) [65817-010LF](#) [65817-015LF](#) [67095-007LF](#) [67601157](#) [68631-112](#) [68645-018](#) [699319-000](#) [70.362.1628.0](#) [70-4210](#) [70-4226B](#) [70-](#)
[4853B](#) [71.350.2428.0](#) [733-134](#) [733-162](#) [760-3052](#) [MHR-64-VUAL](#) [80.063.4001.1](#) [800-90-001-10-001000](#) [801-43-002-10-013000](#)
[801-43-006-10-002000](#) [803-43-024-10-001000](#) [803-93-012-10-001000](#) [8-1437020-4](#) [819-22-004-30-001101](#) [820-22-006-30-001101](#)
[820-22-008-30-001101](#) [821-22-002-10-001101](#)