

REV.	LOCAS.	DESCRIPTION	DATE	DRAWN
A	NEW	INTERIM INITIAL RELEASE.	2020.08.11	何東華

2.54 X No. of Positions $+0.50$ -0.38 (D1)

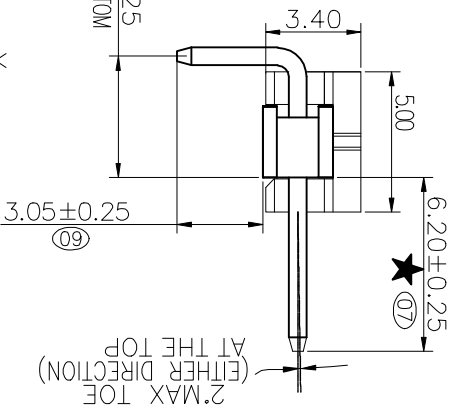
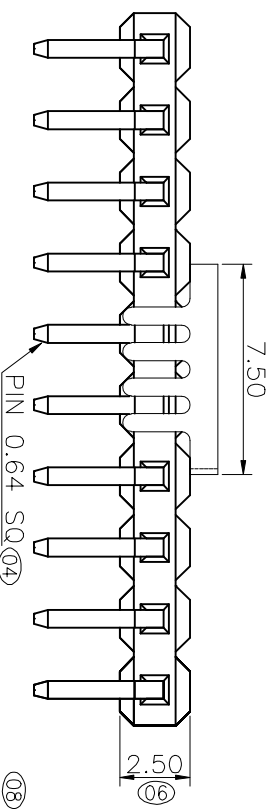
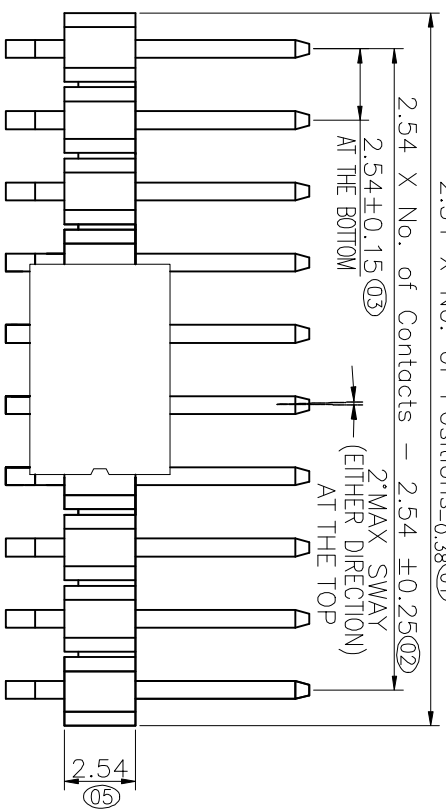

Ordering Information

G PHB101 - XX XX A 211 R 1 B X

- No. of Pins per Row: 02~40
- Standard Plating
- 02=Gold Flash Selective Plating
- 01=Tin
- 05=Gold Flash/Tin
- 58=30u" gold on contact/tin on tail
- Color: 1=Black
- Standard Packing: A=Box, Selective Packing; C=Tube, D=Tape&Reel, E=Cap+Tube, F=Cap+Tape&Reel

Specifications

Current Rating: 3Amp
 Insulation Resistance: 1000MΩMin.
 Dielectric Withstanding Voltage: 600VAC
 Contact Resistance: 20mΩMax.
 Operating Temperature: -40°C to +105°C
 Materials
 Contact Material: Brass
 Insulator Material: High Temperature Thermoplastic, UL 94V-0 Nylon (Halogen Free) or the equivalent material

☆ All materials must meet GREENCONN hazardous substances control standards.
 ★: Critical Characteristics, indicates product characteristics, functionalities, and manufacturing processes regarding to customer's specifications
 ☆☆: Safety Features indicates product characteristics, functionalities, and manufacturing processes complying to legal regulations stated by local government

Greenconn P/N	Customer	Remarks
GPHB101-0258A211R1BF	A007	automotive lighting

Recommended P.C.Board Layout
 (Tolerance: ±0.05)

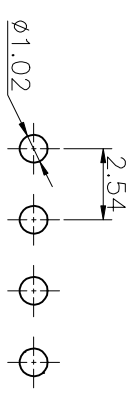

格稜股份有限公司
Greenconn Corporation

REV.	UNIT.	SCALE.	PAGE.	DESIGNED:	何東華	DATE:	2020.08.11	DWG. NO.	GPHB101-CA211RB	TITLE:
A	mm	4:1	1/1	CHECKED:		DATE:				2.54 PIN HEADER
				CO SIGNED:	鍾慶進	DATE:	2020.08.11			SINGLE ROW R/A TYPE
				APPROVED:		DATE:				CONNECTOR

A 1 2 3 4 5 6 7 8 9

X-ON Electronics

Largest Supplier of Electrical and Electronic Components

Click to view similar products for [Headers & Wire Housings](#) category:

Click to view products by [GREENCONN](#) manufacturer:

Other Similar products are found below :

[0015917161](#) [0022155065](#) [57102-F02-18ULF](#) [58102-G61-06LF](#) [582553-1](#) [01.001.5753.1](#) [0050291907](#) [02.125.8002.8](#) [609-3404](#) [61062-3](#)
[CSU011177004](#) [622-0430](#) [622-3653LF](#) [63453-116](#) [636-1030](#) [636-1427](#) [636-3427](#) [636-4007](#) [641938-9](#) [65495-038](#) [65692-001LF](#) [65781-018](#)
[65781-047](#) [65817-010LF](#) [65817-015LF](#) [67095-007LF](#) [67601157](#) [68631-112](#) [68645-018](#) [699319-000](#) [70.362.1628.0](#) [70-4210](#) [70-4226B](#) [70-](#)
[4853B](#) [71.350.2428.0](#) [733-134](#) [733-162](#) [760-3052](#) [MHR-64-VUAL](#) [80.063.4001.1](#) [800-90-001-10-001000](#) [801-43-002-10-013000](#)
[801-43-006-10-002000](#) [803-43-024-10-001000](#) [803-93-012-10-001000](#) [8-1437020-4](#) [819-22-004-30-001101](#) [820-22-006-30-001101](#)
[820-22-008-30-001101](#) [821-22-002-10-001101](#)