

- G-Switch Specification:**
1. Current rated: 0.5A AC/DC
 2. Voltage rating: 50V AC/DC
 3. Withstanding voltage: 150V AC
 4. Contact resistance: 50mΩ max.
 5. Insulation resistance: 500MΩ min
 6. Durability cycle: 20Cycles
 7. Removal force: 0.03kgf/Pin min
 8. Operating temperature range: -25°C ~ +85°C

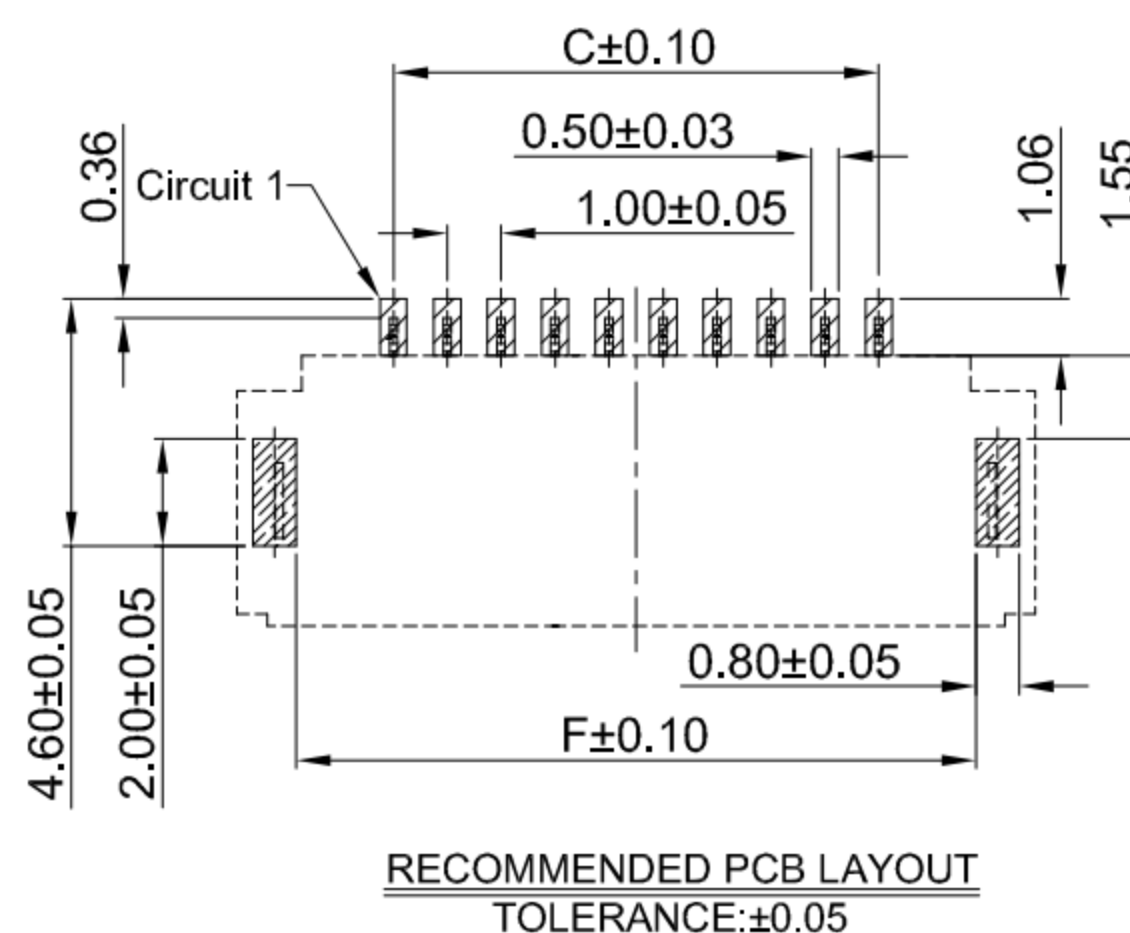

GT-F1007 S R 20 -XX X XX 01

- G-Switch**
- Series No**
- Termipoint**
S-SMT
- Angle**
R-90°
- Terminal Plating**
01-G/F
BT-Bright tin
- Housing Colour**
S-Nature
- Pin Q' PY**
03-40
- Height**
20-1.95mm

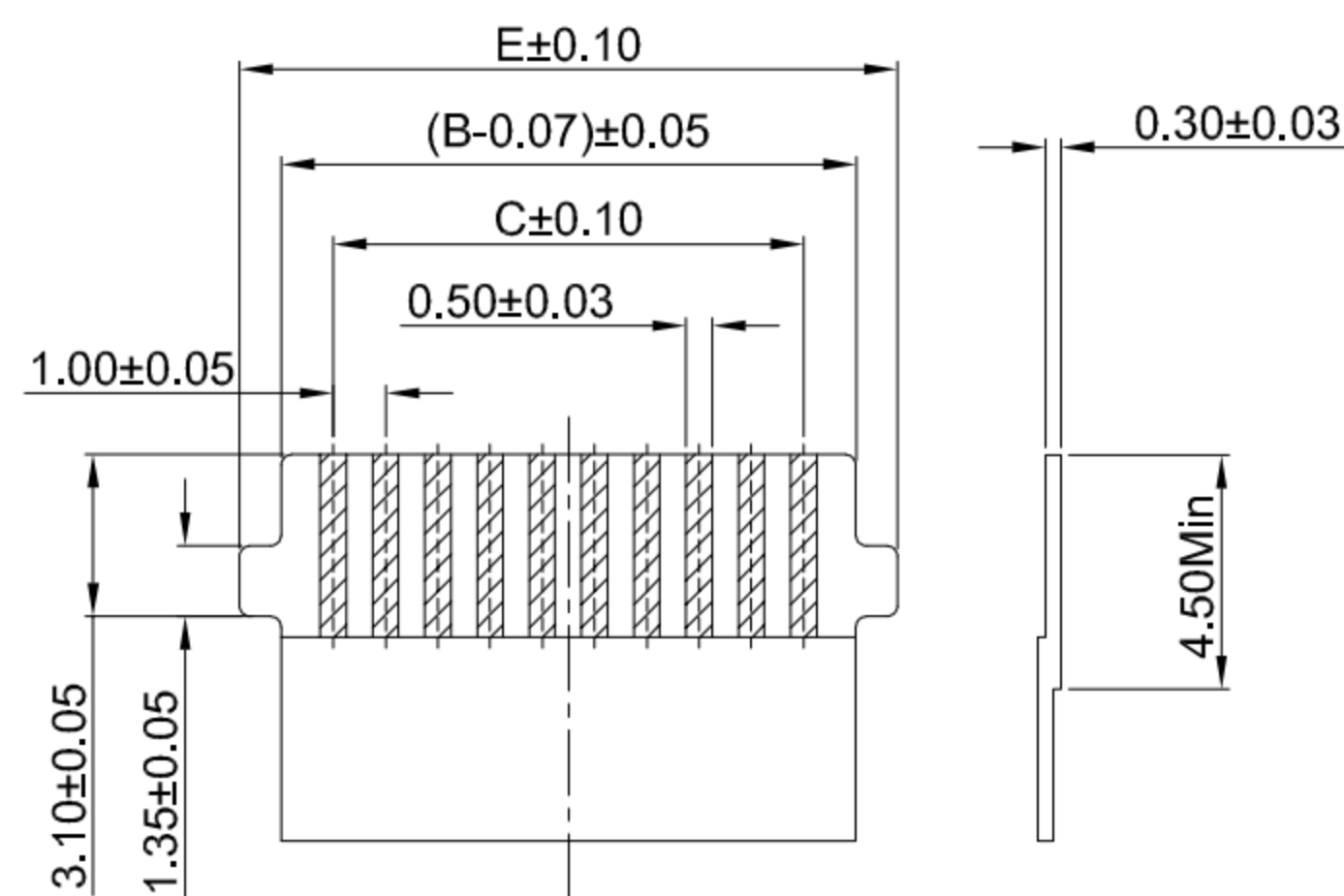
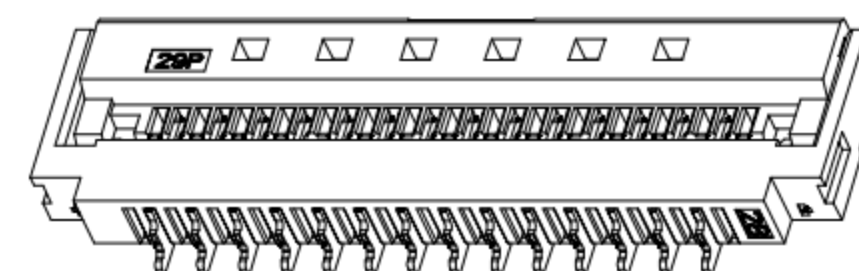
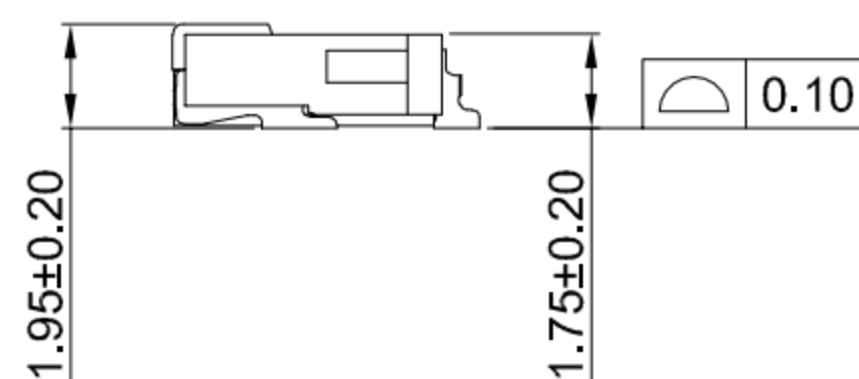
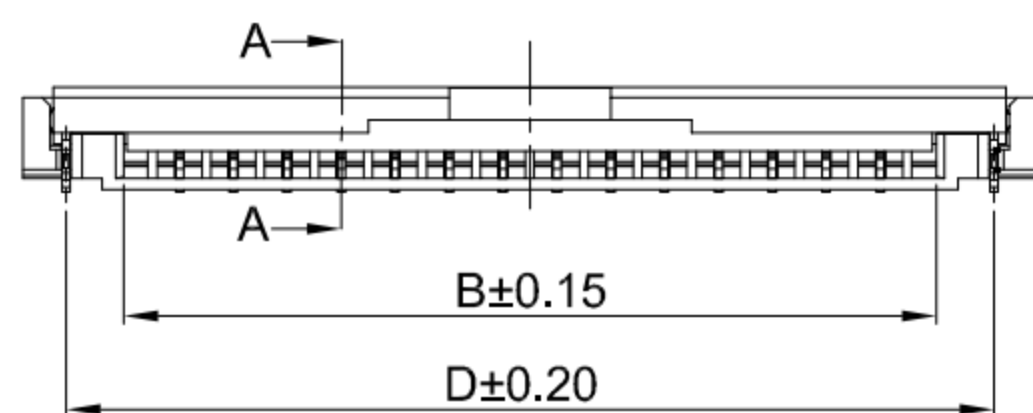

Ordering Information:

| Circuit | Dimensions(mm) | | | | | | Circuit | Dimensions(mm) | | | | | |
|---------|----------------|-------|-------|-------|-------|-------|---------|----------------|-------|-------|-------|-------|-------|
| | A | B | C | D | E | F | | A | B | C | D | E | F |
| 03 | 7.80 | 4.07 | 2.00 | 6.20 | 5.60 | 5.60 | 22 | 26.80 | 23.07 | 21.00 | 25.20 | 24.60 | 24.60 |
| 04 | 8.80 | 5.07 | 3.00 | 7.20 | 6.60 | 6.60 | 23 | 27.80 | 24.07 | 22.00 | 26.20 | 25.60 | 25.60 |
| 05 | 9.80 | 6.07 | 4.00 | 8.20 | 7.60 | 7.60 | 24 | 28.80 | 25.07 | 23.00 | 27.20 | 26.60 | 26.60 |
| 06 | 10.80 | 7.07 | 5.00 | 9.20 | 8.60 | 8.60 | 25 | 29.80 | 26.07 | 24.00 | 28.20 | 27.60 | 27.60 |
| 07 | 11.80 | 8.07 | 6.00 | 10.20 | 9.60 | 9.60 | 26 | 30.80 | 27.07 | 25.00 | 29.20 | 28.60 | 28.60 |
| 08 | 12.80 | 9.07 | 7.00 | 11.20 | 10.60 | 10.60 | 27 | 31.80 | 28.07 | 26.00 | 30.20 | 29.60 | 29.60 |
| 09 | 13.80 | 10.07 | 8.00 | 12.20 | 11.60 | 11.60 | 28 | 32.80 | 29.07 | 27.00 | 31.20 | 30.60 | 30.60 |
| 10 | 14.80 | 11.07 | 9.00 | 13.20 | 12.60 | 12.60 | 29 | 33.80 | 30.07 | 28.00 | 32.20 | 31.60 | 31.60 |
| 11 | 15.80 | 12.07 | 10.00 | 14.20 | 13.60 | 13.60 | 30 | 34.80 | 31.07 | 29.00 | 33.20 | 32.60 | 32.60 |
| 12 | 16.80 | 13.07 | 11.00 | 15.20 | 14.60 | 14.60 | 31 | 35.80 | 32.07 | 30.00 | 34.20 | 33.60 | 33.60 |
| 13 | 17.80 | 14.07 | 12.00 | 16.20 | 15.60 | 15.60 | 32 | 36.80 | 33.07 | 31.00 | 35.20 | 34.60 | 34.60 |
| 14 | 18.80 | 15.07 | 13.00 | 17.20 | 16.60 | 16.60 | 33 | 37.80 | 34.07 | 32.00 | 36.20 | 35.60 | 35.60 |
| 15 | 19.80 | 16.07 | 14.00 | 18.20 | 17.60 | 17.60 | 34 | 38.80 | 35.07 | 33.00 | 37.20 | 36.60 | 36.60 |
| 16 | 20.80 | 17.07 | 15.00 | 19.20 | 18.60 | 18.60 | 35 | 39.80 | 36.07 | 34.00 | 38.20 | 37.60 | 37.60 |
| 17 | 21.80 | 18.07 | 16.00 | 20.20 | 19.60 | 19.60 | 36 | 40.80 | 37.07 | 35.00 | 39.20 | 38.60 | 38.60 |
| 18 | 22.80 | 19.07 | 17.00 | 21.20 | 20.60 | 20.60 | 37 | 41.80 | 38.07 | 36.00 | 40.20 | 39.60 | 39.60 |
| 19 | 23.80 | 20.07 | 18.00 | 22.20 | 21.60 | 21.60 | 38 | 42.80 | 39.07 | 37.00 | 41.20 | 40.60 | 40.60 |
| 20 | 24.80 | 21.07 | 19.00 | 23.20 | 22.60 | 22.60 | 39 | 43.80 | 40.07 | 38.00 | 42.20 | 41.60 | 41.60 |
| 21 | 25.80 | 22.07 | 20.00 | 24.20 | 23.60 | 23.60 | 40 | 44.80 | 41.07 | 39.00 | 43.20 | 42.60 | 42.60 |

| | | | |
|-----|-------------|-----------------|--|
| 4 | SOLDER TABS | PHOSPHOR BRONZE | MATTE Tin |
| 3 | CONTACT | PHOSPHOR BRONZE | BRIGHT Tin Or Gold-Flash On Contact Area |
| 2 | COVER | LCP,94V-0 | BLACK |
| 1 | HOUSING | LCP,94V-0 | NATURE |
| NO. | PART NAME | MATERIAL | REMARK |



SCALE: 1:1 UNIT: mm
 SIZE: A4
 Title: FPC 1.00mm Pitch 90° H2.00mm SMT Type With Lock Connector
 Molde Code: GT-F1007SR20-XXXXX01
 Unless otherwise General Tolerance:
 X ±0.40
 X.x ±0.30
 X.xx ±0.20
 X° ±5°
 X.x° ±3°

| | | | |
|-------|---------|----------|------------|
| DRAWN | CHECKED | APPROVED | DATE |
| Jiang | Hu | Chen | 2021.06.28 |



REV: A0 SHEET: 1/1

X-ON Electronics

Largest Supplier of Electrical and Electronic Components

Click to view similar products for [FFC & FPC Connectors](#) category:

Click to view products by [G-Switch](#) manufacturer:

Other Similar products are found below :

[00-6200-227-022-800](#) [006205250500825+](#) [006205280500825+](#) [FPH-1602G](#) [086222026001800](#) [52610-0675](#) [62674-201121DLF](#) [52746-1671-TR250](#) [10051922-1610EHLF](#) [10051922-2810EHLF](#) [686322124422](#) [XF3M-2915-1B-R100](#) [AYF353125A](#) [AYF530665TA](#) [AYF534065TA](#) [20FLH-RSM1-TB](#) [PCA-7F-25-HL-3-G](#) [207356-1](#) [52807-0430](#) [FFC05011-10SBB114W5M](#) [502250-8027](#) [FH28K-40S-0.5SH](#) [200528-0260](#) [FH28K-10S-0.5SH](#) [501951-1250](#) [X05B20U43T](#) [0.5K-DX-30PWB](#) [DS1020-08-10VBT12](#) [THD0515-34CL-GF](#) [X05A10L28G](#) [ECC2841061EU](#) [20539-030E-01](#) [1.0K-DHQX-16PWB](#) [1.0K-DHQX-30PWB](#) [1775333-6](#) [10054365-202110ELF](#) [10054365-242110ELF](#) [10054365-282110ELF](#) [10064555-392220HLF](#) [59453-041110EBHLF](#) [59453-091110EDHLF](#) [62674-241141ALF](#) [62684-432100ALF](#) [62684-451100AHLF](#) [62684-5721N0ALF](#) [HFW11R-1STE1MTLF](#) [HFW12R-1STE9LF](#) [HFW14R-1STE9MTLF](#) [HFW18S-2STE9LF](#) [HFW20R-1STAE1HLF](#)