

- G-Switch Specification:**
1. Current rated: 0.5A AC/DC
  2. Voltage rating: 50V AC/DC
  3. Withstanding voltage: 150V AC
  4. Contact resistance: 50mΩ max.
  5. Insulation resistance: 500MΩ min
  6. Durability cycle: 20Cycles
  7. Removal force: 0.03kgf/Pin min
  8. Operating temperature range: -25°C ~ +85°C



**GT-F1007 S R 20 -XX X XX 01**

**G-Switch**

**Series No**

**Termipoint**  
S-SMT

**Angle**  
R-90°

**Terminal Plating**  
01-G/F  
BT-Bright tin

**Housing Colour**  
S-Nature

**Pin Q' PY**  
03-40

**Height**  
20-1.95mm

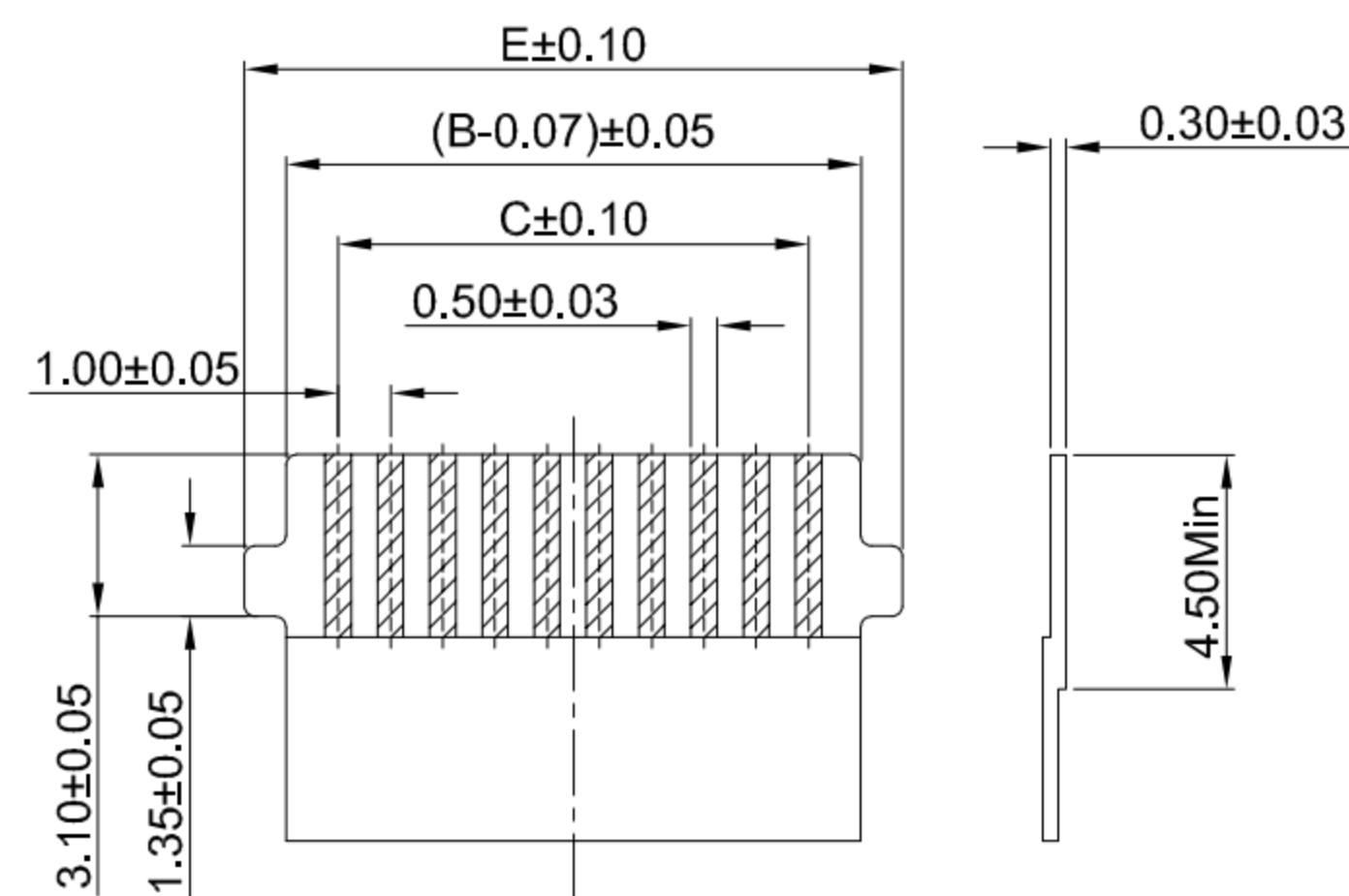
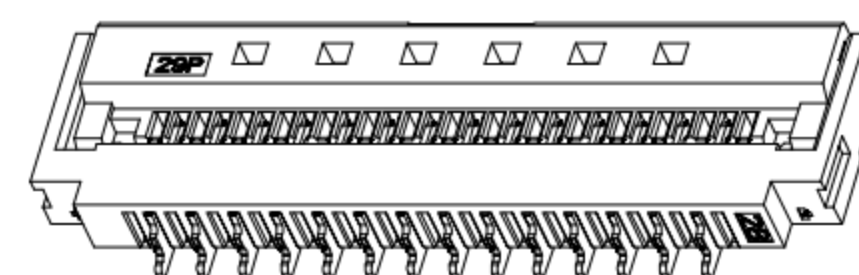
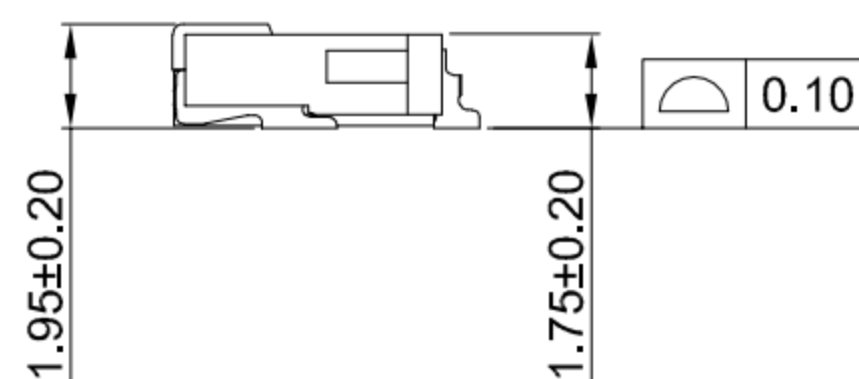
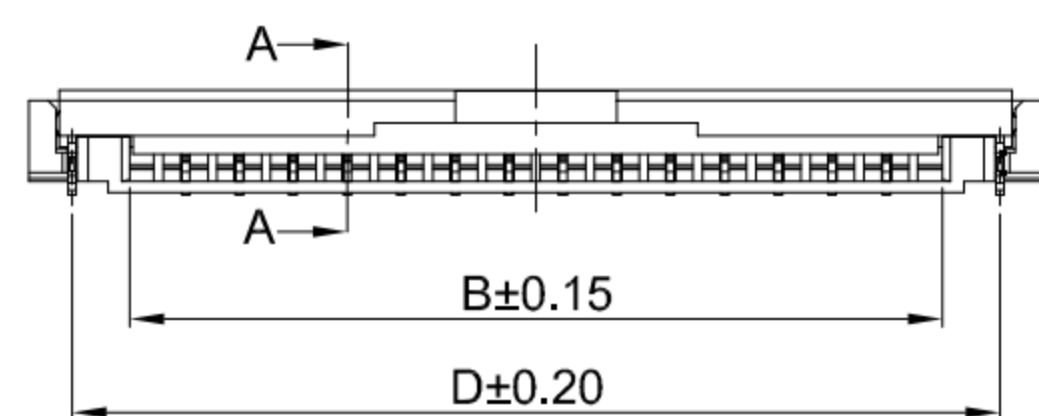

APPLICABLE FPC

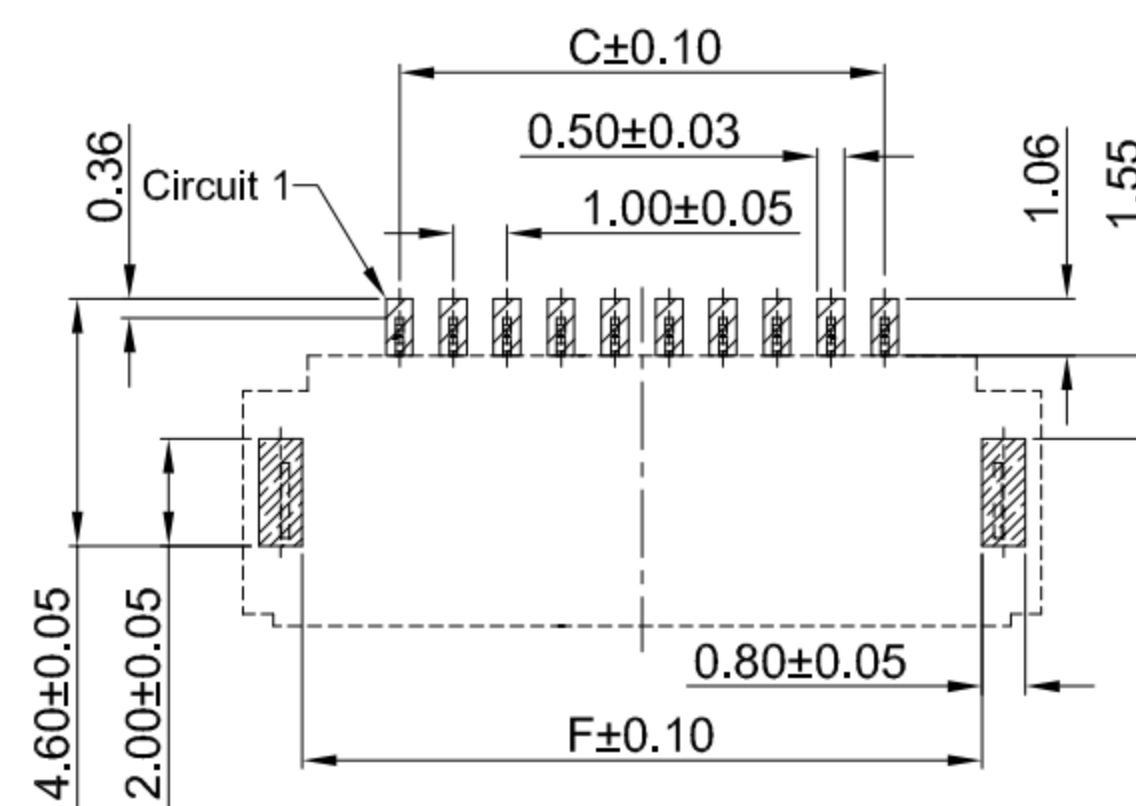

RECOMMENDED PCB LAYOUT  
TOLERANCE:±0.05

**Ordering Information:**

| Circuit | Dimensions(mm) |       |       |       |       |       | Circuit | Dimensions(mm) |       |       |       |       |       |
|---------|----------------|-------|-------|-------|-------|-------|---------|----------------|-------|-------|-------|-------|-------|
|         | A              | B     | C     | D     | E     | F     |         | A              | B     | C     | D     | E     | F     |
| 03      | 7.80           | 4.07  | 2.00  | 6.20  | 5.60  | 5.60  | 22      | 26.80          | 23.07 | 21.00 | 25.20 | 24.60 | 24.60 |
| 04      | 8.80           | 5.07  | 3.00  | 7.20  | 6.60  | 6.60  | 23      | 27.80          | 24.07 | 22.00 | 26.20 | 25.60 | 25.60 |
| 05      | 9.80           | 6.07  | 4.00  | 8.20  | 7.60  | 7.60  | 24      | 28.80          | 25.07 | 23.00 | 27.20 | 26.60 | 26.60 |
| 06      | 10.80          | 7.07  | 5.00  | 9.20  | 8.60  | 8.60  | 25      | 29.80          | 26.07 | 24.00 | 28.20 | 27.60 | 27.60 |
| 07      | 11.80          | 8.07  | 6.00  | 10.20 | 9.60  | 9.60  | 26      | 30.80          | 27.07 | 25.00 | 29.20 | 28.60 | 28.60 |
| 08      | 12.80          | 9.07  | 7.00  | 11.20 | 10.60 | 10.60 | 27      | 31.80          | 28.07 | 26.00 | 30.20 | 29.60 | 29.60 |
| 09      | 13.80          | 10.07 | 8.00  | 12.20 | 11.60 | 11.60 | 28      | 32.80          | 29.07 | 27.00 | 31.20 | 30.60 | 30.60 |
| 10      | 14.80          | 11.07 | 9.00  | 13.20 | 12.60 | 12.60 | 29      | 33.80          | 30.07 | 28.00 | 32.20 | 31.60 | 31.60 |
| 11      | 15.80          | 12.07 | 10.00 | 14.20 | 13.60 | 13.60 | 30      | 34.80          | 31.07 | 29.00 | 33.20 | 32.60 | 32.60 |
| 12      | 16.80          | 13.07 | 11.00 | 15.20 | 14.60 | 14.60 | 31      | 35.80          | 32.07 | 30.00 | 34.20 | 33.60 | 33.60 |
| 13      | 17.80          | 14.07 | 12.00 | 16.20 | 15.60 | 15.60 | 32      | 36.80          | 33.07 | 31.00 | 35.20 | 34.60 | 34.60 |
| 14      | 18.80          | 15.07 | 13.00 | 17.20 | 16.60 | 16.60 | 33      | 37.80          | 34.07 | 32.00 | 36.20 | 35.60 | 35.60 |
| 15      | 19.80          | 16.07 | 14.00 | 18.20 | 17.60 | 17.60 | 34      | 38.80          | 35.07 | 33.00 | 37.20 | 36.60 | 36.60 |
| 16      | 20.80          | 17.07 | 15.00 | 19.20 | 18.60 | 18.60 | 35      | 39.80          | 36.07 | 34.00 | 38.20 | 37.60 | 37.60 |
| 17      | 21.80          | 18.07 | 16.00 | 20.20 | 19.60 | 19.60 | 36      | 40.80          | 37.07 | 35.00 | 39.20 | 38.60 | 38.60 |
| 18      | 22.80          | 19.07 | 17.00 | 21.20 | 20.60 | 20.60 | 37      | 41.80          | 38.07 | 36.00 | 40.20 | 39.60 | 39.60 |
| 19      | 23.80          | 20.07 | 18.00 | 22.20 | 21.60 | 21.60 | 38      | 42.80          | 39.07 | 37.00 | 41.20 | 40.60 | 40.60 |
| 20      | 24.80          | 21.07 | 19.00 | 23.20 | 22.60 | 22.60 | 39      | 43.80          | 40.07 | 38.00 | 42.20 | 41.60 | 41.60 |
| 21      | 25.80          | 22.07 | 20.00 | 24.20 | 23.60 | 23.60 | 40      | 44.80          | 41.07 | 39.00 | 43.20 | 42.60 | 42.60 |

SCALE: 1:1 UNIT: mm  
SIZE: A4

Title: FPC 1.00mm Pitch 90° H2.00mm SMT Type  
With Lock Connector

Unless otherwise  
General Tolerance:

X ±0.40  
X.x ±0.30  
X.xx ±0.20  
X\* ±5°  
X.x° ±3°

Molde Code: GT-F1007SR20-XXXXX01

|       |         |          |            |
|-------|---------|----------|------------|
| DRAWN | CHECKED | APPROVED | DATE       |
| Jiang | Hu      | Chen     | 2021.06.28 |



REV: A0 SHEET: 1/1

|     |             |                 |   |
|-----|-------------|-----------------|---|
| 4   | SOLDER TABS | PHOSPHOR BRONZE | MATTE Tin                                   |
| 3   | CONTACT     | PHOSPHOR BRONZE | BRIGHT Tin Or Gold-Flash<br>On Contact Area |
| 2   | COVER       | LCP,94V-0       | BLACK                                       |
| 1   | HOUSING     | LCP,94V-0       | NATURE                                      |
| NO. | PART NAME   | MATERIAL        | REMARK                                      |



## X-ON Electronics

Largest Supplier of Electrical and Electronic Components

*Click to view similar products for [FFC & FPC Connectors](#) category:*

*Click to view products by [G-Switch](#) manufacturer:*

Other Similar products are found below :

[00-6200-227-022-800](#) [006205250500825+](#) [006205280500825+](#) [FPH-1602G](#) [086222026001800](#) [52610-0675](#) [62674-201121DLF](#) [52746-1671-TR250](#) [10051922-1610EHLF](#) [10051922-2810EHLF](#) [686322124422](#) [XF3M-2915-1B-R100](#) [AYF353125A](#) [AYF530665TA](#) [AYF534065TA](#) [20FLH-RSM1-TB](#) [PCA-7F-25-HL-3-G](#) [207356-1](#) [52807-0430](#) [FFC05011-10SBB114W5M](#) [502250-8027](#) [FH28K-40S-0.5SH](#) [200528-0260](#) [FH28K-10S-0.5SH](#) [501951-1250](#) [X05B20U43T](#) [0.5K-DX-30PWB](#) [DS1020-08-10VBT12](#) [THD0515-34CL-GF](#) [X05A10L28G](#) [ECC2841061EU](#) [20539-030E-01](#) [1.0K-DHQX-16PWB](#) [1.0K-DHQX-30PWB](#) [1775333-6](#) [10054365-202110ELF](#) [10054365-242110ELF](#) [10054365-282110ELF](#) [10064555-392220HLF](#) [59453-041110EBHLF](#) [59453-091110EDHLF](#) [62674-241141ALF](#) [62684-432100ALF](#) [62684-451100AHLF](#) [62684-5721N0ALF](#) [HFW11R-1STE1MTLF](#) [HFW12R-1STE9LF](#) [HFW14R-1STE9MTLF](#) [HFW18S-2STE9LF](#) [HFW20R-1STAE1HLF](#)