

GT-TC074X-HXXX-LX

G-SWITCH

Operating Force

A=160gf
B=250gf
C=100gf

D=70gf

E=130gf H038=3.8 H043=4.3

F=320gf H045=4.5 H050=5.0

G=400gf H055=5.5 H060=6.0

H065=6.5 H070=7.0

H080=8.0 H085=8.5

H090=9.0 H095=9.5

Switch Height (mm)

L05=50,000 Cycles (B, F, G)

L1=100,000 Cycles (A, B)

L3=300,000 Cycles (A, C, D)

L5=500,000 Cycles (A, C, D)

Switch lifetime (Force)

G-Switch Specification:

Operating temperature range -30 to+85

Rating 50mA.12V DC

Insulation resistance: 100MΩ min.100V DC

Dielectric strength 250V AC for 1 min

Contact resistance: 100m Ω max.

Travel:0.25±0.1mm

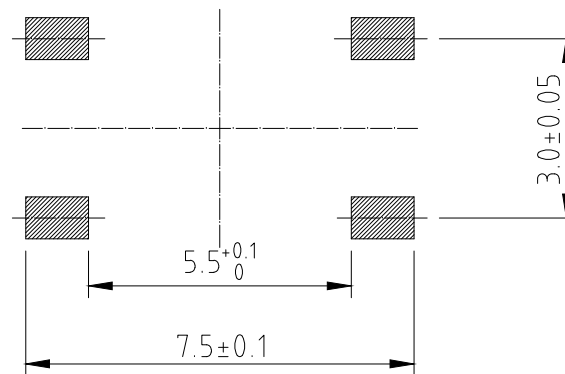
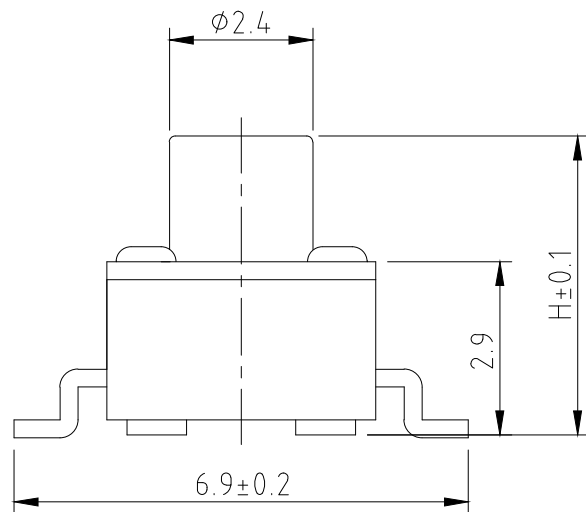

P.C.B LAND DIMENSION

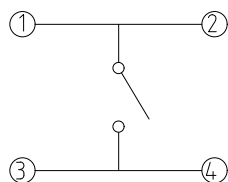

电路图



G-Switch Electronic (HongKong) CO.,Ltd.

Unless otherwise specified, Tolerance:
X. ±0.30
X.x ±0.20
X.xx ±0.15
X.xxx ±0.10
Angles ±3°

DESIGN FengFengChen

DATE 2019.05.29

Molde code:

CHECKED

DATE

GT-TC074X-HXXX-LX

APPROVED

DATE

<http://www.dg-switch.com>

REV.: X1

SCALE: 4:1

UNIT: mm

TEL:0769-82388879

SIZE: A4

SHEET: 1/1

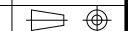

X-ON Electronics

Largest Supplier of Electrical and Electronic Components

Click to view similar products for [Tactile Switches](#) category:

Click to view products by [G-Switch](#) manufacturer:

Other Similar products are found below :

[5GTH92001](#) [5GTH9202242](#) [ADTSA62NV](#) [ADTSA62RV](#) [B3F-3123](#) [1977177-8](#) [1977266-1](#) [ADTSA63NV](#) [ADTSM21NSVTR](#)
[ADTSM25RVTR](#) [ADTSM32NVTR](#) [ADTSMW64RV](#) [FSMRA4JHA04](#) [GS4.70F300QP](#) [3ESH9R](#) [KSC241J SP DELTA LFS](#) [3FTL600RAS](#)
[3FTL640RAS](#) [Y96K132V0FPLFS](#) [5GSH92001](#) [5GTH9658222](#) [ADTSM31NVTR](#) [2-1977120-7](#) [TSJW-5.2-260-TR](#) [KMT011MNGJLHS](#)
[ADTSG648NV](#) [ADTSM62KSVTR](#) [ADTSM648NV](#) [95C06E3RAT](#) [3ATH9Q](#) [FSM4JSMLXTR](#) [FSM4JSMXL](#) [FSMRA8JHA04](#) [HARS0073](#)
[Y97HS12A5RAFP](#) [Y97BT23B2HAFP](#) [Y33R411N9FPLFT](#) [Y31C01402FPLFS](#) [PTS645SK50SMTR92](#) [ADTSM32NVB](#) [KMS233GPWTLFG](#)
[Y78B42324FP](#) [Y33R21116FPLFT](#) [Y31B43131FPLFG](#) [Y78B64124FP](#) [Y71243251FP](#) [Y33R31119FPLFT](#) [Y97HS12A5TAFP](#)
[PTS638SK25SMTR2LFS](#) [Y97LT25BADBFP](#)