

# 樣品承認書

SAMPLE ACKNOWLEDGEMENT

品贊電子（東莞）有限公司

G-SWITCH ELECTRONIC (HONG KONG) CO., LIMITED ISO9001体系认证工厂

客戶名稱CUSTOMER:

產品名稱DESCRIPTION: 轻触开关

品讚料號G-Switch P/N: GT-TZ084B-H015-L1

客戶料號PART NUMBER:

客戶地址ADDRESS:

品讚簽章確認:



客戶確認  
CUSTOMER APPROVAL

核對  
CHECK

審查  
INSPECTION

核准  
APPROVAL

確認蓋章日期  
DATE

## Molde Code:

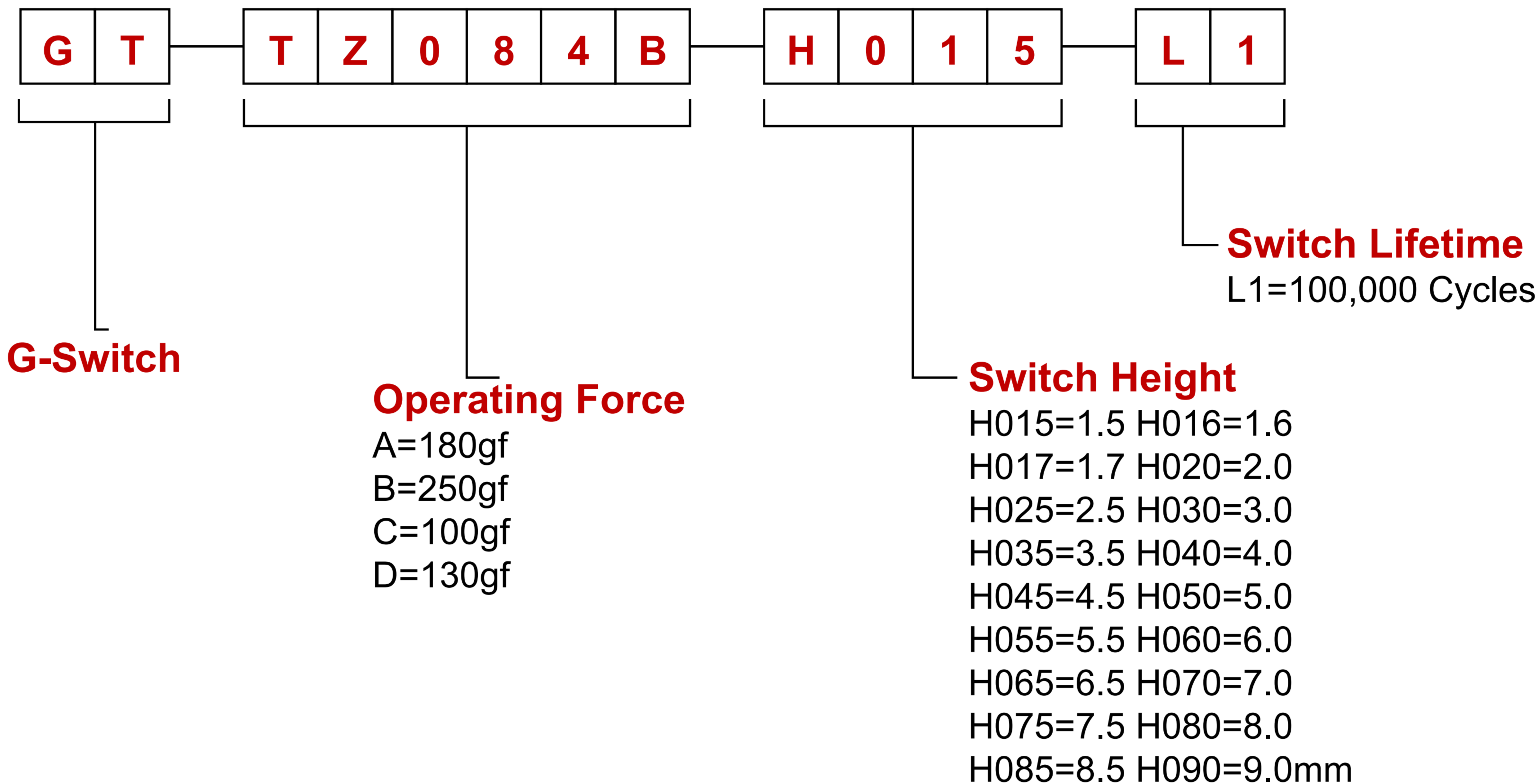

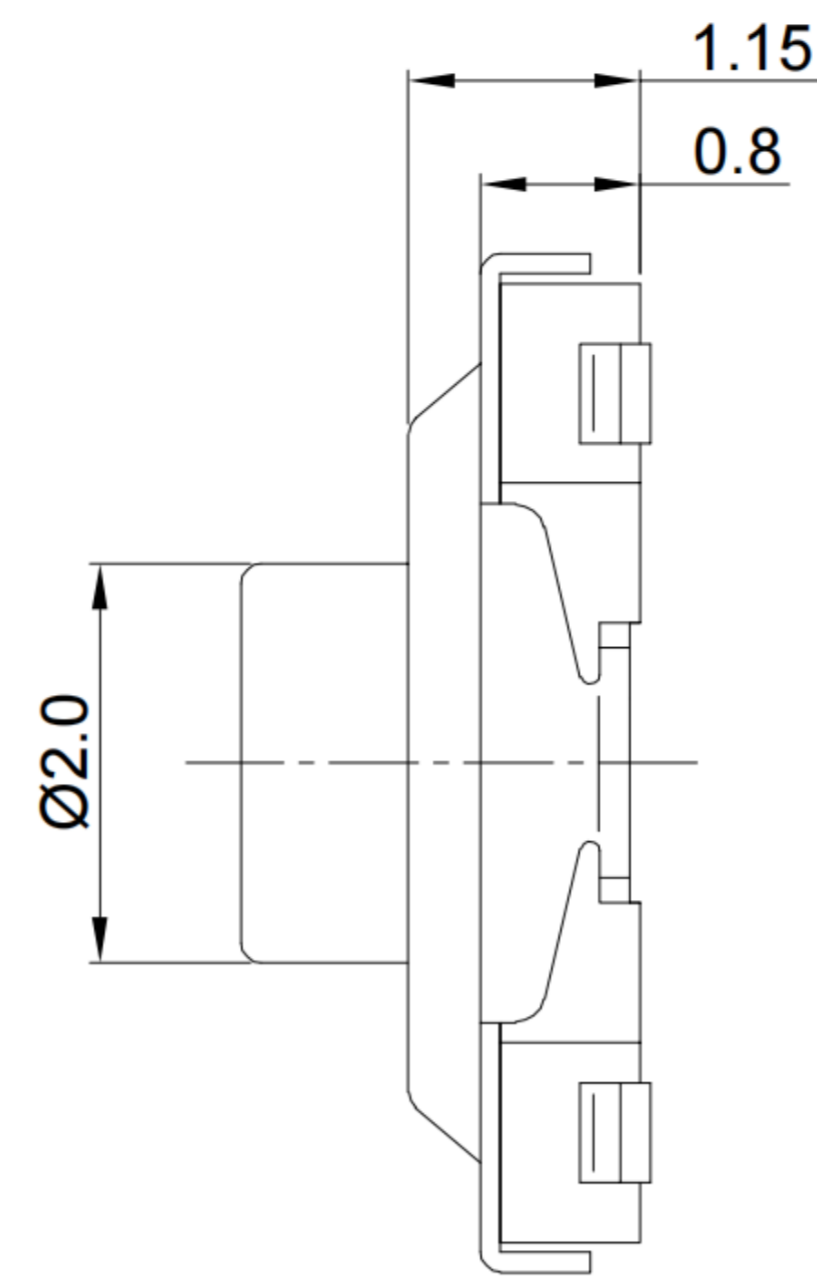
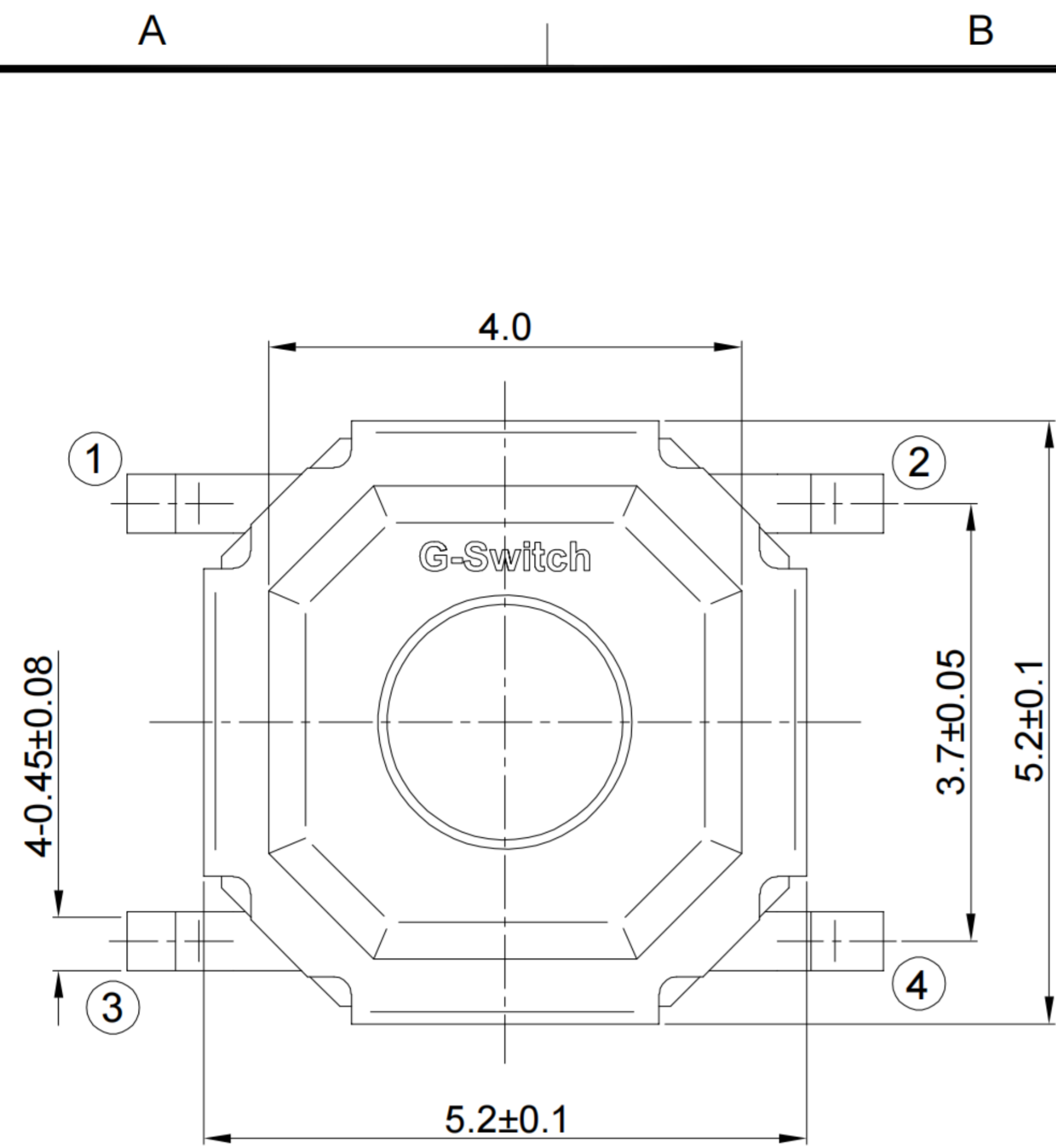

### GT-TZ084X-HXXX-LX

**Operating Force**  
 A=180gf  
 B=250gf  
 C=100gf  
 D=130gf

**Switch Height**  
 H015=1.5 H016=1.6  
 H017=1.7 H020=2.0  
 H025=2.5 H030=3.0  
 H035=3.5 H040=4.0  
 H045=4.5 H050=5.0  
 H055=5.5 H060=6.0  
 H065=6.5 H070=7.0  
 H075=7.5 H080=8.0  
 H085=8.5 H090=9.0

**Switch Lifetime (Force)**  
 L1=100,000 Cycles

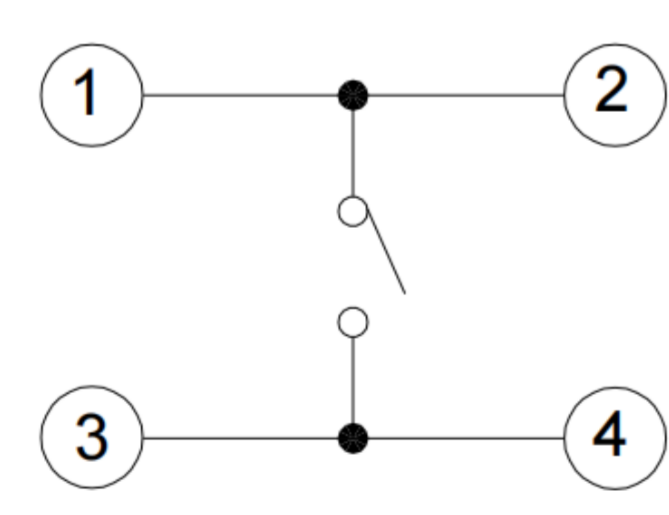
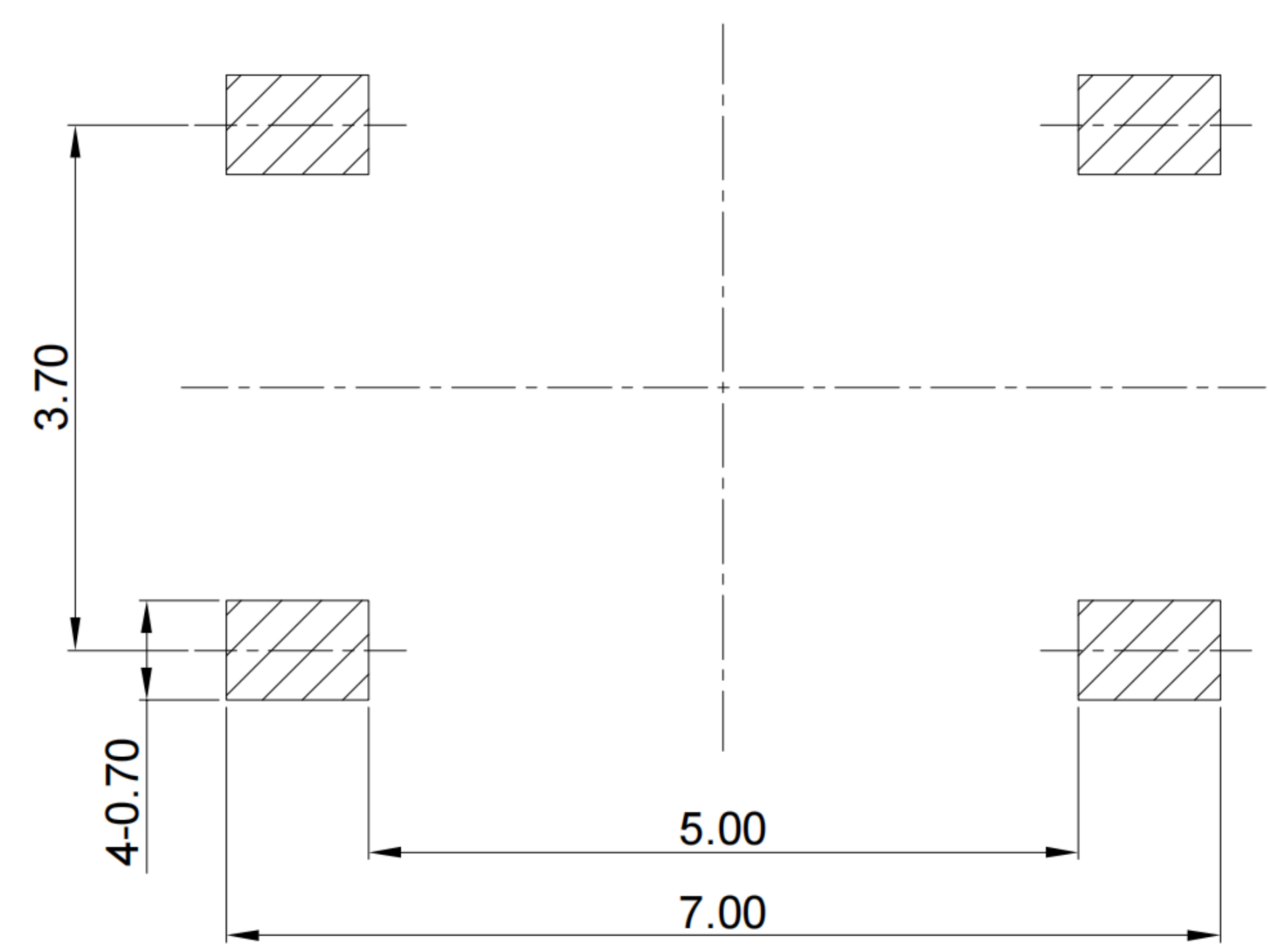
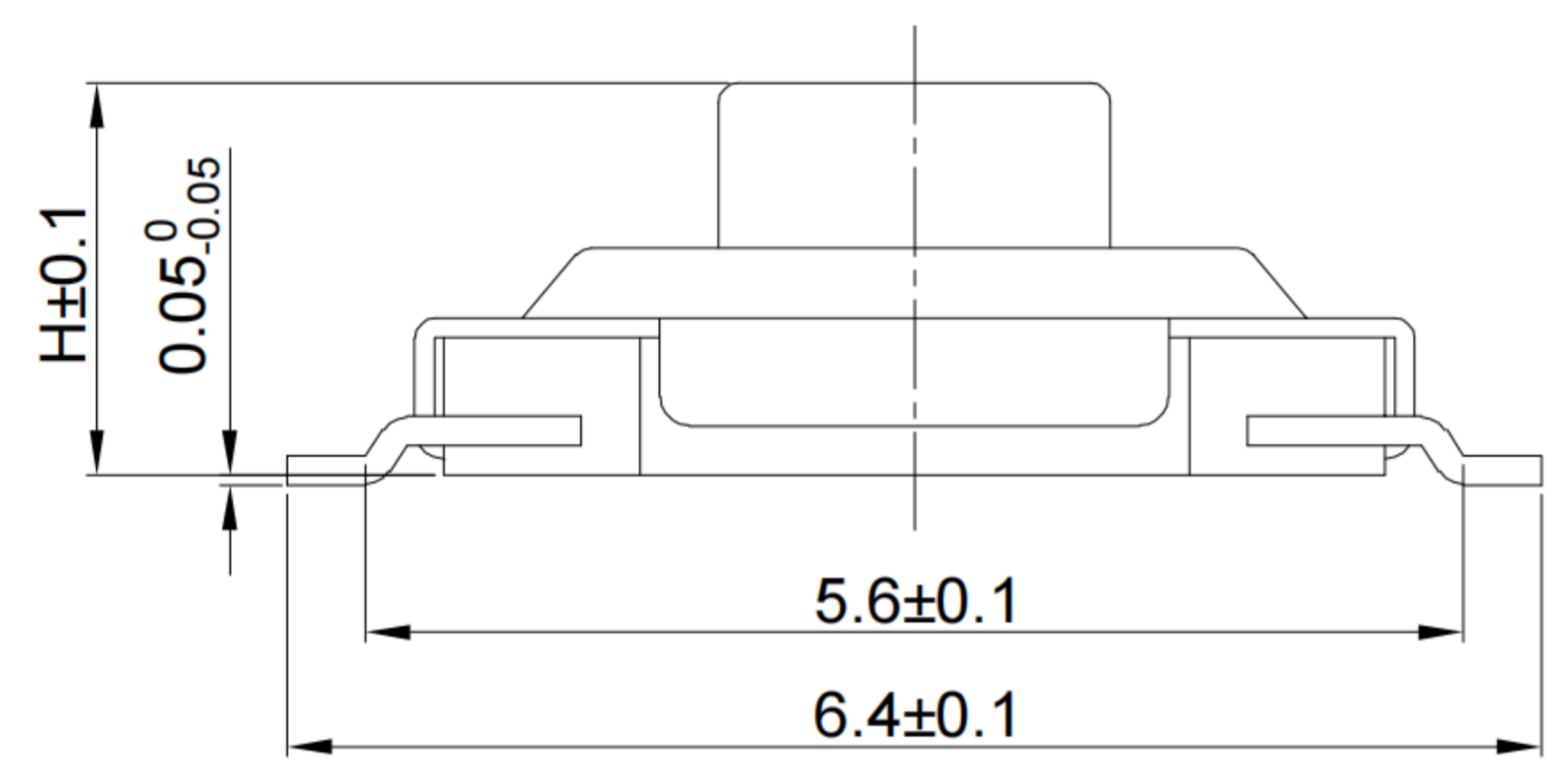

CIRCUIT DIAGRAM

RECOMMENDED PCB LAYOUT  
 TOLERANCE:±0.05

**G-Switch Specification:**

1. Operating temperature range: -40°C ~ +85°C
2. Rating: 50mA, 12V DC
3. Insulation resistance: 100MΩ min. 100V DC
4. Dielectric strength: 250V AC for 1 min
5. Contact resistance: 100m Ω max.
6. Travel: 0.25±0.1mm

6	TAPE	PI	
5	COVER	BRASS	
4	STEM	COPPER ALLOY	
3	CONTACT	STAINLESS STEEL	Ag PLATING
2	TERMINAL	STAINLESS STEEL	Ag PLATING
1	BASE	HIGH TEMPERATURE PLASTIC	LCP BLACK
NO.	PART NAME	MATERIAL	REMARK

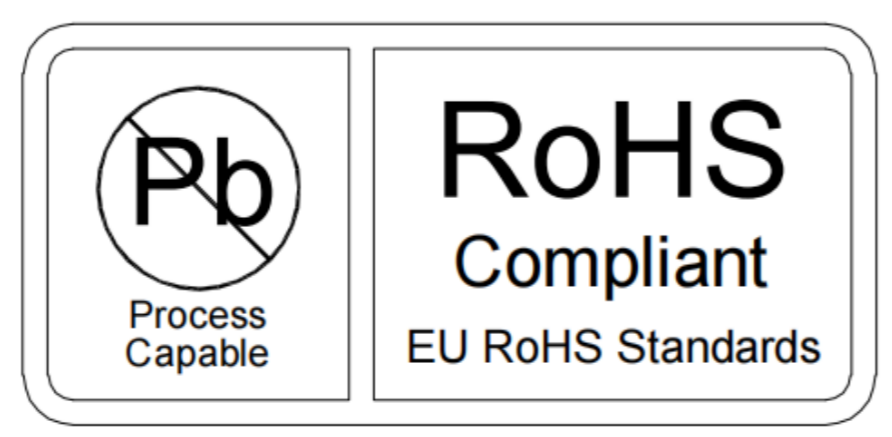

SCALE: 1:1	UNIT: mm
SIZE: A4	
Unless otherwise General Tolerance:	
X.	±0.40
X.x	±0.30
X.xx	±0.20
X°	±5°
X.x°	±3°

Title: Vertical Tact Switch SMT 5.2×5.2×Hmm Simplified version			
Molde Code: GT-TZ084X-HXXX-LX			
DRAWN	CHECKED	APPROVED	DATE
Xia	Chen	Chen	2024.07.15



## 1. General specification 基本说明

### 1.1 Scope 范围

This specification covers the requirements for single key switches which have no key top(TACT SWITCHES:MECHANICAL CONTACT)  
此规范含盖单推柄和无推柄的轻触开关要求

### 1.2 Operating Temperature Range 使用温度范围

-40 to+85°C(normal humidity, normal press.) 正常湿度, 标准压力

### 1.3 Storage Temperature Range 保存温度范围

-40 to+85°C(normal humidity, normal press.)

### 1.4 Test Conditions 测试条件

Tests and measurements shall be made in the following standard

conditions unless otherwise specified:

测试和计量按下列标准条件除非特殊说明

- Normal temperature (temperature 5 to 35°C) 标准温度
- Normal humidity (relative humidity 45 to 85%) 正常湿气
- Normal pressure (pressure 860 to 1060 mbars) 标准压力

In case any question arises from the judgment made, tests shall be conducted in the following conditions:

- Temperature (20±2°C) 温度
- Relative humidity (65±5%) 相对湿度
- Pressure (860 to 1060 mbars) 压力

## 2. TYPE OF ACTUATION 动作类型

Tactile feedback 轻触返回

## 3. CONTACT ARRANGEMENT 1 poles 1 throws 接触形式 1接点1回路

(Details of contact arrangement are given in the assembly drawings.)

细接点形式在装配图中

## 4. MAXIMUM RATINGS

DC 12 V 50 mA 最大额定值  
DC 1 V 10 μA 最小额定值

## 6. General specification 性能

### 6.1 电气的性能

Item项目	Test Condition测试条件	Requirements要求
6.1.1 Contact Resistance 接触电阻	Applying static load twice the actuating force to the center of the stem, measurements shall be made with a 1 kHz small-current contact resistance meter. 用两倍的动作用力作静负载施加于按钮的中心,并用1千赫小电流接触电阻仪测量	100mΩ以下
6.1.2 Insulation Resistance 绝缘电阻	Measurements shall be made following application of DC100V potential between terminals and between individual terminals and frame for one minute. 在端子与端子之间,端子与外壳之间施加DC100V, 一分钟。	100MΩ以上
6.1.3 Dielectric withstanding voltage 电气耐压	AC 250 V (50Hz or60Hz) shall be applied between terminals and between individual terminals and frame for one minute. 在端子与端子之间,端子与外壳之间施加AC250V(50HZ-60HZ)	There shall be no breakdown. 无击穿、闪烁现象
6.1.4 Bounce 抖动	Lightly striking the center of the stem at a rate encountered in normal use (3 to 4 operations per sec),Bounce shall be tested when “ON” and “OFF”. 在正常使用中(以每秒3-4次周期)轻轻地在手柄中心加力,在通与断瞬间测试抖动。	10mS以下

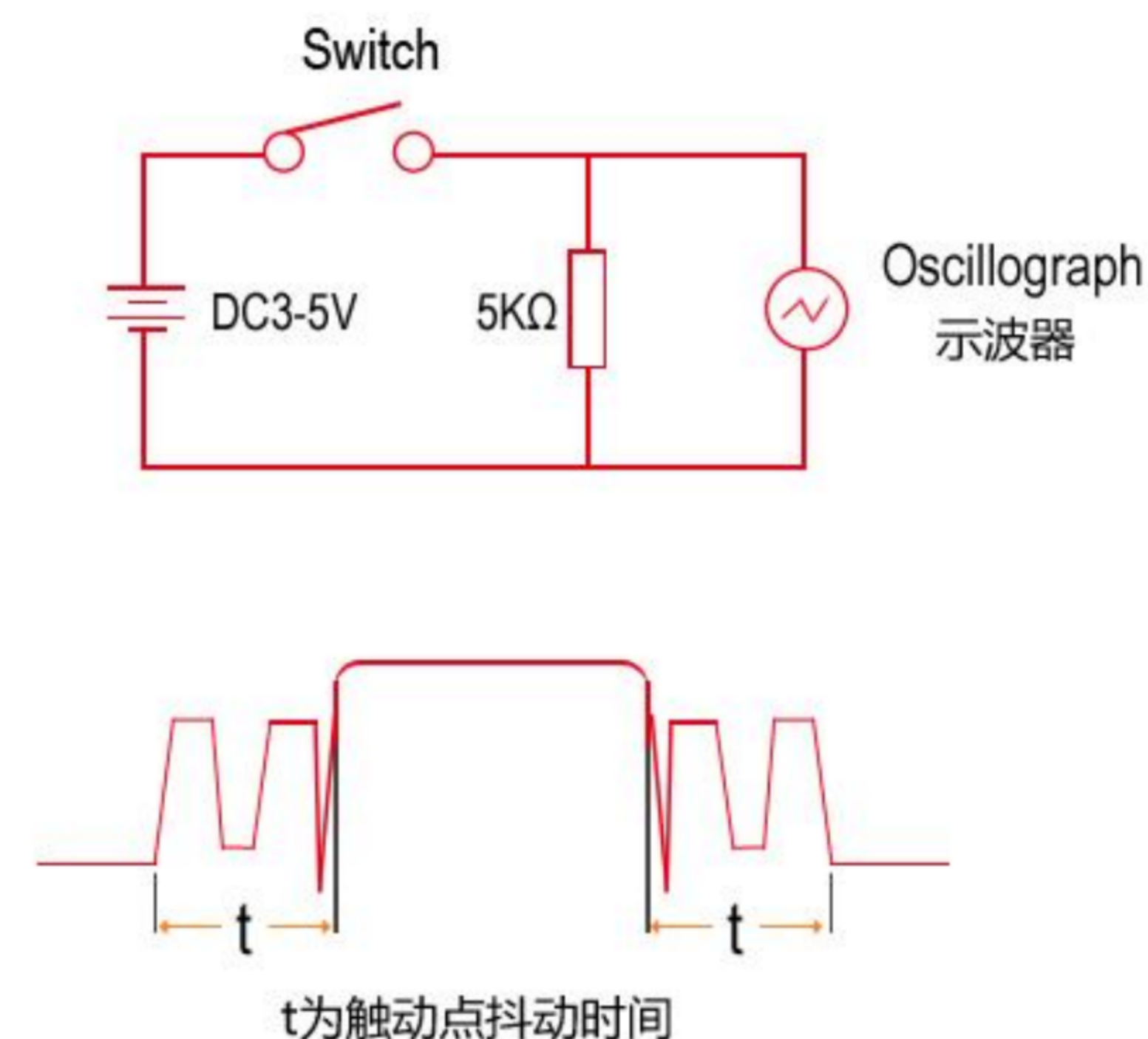

## 6. General specification 性能

### 6.2 机械的性能

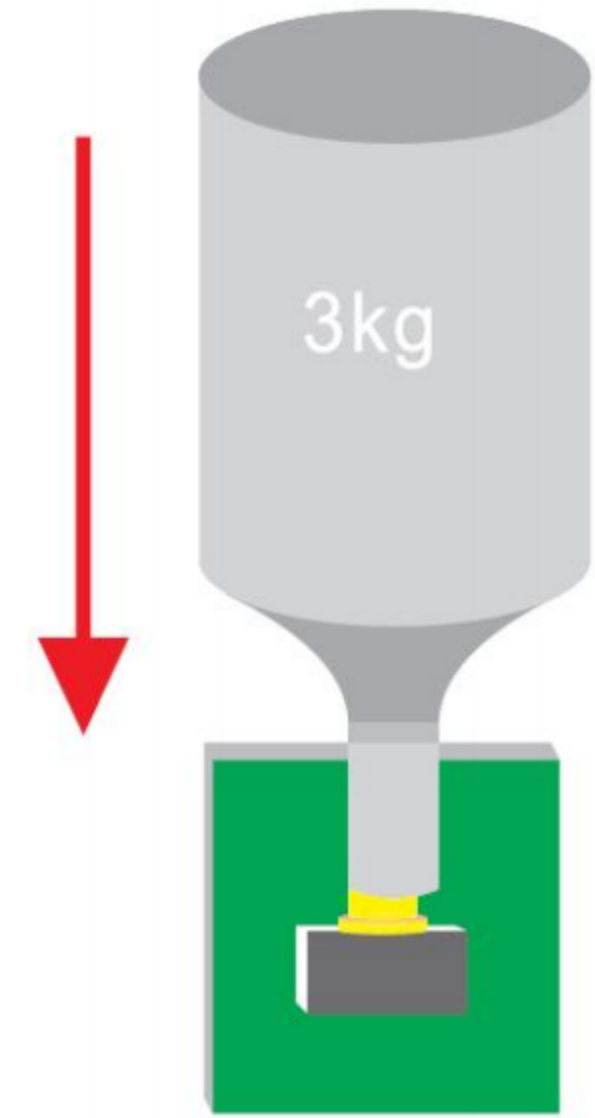
Item项目	Test Condition测试条件	Requirements要求	
6.2.1 Actuating Force 动作力	Place the switch such that the direction of switch operation is vertical and then gradually increase the load applied to the center of the stem, the maximum load required for the stem to come to a stop shall be measured. 开关的动作方向为垂直放置开关向推柄中心逐渐地增加负荷直到推柄停止时所测量的最大负荷。	A=180gf B=250gf C=100gf	±50gf
6.2.2 Travel 行程	Place the switch such that the direction of switch operation is vertical and then apply a static load twice the actuating force to the center of the stem, the travel distance for the stem to come to a stop shall be measured. 开关的动作方向为垂直放置开关,并以双倍动作力的静负荷作用推柄中心,测量推柄从开始到停止的行程距离。	0.25±0.1mm	
6.2.3 Return Force 返回力	The sample switch is installed such that the direction of switch operation is vertical and, upon depression of the stem in its center the whole travel distance, the force of the stem to return to its free position shall be measured. 开关的动作方向为垂直放置开关,在已有行程的推柄中心向上减小压力,推柄回到自由位置时所测量到的力	50 gf min	
6.2.4 Static Strength 静止强度	Placing the switch such that the direction of switch operation is vertical, a static load of 3 kgf shall be applied in the direction of stem operation for a period of 60 seconds. 开关的动作方向为垂直放置开关,在推柄动作方向施加3KG的静负荷,60秒时间。		
		There shall be no sign of damage mechanically and electrically. 无机械的和电气的损伤迹象	

## 6. General specification 性能

### 6.3 使用耐久性

Item项目	Test Condition测试条件	Requirements要求
6.3.1 Operating Life 动作寿命	Measurements shall be made following the test set forth below:按下下列条件进行寿命试验(1)DC 5V 5mA resistive load.DC 5V 5mA阻性负载(2)Rate of operation:1 to 1.5 operations per second动作频率:1-1.5次/每秒(3)Depression:动作力×30% gf减压力(4)Cycles of operation (动作次数) :L1=1,00,000cycles	Contact resistance: 200mΩ Max.接触电阻 Insulation resistance : 50 MΩ Min.绝缘电阻 Actuating force:动作力+ 30 %or- 30%of initial force. ±30%初始动作力Item 6.1.3 Item 6. 2.2
6.3.2 Moisture Resistance 耐潮湿	Following the test set forth below the sample shall be left in normal temperature and humidity conditions for one hour before measurements are made: 样品按下下列条件进行耐潮湿试验,试验后在正常温度和湿度条件下放置1小时后测定(1)Temperature:60±2℃ 温度(2)Relative humidity:90 to 95%相对湿度(3)Time: 96 hours时间Water drops shall be removed.擦除水珠	Contact resistance: 200mΩ Max.接触电阻 Insulation resistance : 50 MΩ Min.绝缘电阻 Item 6.1.3、 6.1.4 Item 6. 2.1~6.2.3
6.3.3 Low Temperature Resistance 耐低温	Following the test set forth below the sample shall be left in normal temperature and humidity conditions for one hour before measurements are made: 样品按下下列条件进行耐低温试验,试验后在正常温度和湿度条件下放置1小时后测定 (1)Temperature:-40±2℃ 温度(2)Time:96 hours时间Water drops shall be removed.擦除水珠	Contact resistance: 200mΩ Max.接触电阻 Insulation resistance : 50 MΩ Min.绝缘电阻 Item 6.1.3、 6.1.4 Item 6. 2.1~6.2.3
6.3.4 Heat Resistance 耐热	Following the test set forth below the sample shall be left in normal temperature and humidity conditions for one hour before measurements are made: 样品按下下列条件进行耐热试验,试验后在正常温度和湿度条件下放置1小时后测定(1)Temperature:85±2℃ 温度(2)Time:96 hours时间	Contact resistance: 200mΩ Max.接触电阻 Insulation resistance : 50 MΩ Min.绝缘电阻 Item 6.1.3、 6.1.4 Item 6. 2.1~6.2.3

## 6. General specification 性能

### 6.3 使用耐久性

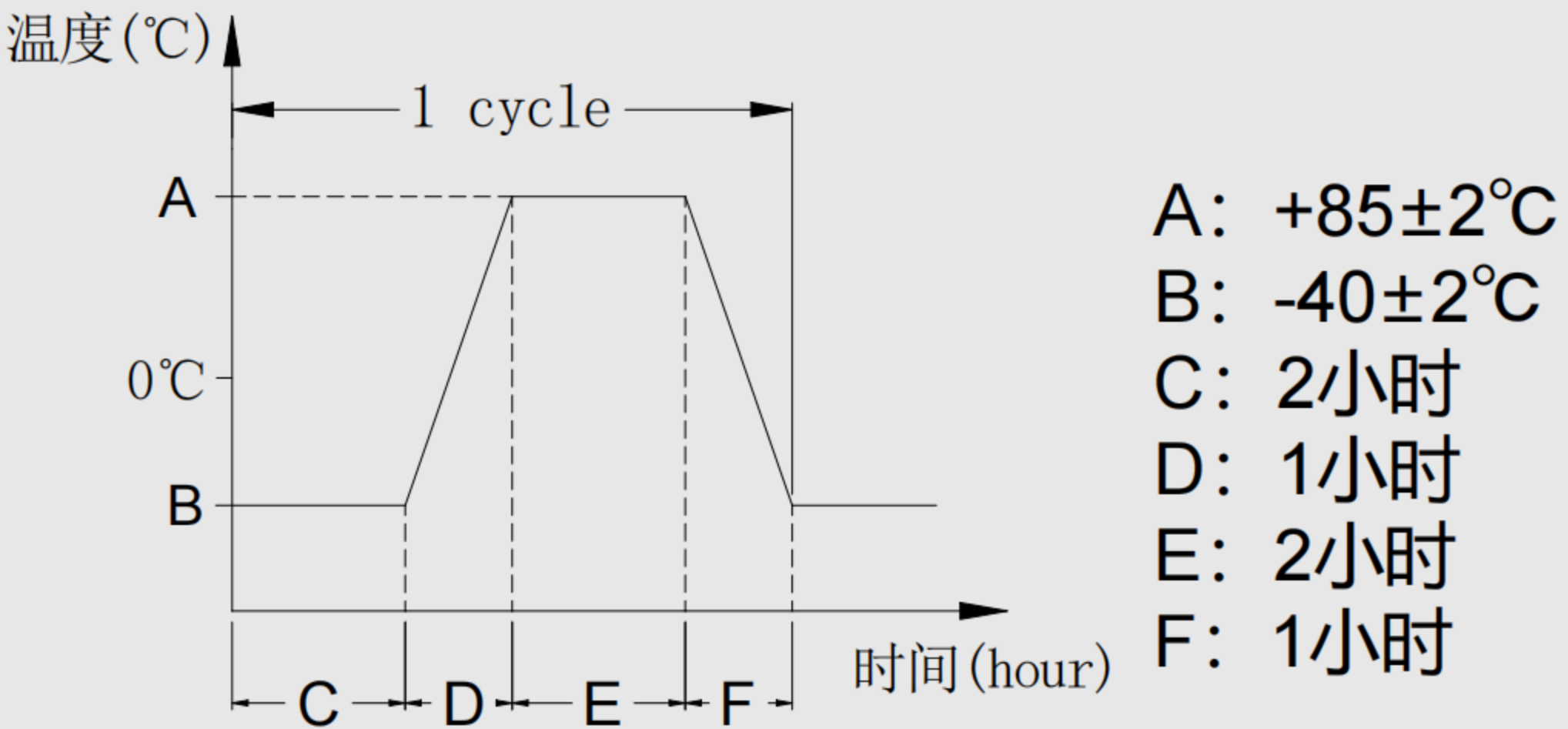
Item项目	Test Condition测试条件		Requirements要求
<p>6.3.5 Change of Temperature 温度循环</p>	<p>Following ten cycles of high temperature test .The Sample shall be Placed in Normal temperature and humidity Conditions for one hour before measurements are made. During this test, water drops shall be removed. 样品按下列条件进行高低温循环试验,试验后在正常温度和湿度条件下放置1小时后测定</p>	 <p style="text-align: center;">Cycling: Five cycles 周期: 5次</p>	<p>Contact resistance: 200mΩ Max.接触电阻 Insulation resistance : 50 MΩ Min.绝缘电阻 Item 6.1.3、6.1.4 Item 6. 2.1~6.2.3</p>
<p>6.3.6 Salt Spray Test 盐雾试验</p>	<p>The salt spray test shall be conducted at the following conditions : 样品按下列条件进行盐雾试验 (1)Density(浓度):溶液(5±1)% NaCl (质量百分比) (2)Temperature:35±2°C温度(3)Time:24 hours时间</p>		<p>金属件无发黄、生锈</p>



## 6. General specification 性能

### 6.3 使用耐久性

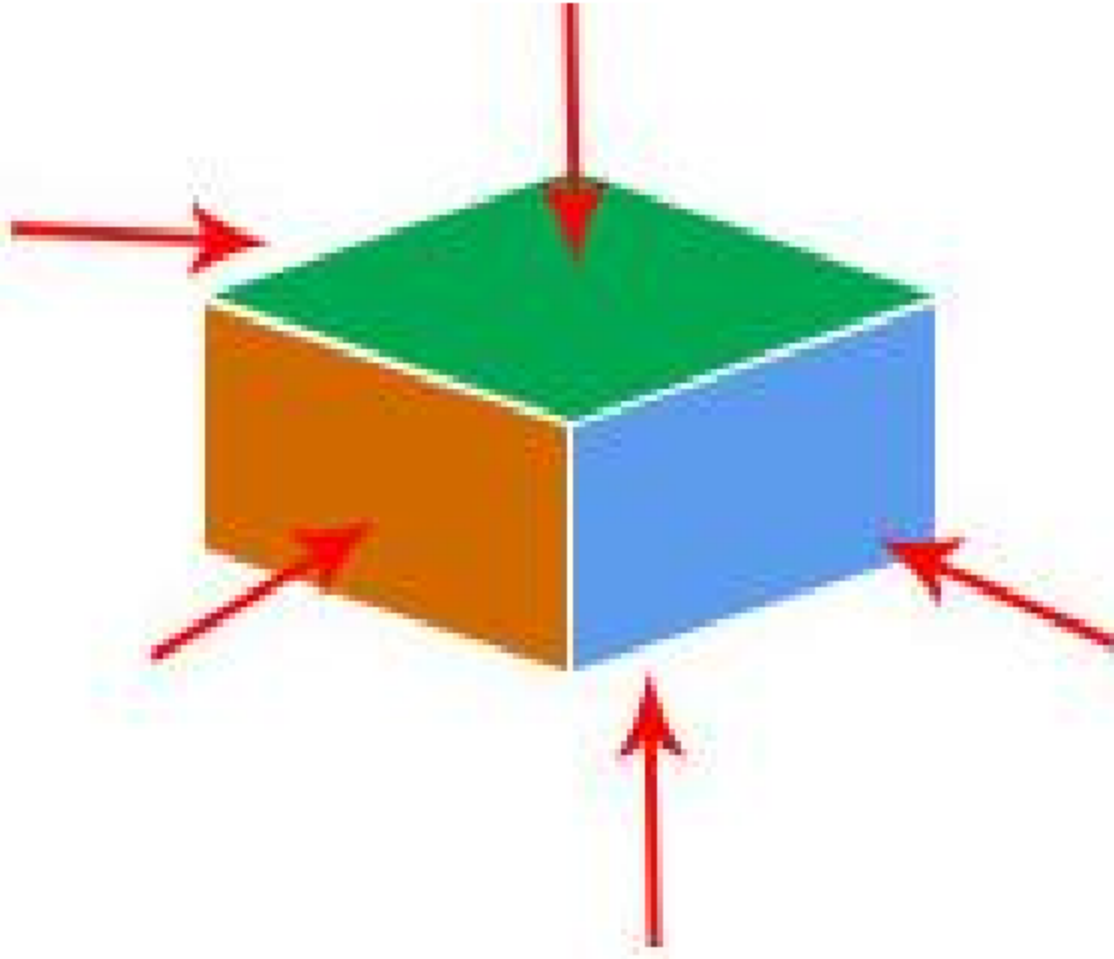
Item项目	Test Condition测试条件		Requirements要求
<p>6.3.7 Vibration Resistance 耐振动</p>	<p>Measurements shall be made following the test set forth below:按下下列条件进行抗振动试验                      (1)Range of oscillation:10 to 55Hz频率范围                      (2)Amplitude,pk-to-pk:1.5 mm振幅:峰-峰1.5mm                      (3)Cycle of sweep: 10-55-10Hz in one minute, approx.扫描周期: 10-55-10Hz约一分钟内(4)Mode of sweep: Logarithmically sweep or uniform sweep.扫描方式:对数扫描式恒定扫描(5)Direction of oscillation:振动方向Three mutually perpendicular directions, including the direction of stem travel. 3个相互垂直方向,包括推柄行程方向(6)2 hours each ,for a total of 6hours.每方向2小时.共6小时</p>		<p>Item 6.1 Item 6. 2.1、6.2.2</p>
<p>6.3.8 Impact Shock Resistance 抗冲击</p>	<p>Measurements shall be made following the test set forth below: 按下下列条件进行冲击试验                      (1)Acceleration:80g 加速度                      (2)Cycles of test :3 cycles each in 6directions, for a total of 18cycles 试验次数:每个方向3次,6个方向共18次</p>		<p>Item 6.1 Item 6. 2.1、6.2.2</p>

## 7. 焊接条件:

Item项目	Test Condition测试条件	Requirements要求
<p>7.1 Hand soldering 手工焊接</p>	<p>Please practice according to bellow conditions:            (1)Soldering temperature :≤260℃            (2)Continuous soldering time:≤5 S            (3)Capacity of soldering iron:≤20 W            请按以下条件进行焊接:            (1)焊锡温度: ≤260℃            (2)连续焊接时间: ≤5 S            (3)电烙铁的功率: ≤20 W</p>	<p>Item 6.1 Item 6. 2.1、 6.2.2</p>
<p>7.2 Automatic flow soldering 自动焊接</p>	<p>For the product of SMT , type solder according to the following conditions            对于SMT产品, 请按以下条件进行焊接Caution: the condition mentioned above is a temperature on the PCB surface on which parts are mounted. There are cases where PCB temperature greatly differs from switch's surface temperature depending on PCB material, size, thickness, etc. The switch's surface temperature shall not allowed to exceed 260℃ 注意: 以上提及的条件是零部件上PCB表面的温度, 由于PCB的材料、尺寸、厚度等不同, PCB从开关表面获得的温度也会有很大产不同, 因此, 尽量不要让开关表面温度超过260℃</p>	<p>Item 6.1 Item 6. 2.1、 6.2.2</p>

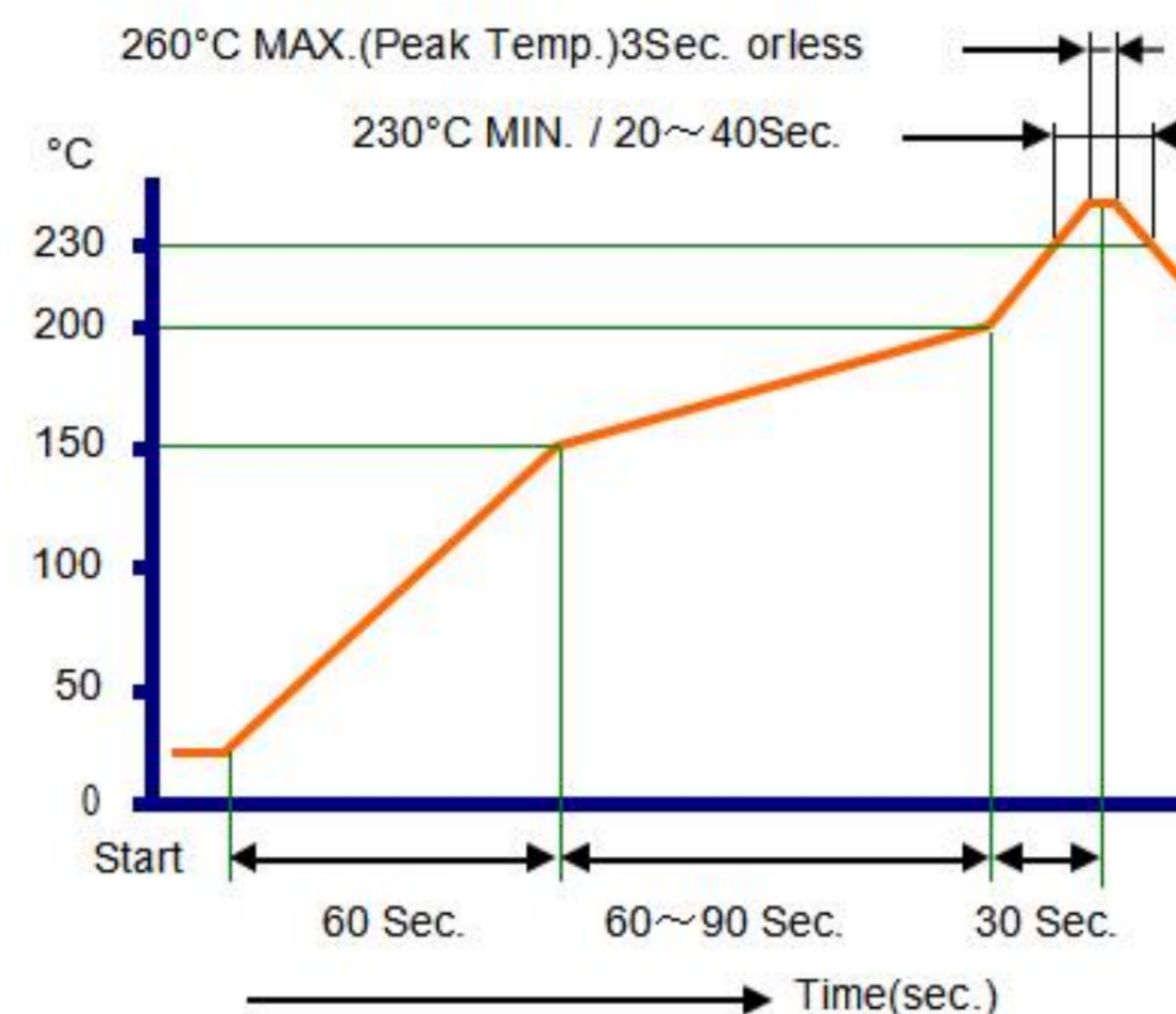

## 8. Other precautions其他注意事项:

- ① Following the soldering process, do not try to clean the switch with a solvent or the like.进行焊接过程中, 不可以用溶剂或类似品清洗开关
- ② Safeguard the switch assembly against flux penetration from its topside.防止助焊剂从开关的顶端渗入
- ③ Please have the products keep in close status and the storage time is 90 days guaranty after delivering the goods at most.  
交货后保证开关处于封密状态并库存时间90天以下

## 9.REEL PACKAGING 盘装:

### 9.1 Scope 范围

This specification covers the requirements of the reel packaging for SMT standard type of tact switches. 该规范包含SMT标准型轻触开关的绕带封装的要求。



轻触开关



USB系列



FFC/FPC连接器



拨动开关



按键开关



板对板连接器



线对板连接器



DC插座



耳机插座



拨码开关



卡座系列



电位器



微动开关



连接器



检测开关



RF射频同轴连接器



HDMI连接器

## 品赞电子 (东莞) 有限公司

Tel:0769-82388879

Fax:0769-82388879

● 专业网址:  
<http://www.dg-switch.com>

● 公司地址:  
东莞市长安镇滨海湾新区华海路2号信鸿欧菲光科创中心2栋701号

● 工厂地址:  
东莞长安镇猫山东路101号301室

## X-ON Electronics

Largest Supplier of Electrical and Electronic Components

*Click to view similar products for [Tactile Switches](#) category:*

*Click to view products by [G-Switch](#) manufacturer:*

Other Similar products are found below :

[6407-250V-25273P](#) [ADTSA62NV](#) [B3F-3123](#) [1977177-8](#) [1977266-1](#) [ADTSA63NV](#) [ADTSM21NSVTR](#) [ADTSM25RVTR](#) [ADTSM32NVTR](#)  
[ADTSMW64RV](#) [1977120-6](#) [FSMRA4JHA04](#) [GS4.70F300QP](#) [KSC241J SP DELTA LFS](#) [3FTL600RAS](#) [3FTL640RAS](#) [Y96K132V0FPLFS](#)  
[09158](#) [6407-250V-25343P](#) [ADTSM31NVTR](#) [2-1977120-7](#) [TSJW-5.2-260-TR](#) [TME1-01-Z](#) [Y651050400P](#) [KMT011MNGJLHS](#) [70-201.0](#)  
[ADTSG648NV](#) [ADTSM62KSVTR](#) [ADTSM648NV](#) [95C06E3RAT](#) [3ATH9Q](#) [FSMRA8JHA04](#) [HARS0073](#) [Y33R411N9FPLFT](#)  
[Y33R51139FPLFT](#) [Y31C01402FPLFS](#) [PTS645SK50SMTR92](#) [ADTSM32NVB](#) [KMS233GPWTLFG](#) [Y78B64124FP](#) [Y33A812C5FP LFT](#)  
[Y56B2D120FP LFS](#) [PTS645 DVM83-BN125-2 LFS](#) [B3W 1000G](#) [B3F 1002C](#) [B3F 0047H](#) [B3W 1002C](#) [B3F 5001G](#) [B3W 1100C](#) [1-](#)  
[1571563-4](#)