

P.C.B LAYOUT
BOTTOM VIEW

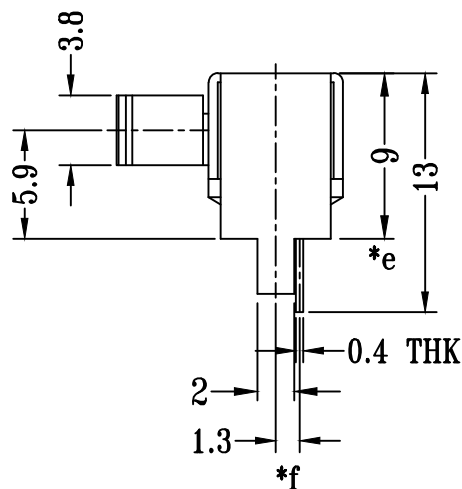
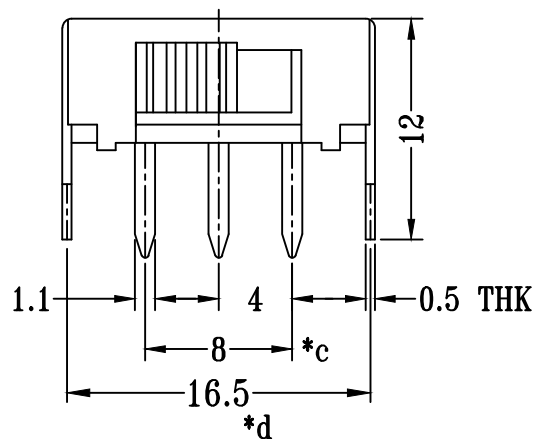

SK-22F02-GXXX

横柄

G-Switch P/N

Switch Height (mm)

G020=2.0 G030=3.0
G040=4.0 G050=5.0
G055=5.5 G060=6.0
G065=6.5 G070=7.0
G075=7.5 G080=8.0
G085=8.5 G090=9.0
G095=9.5 G100=10.0

G-Switch Specification:

Electrical Specifications: 1.0A/DC24V
Contact resistance (CR): $\leq 50\text{m}\Omega$
Insulation Resistance(IR): $\geq 100\text{M}\Omega$ DC250V
Compressive strength (WV): AC250V 1minute
Operating temperature: $-25^{\circ}\text{C}\sim+70^{\circ}\text{C}$
Storage humidity: $<85\%\text{RH}$
Electrical life: 10,000Cycles.

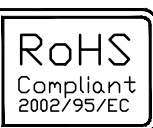
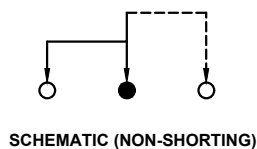

Unless otherwise
specified, Tolerance:
X. ± 0.30
X.x ± 0.20
X.xx ± 0.15
X.xxx ± 0.10
Angles $\pm 3^{\circ}$

G-Switch Electronic (HongKong) CO.,Ltd.

DESIGN FengFengChen	DATE 2019.05.29	Molde code:	
CHECKED	DATE	SK-22F02-GXXX	
APPROVED	DATE		
http://www.dg-switch.com		REV.: X1	SCALE: 4:1
TEL:0769-82388879		SIZE: A4	SHEET: 1/1

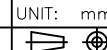

X-ON Electronics

Largest Supplier of Electrical and Electronic Components

Click to view similar products for [Slide Switches](#) category:

Click to view products by [G-Switch](#) manufacturer:

Other Similar products are found below :

[6-1437581-1](#) [M43R](#) [MHS123K15D](#) [MHS133K](#) [MMD](#) [MSS12A](#) [1825074-1](#) [1825160-3](#) [1825167-2](#) [1825289-7](#) [K232CB](#) [25139NLDB](#)
[25449NAH](#) [1825078-1](#) [1825080-4](#) [1825269-1](#) [1825270-2](#) [STS141RA04](#) [T2215BEN506](#) [GH46P000001](#) [GH49P010001](#) [25339NA](#)
[25436NLDH](#) [M42A](#) [AYZ0202AG](#) [L203091MS02Q](#) [4-1437581-7](#) [48BFSP3M2QT](#) [1101M1S3ZB8E2](#) [1-1437581-1](#)
[EG1218REDACTUATOR](#) [MSS2225G04](#) [MSS42G](#) [T105S1CWZBE](#) [SLB124145](#) [SLB1280R5](#) [TG39W000050](#) [25149NAH](#) [25439NAH](#)
[25436NAH6](#) [TG36Y000050](#) [NK236X693](#) [SL-1211C1B8](#) [46204LRX](#) [1977143-4](#) [1977144-4](#) [1977145-4](#) [HASS0194](#) [JS0001](#) [SSJ12R04](#)