



Product Features:

- 10BASE-T Ethernet RJ45
- IEEE802.3i Compliant
- 100% Compliance Testing
- 1500Vrms Hi-Pot
- Proprietary Robust Contact Design
- 30µ" Gold Plating on Contacts

Part Number (0 to 70°C)	Footprint	LED's (L/R)	Turns Ratio (± 3%)		Return Loss 5-10MHz	OCL (100kHz, 0.1Vrms)		Crosstalk (0.1-10MHz)
			TX	RX		TX	RX	
HFJ11-1041HRL	A	None	1CT:2.5	1CT:1	-15dB	35µH	200µH	-40dB
HFJ11-1041ERL ¹	B	None	1CT:2.5	1CT:1	-15dB	35µH	200µH	-40dB
HFJ11-1041E-L11RL	C	G/G	1CT:2.5	1CT:1	-15dB	35µH	200µH	-40dB
HFJ11-1041E-L12RL	C	G/Y	1CT:2.5	1CT:1	-15dB	35µH	200µH	-40dB
HFJ11-1041E-L21RL	C	Y/G	1CT:2.5	1CT:1	-15dB	35µH	200µH	-40dB
HFJ11-1043HRL	A	None	1CT:1.41	1CT:1	-15dB	140µH	140µH	-40dB
HFJ11-1043ERL ¹	B	None	1CT:1.41	1CT:1	-15dB	140µH	140µH	-40dB
HFJ11-1043E-L11RL	C	G/G	1CT:1.41	1CT:1	-15dB	140µH	140µH	-40dB
HFJ11-1043E-L12RL	C	G/Y	1CT:1.41	1CT:1	-15dB	140µH	140µH	-40dB
HFJ11-1043E-L21RL	C	Y/G	1CT:1.41	1CT:1	-15dB	140µH	140µH	-40dB
HFJ11-1075HRL	A	None	1CT:2	1CT:1	-15dB	25µH	140µH	-40dB
HFJ11-1075ERL ¹	B	None	1CT:2	1CT:1	-15dB	25µH	140µH	-40dB
HFJ11-1075E-L11RL	C	G/G	1CT:2	1CT:1	-15dB	25µH	140µH	-40dB
HFJ11-1075E-L12RL	C	G/Y	1CT:2	1CT:1	-15dB	25µH	140µH	-40dB
HFJ11-1075E-L21RL	C	Y/G	1CT:2	1CT:1	-15dB	25µH	140µH	-40dB
HFJ11-1081HRL	A	None	1CT:1	1CT:1	-15dB	100µH	100µH	-40dB
HFJ11-1081ERL ¹	B	None	1CT:1	1CT:1	-15dB	100µH	100µH	-40dB
HFJ11-1081E-L11RL	C	G/G	1CT:1	1CT:1	-15dB	100µH	100µH	-40dB
HFJ11-1081E-L12RL	C	G/Y	1CT:1	1CT:1	-15dB	100µH	100µH	-40dB
HFJ11-1081E-L21RL	C	Y/G	1CT:1	1CT:1	-15dB	100µH	100µH	-40dB

Notes:

1. Not recommended for new designs.
2. LED Key : G = Green, Y = Yellow
3. Other LED colors, bi-colors, polarities, and current limiting versions available
4. Tab-Up and extended temperature available
5. Lightning strike and power line cross circuit protection versions available
6. 1x2 and 1x4 ganged Fastjacks available
7. Additional turns ratios available

HALO 10BASE-T Ethernet Family of FastJacks

Circuit

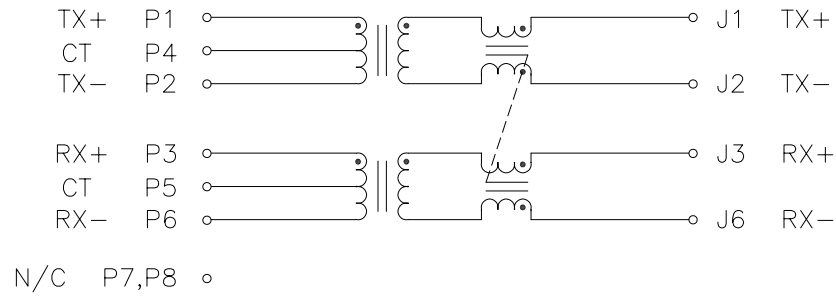

Mechanical

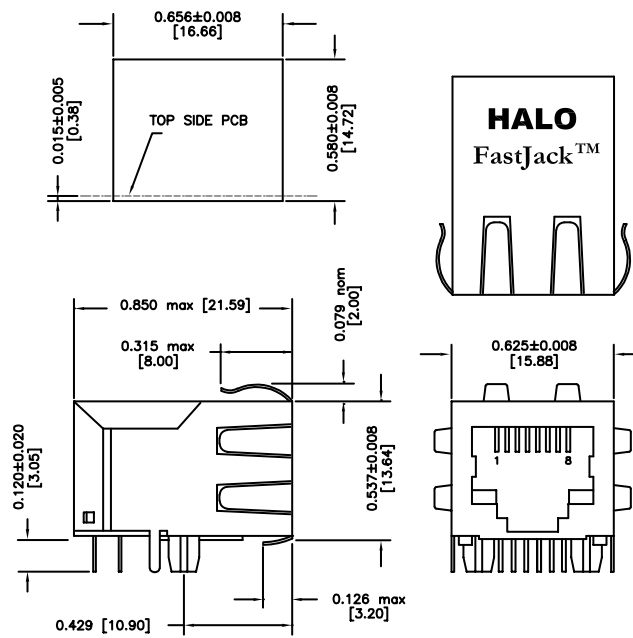

Dimensions are in inches [mm]

HALO 10BASE-T Ethernet Family of FastJacks

Footprint A

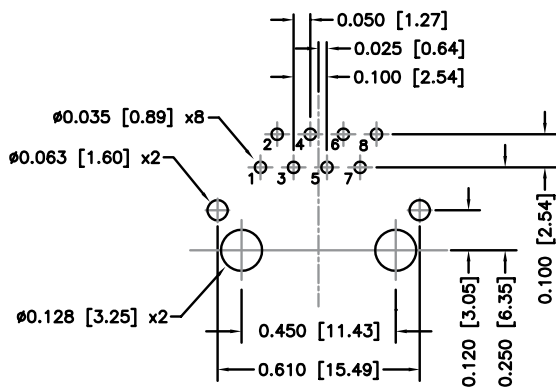

Footprint B

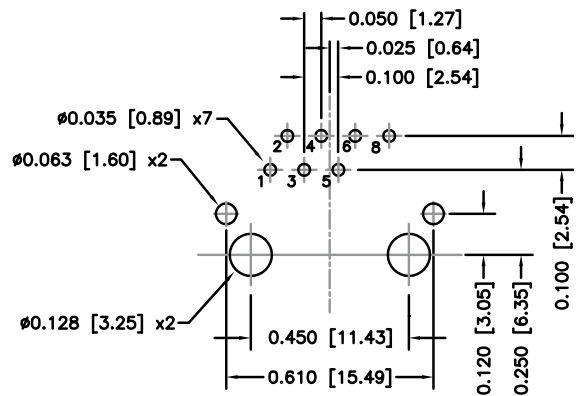

Footprint C

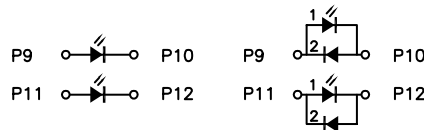
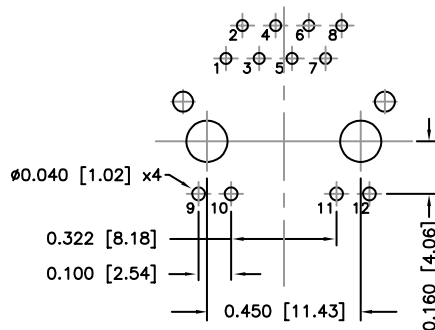

Recommended PCB Layout (Component Side)

Dimensions are in inches [mm]



2880 Lakeside Drive #116
Santa Clara, CA 95054
(650) 903-3800

www.haloelectronics.com

HALO® Electronics is a leading supplier of high quality communication magnetics including signal transformers, filters, CMR chokes, PoE power transformers, DC/DC converters, and integrated Ethernet connectors. HALO's leading edge technology solutions are manufactured in ISO9001 and ISO14001 factories offering high quality products at a competitive price.

© Copyright 2017 HALO Electronics, Inc. All rights reserved.

Revised 11/2017 Download the latest version at www.haloelectronics.com/pdf/fastjack-10baset.pdf

X-ON Electronics

Largest Supplier of Electrical and Electronic Components

Click to view similar products for [Modular Connectors / Ethernet Connectors](#) category:

Click to view products by [Hakko](#) manufacturer:

Other Similar products are found below :

[8949-H88/06BLKA/SN](#) [74441-0010/BKN](#) [MP1010RX-1000](#) [MP44RX-1000](#) [PHJ-4P4C-1-V-4](#) [PHP-6P6C-5](#) [GAX-3-66](#) [GAX-8-62](#) [GDCX-PA-66-50](#) [GDCX-PN-64](#) [GDCX-PN-66](#) [GDCX-PN-66-50](#) [GDLX-A-66](#) [GDLX-N-66](#) [GDLX-S-66](#) [GDLX-S-88K](#) [GDLX-SMT-S-88](#) [GDTX-S-88-50](#) [GDX-PA-1010](#) [GLX-N-1010M-BLK](#) [GLX-S-88M-BLK](#) [GMX-N-1010](#) [GMX-S-1010](#) [GMX-S-66](#) [GMX-SMT4-N-88](#) [GPX-2-64](#) [GSGX-N-2-88](#) [GSGX-N-4-88](#) [GSX-NS2-88-3.05](#) [GSX-NS2-88-3.05-50](#) [GSX-NS-88-3.05-50](#) [PT-108A-8C-UL](#) [PT-J951-8C](#) [PTS-J531-8CS-50UL](#) [1-1775629-2](#) [A-2014-0-4](#) [GWLX-S-88-GR](#) [GWLX-S9-88-YG](#) [DC-1021-8-WH-6](#) [1300530003](#) [1324640-4](#) [RJ11FTVC2G](#) [RJ11FTVC2N](#) [RJFTVX2SA1G](#) [132764-001](#) [1413235](#) [MP88X-1000](#) [MPS88RX-5000](#) [E5288-S000K3-L](#) [E5908-15A242-L](#)