



Quality Products. Service Excellence.

EMI/RFI Chokes 1539 Series

Features



- High saturation flux density ferrite bobbins.
- 1" long leads, tinned to within 1/8" of body.
- Ideal for filtering or energy storage inductors.
- Inductance measured at @ 1Khz. with 0 amps. D.C. current, typical inductance change is less than 5% @ twice rated current.

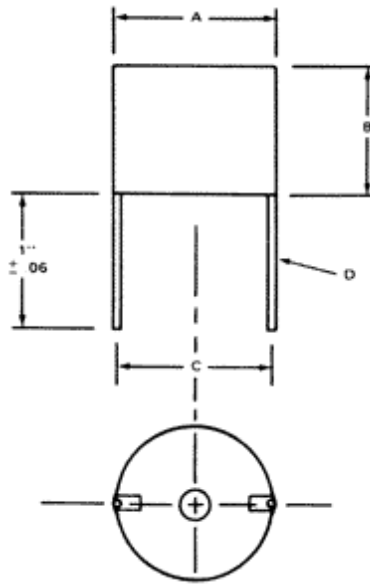

| Part No. | Inductance L uH +/- 10% | Fo Min MHz | R - D.C. Max Ohms | I - D.C. Max Amps | Maximum Dim. A | Maximum Dim. B | Typ. Dim. C | Typ. Dim. D |
|----------|----------------------------|---------------|----------------------|----------------------|-------------------|-------------------|----------------|----------------|
| 1539M01 | 5 | 24.7 | 0.007 | 15 | 0.83 | 0.91 | 0.59 | 0.07 |
| 1539M02 | 10 | 11.4 | 0.008 | 14 | 0.83 | 0.91 | 0.60 | 0.07 |
| 1539M03 | 25 | 6.2 | 0.023 | 8 | 0.83 | 0.91 | 0.57 | 0.04 |
| 1539M04 | 50 | 4.1 | 0.034 | 6.6 | 0.83 | 0.91 | 0.65 | 0.04 |
| 1539M05 | 100 | 2.4 | 0.072 | 4.5 | 0.83 | 0.91 | 0.69 | 0.04 |
| 1539M06 | 250 | 1.6 | 0.173 | 2.9 | 0.83 | 0.91 | 0.65 | 0.04 |
| 1539M07 | 500 | 1 | 0.378 | 2 | 0.83 | 0.91 | 0.68 | 0.04 |
| 1539M08 | 1000 | 0.7 | 0.801 | 1.3 | 0.83 | 0.91 | 0.66 | 0.04 |
| 1539M09 | 2500 | 0.43 | 2.04 | 0.85 | 0.83 | 0.91 | 0.71 | 0.04 |
| 1539M10 | 5 | 26.7 | 0.005 | 20 | 1.22 | 1.11 | 0.94 | 0.08 |
| 1539M11 | 10 | 15.6 | 0.006 | 17 | 1.22 | 1.11 | 0.95 | 0.08 |
| 1539M12 | 25 | 5.2 | 0.009 | 14 | 1.22 | 1.11 | 0.93 | 0.08 |
| 1539M13 | 50 | 3.6 | 0.017 | 10 | 1.22 | 1.11 | 0.99 | 0.07 |
| 1539M14 | 100 | 2.2 | 0.034 | 7 | 1.22 | 1.11 | 0.85 | 0.05 |
| 1539M15 | 250 | 1.2 | 0.083 | 4.6 | 1.22 | 1.11 | 0.97 | 0.05 |
| 1539M16 | 500 | 0.89 | 0.129 | 3.7 | 1.22 | 1.11 | 1.12 | 0.05 |
| 1539M17 | 1000 | 0.58 | 0.279 | 2.5 | 1.22 | 1.11 | 1.05 | 0.05 |
| 1539M18 | 2500 | 0.35 | 0.69 | 1.6 | 1.22 | 1.11 | 1.05 | 0.05 |

| Part No. | Inductance L uH +/- 10% | Fo Min MHz | R - D.C. Max Ohms | I - D.C. Max Amps | Maximum Dim. A | Maximum Dim. B | Typ. Dim. C | Typ. Dim. D |
|----------|----------------------------|---------------|----------------------|----------------------|-------------------|-------------------|----------------|----------------|
| 1539M19 | 50 | 3.4 | 0.012 | 14 | 1.50 | 1.11 | 1.23 | 0.08 |
| 1539M20 | 100 | 2 | 0.025 | 9.8 | 1.50 | 1.11 | 1.12 | 0.07 |
| 1539M21 | 250 | 1.3 | 0.059 | 6.4 | 1.50 | 1.11 | 1.10 | 0.05 |
| 1539M22 | 500 | 0.9 | 0.09 | 5 | 1.50 | 1.11 | 1.14 | 0.05 |
| 1539M23 | 1000 | 0.54 | 0.195 | 3.5 | 1.50 | 1.11 | 1.36 | 0.05 |
| 1539M24 | 2500 | 0.34 | 0.499 | 2.2 | 1.50 | 1.11 | 1.32 | 0.05 |
| 1539M25 | 5000 | 0.24 | 1.08 | 1.5 | 1.50 | 1.11 | 1.27 | 0.05 |
| 1539M26 | 100 | 1.8 | 0.018 | 14 | 1.50 | 1.50 | 1.18 | 0.08 |
| 1539M27 | 250 | 1 | 0.04 | 9 | 1.50 | 1.50 | 1.12 | 0.07 |
| 1539M28 | 500 | 0.7 | 0.085 | 6.5 | 1.50 | 1.50 | 1.06 | 0.05 |
| 1539M29 | 1000 | 0.44 | 0.183 | 4.4 | 1.50 | 1.50 | 1.23 | 0.05 |
| 1539M30 | 2500 | 0.26 | 0.464 | 2.8 | 1.50 | 1.50 | 1.21 | 0.05 |
| 1539M31 | 5000 | 0.19 | 0.714 | 2.2 | 1.50 | 1.50 | 1.32 | 0.05 |
| 1539M32 | 10000 | 0.13 | 1.55 | 1.5 | 1.50 | 1.50 | 1.25 | 0.05 |

Data subject to change without notice

© 2021. Hammond Manufacturing Ltd. All rights reserved.

X-ON Electronics

Largest Supplier of Electrical and Electronic Components

Click to view similar products for [Fixed Inductors](#) category:

Click to view products by [Hammond](#) manufacturer:

Other Similar products are found below :

[MLZ1608M6R8WTD25](#) [MLZ1608N6R8LT000](#) [MLZ1608N3R3LTD25](#) [MLZ1608N3R3LT000](#) [MLZ1608N150LT000](#)
[MLZ1608M150WTD25](#) [MLZ1608M3R3WTD25](#) [MLZ1608M3R3WT000](#) [MLZ1608M150WT000](#) [MLZ1608A1R5WT000](#)
[MLZ1608N1R5LT000](#) [PCMB053T-1R0MS](#) [PCMB053T-1R5MS](#) [PCMB104T-1R5MS](#) [CR32NP-100KC](#) [CR32NP-151KC](#) [CR32NP-180KC](#)
[CR32NP-181KC](#) [CR32NP-1R5MC](#) [CR32NP-390KC](#) [CR32NP-3R9MC](#) [CR32NP-680KC](#) [CR32NP-820KC](#) [CR32NP-8R2MC](#) [CR43NP-](#)
[390KC](#) [CR43NP-560KC](#) [CR43NP-680KC](#) [CR54NP-181KC](#) [CR54NP-470LC](#) [CR54NP-820KC](#) [CR54NP-8R5MC](#) [MGDQ4-00004-P](#)
[MGDU1-00016-P](#) [MHL1ECTTP18NJ](#) [MHL1JCTTD12NJ](#) [PE-51506NL](#) [PE-53601NL](#) [PE-53630NL](#) [PE-53824SNLT](#) [PE-92100NL](#)
[PG0434.801NLT](#) [PG0936.113NLT](#) [PM06-2N7](#) [PM06-39NJ](#) [HC2LP-R47-R](#) [HC3-2R2-R](#) [HC3-R50-R](#) [HC8-1R2-R](#) [HCF1305-3R3-R](#)
[1248AS-H-6R8N=P3](#)