



Quality Products. Service Excellence.

Eclipse DIN Rails *DR Series*



- Field installable.
- Includes a set of 3 plated rails.
- Available in 3 industry standard profiles - DIN 1, DIN 3, and CENELEC.
- **DIN rail mounting kit** required for installation.
- Rails have an oblong slot on each end for ease of mounting.
- Zinc plated.

Accessories

- Eclipse DIN Rail Mounting Kit

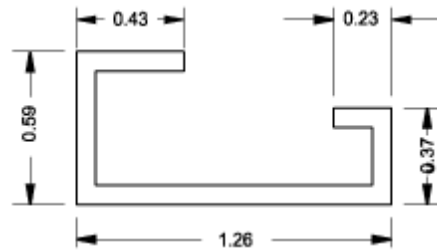

Asymmetric DIN 1 Pro

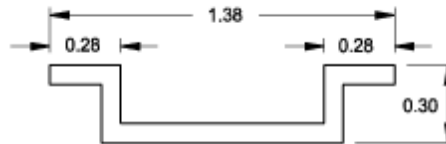

Symmetric DIN 3 Pro

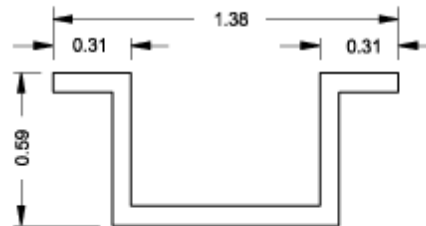

CENELEC Pro

Asymmetric DIN 1 Profile	Symmetric DIN 3 Profile	Cenelec Profile	Length
Part No.	Part No.	Part No.	
2D1K12	2D2K12	2DCK12	9.75
2D1K16	2D2K16	2DCK16	13.75
2D1K20	2D2K20	2DCK20	17.75
2D1K24	2D2K24	2DCK24	21.75
2D1K30	2D2K30	2DCK30	27.75

Data subject to change without notice

© 2022. Hammond Manufacturing Ltd. All rights reserved.

X-ON Electronics

Largest Supplier of Electrical and Electronic Components

Click to view similar products for [Mounting Fixings](#) category:

Click to view products by [Hammond](#) manufacturer:

Other Similar products are found below :

[71-074914-006](#) [71-215091-8S](#) [71-344699-4S](#) [71-441549-19S](#) [75-69211-3P](#) [75-69214-6P](#) [75-69220-27S](#) [75-69224-28P](#) [75-69232-17S](#) [7717-8DAP](#) [85043GULPR](#) [85047GULPT](#) [PMS27488-001-01](#) [1-18023-0](#) [H-118-2](#) [D83999/20WC8SN](#) [1301790551](#) [1302010957](#) [1302263564](#) [1302340393](#) [1404-0016-78](#) [1561-60](#) [BR16A](#) [HS5659MB98PN](#) [NT20SATT01](#) [20800000003](#) [22594-8](#) [89078GBEPR](#) [89078GBESR](#) [SF4011-60101](#) [1671](#) [1855-54](#) [21899-4](#) [2193](#) [2518](#) [H-118-1](#) [D38899/26WJ4BN](#) [BACC47CN2S](#) [HS5659MB35PN](#) [HS5659MB35SN](#) [HS5659MB98SN](#) [LF9Z-1SB22](#) [WMLX-109](#) [364202K01V167](#) [MS05CW-16-8PN-SIL](#) [MS05CW-20-16PN-SIL](#) [ELXA051G1](#) [2547](#) [1453315-11](#) [71-146608-2P](#)