

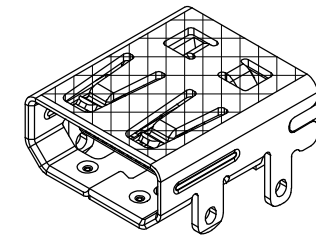

REV.	ECN NO OR DESCRIPTION	REVISED	DATE

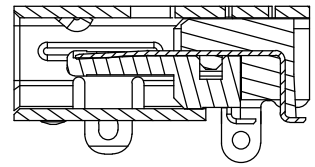
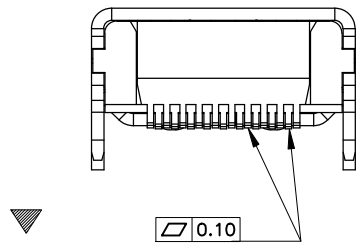
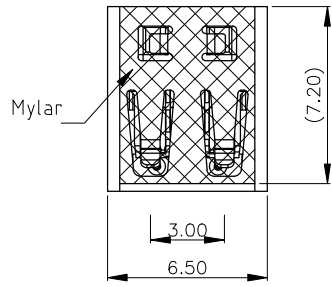

(SHELL & TERMINAL)

- NOTES:
- RATING CURRENT: 0.3A Min.
 - RATING VOLTAGE: 40VAC
 - CONTACT RESISTANCE: 10mΩ Max.
(EXCLUDING CONDUCTOR RESISTANCE)
 - INSULATION RESISTANCE:
 - UNMATED: 100MΩ Min AT 500 VDC.
 - MATED: 10MΩ Min AT 150 VDC.
 - DIELECTRIC WITHSTANDING VOLTAGE:
 - UNMATED: 250VAC FOR 60s.
 - MATED: 150VAC FOR 60s.
 - INSERTION FORCE: 4.4.1N Max.
 - WITHDRAWAL FORCE:
 - 5N Min.(AFTER 5000 CYCLES 3N Min.), 25N Max.
 - DURABILITY: 5000 CYCLES
 - OPERATING TEMPERATURE: -20°C~+85°C
 - STORAGE TEMPERATURE: -20°C~+65°C

PIN	Signal Assignment	PIN	Signal Assignment
1	Hot Plug Detect	2	Utility
3	TMDS Data2+	4	TMDS Data2 Shield
5	TMDS Data2-	6	TMDS Data1+
7	TMDS Data1 Shield	8	TMDS Data1-
9	TMDS Data0+	10	TMDS Data0 Shield
11	TMDS Data0-	12	TMDS Clock+
13	TMDS Clock Shield	14	TMDS Clock-
15	CEC	16	DDC/CEC Ground
17	SCL	18	SDA
19	+5V Power		

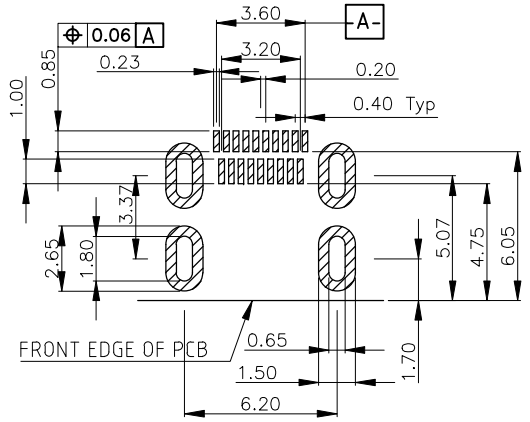
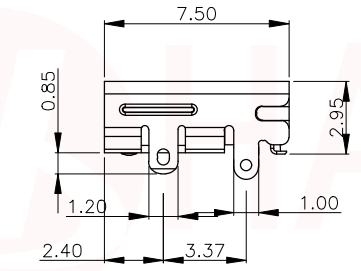
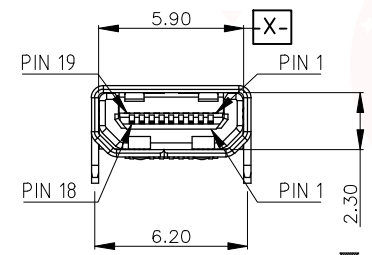

RECOMMENDED PCB LAYOUT
TOP VIEW (TOL=±0.05)

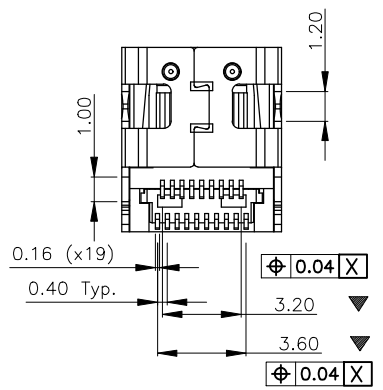

NO.	PART NAME	Q'TY	DWG NO.	PART NO.	MATERIAL	FINISHED
3	SHELL	1			BRASS C2680R-H T=0.30mm	80u" Nickel OVER 80u" Copper
2	INSULATOR	1			LCP, BLACK	/
1	TERMINAL	19			BRASS C2680R-H T=0.12mm	Selected Au OVER 50u" Nickel

UNLESS OTHERWISE SPECIFIED TOLERANCES

DECIMALS: X ±0.20 X.X ±0.10 X.XX ±0.05

ANGLES: X ±2° X.X ±1°

TITLE: HDMI D TYPE SMT NORMAL

DWN xiong PART NO. HDMI-214

CHKD lee SCALE:1:1 UNIT: mm

APVD wang SIZE: A4 SHEET:10F 1 REV: A4

CUSTOMER COPY

东莞市汉博电子科技有限公司
DONGGUAN HANBO TECHNOLOGY CO., LTD

X-ON Electronics

Largest Supplier of Electrical and Electronic Components

Click to view similar products for [HDMI, Displayport & DVI Connectors](#) category:

Click to view products by [Hanbo Electronic](#) manufacturer:

Other Similar products are found below :

[30-1231](#) [30-528](#) [30-504](#) [30-519](#) [33DVIR-24S1B](#) [47648-2000](#) [2002-400](#) [TC142X](#) [769-103/021-000](#) [1932649-1](#) [CP30200GM3](#) [67881](#)
[HAFBF](#) [HBLBH](#) [HBLBI](#) [HAFBG](#) [HAFBH](#) [HAGBF](#) [HAGBG](#) [HAGBI](#) [HAGBJ](#) [HBLBJ](#) [AABIE](#) [AABIF](#) [AABIG](#) [AABIH](#) [AABII](#) [AABIJ](#)
[AABIK](#) [AABIL](#) [AACBE](#) [AACBF](#) [AACBG](#) [ABIBF](#) [ABIBG](#) [ABIBH](#) [42154](#) [AACBH](#) [AACBI](#) [AACBJ](#) [AACBK](#) [AACBL](#) [AAIBD](#) [AAIBF](#)
[AAIBH](#) [AAIBI](#) [AANBF](#) [AANBG](#) [AANBH](#) [AANBI](#)