

* 所有原材料质, 生产制程, 电镀必须符合ROHS要求

Specification

MATERIAL:

Insulator: High Temperature Thermoplastic,
UL 94V-0.

PLATING:

Contact: Plated 50u" Ni Overall
Plated Au Selective Contact Area
Plated 100u" Sn Over Ni On Solder Area
Shell: Plated 50u" Ni Overall
Plated 1u" Au Over Ni On Solder Area

Electrical:

Current Rating :0.5mA AC/DC max.
Voltage Rating :125V AC/DC
Ambient Temperature Range : -20°C~+60°C
Storage Temperature Range : -40°C~+70°C
Ambient Humidity Range :95% R.H. Max.
Contact Resistance:100mΩ max.
Insulation Resistance:1000MΩ min./500VDC
Mating Cycles:10,000 Insertions
Usable Memory Card:
SD&MMC Card

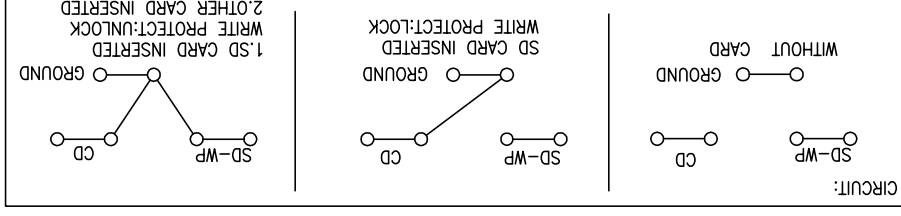
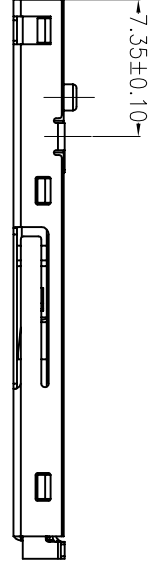
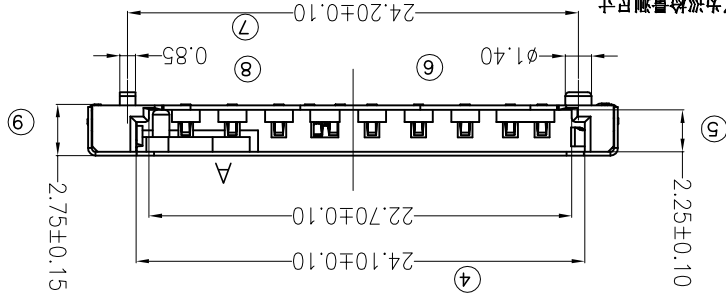
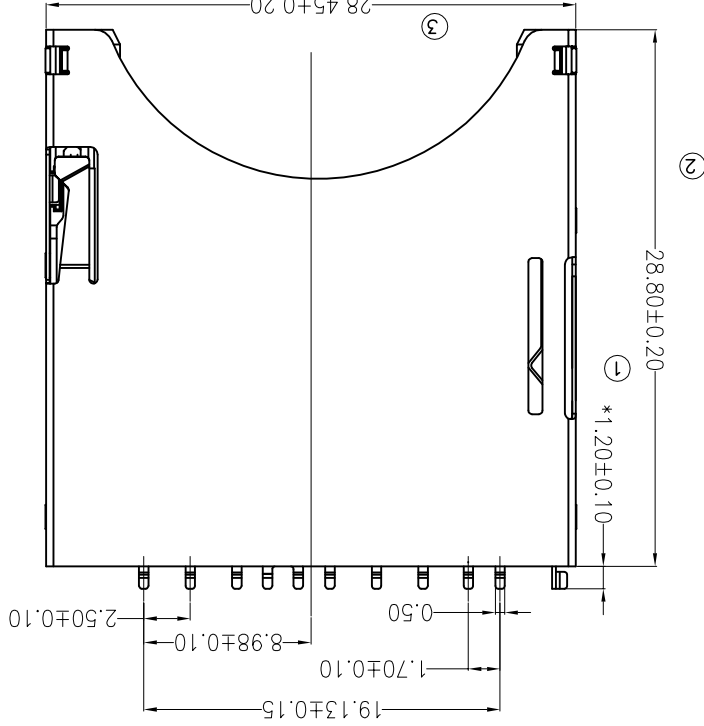
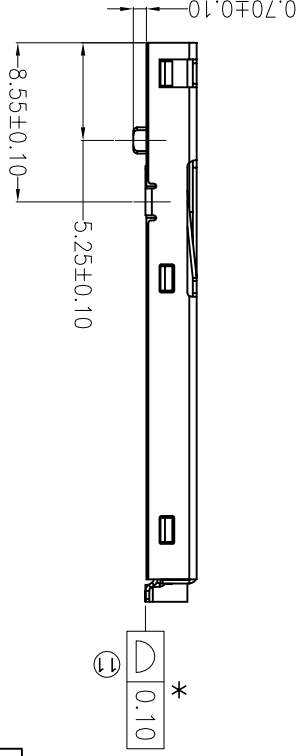

备注:加ⓧ 所示尺寸为首件量测尺寸加*为巡检量测尺寸



东莞市汉博电子科技有限公司
Dongguan Hanbo Electronic Technology Co., Ltd

DIMENSIONS INT: mm
UNLESS OTHERWISE SPECIFIABLE
TOLERANCE

ANGULAR: ±
X.XX: ±
X.XXX: ±
X: ±

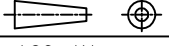

NT-001

DRAWING NO. : NT-001

PRODUCT NO. : SD-111

SD push-push

DRAWING:

COCO

DATE:

2008/12/10

CHECK:

JANY

DATE:

2008/12/10

APPROVED:

JEFF

DATE:

2008/12/10

SCALE:

1:1

REV.:

A

PAGE:

1 of 3

F

E

D

C

B

A

X-ON Electronics

Largest Supplier of Electrical and Electronic Components

Click to view similar products for [Standard Card Edge Connectors](#) *category:*

Click to view products by [Hanbo Electronic](#) *manufacturer:*

Other Similar products are found below :

[6565204-6](#) [PKC-156](#) [1437274-4](#) [147889-1](#) [1489165-4](#) [EBT156-12B1X](#) [EBT15622B2X](#) [EBT156-22R2W](#) [1-582587-1](#) [1-582589-1](#) [2-6437275-9](#) [284-0102-12100](#) [306022901000000](#) [307-012-502-202](#) [307-024-526-201](#) [307-056-520-300](#) [307-080-526-208](#) [1926088-2](#) [245-062-520-350](#) [287-0032-12101](#) [306-010-500-112](#) [306-028-525-102](#) [306-240-318](#) [307-036-502-202](#) [307-036-521-301](#) [307-072-526-202](#) [345-060-559-303](#) [368-004-520-201](#) [392-008-559-201](#) [534671-1](#) [5-530501-5](#) [341-240-317](#) [345-029-520-300](#) [345-030-500-301](#) [345-044-500-300](#) [345-220-058](#) [346-240-318](#) [357-030-526-201](#) [387-012-523-300](#) [395-044-520-300](#) [395-100-524-300](#) [50-12B-10](#) [50-6SN-5](#) [09-07-2032](#) [10035388-106LF](#) [10035388-802LF](#) [10115859-011LF](#) [10122859-009LF](#) [101269333204245CLF](#) [10127905-B04B24BLF](#)