

MATERIAL: Insulator High Temperature Thermoplastic, UL94V-0

CONTACT COPPER ALLOY  
SHELL : SUS

PLATING: Contact Plated 50u Ni over all Contact Au IU  
Shield plated 50u Ni overall  
Plated In Au Selective Contact Area

ELECTRICAL:

Current Rating: 0.5A  
Voltage Rating: 30V AC/DC  
Ambient Temperature Range: -20 °C +60 °C  
Storage Temperature Range: -40 °C +95 °C  
Ambient Humidity Range : 95% R.H. Max.

Contact Resistance: 100mΩ max.

Insulation Resistance: 1000MΩ min./500VDC

产品耐温温度: 260 °C.

Mating Cycles : 1500min Insertions

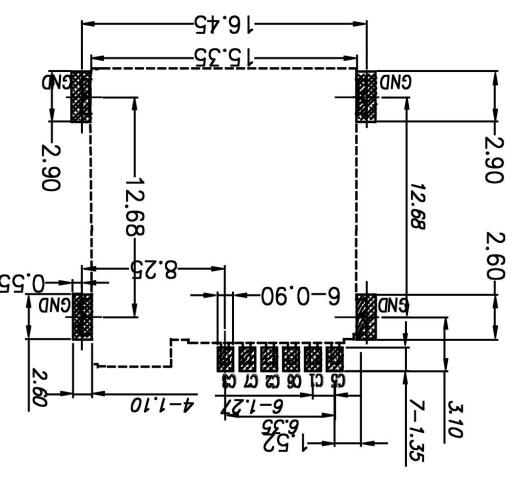
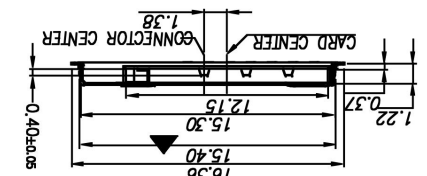
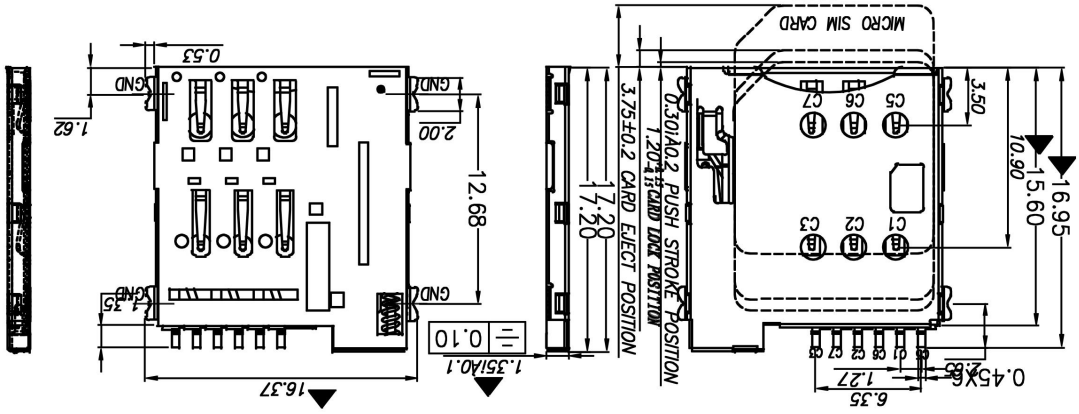

RECOMMENDED PCB LAYOUT  
GENERAL TOLERANCE F0 05

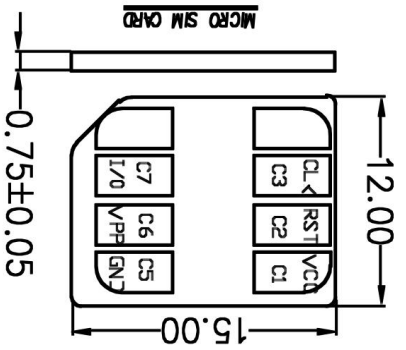

General	Angle	X±2°	DESIGN	设计	14'/05/22	Brick	Jack he	14'/05/22	SCALE 1:1	UNIT:mm	A4	SHEET:1 of 1
General	X±0.50	X±1°	CHECK	校閱	14'/05/22	Brick	Jack he	14'/05/22	FILE NAME:			
General	X±0.30	.XX±0.5°	APPRO.	承認					PRODUCT SPEC.	MICRO SIM CARD		
General	.XX±0.20								PART NO.	SIM-200-P6		
General	UNLESS OTHERWISE NOTED								TITLE:	MICRO SIM CARD		

东莞市汉博电子科技有限公司

## X-ON Electronics

Largest Supplier of Electrical and Electronic Components

*Click to view similar products for [Standard Card Edge Connectors](#) category:*

*Click to view products by [Hanbo Electronic](#) manufacturer:*

Other Similar products are found below :

[6565204-6](#) [PKC-156](#) [1437274-4](#) [147889-1](#) [1489165-4](#) [EBT156-12B1X](#) [EBT15622B2X](#) [EBT156-22R2W](#) [1-582587-1](#) [1-582589-1](#) [2-6437275-9](#) [284-0102-12100](#) [306022901000000](#) [307-012-502-202](#) [307-024-526-201](#) [307-056-520-300](#) [307-080-526-208](#) [1926088-2](#) [245-062-520-350](#) [287-0032-12101](#) [306-010-500-112](#) [306-028-525-102](#) [306-240-318](#) [307-036-502-202](#) [307-036-521-301](#) [307-072-526-202](#) [345-060-559-303](#) [368-004-520-201](#) [392-008-559-201](#) [534671-1](#) [5-530501-5](#) [341-240-317](#) [345-029-520-300](#) [345-030-500-301](#) [345-044-500-300](#) [345-220-058](#) [346-240-318](#) [357-030-526-201](#) [387-012-523-300](#) [395-044-520-300](#) [395-100-524-300](#) [50-12B-10](#) [50-6SN-5](#) [09-07-2032](#) [10035388-106LF](#) [10035388-802LF](#) [10115859-011LF](#) [10122859-009LF](#) [101269333204245CLF](#) [10127905-B04B24BLF](#)