

| Coding style table | |
|--------------------|--|
| | Style A: For connector 6 poles |
| | Style B: For connectors 10 and 14 poles |
| | Style C: For connectors from 16 to 64 poles |

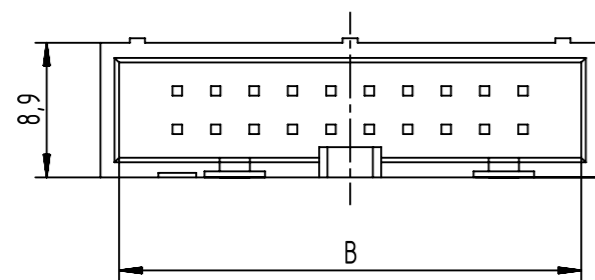

Find further technical information on drawing DS 09191130202

| | | | | | | | |
|--|---|---|---------------------------|---|--------------------|------------------------|--------------|
| | All rights reserved Department EC PD - FR | Created by DOUGE | Inspected by BAGDIKIAN | Standardisation HOFFMANN | Date 2013-11-04 | State Final Release | Ref. Sub. |
| | HARTING Electronics GmbH D-32339 Espelkamp | Title SEK 19 male straight low profile | | Doc-Key / ECM-Nr. 100541602/UGD/001/B 50000066836 | | Rev. B | Page 1/2 |
| All Dimensions in mm Original Size DIN A3 | | Scale 2:1 | Free size tol. | | | | |
| | | Type TB | Number 09195XXX32X | | | | |

| A | Performance Level | | | | | | | Dimensions (mm) | | | | | | | | |
|----|--|---|---|--------------------|-------------------------------|-----------|--------------------------|--------------------------|-------------------|-------|-------------------|--------------------------|-----------------|------|-------|------------------|
| | PL3 : 50 mating Cycles No Gas Test | PL2 : 250 mating Cycles 4 days Gas Test | S4 : 0,76µm Au or equivalent PdNi | Insulator Color | Contact Length ±0.3(mm) | Packaging | Accessory | A Max | B | E | | | | | | |
| | Nb of Contacts | Part Number | Part Number | Part Number | | | | | | | | | | | | |
| B | 06 | 0919 506 7324 | 0919 506 6324 | 0919 506 5324 | Beige | 2.9mm | Standard (Carton Box) | - | 15,4 | 12,78 | 2,54 x 2 = 5,08 | | | | | |
| | 10 | 0919 510 7324 | 0919 510 6324 | 0919 510 5324 | | | | | 20,5 | 17,86 | 2,54 x 4 = 10,16 | | | | | |
| | 14 | 0919 514 7324 | 0919 514 6324 | 0919 514 5324 | | | | | 25,6 | 22,94 | 2,54 x 6 = 15,24 | | | | | |
| | 16 | 0919 516 7324 | 0919 516 6324 | 0919 516 5324 | | | | | 28,1 | 25,48 | 2,54 x 7 = 17,78 | | | | | |
| | 20 | 0919 520 7324 | 0919 520 6324 | 0919 520 5324 | | | | | 33,2 | 30,56 | 2,54 x 9 = 22,86 | | | | | |
| | 26 | 0919 526 7324 | 0919 526 6324 | 0919 526 5324 | | | | | 40,8 | 38,18 | 2,54 x 12 = 30,48 | | | | | |
| | 30 | 0919 530 7324 | 0919 530 6324 | 0919 530 5324 | | | | | 45,9 | 43,26 | 2,54 x 14 = 35,56 | | | | | |
| | 34 | 0919 534 7324 | 0919 534 6324 | 0919 534 5324 | | | | | 51,0 | 48,34 | 2,54 x 16 = 40,64 | | | | | |
| | 40 | 0919 540 7324 | 0919 540 6324 | 0919 540 5324 | | | | | 58,6 | 55,96 | 2,54 x 19 = 48,26 | | | | | |
| | 50 | 0919 550 7324 | 0919 550 6324 | 0919 550 5324 | | | | | 71,5 | 68,66 | 2,54 x 24 = 60,96 | | | | | |
| | 60 | 0919 560 7324 | 0919 560 6324 | 0919 560 5324 | | | | | 84,2 | 81,36 | 2,54 x 29 = 73,66 | | | | | |
| | 64 | 0919 564 7324 | 0919 564 6324 | 0919 564 5324 | | | | | 89,3 | 86,44 | 2,54 x 31 = 78,74 | | | | | |
| | C | 06 | 0919 506 7324 001 | 0919 506 6324 001 | | | | | 0919 506 5324 001 | Black | 2.9mm | Standard (Carton Box) | - | 15,4 | 12,78 | 2,54 x 2 = 5,08 |
| | | 10 | 0919 510 7324 001 | 0919 510 6324 001 | | | | | 0919 510 5324 001 | | | | | 20,5 | 17,86 | 2,54 x 4 = 10,16 |
| | | 14 | 0919 514 7324 001 | 0919 514 6324 001 | | | | | 0919 514 5324 001 | | | | | 25,6 | 22,94 | 2,54 x 6 = 15,24 |
| | | 16 | 0919 516 7324 001 | 0919 516 6324 001 | | | | | 0919 516 5324 001 | | | | | 28,1 | 25,48 | 2,54 x 7 = 17,78 |
| 20 | | 0919 520 7324 001 | 0919 520 6324 001 | 0919 520 5324 001 | 33,2 | 30,56 | 2,54 x 9 = 22,86 | | | | | | | | | |
| 26 | | 0919 526 7324 001 | 0919 526 6324 001 | 0919 526 5324 001 | 40,8 | 38,18 | 2,54 x 12 = 30,48 | | | | | | | | | |
| 30 | | 0919 530 7324 001 | 0919 530 6324 001 | 0919 530 5324 001 | 45,9 | 43,26 | 2,54 x 14 = 35,56 | | | | | | | | | |
| 34 | | 0919 534 7324 001 | 0919 534 6324 001 | 0919 534 5324 001 | 51,0 | 48,34 | 2,54 x 16 = 40,64 | | | | | | | | | |
| 40 | | 0919 540 7324 001 | 0919 540 6324 001 | 0919 540 5324 001 | 58,6 | 55,96 | 2,54 x 19 = 48,26 | | | | | | | | | |
| 50 | | 0919 550 7324 001 | 0919 550 6324 001 | 0919 550 5324 001 | 71,5 | 68,66 | 2,54 x 24 = 60,96 | | | | | | | | | |
| 60 | | 0919 560 7324 001 | 0919 560 6324 001 | 0919 560 5324 001 | 84,2 | 81,36 | 2,54 x 29 = 73,66 | | | | | | | | | |
| 64 | | 0919 564 7324 001 | 0919 564 6324 001 | 0919 564 5324 001 | 89,3 | 86,44 | 2,54 x 31 = 78,74 | | | | | | | | | |
| D | | 06 | 0919 506 7324 740 | 0919 506 6324 740 | 0919 506 5324 740 | Beige | 2.9mm | Tape & Reel | Vacuum Cover | | | | | 15,4 | 12,78 | 2,54 x 2 = 5,08 |
| | | 10 | 0919 510 7324 740 | 0919 510 6324 740 | 0919 510 5324 740 | | | | | | | | | 20,5 | 17,86 | 2,54 x 4 = 10,16 |
| | | 14 | 0919 514 7324 740 | 0919 514 6324 740 | 0919 514 5324 740 | | | | | | | | | 25,6 | 22,94 | 2,54 x 6 = 15,24 |
| | | 16 | 0919 516 7324 740 | 0919 516 6324 740 | 0919 516 5324 740 | | | | | | | | | 28,1 | 25,48 | 2,54 x 7 = 17,78 |
| | 20 | 0919 520 7324 740 | 0919 520 6324 740 | 0919 520 5324 740 | 33,2 | | | | | 30,56 | 2,54 x 9 = 22,86 | | | | | |
| | 26 | 0919 526 7324 740 | 0919 526 6324 740 | 0919 526 5324 740 | 40,8 | | | | | 38,18 | 2,54 x 12 = 30,48 | | | | | |
| | 30 | 0919 530 7324 740 | 0919 530 6324 740 | 0919 530 5324 740 | 45,9 | | | | | 43,26 | 2,54 x 14 = 35,56 | | | | | |
| | 34 | 0919 534 7324 740 | 0919 534 6324 740 | 0919 534 5324 740 | 51,0 | | | | | 48,34 | 2,54 x 16 = 40,64 | | | | | |
| | 40 | 0919 540 7324 740 | 0919 540 6324 740 | 0919 540 5324 740 | 58,6 | | | | | 55,96 | 2,54 x 19 = 48,26 | | | | | |
| | 50 | 0919 550 7324 740 | 0919 550 6324 740 | 0919 550 5324 740 | 71,5 | | | | | 68,66 | 2,54 x 24 = 60,96 | | | | | |
| | 60 | 0919 560 7324 740 | 0919 560 6324 740 | 0919 560 5324 740 | 84,2 | | | | | 81,36 | 2,54 x 29 = 73,66 | | | | | |
| | 64 | 0919 564 7324 740 | 0919 564 6324 740 | 0919 564 5324 740 | 89,3 | | | | | 86,44 | 2,54 x 31 = 78,74 | | | | | |
| | E | 06 | 0919 506 7324 741 | 0919 506 6324 741 | 0919 506 5324 741 | | | | | Black | 2.9mm | Tape & Reel | Vacuum Cover | 15,4 | 12,78 | 2,54 x 2 = 5,08 |
| | | 10 | 0919 510 7324 741 | 0919 510 6324 741 | 0919 510 5324 741 | | | | | | | | | 20,5 | 17,86 | 2,54 x 4 = 10,16 |
| | | 14 | 0919 514 7324 741 | 0919 514 6324 741 | 0919 514 5324 741 | | | | | | | | | 25,6 | 22,94 | 2,54 x 6 = 15,24 |
| | | 16 | 0919 516 7324 741 | 0919 516 6324 741 | 0919 516 5324 741 | | | | | | | | | 28,1 | 25,48 | 2,54 x 7 = 17,78 |
| 20 | | 0919 520 7324 741 | 0919 520 6324 741 | 0919 520 5324 741 | 33,2 | 30,56 | 2,54 x 9 = 22,86 | | | | | | | | | |
| 26 | | 0919 526 7324 741 | 0919 526 6324 741 | 0919 526 5324 741 | 40,8 | 38,18 | 2,54 x 12 = 30,48 | | | | | | | | | |
| 30 | | 0919 530 7324 741 | 0919 530 6324 741 | 0919 530 5324 741 | 45,9 | 43,26 | 2,54 x 14 = 35,56 | | | | | | | | | |
| 34 | | 0919 534 7324 741 | 0919 534 6324 741 | 0919 534 5324 741 | 51,0 | 48,34 | 2,54 x 16 = 40,64 | | | | | | | | | |
| 40 | | 0919 540 7324 741 | 0919 540 6324 741 | 0919 540 5324 741 | 58,6 | 55,96 | 2,54 x 19 = 48,26 | | | | | | | | | |
| 50 | | 0919 550 7324 741 | 0919 550 6324 741 | 0919 550 5324 741 | 71,5 | 68,66 | 2,54 x 24 = 60,96 | | | | | | | | | |
| 60 | | 0919 560 7324 741 | 0919 560 6324 741 | 0919 560 5324 741 | 84,2 | 81,36 | 2,54 x 29 = 73,66 | | | | | | | | | |
| 64 | | 0919 564 7324 741 | 0919 564 6324 741 | 0919 564 5324 741 | 89,3 | 86,44 | 2,54 x 31 = 78,74 | | | | | | | | | |
| F | | 06 | 0919 506 7322 | 0919 506 6322 | 0919 506 5322 | Beige | 4.5mm | Standard (Carton Box) | - | | | | | 15,4 | 12,78 | 2,54 x 2 = 5,08 |
| | | 10 | 0919 510 7322 | 0919 510 6322 | 0919 510 5322 | | | | | | | | | 20,5 | 17,86 | 2,54 x 4 = 10,16 |
| | | 14 | 0919 514 7322 | 0919 514 6322 | 0919 514 5322 | | | | | | | | | 25,6 | 22,94 | 2,54 x 6 = 15,24 |
| | | 16 | 0919 516 7322 | 0919 516 6322 | 0919 516 5322 | | | | | | | | | 28,1 | 25,48 | 2,54 x 7 = 17,78 |
| | 20 | 0919 520 7322 | 0919 520 6322 | 0919 520 5322 | 33,2 | | | | | 30,56 | 2,54 x 9 = 22,86 | | | | | |
| | 26 | 0919 526 7322 | 0919 526 6322 | 0919 526 5322 | 40,8 | | | | | 38,18 | 2,54 x 12 = 30,48 | | | | | |
| | 30 | 0919 530 7322 | 0919 530 6322 | 0919 530 5322 | 45,9 | | | | | 43,26 | 2,54 x 14 = 35,56 | | | | | |
| | 34 | 0919 534 7322 | 0919 534 6322 | 0919 534 5322 | 51,0 | | | | | 48,34 | 2,54 x 16 = 40,64 | | | | | |
| | 40 | 0919 540 7322 | 0919 540 6322 | 0919 540 5322 | 58,6 | | | | | 55,96 | 2,54 x 19 = 48,26 | | | | | |
| | 50 | 0919 550 7322 | 0919 550 6322 | 0919 550 5322 | 71,5 | | | | | 68,66 | 2,54 x 24 = 60,96 | | | | | |
| | 60 | 0919 560 7322 | 0919 560 6322 | 0919 560 5322 | 84,2 | | | | | 81,36 | 2,54 x 29 = 73,66 | | | | | |
| | 64 | 0919 564 7322 | 0919 564 6322 | 0919 564 5322 | 89,3 | | | | | 86,44 | 2,54 x 31 = 78,74 | | | | | |
| | G | 06 | 0919 506 7322 001 | 0919 506 6322 001 | 0919 506 5322 001 | | | | | Black | 4.5mm | Standard (Carton Box) | - | 15,4 | 12,78 | 2,54 x 2 = 5,08 |
| | | 10 | 0919 510 7322 001 | 0919 510 6322 001 | 0919 510 5322 001 | | | | | | | | | 20,5 | 17,86 | 2,54 x 4 = 10,16 |
| | | 14 | 0919 514 7322 001 | 0919 514 6322 001 | 0919 514 5322 001 | | | | | | | | | 25,6 | 22,94 | 2,54 x 6 = 15,24 |
| | | 16 | 0919 516 7322 001 | 0919 516 6322 001 | 0919 516 5322 001 | | | | | | | | | 28,1 | 25,48 | 2,54 x 7 = 17,78 |
| 20 | | 0919 520 7322 001 | 0919 520 6322 001 | 0919 520 5322 001 | 33,2 | 30,56 | 2,54 x 9 = 22,86 | | | | | | | | | |
| 26 | | 0919 526 7322 001 | 0919 526 6322 001 | 0919 526 5322 001 | 40,8 | 38,18 | 2,54 x 12 = 30,48 | | | | | | | | | |
| 30 | | 0919 530 7322 001 | 0919 530 6322 001 | 0919 530 5322 001 | 45,9 | 43,26 | 2,54 x 14 = 35,56 | | | | | | | | | |
| 34 | | 0919 534 7322 001 | 0919 534 6322 001 | 0919 534 5322 001 | 51,0 | 48,34 | 2,54 x 16 = 40,64 | | | | | | | | | |
| 40 | | 0919 540 7322 001 | 0919 540 6322 001 | 0919 540 5322 001 | 58,6 | 55,96 | 2,54 x 19 = 48,26 | | | | | | | | | |
| 50 | | 0919 550 7322 001 | 0919 550 6322 001 | 0919 550 5322 001 | 71,5 | 68,66 | 2,54 x 24 = 60,96 | | | | | | | | | |
| 60 | | 0919 560 7322 001 | 0919 560 6322 001 | 0919 560 5322 001 | 84,2 | 81,36 | 2,54 x 29 = 73,66 | | | | | | | | | |
| 64 | | 0919 564 7322 001 | 0919 564 6322 001 | 0919 564 5322 001 | 89,3 | 86,44 | 2,54 x 31 = 78,74 | | | | | | | | | |

| | | | | | | |
|---|--|---|---------------------------|-----------------------------|---|------------------------|
| | All Dimensions in mm Original Size DIN A4 | Scale 1:1 | Free size tol. | | Ref. | |
| | | | | | Sub. | |
| | All rights reserved | Created by DOUGE | Inspected by BAGDIKIAN | Standardisation HOFFMANN | Date 2013-11-04 | State Final Release |
| | Department EC PD - FR | Title SEK 19 male straight low profile | | | Doc-Key / ECM-Nr. 100541602/UGD/001/B 50000066836 | |
| HARTING Electronics GmbH D-32339 Espelkamp | Type TB | Number 09195XXX32X | | Rev. B | Page 2/2 | |

X-ON Electronics

Largest Supplier of Electrical and Electronic Components

Click to view similar products for [Headers & Wire Housings](#) category:

Click to view products by [HARTING](#) manufacturer:

Other Similar products are found below :

[892-18-020-10-001101](#) [58102-G61-06LF](#) [582553-1](#) [0009485154](#) [009176003701906](#) [0050291907](#) [LY20-4P-DT1-P1E-BR](#) [02.125.8002.8](#)
[609-3404](#) [61062-3](#) [622-0430](#) [622-3653LF](#) [63453-116](#) [636-1030](#) [636-1427](#) [636-3427](#) [636-4007](#) [641938-9](#) [641991-4](#) [644827-2](#) [65817-010LF](#)
[65817-015LF](#) [65863-015LF](#) [66207-023LF](#) [67095-007LF](#) [67601157](#) [68648-049](#) [70.362.1628.0](#) [70-4210](#) [70-4226B](#) [70-4853B](#) [707-5020](#) [707-](#)
[5028](#) [71.350.2428.0](#) [71918-208LF](#) [71961-016LF](#) [733-134](#) [733-162](#) [754199-000](#) [760-3052](#) [787-8014-00](#) [79531-3000](#) [FCN-360C032-B](#) [FCN-](#)
[367T-T012/H](#) [FCN-723D010/2](#) [80.063.4001.1](#) [800-90-001-10-001000](#) [800-90-010-10-002000](#) [801-43-002-10-013000](#) [801-43-006-10-002000](#)