

A

B

C

D

assembly aid enclosed

SW15

width across flats: 15

M12x1

Ø16,4

SW14

width across flats: 14

special printing

SW15

width across flats: 15

A (2:1)

contact face acc. to IEC 61076-2-101

pin	colour
1	white/yellow
2	yellow/white
3	blue/orange
4	orange/blue

complete length when assembled app. 46mm

order contacts separately

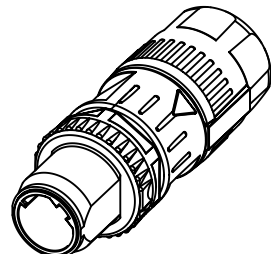

cable Ø	wire gauge	part-no.
5,7-8,8mm	AWG 26-22	09 67 000 5576
	AWG 24-20	09 67 000 8576
	AWG 22-18	09 67 000 3576

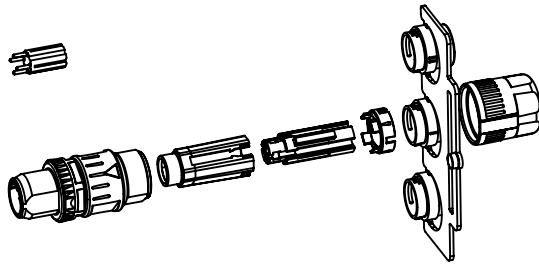

	All Dimensions in mm Original Size DIN A4	Scale 1:1	Free size tol.			Ref. Sub.
	All rights reserved Department EL PD	Created by POPESCUD	Inspected by AVRAM	Standardisation HOFFMANN	Date 2018-09-13	State Final Release
HARTING Electronics GmbH D-32339 Espelkamp		Title M12 crimp Slim Design 4-pole D-coded male			Doc-Key / ECM-Nr. 100518952/UGD/001/G 500000138339	
		Type TB	Number 21038811415			Rev. G
					Page 1/1	

## X-ON Electronics

Largest Supplier of Electrical and Electronic Components

*Click to view similar products for [Circular Metric Connectors](#) category:*

*Click to view products by [HARTING](#) manufacturer:*

Other Similar products are found below :

[600X518037X](#) [6STD15PCR99B70A](#) [8R4000A16M020](#) [8R5000A16M005](#) [1200910002](#) [1203580030](#) [1200910008](#) [1200910011](#) [1300140094](#)  
[130203-0054](#) [1300140026](#) [1300150099](#) [1-3637-600-5205](#) [1612618](#) [21036836414](#) [8R4006A16M010](#) [1R3006A20M005](#) [41-40011](#) [42-00006](#)  
[42-01015](#) [4-22279-4](#) [4-22281-1](#) [4-22284-9](#) [43-00113](#) [43-01203](#) [41-40013](#) [42-00008](#) [43-00343](#) [43-01026](#) [43-01162](#) [43-01173](#) [43-10000](#)  
[XS3P-M421-2](#) [600X518050X](#) [8R5006A16M020](#) [8R5006A16M005](#) [8R4000A16M010](#) [6-22279-3](#) [1605332](#) [N03FA03144](#) [1300140077](#) [43-](#)  
[16213](#) [43-01338](#) [XS2RD4265](#) [XS2R-D426-1](#) [XS8A-0441](#) [859RD04-103R004](#) [860RD04-113R004](#) [860RD04-213R004](#) [1-213245-2](#)