

WIRING INFORMATION

J1	Wire color	J2
2-e	Rose	2-e
1-e	Orange	1-e
2-d	Yellow	2-d
1-d	Rose	1-d
2-c	Rose	2-c
1-c	Brown	1-c
2-b	Black	2-b
1-b	Rose	1-b
2-a	Rose	2-a
1-a	Red	1-a
Shell	Braid	Shell

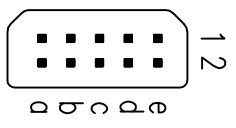

NOTES /

- 1.) CABLE ASSEMBLY IS MANUFACTURED PER RELEVANT JOB.
- 2.) MECHANICAL REQUIREMENTS
  - OPERATING TEMPERATURE = -20° TO +105°C
  - MATING CYCLES : 250, PERFORMANCE LEVEL 2 ( IEC 60512-5 )
- 3.) THE CONNECTOR COMPLIES REQUIREMENT : IEC 61076-4-107
- 4.) WHITE LABEL INFORMATION:

DATE CODE  
HARTING P/N

- 5.) CABLE MUST BE PERFORMED HI-POT TEST AND CONTINUITY TEST
- 6.) CABLE MUST BE PACKED INTO A PLASTIC BAG.

Rev.	Description	Appr.	Date
A	Prototype	Lucy Zheng	28/06/17

33 27 243 700 0019	7 m
33 27 242 120 0055	12 m
33 27 243 350 0029	3.5 m
33 27 243 400 0028	4 m
33 27 243 300 0027	3 m
33 27 243 060 0026	0.6 m
33 27 242 100 0021	10 m
33 27 243 800 0020	8 m
33 27 243 650 0019	6.5 m
33 27 243 200 0003	2 m
33 27 243 100 0002	1 m
33 27 243 050 0001	0.5 m

Part-No.

Dim. L

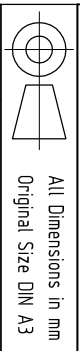

All Dimensions in mm  
Original Size DIN A3  
Free size fol.

Created by	Inspected by	Standardisation	Date	State
ZHENGL	LJK	LJK	2017-06-28	Final release

HARTING Customised Solutions		D-32427 Minden		Title		Har-link standard cable,male double ended cable assy, L*M		Doc-Key / EGM-Nr.	
All rights reserved		Department HCS - CN		Type		TB		Rev.	
Department HCS - CN		Number		33 27 0001		Page		1/1	

## X-ON Electronics

Largest Supplier of Electrical and Electronic Components

*Click to view similar products for [Specialised Cables category](#):*

*Click to view products by [HARTING manufacturer](#):*

Other Similar products are found below :

[603PT6](#) [603SS6L](#) [604PT6](#) [604SS6](#) [706000D02F200](#) [910640](#) [1200740077](#) [1200740114](#) [AC172](#) [ACL-SSI-4](#) [R88ACAKA0015SRE](#)  
[R88ACAWL005SDE](#) [R88ACRGD0R3C](#) [1300150047](#) [1300660036](#) [1302262116](#) [1300150149](#) [1300220020](#) [1300220104](#) [1300220119](#)  
[1301240492](#) [1301810221](#) [1365323-1](#) [176P12](#) [1971465-2](#) [20240400003](#) [20240400013](#) [2085828-1](#) [20886510030](#) [2-22733-8](#) [22733-8](#) [CB-](#)  
[5PSBC-RS](#) [CB-704EC-RS](#) [CB-BATACC-RS](#) [CB-JST3PSW-RS](#) [CB-M12COM-R10](#) [25AC84](#) [25AK84X](#) [25AU25](#) [25FN82](#) [AC118](#) [ACL-](#)  
[HHS-1M\(CAT5E\)](#) [SSL009PC2DC012N](#) [FC2A-KC6C](#) [2085828-2](#) [20886510150](#) [CCS-FCB-5](#) [CCSF2CBF2](#) [R88A-CRWB020N](#) [416216000-3](#)