

## Technical Characteristics

### Part Number

#### Han<sup>®</sup> 1A Kit

Hood	Top Entry
Housing	Snap-In Bulkhead
Material	Polyamide Plastic
Protection Degree	IP65
Temp Rating	-30 to +90C
Cable Gland	Plastic
Cable Diameter	5.7 – 10mm
Insert	3+GND
Screw Terminals	18-14AWG
Wire Strip Length	7.5mm
Mating Cycles	>100
Flammability	V-0

**73 10 100 0016**



#### Electrical Characteristics

Rated Current	10amps
Rated Voltage acc. UL	250V
Rated Impulse Voltage	6kV

## Drawings and Assembly Information

Dimensions in mm

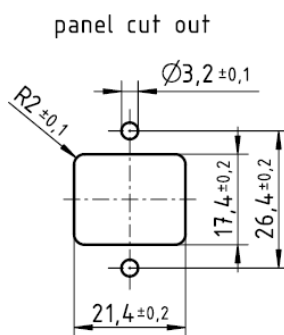
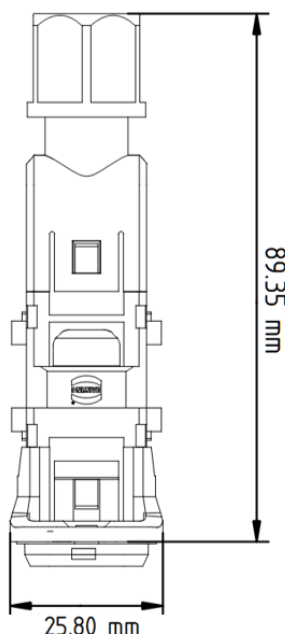

Tooling and Torque Values		
Type	Tool	Torque (Nm)
Terminal Screws (M3)	Slotted 0.4 x 2.5	0.25
Mounting Screws (M3 recommended)	-	0.3
Recommended Punch Die	09990000973	-

Kit Contents	
Male Insert	09 10 003 2601
Female insert	09 10 003 2701
Housing	09 10 000 0300
Hood & Gland	09 10 000 0400

For further information, please reach out to [techsupportUS@HARTING.com](mailto:techsupportUS@HARTING.com)

## X-ON Electronics

Largest Supplier of Electrical and Electronic Components

*Click to view similar products for [Heavy Duty Power Connectors](#) category:*

*Click to view products by [HARTING](#) manufacturer:*

Other Similar products are found below :

[6646058-2](#) [6646137-1](#) [6646138-1](#) [6646940-1](#) [6651091-1](#) [6651525-1](#) [6651529-1](#) [696475-1](#) [702-32-01109](#) [73080255059](#) [73080965046](#)  
[7310205040001](#) [765-16-0080B](#) [765-18-0080D](#) [902-77-02113](#) [PS00/A0620/6300](#) [AN0024023](#) [154-42B7WM250](#) [MS3117-14AC](#) [1643543-1](#)  
[1766966-1](#) [1791340000](#) [NLDFT-3-BL-L-S120-M40A](#) [NLDFT-N-W-L-C240-M40B](#) [1926015-1](#) [NLS-3-BL-C240-M40B](#) [NLS-N-W-C240-](#)  
[M40B](#) [NPS-3-BL-T6](#) [2-1589900-8](#) [9300480317](#) [294-0091-01100](#) [296-0040-01100](#) [1-6609148-0](#) [A32595-0049](#) [1766249-1](#) [19000005132](#)  
[1926016-1](#) [1-966831-8](#) [AN0024202](#) [AN0264023](#) [279-0841-10100A](#) [281-0334-00100A](#) [RMSB4](#) [419-2083-301](#) [LCDX4/0-14B-X](#) [075-8519-](#)  
[001](#) [078238-1613](#) [07.470.3256.0](#) [09000005288](#) [09140240311](#)