

Technical Characteristics

Part Number

Han[®] 1A Kit

Hood	Top Entry
Housing	Snap-In Angled Bulkhead
Material	Polyamide Plastic
Protection Degree	IP65
Temp Rating	-30 to +90C
Cable Gland	Plastic
Cable Diameter	5.7 – 10mm
Insert	3+GND
Screw Terminals	18-14AWG
Wire Strip Length	7.5mm
Mating Cycles	>100
Flammability	V-0

73 10 100 0018



Electrical Characteristics

Rated Current	10amps
Rated Voltage acc. UL	250V
Rated Impulse Voltage	6kV

Drawings and Assembly Information

Dimensions in mm

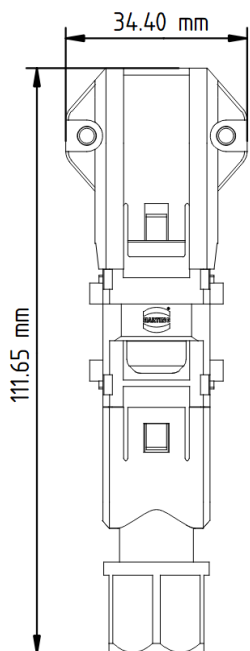

Tooling and Torque Values		
Type	Tool	Torque (Nm)
Terminal Screws (M3)	Slotted 0.4 x 2.5	0.25
Mounting Screws (M3 recommended)	-	0.3
Recommended Punch Die	09990000973	-

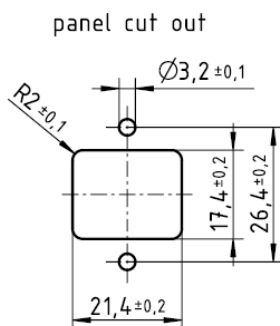

Kit Contents	
Male Insert	09 10 003 2601
Female insert	09 10 003 2701
Housing	09 10 000 0800
Hood & Gland	09 10 000 0400

X-ON Electronics

Largest Supplier of Electrical and Electronic Components

Click to view similar products for [Heavy Duty Power Connectors](#) category:

Click to view products by [HARTING](#) manufacturer:

Other Similar products are found below :

[6646058-2](#) [6646137-1](#) [6646138-1](#) [6646940-1](#) [6651091-1](#) [6651525-1](#) [6651529-1](#) [696475-1](#) [702-32-01109](#) [73080255059](#) [73080965046](#)
[7310205040001](#) [765-16-0080B](#) [765-18-0080D](#) [902-77-02113](#) [PS00/A0620/6300](#) [AN0024023](#) [154-42B7WM250](#) [MS3117-14AC](#) [1643543-1](#)
[1766966-1](#) [1791340000](#) [NLDFT-3-BL-L-S120-M40A](#) [NLDFT-N-W-L-C240-M40B](#) [1926015-1](#) [NLS-3-BL-C240-M40B](#) [NLS-N-W-C240-](#)
[M40B](#) [NPS-3-BL-T6](#) [2-1589900-8](#) [9300480317](#) [294-0091-01100](#) [296-0040-01100](#) [1-6609148-0](#) [A32595-0049](#) [1766249-1](#) [19000005132](#)
[1926016-1](#) [1-966831-8](#) [AN0024202](#) [AN0264023](#) [279-0841-10100A](#) [281-0334-00100A](#) [RMSB4](#) [419-2083-301](#) [LCDX4/0-14B-X](#) [075-8519-](#)
[001](#) [078238-1613](#) [07.470.3256.0](#) [09000005288](#) [09140240311](#)